

SPECIFICATION

Power Supply Voltage
Factory set password

12V~30V DC, Negative Ground
"113266"

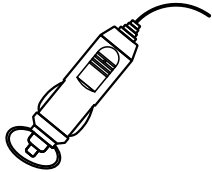

Portable car player
CarPlay(wired+WiFi)

Portable car player

KLEVA
SmartPlay

CarPlay(wired+WiFi) 

Operation Manual



Cigarette lighter power supply
Wireless CarPlay/Android Auto
Wired Mirrorlink
Reversing camera input
Audio/Video/Picture Playback



How to install the Mounting Bracket:

Glass suction cup type suspension installation.

1. To suction the mounting bracket, place it on your desired surface and push down on the locking lever.
2. To adjust the length of the mounting bracket neck, turn the locking dial anti-clockwise to loosen. Pull up or down to adjust to your desired length. Once you've achieved your desired view, turn clockwise to lock.
3. To adjust the height of the mounting bracket, turn the dial closest to the suction base anti-clockwise. Move it up and down to reach your desired height. Once chosen, turn clockwise to lock it into place.



Installation example :



CIGARETTE LIGHTER POWER PLUG

This device is powered by the cigarette lighter power plug. To power the SmartPlay™, first plug the power cord into the DC port on the left-hand side of the screen. Then, connect the other end of the power cord into the cigarette lighter port of your car, to turn it ON.

Style 1

Standard Cigarette
Lighter Power Plug

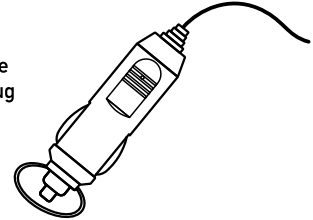

BLUETOOTH PAIRING CONNECTION

You can use Bluetooth music or Bluetooth calls. When using wireless CarPlay, you need to pair the Bluetooth connection first.

Device Bluetooth Name: "SWL-BT"

PIN Number: "0000" or "1234" (If need)

Connection Method:

1. Power on the machine and turn on it.
2. Turn on the Bluetooth function on the mobile phone, click to search for devices, and when the Bluetooth name of the current machine is found, click to connect.

FUNCTION DESCRIPTION

AV IN (CAM IN)	Video input interface. Connect the reversing camera through the 2.5mm plug to RCA cable.
USB Port	You can plug in a USB device to play music, video, and pictures. Mirrorlink or carplay or Android Auto can also be connected through this port. (Some models support Type-C)
IR	Remote control signal receiver. (Only some models have remote control)
DC IN	3.5mm power cord plug (some models are Type-C power plug), the voltage range is 12~30V.
MIC IN	3.5mm microphone jack. (External lavalier microphone can be connected). (Supported by some models only)

Tip: Only look at the introduction of the functions that the purchased model has.

Mirrorlink (iPhone)

When the device is plugged into the iPhone, the content of the phone screen will be projected onto the car screen.

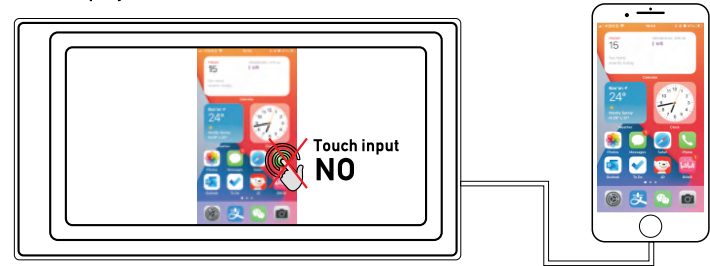

You can't control your iPhone here.

Mirrorlink (Android)

When using an Android device, after connecting the USB data cable, you will be prompted to install the APP software. After installation, Plug the data cable again, it will enter the screen mirroring mode. And it can be operated on both the player screen and the phone screen.

Only the image transfer is successful at this time. The sound can only be transmitted after the Bluetooth connection is successful.



You can also control your android phone here.

Apple CarPlay (wired & wireless)



[You can also control your iphone here.](#)



On your Smartplay™, go to phone link and under iPhone settings, ensure that Auto Connect is set to CarPlay.

Wired: Simply connect the lightning USB power cable into the left-hand side of the SmartPlay™ screen and the other end into your iPhone. From there, it will automatically enter the CarPlay interface (lightning power cable not included).

Wireless: First turn on the Bluetooth and Wi-Fi functions of the mobile phone. Press the Phone App Icon on the SmartPlay™, which is labelled Bluetooth. Then select "Pair," which is the 4th option at the bottom of the screen. Open settings on your iPhone and select Bluetooth. On your iPhone screen, under devices, select SWL-BT and follow the pairing process, from there it will automatically enter CarPlay interface.

(**Note:** The signal is transmitted through Wi-Fi at this time, so even if the Bluetooth function is turned off, it will be transmitted normally. When the Wi-Fi function is turned off, CarPlay will be disconnected.)

Android Auto (wired & wireless)

This feature is not supported in all countries, and "Google Play" services need to be available locally.

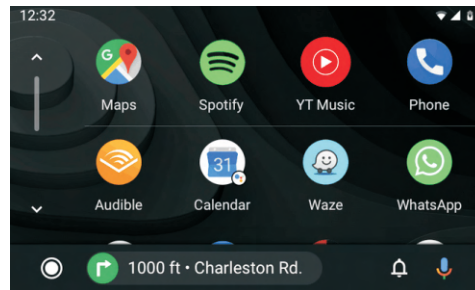

[You can also control your android phone here.](#)

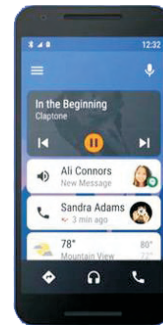

1. Need to download and install "Android Auto" software in "Google Play".
2. A mobile phone with Android 6.0 or higher must be used. It must use a valid data cable connection.

On your Smartplay™, go to phone link, and under Android settings, ensure that Auto Connect is set to Auto.

Wired: Simply connect the USB power cable into the left-hand side of the SmartPlay™ screen and the other end into your Android. From there, it will automatically enter the Android Auto interface (power cable not included).

Wireless: Press the Phone App Icon on the SmartPlay™, which is labelled Bluetooth. Then select "Pair," which is the 4th option at the bottom of the screen. Open settings on your Android and select Bluetooth. On your Android screen, under devices, select SWL-BT and follow the pairing process by entering the pin code found on the SmartPlay™ device, then follow on with the privacy process, from there it will automatically enter the Android Auto interface.

COMMON PROBLEMS AND SIMPLE TROUBLESHOOTING

1) How to connect the Mirrorlink.

Before connecting the mobile phone, click the Phonelink function of the device, and then select the mode as Mirror, then connect the data cable of the mobile phone, and click the authorization on the mobile phone to connect.

2) How to make the sound come out through the speakers in the car.

1. The built-in speaker of our device can emit sound, you can turn it off in the system settings;
2. Transmit the sound to the original car radio through the FM transmitting function of the device (for example: select 86.3MHZ on the device, and then play USB music, then use the car radio to search for 86.3MHZ);

3) Bluetooth not working properly.

Delete the paired "SWL-BT" on the mobile phone, and then re-search the Bluetooth name "SWL-BT". After the pairing is successful, it can be used normally.

4) Can't automatically connect with CarPlay or Android Auto.

1. You need to set CarPlay or Android Auto as the default connection mode on the Phonelink setting interface, and then it can automatically jump to the CarPlay or Android Auto interface when USB is connected.
2. If it is a wireless connection, you need to turn on the wifi on the mobile phone, and then when the Bluetooth is connected, it will automatically jump to the CarPlay or Android Auto interface.
3. Go to 'setup', press 'restore factory setting', confirm 'yes' then connect again using Carplay or Android Auto.

5) Press your finger down on the top of the screen and slide down to view the status bar to adjust the volume. Once the sound has been adjusted return to home screen. If you are trying to increase the volume ensure that the volume on your phone is also set to max.

6) Can't remember time and date, settings.

The machine does not have a battery, so there is no way to remember the time and date. After connecting to the mobile phone, the time and date will be automatically updated.

7) Can't play TF card, USB music and video.

Use 8G or 16G TF card and USB devices, some large-capacity storage devices may not support; format the storage device, use the file system FAT32; some encoding formats may not be recognized, please use common format media files.

8) If you need to download the phone book contacts to the car display unit . You need to go to the Bluetooth page .Press 'Contacts' . Then press the ↓ you can see the phone book .

9) The Remote Control is not functioning?

The remote control can only function if used on the left hand side of the SmartPlay™ near the remote control sensor on the left hand side of the screen. Ensure that you have inserted 2x AAA batteries into the remote to power.

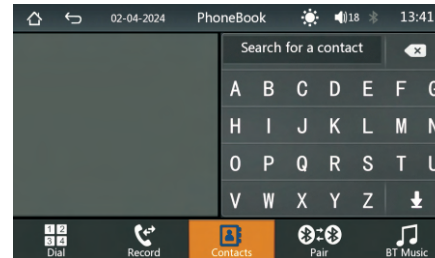
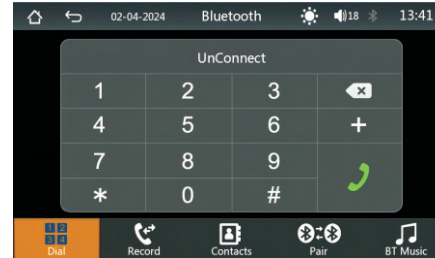

(Reversing Camera not included, to be purchased separately)

REVERSING CAMERA CONNECTION (CCD)

The reversing video input can be connected through the RCA adapter cable. When there is a signal at this port, the LCD will automatically switch to the camera image.



2.5mm AUX to RCA adapter cable

wiring diagram of reversing camera

