



Cadenza CHANDELIER

INSTALLATION GUIDE



WEARING GLOVES
IS RECOMMENDED

DANGER: ELECTRIC SHOCK RISK. FOR YOUR SAFETY,
TURN OFF ELECTRICAL POWER BEFORE BEGINNING
INSTALLATION AND USE CAUTION WHEN INSTALLING.

+1 888.399.9905

www.vault-light.com | sales@vault-light.com



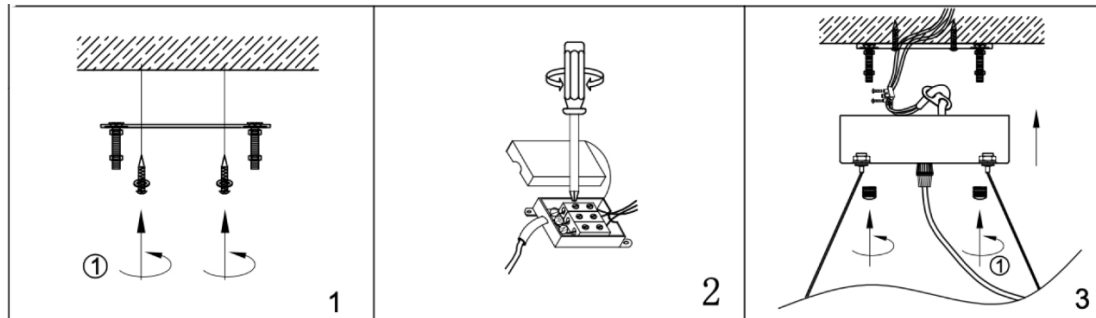

REF/SKU : BRCH9083-90
Lampholder: LED

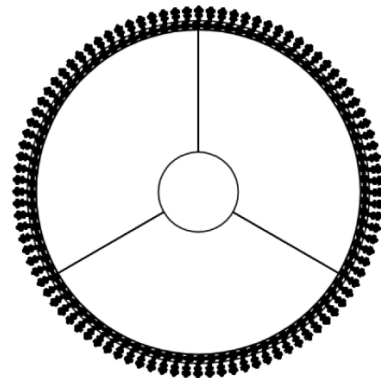
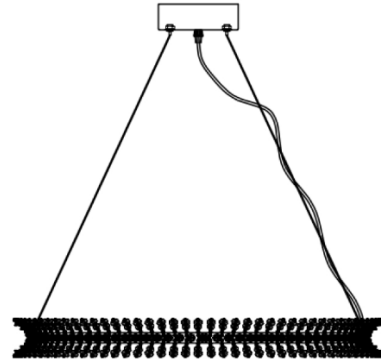

Installation program

1. Fixing hanging board on the ceiling by screw.
2. Connect the wires in the junction box to the external power cord
3. Push the canopy to the ceiling and lock it with screws

ATTENTIONS



- WARNINGS**
1. Do not disassemble this products
 2. Do not strike or shake strongly
 3. Do not wipe with ethyl alcohol, gasoline or paint thinners etc.

Assembling Attentions :

1. Components should be on desk, without any defect or out of shape.
2. The bearing of mounting plate should be enough for the lamp, expansion screw is needed for big chandeliers.
3. Once wight of chandelier is over 3kg, it should be fix with Embedded chain hoist to make sure not pressure to wire
4. Incandescent light bulb can not be installed to combustible hook directly, can not cling to fabric shade, power can not higher than maximum marked on lamp.