

size:105x148mm

### 3.Installation

The installation and position of the camera

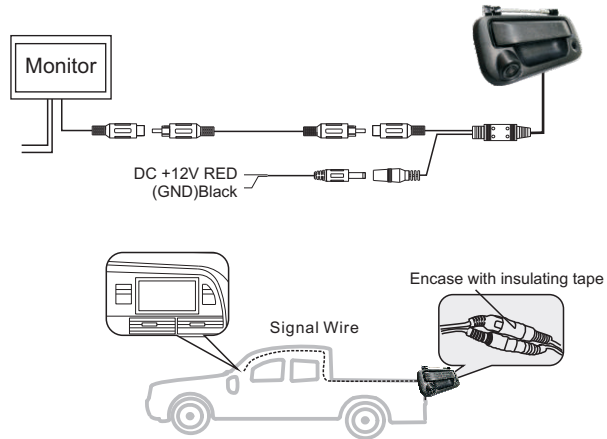

The effect of camera's installation



3

# BOYO<sup>®</sup>

VISION

## VTS18HD



## 1.Specification

Technical term	Technical Parameters
Image Sensor	HD CCD
Power Supply(DCV)	DC 9V-16V
Current Consumption	57 mA
Power	0.7 W
Effective pixels	768(H)X494(V)NTSC, 752(H)X582(V)PAL
Electronic shutter	1/60 (NTSC)1/50(PAL)-100000s
Minimum illumination	0.1 Lux
S/N Ratio	48 dB
Resolution(TV Lines)	600 TVL
TV System	NTSC / PAL
Lens Angle(Deg.)	D=130°± 10° H=90°±5° V=68°±5°
Video output	1.0Vp-p 75ohm
IP rating (Waterproof)	IP 67
White Balance AUTO	AUTO
AGC	AUTO
BLC	AUTO
Operating Temperature(° F)	-31° F~167° F

## 2.Accessories

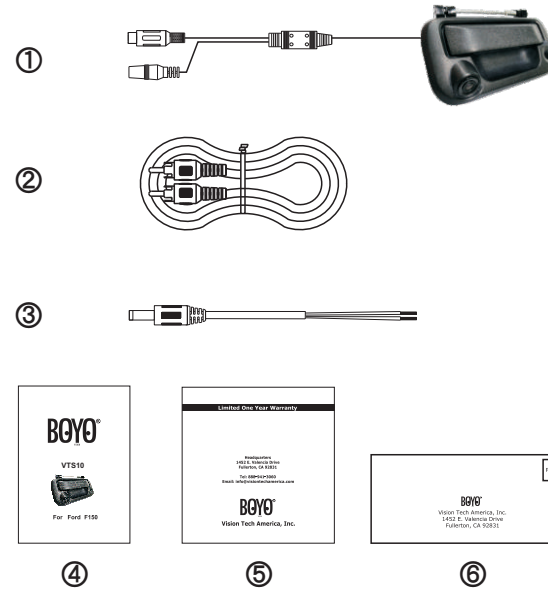

Sequence Number	Name
①	Camera
②	Signal Wire (26ft)
③	Power Line (10ft)
④	User's manual
⑤	Warranty Card
⑥	Registration Card