



B7

2CH DRIVING VIDEO RECORDER

User Manual

- HD Recording Solution (1280 X 720p)
- 2.4"High-Resolution LCD
- 2CH System (External Camera : Option)
- External GPS & G-sensor (option)
- Micro SD memory card

Contents



Safety Instructions	3
1. Feature	6
2. Box Contents	6
3. How to Install the Recorder in Your Vehicle	7
1) Mounting / Removal of the stand	7
2) How to install	8
3) Recommended installation location	8
4. Components and Functions	9
5. Preparations for Operation	10
1) Inserting the micro SD card	10
2) Removing the micro SD card	10
6. Operation	11
1) Power ON/OFF	11
2) Checking the received GPS data	11
3) Video recording	12
4) Emergency recording	13
5) Real-time displaying	13
6) Function of mode switching	13
7. Menu Function	14
Recording mode	14
G-Sensor / Speaker volume / MIC volume	15
Parking mode set up / LCD Screen control / Video set up	16
Play list / SD Card format / V-OUT set up	17
8. PC Viewer Manager	18
1) How to install PC Viewer Manager	18
2) Configuration set up	21
9. Firmware Update	23
10. Micro SD Card Data	23
11. Specifications	24
• Parking mode	25
• Limited warranty statement	26

Safety Instructions

This device is safe driving ancillary product that records while driving and it can be used as reference in case of driver's sudden collisions caused by other vehicles or unexpected accident. It is very important to follow these safety rules. We state "Caution" and "Warning" to clarify any potential risk for a damage associated with the misuse of the product.



WARNING

This information to prevent physical damages. Please read the following rules carefully.



Should install while power off. (After install products, connect DC jack)
– It may cause to electronic shock or malfunction.



Do not operate the product while driving.
– It may cause an accident. Stop in a safe place and operate.



Do not put a sharp object on the hole or crack in the body.
– In case of inserting them, stop to operate, it may cause electronic shock, fire and malfunction.



Do not disassemble the product.
– It may cause malfunction and injury.
– Make inquiries to agent for repair and checkup.



Keep the product away from hot or cold temperature.
– In case of being the product in airtight car may cause by malfunction.



Do not use beyond standard voltage of the product.
– Using beyond standard voltage may cause by explosion, fire and malfunction.



Do not use in dangerous condition as smoking, smell something burn.
– It may cause fire. Stop to use and make inquiries to agency.



When install direct power cable, should contact to a electric shop. (The place of fuse box is varying depending on each car manufacturer. Please check the car manual before installation)



Do not use other accessories.
– Using with other accessories may cause malfunction.



Attach the product on the front window properly.
– Clean the front window and adhere it firmly, otherwise it may be detached due to temperature/humidity/dust/shock.

Safety Instructions



INSTRUCTIONS

This information to prevent any damages or reducing lifespan of the products.



Do not shock to the product.
– It may cause damage or malfunction for product.



The front window and camera lens should be kept clean.
– If it is dirty, the recording image quality could be poor.



In case of metallic tinting on front window may cause telecommunication problem or poor recording quality.
– In metallic tinting car may cause GPS signal receipt problem.



GPS function needs loading time when it power on.
– It needs from few seconds to minutes depending on signal receipt environment.



Do not place any obstacle objects around the external GPS.
– It may cause problem on GPS signal receipt rate.



Do not place near magnetic devices.
– It may cause malfunction and trouble.



In case of suddenly changing of brightness such as tunnel enter/exit or extremely dark place, the recording quality may be low.



Replacing position of the product may lead to change in camera angles.
– Adjust the camera angle and check the recorded image.



Check data stores in the micro SD memory card.
– Check data stores in the micro SD memory card to see if the product is operating properly.



GPS connection can be delayed when the unit has not been used for long or when it is default status.
– GPS receiving condition is not related to recording operations.



G-SENSOR may not recognize impacts when it is too low or weak.
– Recording files are must be formatted regularly (at least every 2 weeks) to keep your data safety.
– We do not take responsibilities for any malfunctions caused by memory card.



Please check the memory card regularly to see if the operation of the product and the micro SD Card is in good condition.
– Please contact the customer service if any deflection has been found.



Please take care below notice for micro SD Card. We do not have responsibility for data loss or damage caused by not complying below rules.



Do not use incorrect type of micro SD Card.

- Manufacturer do not have a responsibility for not in usage of adulterated card.



Push the micro SD Card fully.

- It may cause a malfunction.



Before ejecting micro SD Card, please check the power off.

- If you pull micro SD Card out during power on status, it may cause malfunction or data loss.



Integral components are no user-serviceable.

- It may cause a serious damage on micro SD Card.



micro SD Card has limited lifespan, It would not support normal recording due to damage memory as time goes by. Please check the warranty period of micro SD Card.

- If you find data lose after long time usage, please replace new micro SD Card.



Please check the capability of the micro SD Card when you purchase spare micro SD Card.

- This is to avoid loss of your datafiles.



Please Backup your data regularly.

- This product supports up to 16GB.



Turn off the product before ejecting the micro SD Card.

- It may cause a serious damage on micro SD Card.



Please take care below notice for built-in battery. We do not have responsibility for damage caused by not complying below rules.



Built-in battery is an auxiliary usage for safe saving recording image while the power is not supplied. Please connect and use main power supply for normal recording.

- Unless connect main power supply, it does not work properly.



Battery has limited lifespan, so the recording time may be reduced after 6 months. (The life time is different depending on using condition.)

- If you find a problem that the last recording is not saved continuously, the battery life might be reduced. Please inquire your dealer for battery replacement. (Provide at a cost)



Do not put the product in place where sudden temperature increasing and should use on optimum voltage, temperature and humidity. - It may cause to electronic shock or malfunction.



When it takes long time not in use, the battery may leak.

- If the leakage is covered on the skin, please wash it with running water. Do not rub your eyes when it touched your eyes. See your doctor.

Feature

- Automatic recording system
- Parking mode function : with connecting 5V Direct power cable(option)
- Wide view angle (120°) (Built-in 2.3 pixel CMOS Camera)
- Voice recording support while image recording.
- Speaker Alert
- External GPS
- Built-in 3G-SENSOR(Front/Rear, Left/Right, Up/Down shock sensing and recording)
- micro SD Card use (Max, 16GB)
 - If the recording image exceeds micro SD Card capacity, it deletes images from the oldest file and records continuously.
- Emergency battery equipped
- Free voltage (DC 12~ 24V)
- 2,4inch IPS (Wide view) LCD
- Configuration function
- Playback function

Box Contents

* Before use this products, please check below contents. If there is something missing parts, please contact sales agent.

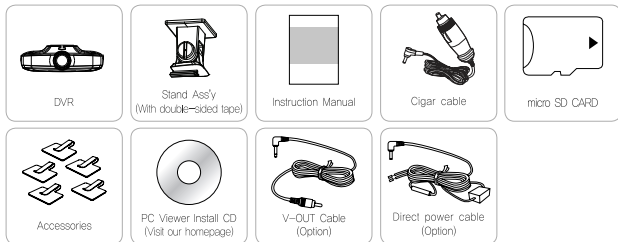

* Pictures of the parts may differ from the actual. Some parts may change in certain circumstances.

How to Install the Recorder in Your Vehicle



Prior to installation, check the followings :

- To ensure safe installation, always perform installation procedures in a bright place,
- Before installation, always turn off the engine and pull out your car key,
- DO NOT use any other cables than the power cable included,
- For vehicles with excessive window tinting, the recorded images may appear dark,
- Do not place any obstacle objects around the external GPS,
- If use navigation and vehicle monitor, the image could be reflected on the front glass and it might effect on the recording quality. To prevent this problem, please set the direction not to be reflected the image,



**If the product is separated from the glass it could be occurred car accident.
Please clean the front glass and fix it firmly.**

1 Mounting / Removal of the stand

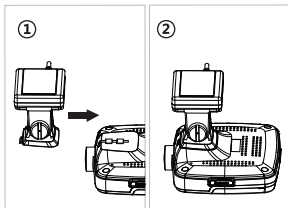

Combination

1. After fixing the combination part of the stand and the product well, the product puts in with the front,
 2. In order for the quadrangular shape of the stand appearance and square shape of the product to agree, the product puts in deeply.
- * when necessary adhere the stand first and bond the product

Separation

- ① In opposition of assembly method pulls a combination part with back and disjoints,

How to Install the Recorder in Your Vehicle

2 How to install

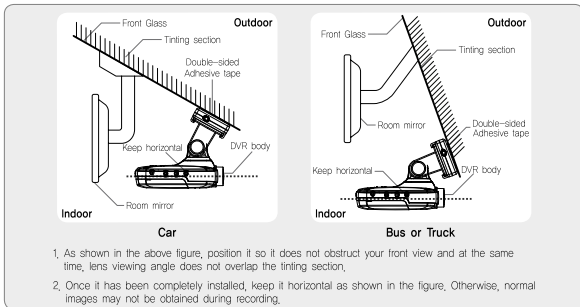

3 Recommended installation location

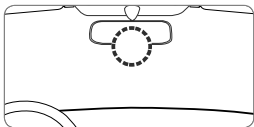

If installed at the center of glass window in the front of the room mirror, optimal recorded images can be obtained.



If it is difficult to install as above picture, it can be installed on left or right of room mirror. Install the product on the middle of vehicle otherwise the image may lean to one side.

Components and Functions

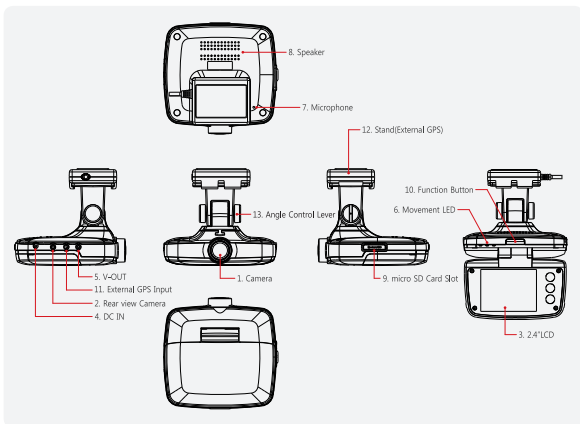

1, Camera	2,0M Pixel CMOS Camera 120° Viewing Angle
2, Rear view Camera	0,4M Pixel CMOS Camera 130° Viewing Angle
3, 2.4" LCD	Camera image & Configuration & Playback
4, DC IN(Power Input)	A port intended to connect the power cigar cable (12V~24V)
5, Video-Out	Picture output
6, Movement LED	Movement Status/ Inner Voice Recording
7, Microphone	Voice recording microphone
8, Speaker	Output speaker of all kinds of auditory warning signals(MONO)
9, Micro SD Card Slot	A slot intended to insert the micro SD Card
10, Function	Emergency recording, Audio recording ON/OFF, V-OUT ON/OFF
11, External GPS Input	External GPS signal input port
12, Stand(External GPS)	Stand for fixation on glass window (Double-sided adhesive tape), External GPS
13, Angle Control Lever	Control Lever (Enabling to adjust its angle)

Preparations for Operation



Before using the micro SD Card, check the followings :

- Always use the original micro SD Card only. If not, data loss may happen.
- The micro SD Card can be inserted regardless of the power ON/OFF status of the product. As soon as it is inserted, it will reset the internal software and then operate
- To remove the micro SD Card, first turn off the vehicle engine, and check the GPS LED lights out(not more than 20 sec, required). Then, remove the micro SD Card. If remove micro SD Card on power on status, it sounds beep and can not complete recording. And it may cause loss of recording image serious damage to micro SD Card.

1 Inserting the micro SD card

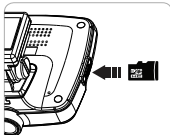

Open the card slot and insert the micro SD Card like the picture,

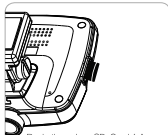

Push the micro SD Card fully until it seems to be caught by something inside,

2 Removing the micro SD card

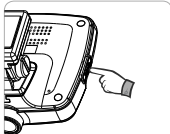

Press gently the micro SD Card. Then, it will come out,

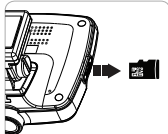

Pull out the micro SD Card,

Operation



Before operating this product, please be aware points below

- Do not operate on driving.
- Recording is possible when micro SD Card is inserted.
- If remove micro SD Card while recording, some part of image might be deleted.(with beep sound)

1 Power ON / OFF

1. This product has no power ON/OFF button. To power on, start up the engine while the power cigarette cable has been connected to the body. Then the power on with beep sound.
2. If the engine is turned off, the power remain for seconds in order to save securely recording file and then turn off with beep sound automatically.



The product does not power off by itself after engine off when it connected to battery by direct power cable. If you want to power off, please disassemble direct power cable from product.

2 Checking the received GPS data

After inserting the micro SD Card, start up the vehicle engine. Then, the product will power on. At the same time, while auditory signals are heard, it will start searching GPS signals, if done, it will detect GPS signal with beep sound.

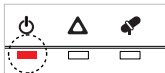

GPS functions can be used to estimate the user's driving route, speed, time(duration)

- Within the GPS coverage Green LED Lighting
- Out of the GPS coverage RED LED Lighting

Operation

3 Video recording

Once installation and wiring procedures have been completed, start up the engine with the micro SD Card inserted. Then, it will power on without any other additional operation, and recording will start simultaneously.

- Factory Default : INFINITE MODE + EVENT MODE (User can change recording mode on Recording setting / refer to page13)



Depending on voice recording mode Blue LED blinks

Infinite recording : It blinks at intervals of 2,5 seconds,(Blue LED)

Event recording : It blinks at intervals of 0,5 seconds,(Blue LED)

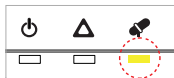

Depending on voice recording mode Yellow LED blinks

Voice recording ON : Yellow LED In

Voice recording OFF : Yellow LED Out

Recording mode & time

- **Infinite recording** : Independent of events, it continues recording at intervals of 1 min,



- **Infinite and Event recording** : Both normal recording and event recording are used, if any event (impact) is detected during normal recording, normal recording will stop and instead, event recording will start. After event recording, normal recording will resume,

Ex) If an event happens 1 minute and 50 seconds after starting recording :



- * The words, 'an event happens' mean to detect any impact when it is given. The higher is the sensitivity, finer shocks or impacts are detected. On the other hand, the lower is the sensitivity, simply strong shocks or impacts only are detected. It is possible to adjust the intensity of detection

4 Emergency recording

● Emergency recording

Emergency recording function is intended to activate manually recording in an unexpected event or when it is necessary to save images at discretion. Such images will be saved in [EVENT] folder of the micro SD Card.

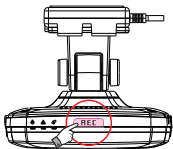

- Simply (briefly) press down REC button during operation.
Then, manual video recording will be enabled with beep sound.
- Recording procedures are same as those for event recording.
- **This function will be disabled during event recording.**
- Press the button for long to record images with sound effect.

5 Real-time display



Real time recording display on the 2.4" LCD screen.
Display the Both screens when external camera is connected.

6 Function of mode switching



Voice recording ON/OFF (Default : ON)

Depending on voice recording mode Yellow LED blinks



- * Voice recording ON : Yellow LED In
- * Voice recording OFF : Yellow LED Out

Menu Function

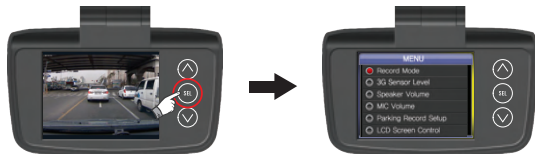

1. Press down the Select button to enter the menu
 2. Simply press select button to enter and press a few seconds to exit,
 3. To exit the menu press down the SELECT/ UP/ DOWN button for a long. It also automatically escapes the menu after 10seconds,
- The touch key is for the advanced products



How to activate the button

- Enter: Touch the button lightly for 0,2 seconds,
- Exit: Touch the button for more than 3 seconds,

I Recording mode

- Setting: Selecting recording type (disable the G-Shock sensor)
- Normal recording: It records continuously at intervals of 1 min,
- Normal + Event recording: If any impact is recognized during normal recording, the data will be organized before 10 seconds and after 10 seconds from the impact moment, (total 20seconds)





2 Sensitivity adjustment

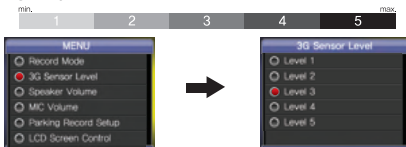

3 Speaker volume

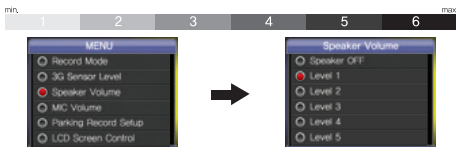

4 Microphone volume

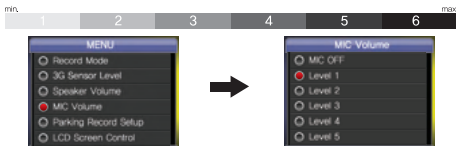

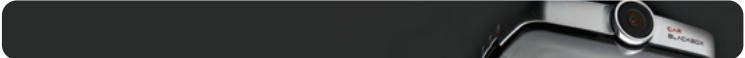

5 Parking mode set up

- G-sensor + Motion detection
- Motion detection: performs only when any motions are detected
- G-sense: performs only when any shocks are detected
- **Parking mode: Refer to page 25**

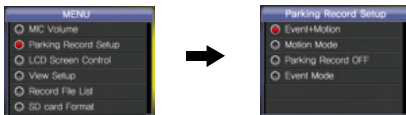

6 LCD display adjustment

Setting the LCD screen timer

- 1min: LCD screen off after 1 min • 3min: LCD screen off after 3 min
- 5 min: LCD screen off after 5 min • Always on: LCD screen is on continuously

• **LED screen off when the parking mode is on**



7 Screen set up

Setting the images

- Front image + rear image: display both images when rear camera is connected
- Front image: displays front image only • Rear image: displays rear image only when rear camera is connected

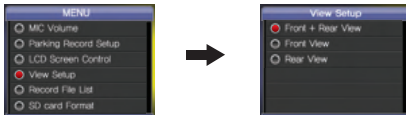



8 File list

Able to play the images from the file list that stored in SD card

Press the SELECT touch key to play the list from the normal recording or event recording

Press SELECT touch key for 3 seconds to return to the list while playing images

• **Recording does not run while playing the image**

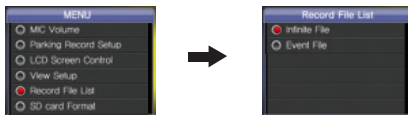

9 SD card format

Format the SD card as FAT32 structure

It reboots the unit automatically when formatting is complete

Please be aware that all file will be deleted by doing so

• **Backup is recommended before formatting**



10 V-out set up

Convert into the V-out mode by pressing down the SELECT touch key for 5 seconds in the LCD mode,

Convert into the LCD mode by pressing down the SELECT touch key for 5 seconds in the V-out mode

PC Viewer Manager



I How to execute PC Viewer Manager

- Please Double Click on  icon to run PC Viewer program.



1 Playback display	It shows front camera recording data.
2 Playback display	It shows rear camera recording data.
3 3G-SENSOR / Playback Location	It shows 3G-SENSOR data with graphs and playback location.
4 Speedometer	Displays GPS speed.
5 Playback Control	Adjust speed of playback.
6 Viewer Control	Stop / Previous file / Rewind / Play(Pause) / Forward / Next file.
7 Volume Control	It controls the play volume.(Mute / Volume +,-)
8 GPS Information	The GPS location data is shown through this map. (Data / Time / Speed / Location / Direction)
9 File Management	File open / Save / Delete.
10 Playback List Range	It shows playback list.
11 Playback List	It shows the playback list in the micro SD Card.
12 Map Information(Google map)	The driving routes are shown through this map.
B Screen Capture	Save the playback screen as JPS file.
1 Configuration Set	Setting operating configuration.
E5 Program Exit/Minimization	Exit the PC Viewer program or Minimize the PC Viewer program.

● Menu Button and Control

Button	Function	Description
	Volume Control	It controls the play volume (Mute / Volume +,-)
	Play / Pause	Play or pause the playing file.
	Rewind / Forward	Play before (after) few second during playing file.

● Playback List Button

Button	Function	Description
	All Files	It shows all files in the List.
	Infinite Files	It shows normal files only in the List.
	Event Files	It shows event files only in the list.
	Open Folder	Selects the folder to play.
	File export	Save the selected file to hard disk drive.
	File delete	Deletes the selected file on micro SD Card.

1. Open Folder

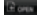
- 1) Clicks on  button.
- 2) When the explorer appeared, select the video files.
- 3) It can select one file or all files(CTRL+A).

2. File Export (Save to hard disk drive)

- 1) Select the files which you want to save to hard disk drive, (Multiple selection)
- 2) If you click the  button, then, [DVR Backup]folder will be auto-created in [My documents] of PC, the file you want is saved at [DVR Backup] folder.

3. File Delete

- 1) There is a select button at the front part of each file.
- 2) When the select button is clicked, the file will be selected or cancelled, (Multiple selection)
- 3) When the select button on the top is clicked, all of the file will be selected or cancelled.
- 4) Select the files which you want to delete, (Multiple selection)
- 5) Clicks the  button, then the selected files will be deleted on micro SD Card.

⇨ Caution : The file which unsaved to hard disk drive cannot be recovered.

PC Viewer Manager

• Playback List

FILE TYPE >	ALL	NORMAL	EVENT	PARKING
TYPE	DATE	FILE NAME		
●	2011.10.28 13:03:40	111028_130329_020_I_2.mpg		
●	2011.10.28 13:03:26	111028_130327_002_E_1.mpg		
●	2011.10.28 13:03:26	111028_130327_002_E_2.mpg		
●	2011.10.28 13:03:42	111028_130343_003_E_1.mpg		
●	2011.10.28 13:03:44	111028_130343_003_E_2.mpg		
●	2011.10.28 13:04:06	111028_130409_021_I_1.mpg		
●	2011.10.28 13:04:10	111028_130409_021_I_2.mpg		
●	2011.10.28 13:06:08	111028_130608_022_I_1.mpg		
●	2011.10.28 13:06:10	111028_130609_022_I_2.mpg		



Function	Description
1 File List	It shows file in the micro SD Card.
2 File Select	It can select a file to save or delete.
3 File Arrangement	Arrange files by ALL/EVENT/INFINITE

- 1) File arranges by oldest file.
- 2) File can be arranged by ALL / EVENT / INFINITE.
- 3) Click the button by the name of file to copy or delete.

• Other Buttons

Button	Function	Description
	Configuration Set	Setting operating configuration
	Minimize/Close Window	Exit the PC Viewer program or Minimize the PC Viewer program

• Google Map Button

Control Button	Function
	Map Tracking ※ Google Map can be displayed when user PC is connected through internet
	Map Zoom In / Out

2 Configuration set up

- If click Configuration Set button , the below configuration image will pop up.

※ Recording Setting

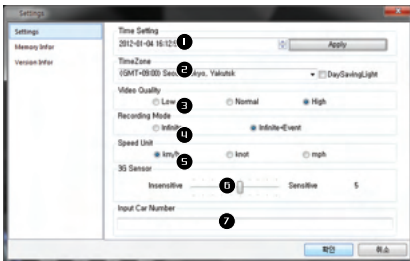

Function	Description
1 Date/ Time	Choose the current date and time
2 Standard time	Select the standard time zone (summer time)
3 Video Quality	Set up the video quality (default values : HD 1280 x 720p)
4 Recording Mode	Select the recording mode, (default values : infinite mode + event mode)
5 Speed Unit	Select the speed unit
6 3G-SENSOR	Adjust the sensitivity levels
7 Input the number of car	I register a car number and it will be shown when playback

- Apply button: Apply to RTC(Real time clock)
- After setting, files will be deleted automatically

PC Viewer Manager

• User Setting

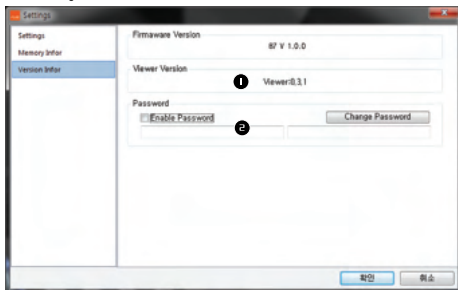

Function	Description
1 Version Info	Shows the version of PC Viewer and Firmware.
2 Input User Password	Register user password and check the "Apply to user password" Check the "Change password" to record the registered password.

Firmware Update



● Firmware upgradeable through micro SD Card.

1. Copy the target file to update, "bin" file into a root folder of micro SD Card,
2. Insert micro SD Card into product and connect the power.
3. The updating is progressed with Red LED blinking rapidly,
4. When Update is completed, Automatically rebooting is started,
5. Disconnect the power and connect again, Product is working based on the new firmware,

Firmware update: Download the firmware from the website

Micro SD Card Data



1. Event Folder

- shock sensor will be stored separately into event folder and will be named as **yyyymmdd_hhmmss_E_x.mp4**
- 20 seconds of video and audio files that are generated manually by pressing REC button will be stored separately into event folder and will be named as **yyyymmdd_hhmmss_B_x.mp4**
- The Parking mode files that are generated from the G-shock sensor and motion detection will be stored separately into event folder and will be named as **yyyymmdd_hhmmss_P_x.mp4**

2. Infinite Folder

- The length of 1ch normal recording file is 1minute and the file will be generated into normal folder.
This will be named as **yyyymmdd_hhmmss_L1_x.mp4**
- The length of 2ch normal recording file is 1minute and the file will be generated into normal folder.
This will be named as **yyyymmdd_hhmmss_L2_x.mp4** (2ch recording file generates as a single file.)

3. __System.cfg

- saves in this folder that configuration of the product,

4. version.txt

- Display version information,

Specifications



Front Viewer Camera	2,0M Pixel CMOS CAMERA (120° Viewing Angle)
Rear Viewer Camera	0,4M Pixel CMOS CAMERA (130° Viewing Angle)
Recording Resolution	1CH: 1280x720, 2CH: 640x480
Recording Frame	30fps@max (1CH), 15fps@max (2CH)
Recording Quality	High Quality(6Mbit) / Normal Quality(5Mbit) / Low Quality(4Mbit)
Recording Memory	46MB/min, 32MB/min, 24MB/min
Video Compression	H,264
Recording Mode	INFINITEMODE / INFINITEMODE+EVENTMODE
3G-Sensor function	0
GPS Antenna	0
Audio Recording	0
Function Button	REC / SELECT / UP / DOWN
Backup Battery	0
Power	DC 12V~24V
LED Indicator	0
Google Map Link	0
PC VIEWER MANAGER	0
Operating Temperature	-10℃~60℃
Storage Temperature	-20℃~70℃
Dimension	93(W)x28(H)x85(D)mm (Body only)
Weight	136g (Body only)
Power Consumption	Max 400mA@12V

Parking Mode : Direct power cable(option) connection

● FEATURE

- Parking surveillance mode means continuous recording mode on parking status which supports power from car battery even in power off status, (Similar with CCTV)
- It supplies Ordinary power cable (Option) which has automatically blocked off a low voltage so that it could prevent engine starting problem due to a dead battery,
- It blocks off the power automatically when the battery voltage is lower than 11,8V, Recording time is varying depending on battery capacity,

● NOTICE

1. When install ordinary power cable, should contact to a specialty store, (The place of fuse box is varying depending on each car manufacturer, Please check the car manual before installation)
2. Please use enclosed genuine ordinary power cable, Otherwise it may cause a serious problem on the product or car life,
3. Ordinary power cable is only available for power voltage 12V,
4. To safe usage on battery, please disassemble ordinary power cable when you do not drive for a long time (over 3 days). We recommend to disassemble to safe driving, however, this cable contains a function for preventing battery dead,
5. The recording time is varying depending on battery capacity,
6. Do not remodel ordinary power cable,
7. We do not have any responsibility for repair, exchanging or refund improper use,
8. We do not support exchanging or refund after unsealing except for defective product,
9. We do not have any responsibility for a damage caused by not following this notice,

● Parking mode ON/OFF

· If there are no movement or vibration for 10minutes on infinite recording mode, it will be converted into parking mode automatically. In order to turn parking mode off, press function button or keep staying vibration for 3 seconds, parking mode will be released automatically. LED status of Parking mode as below.

- * Parking mode ON: 3 colors LED blinks back and forth
- * Parking mode OFF: Operate as infinite recording mode LED status,

1. 1CH(1280x720), 2CH(640x480) recording in the parking mode.
2. In the parking mode, it will change to the Event recording, a file takes 20 seconds recording time.
3. In the parking mode, if vehicle moves, then it will be changed into the previous recording mode.
(It will take some seconds to minutes based on the vehicle and road condition)

Limited warranty statement



This Limited Warranty shall apply to the company Product including all accessories as contained within the original company's gift box ("the Product"). The company warrants that product from its authorized distributor will meet the applicable product specifications and be free from all defects in material and workmanship for an applicable period herein ("Limited Warranty"). This Limited Warranty is subjected to the following terms and conditions :

1. This Limited Warranty is given only to the original purchaser of the Product("Customer") It shall neither exclude nor limit a) any statutory rights of the Customer or b) any of the Customer's rights against the sellers of the Product.
2. The Limited Warranty shall be restricted to the country/region of Product purchase this is to avoid excessive importing or exporting of the Product throughout the supported countries.
3. This Limited Warranty is only valid and enforceable in countries where the Product is sold, Outside of the country of purchase, any repairs performed by the company Authorized Service Centre are subject to charge to the purchaser at normal repair rates.
4. The Limited Warranty entitles the Customer to a Product replacement or a full refund of the purchase price for any defects relating to the performance and/or functioning of the Product which result from normal use of the Product, provided that such a defect arises within ten (10) days of the original date of purchase of the Product and cannot be otherwise repaired. The company will provide a replacement or repair of the Product at the company own expense for any such defect arising after ten (10) days but within one (1) month of the original date of purchase. This Limited Warranty may not be sold-on, assigned, transferred or given to any subsequent purchaser or acquirer of the Product.
5. This Limited Warranty shall last for twelve (12) months from the date of original purchase("Warranty Period"). A valid original invoice ("Proof of Purchase") is required.
6. This Limited Warranty covers expenses for inspecting and repairing the Product during the term of the Limited Warranty. Customer shall deliver the defective Product to the company premises together with the warranty certificate, proof of purchase, and proof of identity of the Customer; however, any defective Product shipped by the Customer missing any one of such documentation may render this Limited Warranty invalid. Where the defect was the result of the Customer's own mishandling of the Product, force majeure, or the result of a repair by an unauthorized service provider, the Customer shall bear all expenses relating to shipping such a defective Product.
7. The company will return the repaired Product or another Product to the drop-zone for collection by the Customer in good working condition. All replaced faulty Products or components there will become the property of the company.
8. This Limited Warranty applies only to the original hardware components of the Product and does not apply to any software or other equipment.
9. The company repairs or replaces the Product, the repaired or replaced Product shall continue to be warranted for the remaining term of the Limited Warranty period or for three (3) months from the date of repair or replacement, whichever is longer.
10. Before returning any units for service, the Customer is solely responsible for backing up data and removing any confidential, proprietary, or personal information from the Product. The company is not responsible for damage to or loss of any programs, data, or removal storage media.
11. This Warranty does NOT cover recovery from any software updates, installation and removal of the application software, or any loss of data storage.
12. The company reserves the right to add, delete or amend the terms and conditions of this Limited Liability and any such change will be made available to the purchasers of the Product.



13. THIS LIMITED WARRANTY SHALL NOT APPLY IF THE DEFECT WAS CAUSED THROUGH ANY OF THE FOLLOWING :

- (a) The Product serial number, the accessory date code has been removed, erased, defaced, altered or is illegible; or
- (b) The defect is resulting from the use of the product in a manner other than their normal and customary manner, e.g., in excess of their minimum specification or operating instructions, or malfunction or failure resulting from use of incalibrate voltages; or
- (c) Deterioration of the Product due to normal wear and tear. All plastic surfaces and other natural wear of externally exposed parts of the product are scratched or damaged under normal usage; or
- (d) The defect is arising from improper installation, unauthorized repair, alteration or modification to the Product by third parties; or
- (e) The defect is arising from operating with components or accessories (ancillary or peripheral equipment) not officially authorized or provided by the company or used in other than its intended use; or
- (g) The defect or damage are arising from unauthorized modification; or
- (h) The defect or damage is arising from misuse, mishandling, accidental lost, abuse, accident, negligence and damage caused directly or indirectly by Customer, including but not limited to improper testing, installation, alteration or modification of any kind, or spillage of food or liquid, or build up of dirt or dust, or mains supply problem, thunderstorm activities, or infestation by insects or vermin, or exposure to abnormally corrosive conditions, or operation with extreme heat or humidity; or

14. WHERE A DEFECT WAS UNDETECTABLE BY THEN-AVAILABLE TECHNOLOGY OR WAS THE RESULT OF COMPLYING WITH THE APPLICABLE REGULATORY STANDARDS OR WHERE THE DEFECT WAS THE RESULT OF THE CHANGE IN THE DESIGN OF THE PRODUCT COMPONENTS SUPPLIED BY A THIRD PARTY, THE COMPANY WILL NOT BE LIABLE FOR ANY LOSSES OR DAMAGES OF ANY NATURE, INCLUDING BUT NOT LIMITED TO LOST PROFITS OR COMMERCIAL LOSS OF THE CUSTOMER.

15. This Limited Warranty does not affect the Customer's statutory rights in law specific to the country of purchase, and such rights remain protected. Some countries do not allow the exclusion or limitation of incidental or consequential loss or damage, or limitation of the implied warranties, in which case the preceding limitation of exclusions may not apply to such Customers. Please note Warranty service availability and response times may vary from country to country and may also be subject to registration requirement in the country of purchase. If you require assistance regarding warranty conditions, or have any other inquiries, please contact the company Customer care center or via the official website:

Product	Warranty Period
Car Black Box	1 Year

INSTRUCTION MANUAL