

## 1 Introduction



## 2 Package

The packing box contains the following accessories, please confirm:

- Rearview mirror monitor
- wire harness
- User's manual
- wire cover
- Remote control(option)

For the items listed above, please check with your package box. If any damage, Please contact with the distributor or the agent as soon as possible.

## 3 Features

- Back up camera display
- Automatic brightness adjustment
- 4.0mm glass and  $\varnothing 21\text{mm}$  car factory OEM bracket
- Adjustable Back up guide line
- Compass and temperature
- Auto dimming (option)

## 4 Specification

- Screen Size: 4.3 inch
- Display Screen: TFT-LCD
- Aspect Resolution: 480(H) X 272(V)
- Working Voltage: DC 12V
- 2ways Video Input:
  - Back up camera display (auto switch)
  - Car DVD or other Video input
- Signal System: PAL / Auto / NSTC

## 5 How to install mirror monitor

### 5.1 Remove the original mirror



Different cars have different brackets. It depends on your vehicle maker and manufacturer. There are many methods to remove the original rearview mirror, however, please don't force the mirror off the bracket. The manufacturer will not be responsible for damage caused to your car by wrong installation of the mirror.

### 5.2 Install mirror monitor on the plate



## 6 How to wire

After the mirror is mounted, you need to run the cable along the roof lining and down the pillar so you can connect to power and the rearview camera.

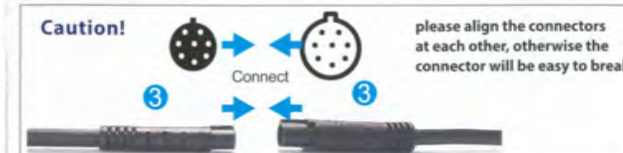
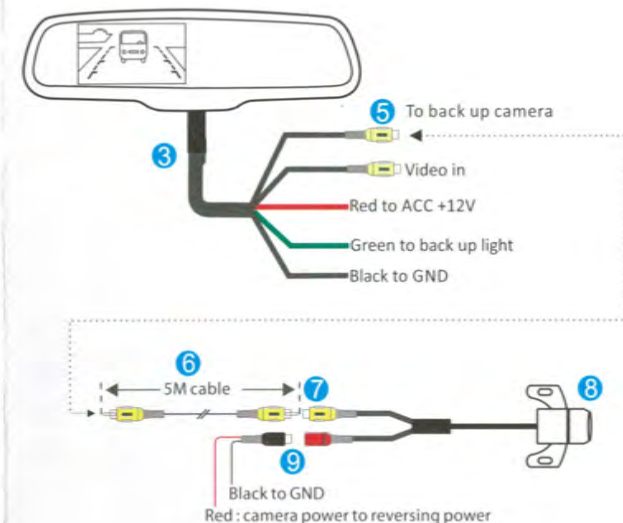

## 7 Back up camera display

When the car is in reverse, the monitor will automatically display backup camera.



A perfect reflective mirror

automatically display

## 8 Adjustable guideline

### 8.1 About guide line

Generally, to help drivers estimate the distance from obstacles, there are three lines for reference - red, yellow and green. Those three lines are displayed on the monitor when car is reversing. The green line is 9.84feet way from the back of car and the yellow line is 6.56feet. The distant red line is 3.28feet way from the backside of car while the closed red line is 1.31feet. Both reference lines on the left and right should leave 0.65feet from the car.

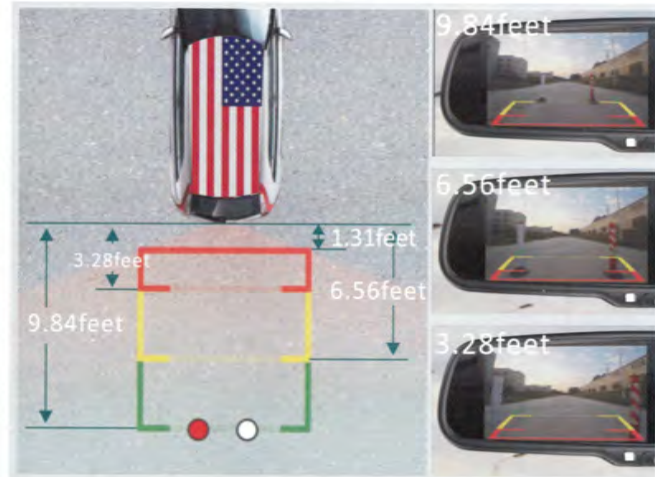

### 8.2 What the regular guide line is

Regular guide line is fixed. But installation sites of cameras are different as well as car size. The fixed guide line is not accurate enough for drivers. There is a great difference between regular and fixed guide lines and car's real guide lines, especially when camera is mounted on the left or right side of car backside. It may cause accidents.



### 8.3 How to adjust the guide line

According to the site of standard reference line, we can put reference objects such as desks in the back area of car. Compared with the marked reference objects, we can adjust the sites and angle of two guide lines displayed on the monitor. You will get the accurate and safety guide lines once they coincide with the reference objects.

Press setting button is to enter into "guide line adjustment" mode. The system is defaulted to adjust left guide line firstly. Press the button again will switch to adjust the right guide line. The up , down , left and right buttons are to adjust the correspondent location of guide lines. The clockwise rotation and contra rotation buttons are to adjust the angle of guide lines. It is easy to operate and calibrate. After finishing calibration, switch the reverse gear to save the information.

**Caution: keep the remote control 0.5m-1.0m from rearview mirror when you use the remote to adjust the parking lines.**

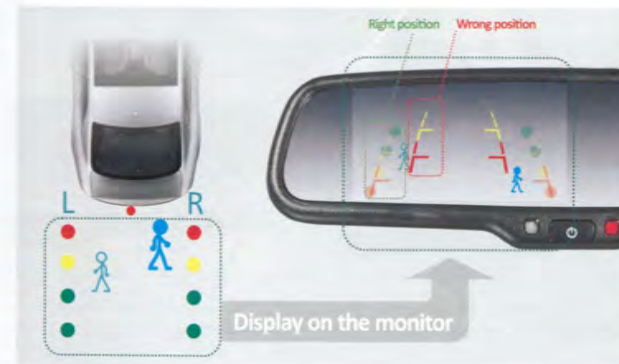

Press the button to choose the L or R adjustable guideline

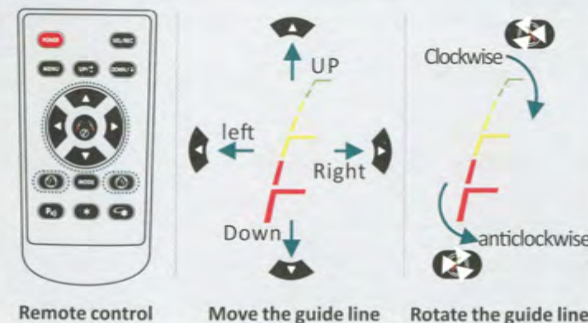

Remote control

Move the guide line

Rotate the guide line

## 9 Automatic brightness adjustment



When ambient light is weak, the screen will automatically reduce the brightness and get better for watching

When ambient light is strong, the screen will automatically increase the brightness and get better for watching

## 10 Auto dimming

The auto-dimming of our mirror works automatically when you start the engine, and the indicator will light up. The light sensor in the back of the rearview mirror detects the ambient light. When night falls and the ambient light is weak, auto-dimming starts to work and automatically dims to eliminate.

the glare of rearward-approaching vehicles. Hence it protects drivers from high beam glare and avoiding car accident.



the light sensor from the back of mirror detects the ambient light

front light sensor detects the light from rearward-approaching vehicles.



Video input: short press to turn on/off auto-dimming  
long press to turn on/off the screen.  
Camera input: adjust brightness of screen

## 11 Digital compass calibration

This compass can be calibrated by driving your vehicle in several complete circles. A quick guide is stated as below. If the vehicle's compass headings become inaccurate, the compass can be manually calibrated by:

1. Press the **MENU** three times enter into "SETTING" menu, and press **SEL/REC** button to choose the "ANGLE". you can press **DOWN/↓** **UP/↑** to adjust the angle.

Please visit: <http://magnetic-declination.com/> to find out the compass angle of your area or conference 11-1

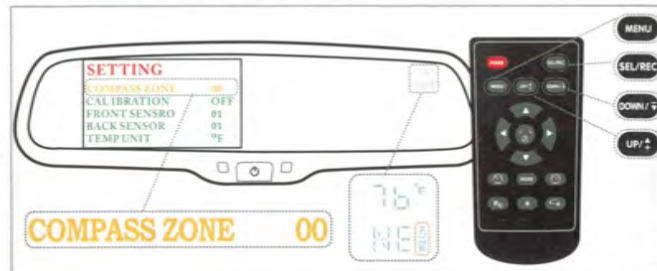

2. Press **SEL/REC** to select the "CALIBRATION", the default mode is "OFF", press **DOWN/↓** **UP/↑**, select the "AUTO"

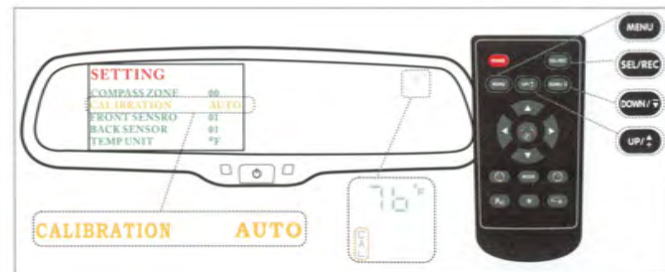

3. Drive your vehicle in at least 2 circles' counterclockwise, allowing 45 seconds to complete one circle

4. For best calibration, keep your circle radius close to 5 meters and speed less than 10km/h.

5. Press **SEL/REC** to select the "CALIBRATION", press **DOWN/↓** **UP/↑**, select the "OFF"

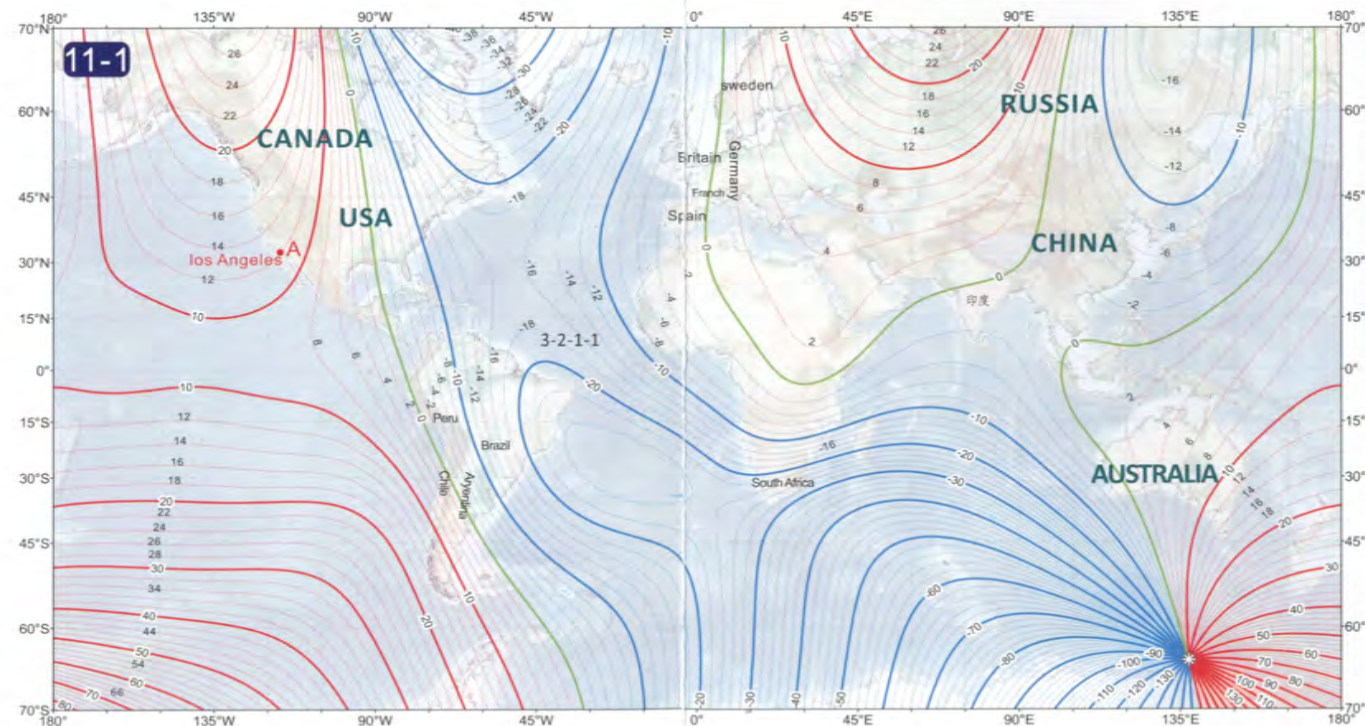
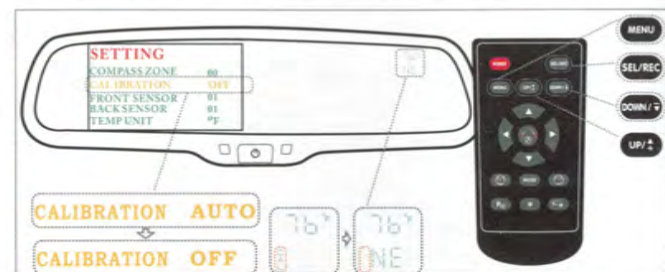

## 12 Temperature

### 12.1 How to change Temperature Unit

Press the **MENU** enter into "SETTING" menu, and press **SEL/REC** button to choose the "TEMP UNIT", press **DOWN/↓** **UP/↑** you can switch  $^{\circ}\text{F}$  to  $^{\circ}\text{C}$ .

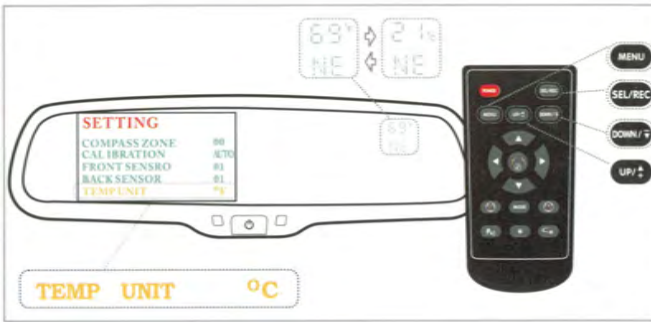

### 12.2 Temperature sensor installation

Locate the temperature sensor between the front of the radiator and the front bumper. Locate edge of sheet metal or plastic shield, and slide metal clip over edge until secure.

Sensor should be in the flowing of fresh air. Do not locate it next to a heated engine part.



the temperature of Engine should not make any sense to the temperature sensor if it install on this position

## OE-STYLED REAR VIEW MIRROR MONITOR WITH AUTO-DIMMING COMPASS & TEMPERATURE



**BOYO**<sup>®</sup>  
VISION  
◆ VTM43TCA