

Compact Rear-View Wi-Fi APP Camera with Dual Mounting Options

VTX400W

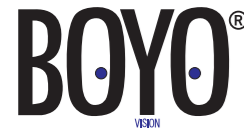

User's Manual

1. Parts list



A Rearview Camera × 1



B License Plate Bracket × 1



C Power Cable × 1



D Mounting Hardware × 1



E 3M Mounting tape × 1



F User's Manual × 1

2. Preparations

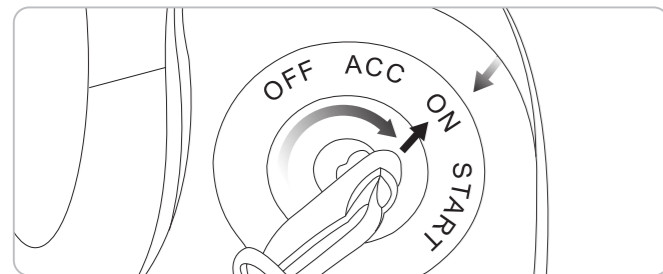

① Turn the key to the "ON" position and make sure the power of the car is on.

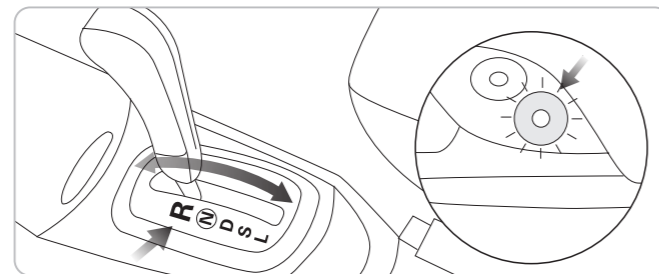

② Put the car in reverse gear and make sure that the backup lights are working

3. Camera Installation for Fast Start Mode

The camera will turn on within 2-3 seconds when you put the vehicle into reverse in Fast Start Mode.

NOTE: Installing in Fast Start Mode may have an effect on the battery life if you stop driving your vehicle for 3 weeks or more.

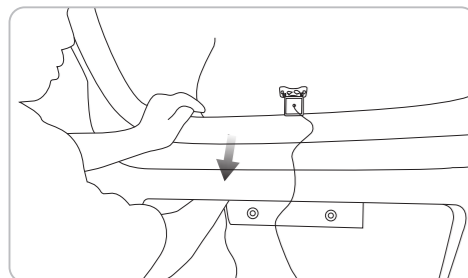

① Pull the camera power cable into the trunk of the vehicle

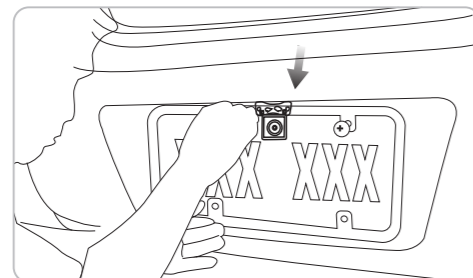

② Mount the camera onto the rear of the vehicle with the mounting tape and supplied screws

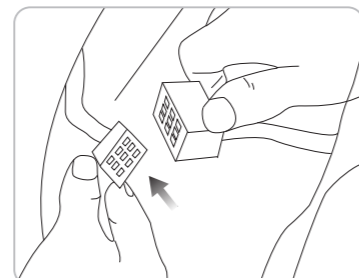

③ Locate the reverse light harness in the trunk. Disconnect the harness.

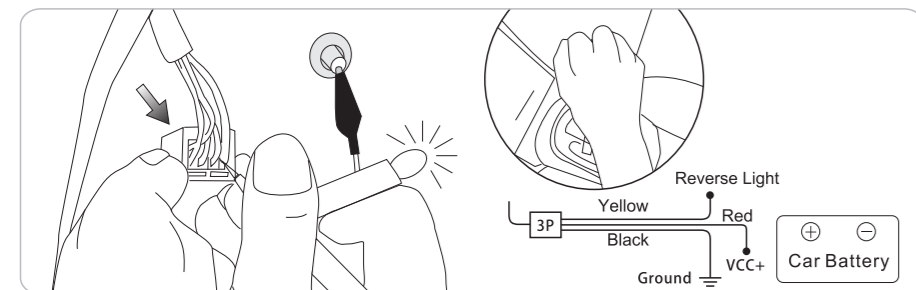

④ Locate the vehicle battery power wire; turn off the ignition and this wire should still be energized. Connect the camera VCC+ wire to the vehicle battery power wire.

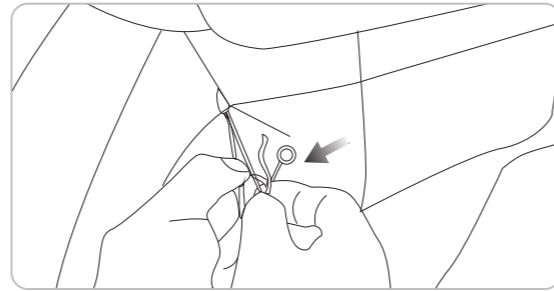

⑤ Locate the vehicle reverse light wire. Put the transmission into reverse, this wire should be energized when the ignition is on and the transmission is in reverse. Connect the camera reverse wire to the vehicle reverse light wire.

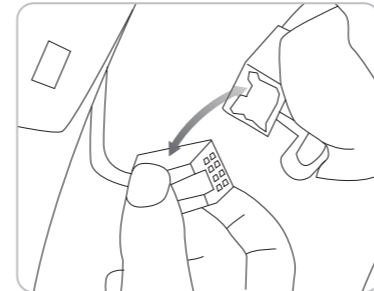

⑥ Reconnect the reverse light wire harness.

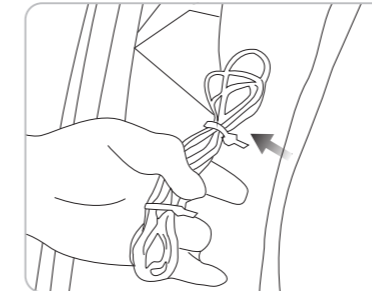

⑦ Bundle up and secure excess cable.

4. Camera Installation for Standard Mode

The camera will turn on within 10 seconds when you put the vehicle into reverse in Standard Mode.

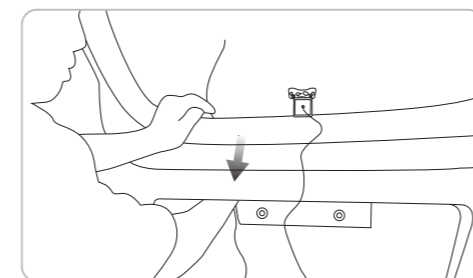

① Pull the camera power cable into the trunk of the vehicle

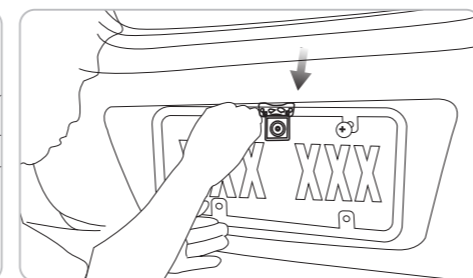

② Mount the camera onto the rear of the vehicle with the mounting tape and supplied screws

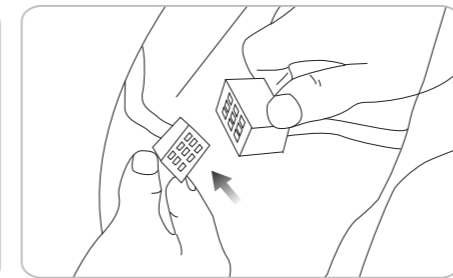

③ Locate the reverse light harness in the trunk. Disconnect the harness.

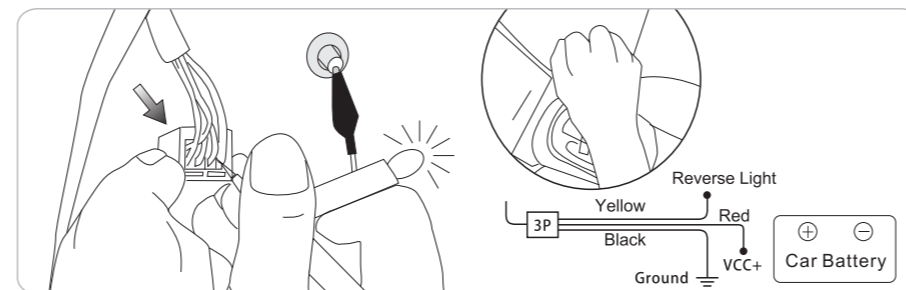

④ Connect the camera VCC+ wire to the vehicle ignition switch wire.

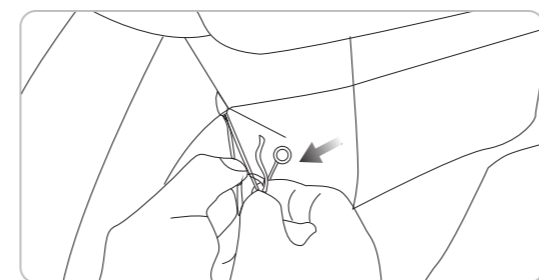

⑤ Locate the reverse light wire; put the transmission into reverse, this wire should be energized when the ignition is on and transmission is in reverse. Connect the camera reverse wire to the vehicle reverse light wire

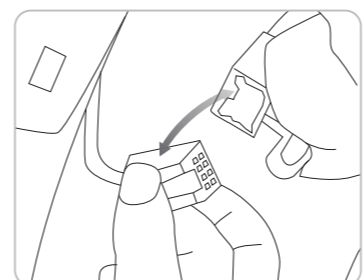

⑥ Reconnect the reverse light wire harness.

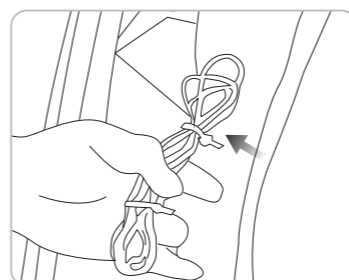

⑦ Bundle up and secure excess cable.

5. Android Phone Connection

Download the BOYO VIEW Application in the Play Store

*NOTE: The camera must be powered up in order to connect to WiFi in the Android settings. Open the phone settings → Choose WiFi → Connect to "BOYOCAM-XXXXXXXXXXXX"

Open Boyo View App

WiFi indicator in the App will switch to GREEN when the camera is connected to the phone.

The Boyo View App will auto pop up when the vehicle transmission is put into reverse.

Go to Settings
→ Applications manager → Boyo View

