

Wayne-Dalton Corp. • Ellyson Industrial Park • 3395 Addison Dr. • Pensacola, FL 32514
Customer Service • 800-305-4349 • 800-676-7734 option 3 • FAX 800-471-2129

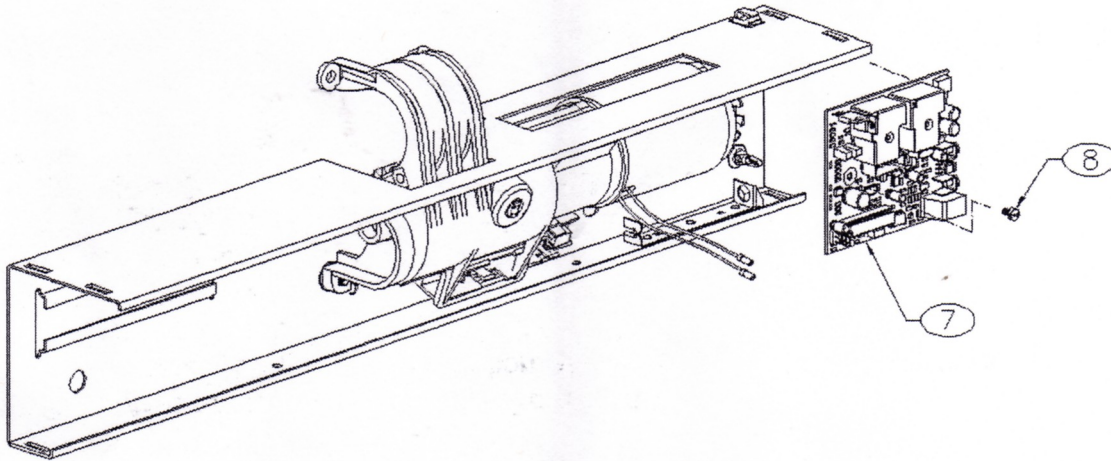

CAUTION! DISCONNECT LIGHT FIXTURE AC POWER PLUG FROM OUTLET FIRST

1. Remove left end cap and disconnect battery
2. Remove the interface cable and right end cap
3. Remove lag screw and lag screw cover holding front cover and slide cover off to the left
4. Remove Molex connector (4 wires) from center of circuit board
5. Remove the three wire potentiometer wire harness from the circuit board
6. Remove screw (8) then with needle nose pliers, squeeze the top of the nylon standoffs on the right side off the board while pulling up on the circuit board
7. Install new circuit board carefully aligning the nylon standoffs through the corresponding holes in the circuit board
8. Install screw (8) back through the circuit board, the easiest way is to use a ¼" nut driver
9. Plug Molex connector back into circuit board
10. Reconnect the three wire potentiometer cable onto the circuit board
11. Reconnect interface cable and right end cap
12. Slide front cover back on carefully aligning the grooves in the cover with the DoorMaster chassis
13. Being careful not to go at an angle, reinstall lag screw and lag screw cover, **DO NOT OVERTIGHTEN LAG SCREW**, just snug is fine
14. Reconnect the battery pack
15. Replace left end cap

Run install routine twice, first with door closed, then with door fully open

- Run install routine by inserting the programming tool or a bent open paper clip into the Wall station center hole for ½ a second.