

Instructions For The *i*drive™ TorqueMaster™ Motor Cover Replacement

⚠ WARNING: HAZARDOUS VOLTAGE. IF THIS PROCEDURE IS BEING DONE ON AN *i*drive OPENER THAT IS INSTALLED ON A DOOR, DISCONNECT ELECTRIC POWER TO THE OPENER BEFORE REMOVING ANY COVER FROM THE OPENER. UNPLUG FLEXIBLE POWER CORD AT THE OPENER INLET CONNECTOR OR AT THE ELECTRICAL OUTLET. IF THE OPENER IS DIRECTLY WIRED TO HOUSE WIRING, DISCONNECT ELECTRIC POWER AT THE HOUSE FUSE/BREAKER BOX.

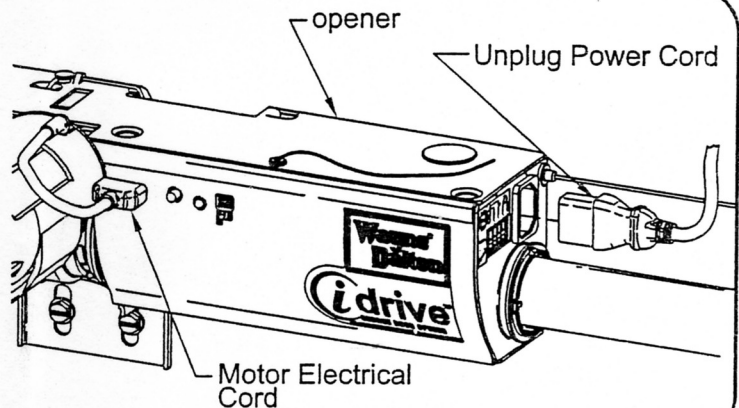

If the *i*drive opener is installed on a door, pull emergency disconnect to raise motor and remove the lock arm for easier access to socket cap screws. Using a 3mm hex key, loosen and remove the (2) socket cap screws holding the motor cover to the motor. Set the screws aside. You will reuse them.

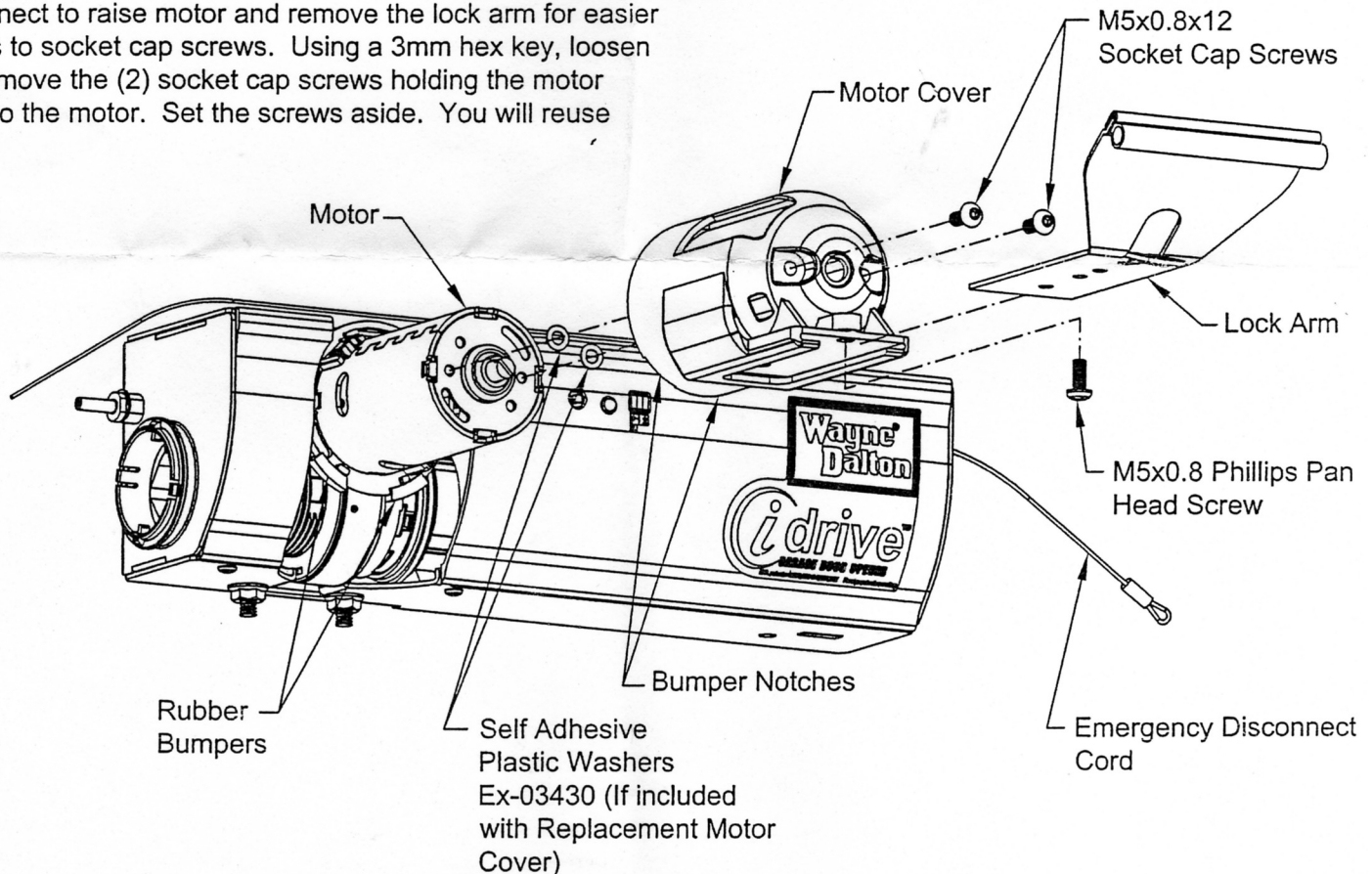

Pull cover off the back end of the motor to remove. Leave rubber bumpers in place on the motor flange. If the replacement motor cover includes two plastic washers: peel washers from backing paper and affix to the motor, centering the washers on the two threaded holes that attach the cover. Pressure must be applied to the washers against the motor for the pressure sensitive adhesive to adhere. Assemble new motor cover by aligning slot in the cover with motor electrical cord. Align rubber bumpers with notches in the cover. Assemble two socket cap screws and tighten (8-10 in-lb). Assemble lock arm to new motor cover. Reconnect power to opener and release emergency disconnect.