



Instructions

Medicine Ball Rack

WARNING

- Prior to assembly, remove the components from the box and verify that all the listed parts were supplied.
- Please make sure all bolts, nuts and washers are tightly fastened.
- Please refer to diagram for installation.
- The unit should only be used on a level surface and is intended for indoor use only.

BODY SPORT SELLS THIS PRODUCT AS-IS AND MAKES NO WARRANTY, EXPRESS OR IMPLIED, INCLUDING, WITHOUT LIMITATION, ANY IMPLIED WARRANTY OF MERCHANTABILITY OR FITNESS FOR A PARTICULAR PURPOSE, ALL SUCH WARRANTIES BEING HEREBY EXPRESSLY EXCLUDED.

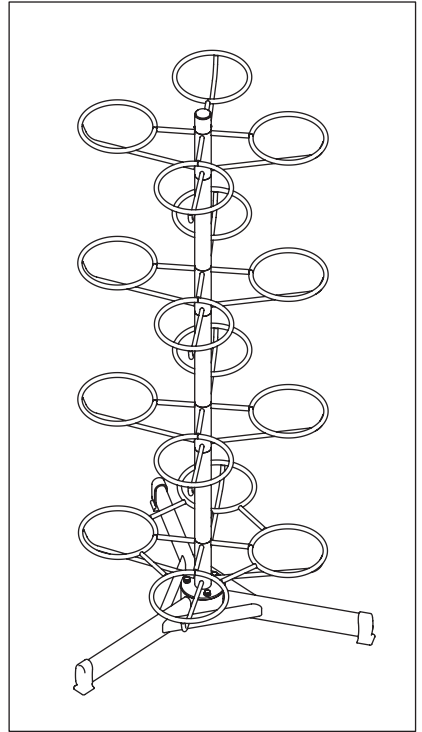
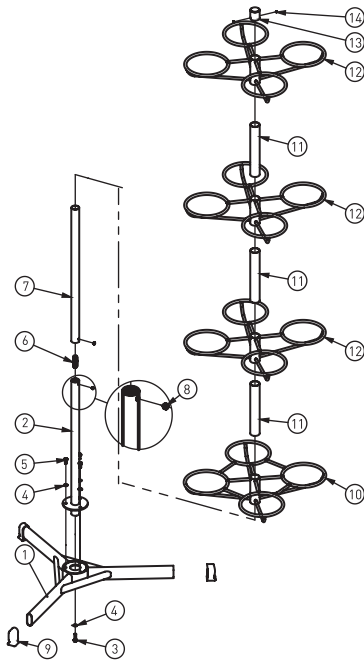

No.	Item Description	Quantity
1	Base	1
2	Inner Lower Support Tube	1
3	M10 x 30mm Bolt (Preassembled)	1
4	M10 Washers (Preassembled)	4
5	M10 x 20mm Bolts (Preassembled)	3
6	Double Locking Pin (Preassembled)	1
7	Inner Upper Support Tube	1
8	M10 x 10mm Locking Screws (Preassembled)	2
9	Feet (Preassembled)	3
10	Lower Rack	1
11	Outside Rack Tubes	3
12	Upper Racks	3
13	Top Cap	1
14	M6 x 5mm Locking Screws (Preassembled)	2