

Don't immerse it into the water. You'd better not use it in the rainy day.

Please clean the product with dry cloth.

Don't let your dog catch or bite the product.

When the electricity of the batteries in the receiver is not enough, please charge them in time.

We strongly suggest that you should charge the batteries with the charger we offer.

Don't disassemble the product , the damage caused by it isn't in our warranty scope.

If the dog feels uncomfortable when wearing the collar, you can take it off for a while, and use it again when the dog calms down.

The temperature the product can be used in is between 2 and 45 centigrade. Beyond or below this temperature range will damage the product , and this kind of damage isn't in the warranty scope.

The product can only be used on the healthy dogs. If the dog has had physical or mental problems , please turn to the professional veterinarians first.



Receiver: 3.7V 120ma LiP

Made in China

#### Important Notice:

If you find the spray collar can't spray after you use it for a while, please don't worry and please follow the instructions to check.

1. Please take out the bottle from the unit and check whether it's empty and need to refill. If needed, please release the air from the bottle first and then refill the bottle.
2. If you don't need to refill, then take out the bottle from the unit and wait for at least half hour and then reinstall the bottle back to the right position.

The spray should work properly.

Petainer®



## Anti Bark Spray Collar

## Prepare to use

### Charge the Spray Collar

1. Connect the charger connector to the charging jack.
2. Plug the charger into a standard outlet.
3. The 3 led lights will be flashing one by one.
4. Charge the Collar Receiver at least 4 hours for the first charge.
5. After fully charged, the first red LED light will keep lighting.
6. After charging is completed, replace the rubber cover.

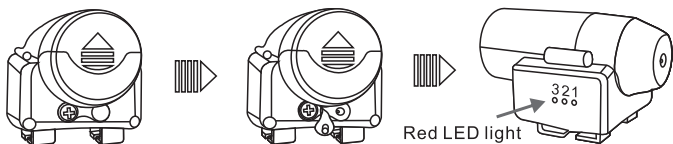

### Install the Storage Bottle

1. Open the storage cover by pushing according to the direction.
2. Insert the bottle to the right position, please refer to the picture.
3. Install the cover back.

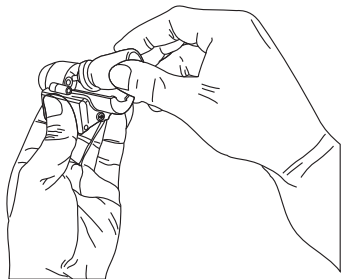
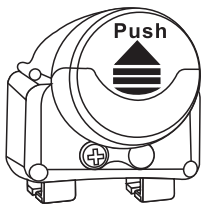

## Turn on/Off the Spray Collar

1. Move the head of the black cover of the storage bottle to the position( see picture) and hold for 3 seconds.
2. The first LED light will keep flashing until the Magnetic switch will be turned on/off.
3. when it's turned on, it's in the working modes.



## Change the sensitivity of the Spray collar – 3 levels

To fit the different dogs, this Spray collar is designed to be able to adjust the sensitivity of the bark

1. There are three indicator lights near the power switch.
2. When the power is connected, only one indicator light is lights, at that time the bark sensitivity is the highest( the weaker bark also can cause the burst of spray.)

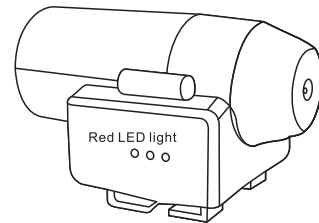

3. Approaching the black cover to the indicator light once time (don't keep over 3 seconds, or the Spray collar will treat it as a shutdown order.), the number of indicator light getting light varies. If one indicator light is on, it means the bark sensitivity is the highest. When it comes two, it means the bark sensitivity is in the middle, and three indicator lights are on, showing that the bark sensitivity is at the lowest level (only the stronger bark can cause the burst of spray).

### Important Notice:

The product isn't a toy, don't let the children use it, and don't use it casually. Before using the product, make sure your dog is healthy.