

# Data sheet - Splendide Washer and Dryer (120V)

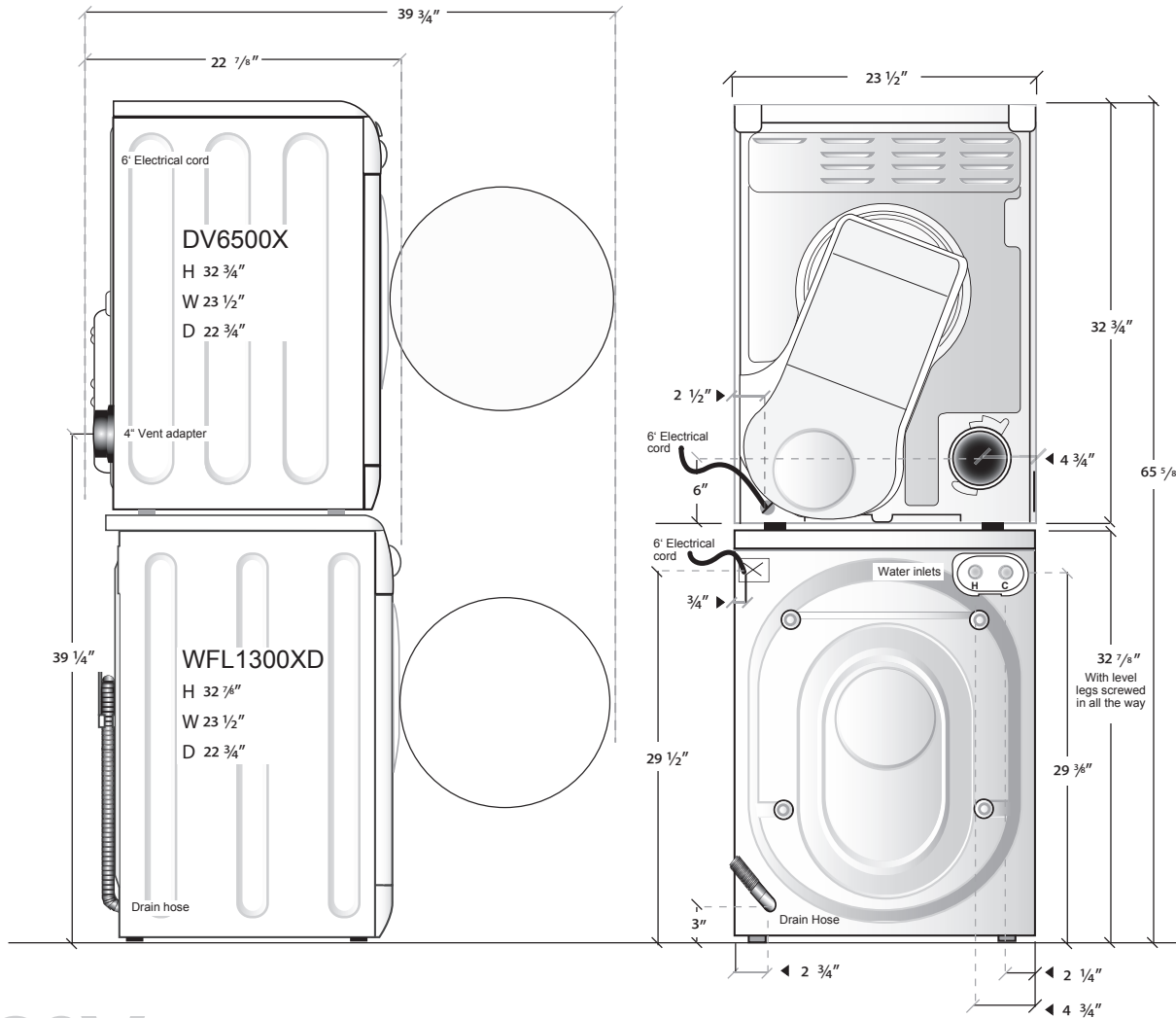

### Min. cutout dimensions

**NOTE:** Allow space for easy servicing and removal. Always refer to installation instructions that come with the units for complete instructions.

### Suggested shelf installation

**TIP:** When installing the dryer on a shelf above the washer, leave space behind the shelf (or leave an access hole) so the dryer ducting can be connected before the washer is slid into its final installation location (see NOTE, left)

\*6" has been added to this dimension for easy access to water shut-off valves.  
\*\* Min. dimension shown. Dimension may increase depending on standpipe location.

### Included with WFL1300XD washer

- 2 Water inlet hoses
- Electrical conn.
- Flexible drain hose (5' length)
- Drain hose u-clamp

Optional accessories	RV/Marine installation accessories
<ul style="list-style-type: none"> <li>PI22 Drain-A-Way pan</li> <li>154187104A Faucet adapter kit</li> <li>1005 All-natural HE laundry powder</li> </ul>	<ul style="list-style-type: none"> <li>VID403A/AC deluxe vent kit</li> <li>MK01 SecureFit brackets</li> <li>SK02 RV/Marine stack kit</li> <li>VI490D 90° dryer vent elbow</li> </ul>

# 120V

**Product model numbers**  
**WFL1300XD Front-loading Washer**    **DV6500X 120V Dryer**

- ### Installation location requirements
- Recessed area, closet, or alcove.
  - Solid, level floor. Must support 280 lbs. min.
  - Towable trailer/watercraft: position over axles/midship. Block in to prevent extreme movement.

- ### Min. clearances (from case)
- WFL1300XD:** 0" sides, 1" front/back  
**DV6500X:** Standard 1/2" top, 3/4" sides/rear/front (alternative - 4" top, 0" sides, 3/4" rear/front)  
 NOTE: Allow additional clearances for easy maintenance and removal

- ### Electrical requirements
- WFL1300XD:** 120V/60Hz/460W/6amp\*  
**DV6500X:** 120V/60Hz/12amp\*  
 (\*15amp separate circuit recommended)

- ### Standpipe Drain System Req:
- Min 1 1/4" diameter standpipe with 7 GPM carry-away capacity
  - Distance from bottom of washer to top of standpipe: 25" min./34" max.
  - Min. distance from bottom of washer case to outlet end of drain hose: 20"
  - Air break required to avoid siphoning

- ### Dryer exhaust requirements:
- DO NOT exhaust into chimney, furnace, cold air duct, attic, crawl space, or another duct used for venting
  - Two, 72 square-inch ventilation openings req. if using a closet door. Louvered doors with equiv. air openings are acceptable. Allow clearance for knobs, buttons, cabinet moldings, etc.
  - Rigid or flexible metallic duct required (not included). Ducting must slope downwards and away from the machine.



Never reuse data sheets. Data sheets are subject to change without notice. Never use data sheets for final installation criteria. For complete installation information, refer to the owners manual that comes with the unit (also available upon request).