

YAMAHA R1 2009 - 2014 DIY WINDSCREEN INSTALL

Installation Instructions for Yamaha R1 2009 - 2014

Thank you for purchasing Zero Gravity's windscreen, (a screen which has been designed and manufactured to give years of safe & fun riding.) These instructions give you an in-depth look at the installation process. To receive further assistance or parts please call Zero Gravity® Sales Department at 805-388-8803 or E-mail at salesinfo@zerogravity-racing.com.

PLEASE READ BEFORE INSTALLING YOUR WINDSCREEN

Helpful hints: Use metric tools, clean hands, put the bike on a stand. Do not pry on the screen excessively, as it can break without much warning.

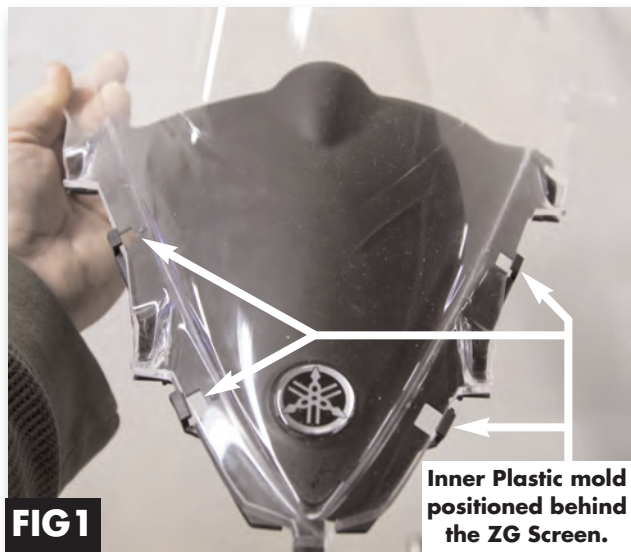

FIG1

Inner Plastic mold positioned behind the ZG Screen.

Fig 1. Remove both mirrors. Locate both fasteners in the inside fairing. Once you remove the mirrors the factory screen can be removed by sliding back and pulled up slightly. **For 2012 - 2014 install:** OEM windscreens have an inner plastic mold attached to the screen (as shown above). Carefully remove it and attach to Zero Gravity screen as shown in **Fig 1**.



FIG2

Grab & Pull up fairing

Fig 2. Start by inserting the windscreen from one side. To slide in, grab and pull up on the upper fairing as shown above. Rotate the mirror rubber gasket to align the side windscreen humps. Repeat for the other side. **For 2012 - 2014 install Tip:** The trick to keeping the two plastic units together, is to not flex the windscreen during the process.

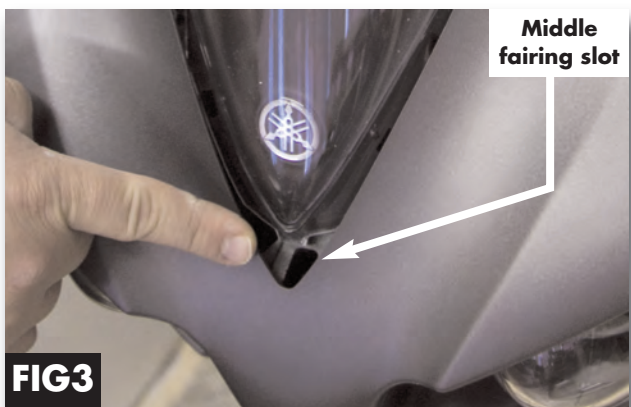

FIG3

Middle fairing slot

Fig 3. Locate the middle fairing slot at the bottom of the windscreen. Insert windscreen into this slot for positive retention.

For 2012 - 2014 install: Both the windscreen & inner plastic mold must insert into this slot for positive retention.

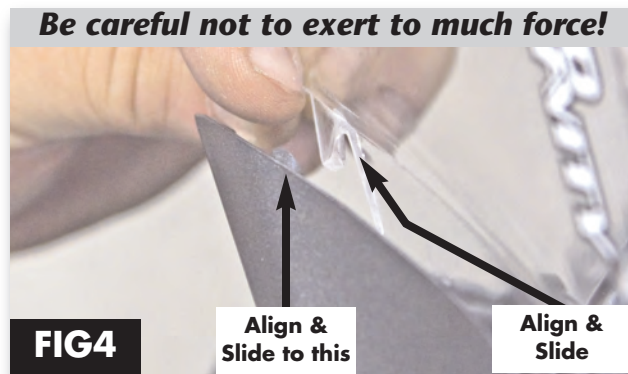

FIG4

Align & Slide to this

Align & Slide

Fig 4. To finish the installation process, align and slide the U-hooks located upper fairing corners, into their respective slot by applying light pressure.

Be careful not to exert too much force!

Check alignment then install side mirrors to finish.

