

QOD GOLF BUGGY OPERATING MANUAL

- Model Q1 – Electric Push Buggy
- Model Q2 – Full Directional Remote control



Manufactured by QOD GOLF INT'L - Australia, Distributed by QOD
GOLF USA

Warning: Product Patent Protected, Design Protected, Copyright Protected. All Rights Reserved.

version 13 Jan 2022

WELCOME TO TEAM QOD.

QOD stands for “Quality Of Design.”

We pronounce it [Quad], as in four-wheeled, but some prefer to call it “Q” “O” “D” and that’s ok too!

Thank you for joining our team. Not long ago we were just like you, golfers who wanted to find a better way to enjoy the walk.

Although it will take several rounds to get comfortable operating the QOD, we hope you will find it helps provide a much more enjoyable way to play the game we all love.

Should you ever need any assistance we will always do our best to give you the service you deserve, as quickly as possible.

Please note that pictures in the manuals are for illustration purposes. All caddies operate along the same theme, but later releases may have differences in appearance because of regular updates. An example is All-terrain wheel, or small wheels in the compact version.

Caddies are known as Caddy, Buggy, Trolley, Trundler and carts around the world.

**Manufactured by QOD GOLF INT’L - Australia, Distributed by QOD
GOLF USA**

Warning: Product Patent Protected, Design Protected, Copyright Protected. All Rights Reserved.



BEFORE YOU CONTINUE . . .

- **Please Note: In order for the terms of the warranty to be valid, the manufacturer requires that you register your caddy and battery on our website within (30) thirty days of receiving your QOD, and by doing so, you acknowledge that you have read and understand the operating manual and the safety precautions contained herein.**

www.qodgolf.com/Warranty

- Caddy/Buggy serial numbers can be found on the front-side of the center spine of the caddy, below the large nut.

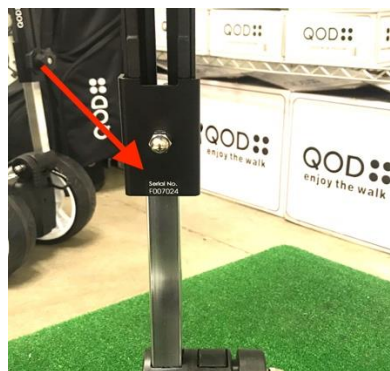

Manufactured by QOD GOLF INT'L - Australia, Distributed by QOD GOLF USA

Warning: Product Patent Protected, Design Protected, Copyright Protected. All Rights Reserved.

- Battery serial numbers can be found by unzipping the battery cover and looking to the far right of the back of the battery. You'll need the last nine digits on the right, underneath the barcode.



**Manufactured by QOD GOLF INT'L - Australia, Distributed by QOD
GOLF USA**

Warning: Product Patent Protected, Design Protected, Copyright Protected. All Rights Reserved.

TABLE OF CONTENTS

MINI MISER LITHIUM BATTERY & CHARGER	6
<i>Charging Procedure</i>	<i>7</i>
CADDY/Buggy SET UP & FOLDING	8
ATTACHING ACCESSORIES	10
<i>Drink Holder</i>	<i>10</i>
<i>Phone Holder.....</i>	<i>10</i>
<i>Scorecard Holder.....</i>	<i>11</i>
<i>Umbrella Holder.....</i>	<i>12</i>
<i>Storage Pouch</i>	<i>12</i>
BATTERY FITTING	13
SECURING GOLF BAG TO CADDY	14
ADJUSTING STRAPS OF BAG	15
ADJUSTING HEIGHT OF BAG	16
OPERATION	16
Single Motor Q1	17
Dual Motor Directional Remote control Q2.....	20
Remote Control Handset Operation Q2.....	23
MANEUVERABILITY	23
TRANSPORTING YOUR QOD.....	24
MAINTENANCE	25
ADJUSTING ALIGNMENT	26
TROUBLESHOOTING.....	23
<i>No Power or Intermittent Power</i>	<i>23</i>
CADDY SPECIFICATIONS	28
DISCLAIMER.....	29

Manufactured by QOD GOLF INT'L - Australia, Distributed by QOD
GOLF USA

Warning: Product Patent Protected, Design Protected, Copyright Protected. All Rights Reserved.

MINI MISER LITHIUM BATTERY AND CHARGER:

Depending on your cart you are supplied with one of two types of batteries:

1. Compact Caddies with Smaller wheels , 14.4v batteries to drive the cart faster to match up with the carts with All Terrain Wheels.
2. All Terrain carts with Larger Wheels , 12.8v batteries so that the cart is not overpowered and therefore too fast at lower speeds.



BATTERY SPECS: 18aH 14.4 Volts.

CHARGER SPECS: 110/240 volts, 50-60 Hz 100VA AC, 16.8 volts, 4 Amps DC

BATTERY SPECS: 18aH 12.8 Volts. Has Indicator Guage and USB ChargingBank

CHARGER SPECS: 110/240 volts, 50-60 Hz 100VA AC, 16.8 volts, 4 Amps DC

SAFETY WARNING: The battery and charger are well designed with proper safety measures in place, as with any lithium-ion battery, please handle with care and use common sense. Do not drop, puncture, or disassemble the battery for any reason. Should the battery be damaged, please do not use and call us immediately for assistance at (800) 774-1088 or +61 2 99062777.

PLEASE NOTE: Currently these batteries are forbidden on all commercial airlines.

Manufactured by QOD GOLF INT'L - Australia, Distributed by QOD
GOLF USA

Warning: Product Patent Protected, Design Protected, Copyright Protected. All Rights Reserved.

Charging Procedure:

- You will need to charge your battery prior to first use. This may take up to 8 hours for the first charge, but the amount of time will decrease on subsequent charges.
- Charge the battery in any standard outlet that is not shared with another device. If your socket has an on/off switch, turn it off until you plug the charger into the wall.
- Connect the battery to the charger before plugging the charger into the wall. When finished charging, disconnect the charger from the wall before disconnecting the battery from the charger.
- A red light appears on the charger while charging and will blink green OR be solid green upon completion. The 14.4v battery does not have any lights on it, the 12.8v battery has capacity indicator lights. These lights are indicative of battery power Two green lights and a red light indicate the capacity is well over 50% charge. This means more significant than 13 volts in the battery. One green and one red means less than 13 volts but greater than 12 volts. One red means the battery is below 12 volts and in urgent need of charging. Flashing red light on the Buggy "T" handle means that the battery is very low and cannot power the buggy.
- Once the charger light blinks or is solid green, you may disconnect and use the battery. If you are not available to disconnect the battery right away, that is completely fine, just disconnect from the power supply whenever you can.
- If you don't play for a couple of weeks, plug the battery back in before you play, if it is blinking green or solid green, you are good to go, if it is red, let it charge until it blinks green again.

IMPORTANT

- **Never use any charger with this battery other than the Miser supplied to you.**
- **Always recharge after each use until the charger light blinks green or is solid green. There is no memory in the battery so you will not "waste charges" by keeping it charged.**
- **Always charge and store in a cool, dry place. Do not leave in a hot car or freezing garage, or store on a cold-concrete floor, or room prone to heat and moisture.**
- **If you plan on not using your battery for more than a month, charge your battery for approximately two hours and then disconnect from the wall and store in a cool, dry environment. Set a calendar reminder to charge for about two hours once a month to ensure the longevity of your battery. It does not have to be exactly one month, or**

Manufactured by QOD GOLF INT'L - Australia, Distributed by QOD
GOLF USA

Warning: Product Patent Protected, Design Protected, Copyright Protected. All Rights Reserved.

exactly two hours, this is just a general guideline. The battery will last longer when stored over long periods of time with approximately 50% of a charge prior to storing.

- If you connect the charger to the battery and plug into wall and the light is solid green, it means the battery is already at capacity and does not need to be charged.
- If you are having issues getting power to your cart, please refer to trouble shooting steps further below in the manual or call us for assistance.

CADDY SET-UP AND FOLDING

It will take time before these steps become second-nature to you, we recommend following along with the videos at qodgolf.com , Select "Current Customers " tab on the right , then go into setup on the left which has opening and closing videos.

Step 1: Stand next to the folded caddy with the handle bar/control panel facing to your left. On the top of the right side of the caddy, lift up on the small black plastic lever, then lift the hand bar and extend it out to your right until it is pointed in the direction of 2 o'clock. Then close down the same lever, locking it in place.



Step 2: On your left, find the other small black plastic lever and lift it upwards to release it. Then lift the handle bar upwards until the spine of the caddy is vertical and pointed at 12 o'clock. Close down the same lever, locking it in place.



Manufactured by QOD GOLF INT'L - Australia, Distributed by QOD GOLF USA

Warning: Product Patent Protected, Design Protected, Copyright Protected. All Rights Reserved.

Step 3: Find the rotating locking knob located in the center of the vertical spine and loosen it by rotating it to the left, extend the spine upwards to its maximum height and then rotate the knob back to the right, which locks it into place. (The height of the spine is not adjustable, it is designed to lock in the same position each time.)



Step 4: On the base of the QOD, find the U-shaped piece and lift it and extend it to the right. Then place one hand on the spine of the QOD to your left, and use your right hand to gently lift the front of the QOD off of the ground, and extend the front wheels away from the spine (to your right).

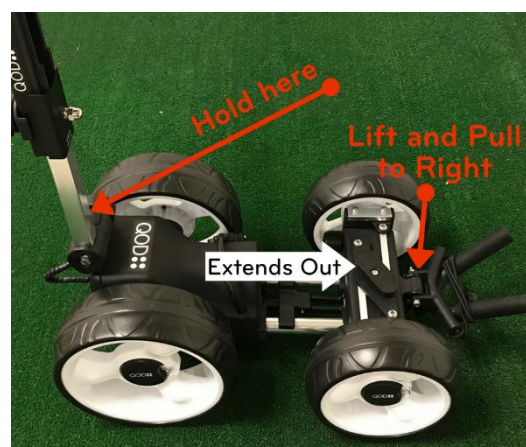

Step 5: Find the centre of the front section between the two front wheels and place one hand on the plastic piece that holds the centre-most screw. Lift the front wheels off the ground, and rotate the plastic piece in between the wheels counter-clockwise to start the extension of the front wheels away from each other. Once started, you can then fully extend the wheels by using one hand on each front wheel and continuing to push away from each other until they lock into place.

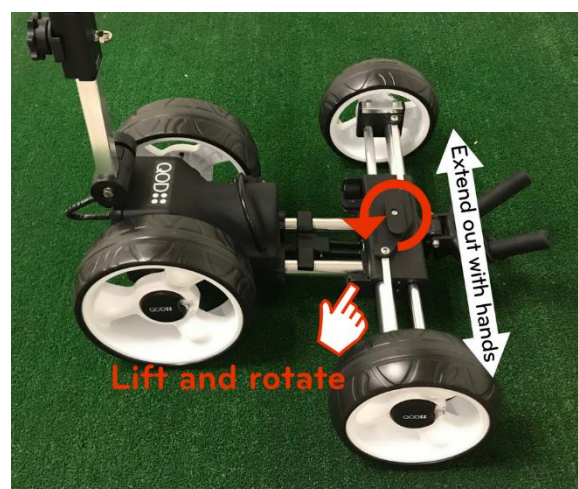

Manufactured by QOD GOLF INT'L - Australia, Distributed by QOD GOLF USA

Warning: Product Patent Protected, Design Protected, Copyright Protected. All Rights Reserved.

Step 6: Prior to placing your bag on the caddy, on the front-bottom section of the QOD, you need to separate the upper plastic support bracket (with bungee straps) from the U-shaped bottom bag holder.



ATTACHING ACCESSORIES

All of the accessories on the QOD are designed to remain attached once assembled. The storage pouch can easily slide off to make folding and stowing the QOD easier.

- **Drink Holder:** The drink holder is designed to sit on the main spine of the cart, in the small plastic bracket to your left, when you are behind the handle bar.



- **Phone Holder**
 - If you ordered an umbrella holder, attach that first.
 - Remove the peg from box and slide into the slot on end of the bracket below the right handle. It will be a snug fit!
 - Slide the phone holder onto this peg. If you need a more secure fit, you can add one of the rubber strips provided.
 - Instructions for adjusting the phone holder itself can be found on the box. The outside knob locks the arms in place, while the inside knob adjusts their width.



Manufactured by QOD GOLF INT'L - Australia, Distributed by QOD GOLF USA

Warning: Product Patent Protected, Design Protected, Copyright Protected. All Rights Reserved.

- **Scorecard Holder**

- **If you have an umbrella holder attach the scorecard holder like this . . .**

- You must attach the umbrella holder first
- Place the scorecard holder on the left side of the QOD just below the umbrella holder. While looking underneath the holder, align the two holes over the two small brass holes on the left side of the QOD handle.
- Remove and insert both of the screws taped underneath the holder.
- The pencil slot can be gently bent manually to fit the size of your pencil.



- **If you don't have an umbrella holder attach the scorecard holder like this . . .**

- (Optional) Apply double-sided tape underneath the scorecard holder slot.
- Place the scorecard holder on the left side of the QOD, just below the bracket below the handle bar. While looking underneath the scorecard holder, align the innermost hole with the brass hole on the bracket.
- Remove one of the screws taped underneath the scorecard holder and insert and secure into this hole. You will only use one screw.
- The pencil slot can be gently bent manually to fit the size of your pencil.



Manufactured by QOD GOLF INT'L - Australia, Distributed by QOD GOLF USA

Warning: Product Patent Protected, Design Protected, Copyright Protected. All Rights Reserved.

○ Umbrella Holder

- Tools: Phillips Screwdriver, 10mm socket (OR pliers/wrench).
- Remove screw from top of accessory bracket on handle bar, then remove second screw above it. You no longer need these.
- Look through the holes to make sure the cable is not blocking the holes. If it is, use a tee to move the cable to one side.
- Remove the two screws inserted in the umbrella holder bracket. You will use these again in the last step.
- Lock the umbrella holder in an upright position. While standing behind the caddy, slide the umbrella holder from left to right over the two empty holes. It is a tight fit.
- Insert stainless screw through the top hole and insert other screw from the bottom. Then tighten both.

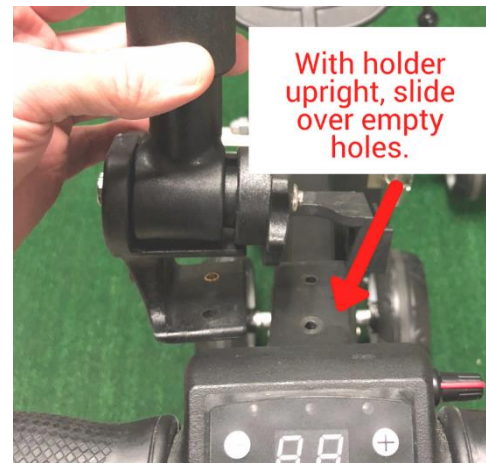
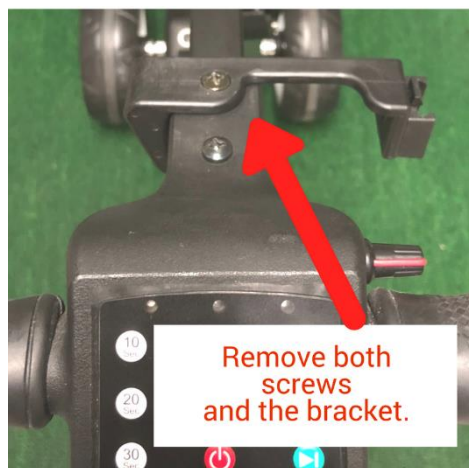

○ Storage Pouch



Manufactured by QOD GOLF INT'L - Australia, Distributed by QOD GOLF USA

Warning: Product Patent Protected, Design Protected, Copyright Protected. All Rights Reserved.

Battery Fitting

Step 1: The battery sits in the center of the caddy, directly on top of the aluminium tubes and plastic extension arm.



Step 2: The battery is plugged into the caddy using the cable connected to the caddy. We often refer to this as the "T-Cable."

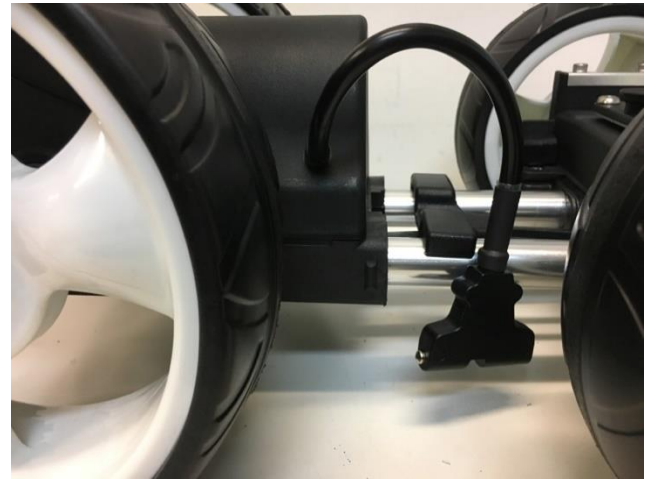

Step 3: Place the battery in the cradle with the connection port facing the rear of the caddy. Connect the cable to the battery with the + symbol on T-cable facing the direction of the red cap on the battery. NOTE: If you try this the wrong way, the battery will reject the cable, so if it is difficult to connect, twist the cable to attach it using the opposite side of cable.



Manufactured by QOD GOLF INT'L - Australia, Distributed by QOD GOLF USA

Warning: Product Patent Protected, Design Protected, Copyright Protected. All Rights Reserved.

SECURING GOLF BAG TO THE CADDY

- The QOD will work with nearly every type of golf bag available from major manufacturers, however it will perform best with a bag the industry calls a “Lightweight Cart Bag”.
- Prior to placing your bag on the caddy, displace the weight of the contents of your bag as evenly as possible on both sides of the bag. This will improve the caddy’s stability and alignment.
- Separate the U-shaped lower bag holder from the support bracket just above it (which has the bungee straps extending from it). **See Photo #1**
- Tilt the upper bag holder upwards and extend the arms away from each other. **See Photo #2**

Photo #1



Photo #2



- Place your golf bag in the center of the bag holders with your pockets facing outwards. Make sure the base of your bag is as far back as it can go in the lower bag holder, and lift and extend the bungee straps around the bottom of your bag, securing them by pushing one knob through the loop of the opposite bungee strap. Then grab the bungee cords from your upper bag holder and extend them around the top of your bag. Depending on the style of your bag,

Manufactured by QOD GOLF INT’L - Australia, Distributed by QOD GOLF USA

Warning: Product Patent Protected, Design Protected, Copyright Protected. All Rights Reserved.

you may want to loop the cords through a strap on the bag, and then again you will push one plastic ball of one side of the bungee through the loop of the other bungee strap.



ADJUSTING STRAPS OF BAG

- The bungee straps on the top bag holder can be adjusted by moving the loop of the strap where it connects to the side of the plastic arm cradle in either direction. To do this, we recommend using a flathead screwdriver or a golf tee to pry the bungee strap off of its retaining peg and push it back onto a different peg.
- The bottom bag holder bungee straps can be shortened by making a loop with each cord and then feeding the ball back through that loop before pushing the ball through the loop of the cord on the opposite side.
- If the strap is still too loose for your bag, you can also loop both ends through a strap on your bag, and then loop around the same strap one more time to effectively shorten the bungee straps and increase the tension.

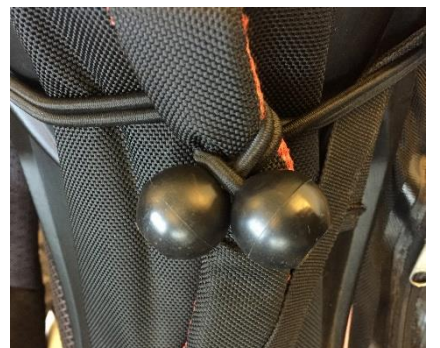

Manufactured by QOD GOLF INT'L - Australia, Distributed by QOD GOLF USA

Warning: Product Patent Protected, Design Protected, Copyright Protected. All Rights Reserved.

- If these straps are too short or tight to fit around your bag, we recommend purchasing a small carabiner clip online or from a hardware store.

ADJUSTING HEIGHT OF BAG

If your bag sits too high or too low, you can make small adjustments that will allow for a minimal change in height.

- If your bag sits too high, you can lower the bottom bag support by removing the bolt located underneath the U-shaped lower bag support.
- If your bag sits too low, you can replace the rubber sleeves on the U-shape lower bag support with standard bicycle grips with extra thick rubber. The thickness of the rubber will increase the height of where the bag sits.
- You can also add a second nut to the bolt located underneath the U-shaped bottom bag support. To do this, remove the bolt, and add a second nut to the bolt-head side of the bolt, then re-insert the bolt through the plastic hole and secure it with the original nut. You can then use the new nut to adjust the height of the bolt to dictate how high or low the bottom bag support is when it hits the front suspension base of the QOD.



**Manufactured by QOD GOLF INT'L - Australia, Distributed by QOD
GOLF USA**

Warning: Product Patent Protected, Design Protected, Copyright Protected. All Rights Reserved.

OPERATION - Single Motor Caddy - QOD Q1 Series

Control Panel: The control panel is designed to be easy to understand and simple to use. The only thing you must be aware of is that if you are not using the potentiometer knob, you want to leave that in the "off" position, which is rolled back towards you. If you are using the potentiometer knob, then only use the knob and don't intermittently use the + or - buttons.

Battery Power Lights:

- When all three lights are illuminated (Green, Yellow, Red) you have at least 50% power remaining in battery.
- When only the Yellow and Red Lights are on, you have between 45% and 10% of your battery life remaining.
- When only the red light is illuminated, you have less than 10% of battery life remaining and will soon run out of power.



Timed-Advance Function:

Press the :10, :20, or :30 button and the caddy will travel a timed distance on its own and stop at the end of the timer. After using this feature a few times you will get an idea of how far the caddy travels with each timed interval.



Manufactured by QOD GOLF INT'L - Australia, Distributed by QOD GOLF USA

Warning: Product Patent Protected, Design Protected, Copyright Protected. All Rights Reserved.

Power On/Off:

Press and hold the red power button to turn the caddy on, and to turn it off. Once the caddy is powered on, you may leave it on for your entire round of golf. If you take an extended brake during your round, you can power it down to conserve battery life.

**Potentiometer Knob:**

Rolling the knob forwards or backwards will adjust your speed setting. You can use this as an alternative to + or – button. To stop the caddy, roll the knob all the way backwards.

**Do not leave knob rotated forward in the ON position while using + or – buttons as that will send mixed signals to the controller.*

**Speed Settings:**

Use the + or – buttons to adjust your speed between any one of the nine speed settings.

**Do not use + or – buttons while potentiometer knob is in ON position.*



Manufactured by QOD GOLF INT'L - Australia, Distributed by QOD GOLF USA

Warning: Product Patent Protected, Design Protected, Copyright Protected. All Rights Reserved.

Start and Stop Button:

Rest your thumb on the button and press to either start or stop the caddy. If the last speed setting is at 0, the caddy will not start until you hit the + button.

This will be the case after using the timed-advance function as the speed always ends up back at 0.



Manufactured by QOD GOLF INT'L - Australia, Distributed by QOD GOLF USA

Warning: Product Patent Protected, Design Protected, Copyright Protected. All Rights Reserved.

OPERATION - Remote Control Caddy - QOD Q2 Series

Control Panel: The control panel is designed to be easy to understand and simple to use. The only thing you must be aware of is that if you are not using the potentiometer knob, you want to leave that in the "off" position, which is rolled back towards you. If you are using the potentiometer knob, then only use the knob and don't intermittently use the knob and the Remote Control buttons.

Battery Power Lights:

- When all three lights are illuminated (Green, Yellow, Red) you have at least 50% power remaining in battery.
- When only the Yellow and Red Lights are on, you have between 45% and 10% of your battery life remaining.
- When only the red light is illuminated, you have less than 10% of battery life remaining and will soon run out of power.



Timed-Advance Function:

Press the :10, :20, or :30 button and the caddy will travel a timed distance on its own and stop at the end of the timer. After using this feature a few times you will get an idea of how far the caddy travels with each timed interval.



Manufactured by QOD GOLF INT'L - Australia, Distributed by QOD GOLF USA

Warning: Product Patent Protected, Design Protected, Copyright Protected. All Rights Reserved.

Power On/Off:

Press and hold the red power button to turn the caddy on, and to turn it off. Once the caddy is powered on, you may leave it on for your entire round of golf. If you take an extended brake during your round, you can power it down to conserve battery life.

**Potentiometer Knob:**

Rolling the knob forwards or backwards will adjust your speed setting. You can use this as an alternative to + or – button. To stop the caddy, roll the knob all the way backwards.

**Do not leave knob rotated forward in the ON position while using + or – buttons as that will send mixed signals to the controller.*

**Speed Settings:**

Use the Hand Held Remote Control or the Potentiometer on the Right to adjust your speed between any one of the nine speed settings.

**Do not use the hand held remote while potentiometer knob is in ON position.*



Manufactured by QOD GOLF INT'L - Australia, Distributed by QOD GOLF USA

Warning: Product Patent Protected, Design Protected, Copyright Protected. All Rights Reserved.

Start and Stop Button:

Rest your thumb on the button and press to either start or stop the caddy. If the last speed setting is at 0, the caddy will not start until you use the Potentiometer or remote control.

This will be the case after using the timed-advance function as the speed always ends up back at 0.



Manufactured by QOD GOLF INT'L - Australia, Distributed by QOD GOLF USA

Warning: Product Patent Protected, Design Protected, Copyright Protected. All Rights Reserved.

Remote Control handset Operation

Ensure that when you are using the remote control facility the Potentiometer for manual control has been turned to the off position .

IMPORTANT SAFETY NOTES for the remote control :

Your QOD Remote Control Buggy has an automatic shut-down feature to help prevent "run-away." When operating the buggy remotely, if it does not receive a signal from the Remote-Control after the last button push for approximately 40 to 50 seconds, it will assume the Buggy has lost contact and stopped automatically. If this happens, push any button on the remote control to resume operation.

If you are using the Remote Control and walking close behind the buggy be aware that the buggy will stop if it does not receive a signal in 40 to 50 seconds, be careful not to walk into the buggy.

While the maximum range for your QOD Buggy to receive a signal from your Remote-Control is 80-100 meters; this range is in perfect "laboratory" conditions. We recommend that you operate your QOD buggy at a maximum of 20-30 meters. This recommendation will help prevent any signal interference and loss of control.

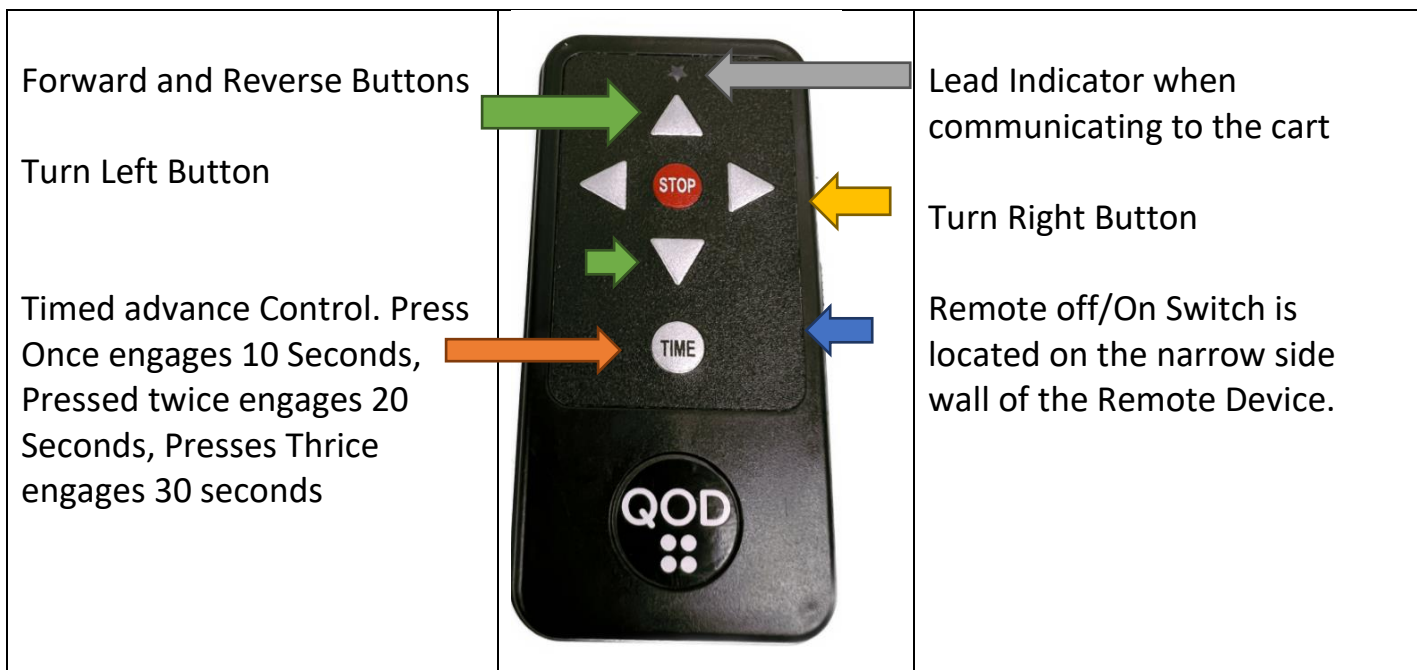

Manufactured by QOD GOLF INT'L - Australia, Distributed by QOD GOLF USA

Warning: Product Patent Protected, Design Protected, Copyright Protected. All Rights Reserved.

POWER Switch: This is positioned on the side wall of the handheld remote device. Slide the switch up to turn on the remote-control device and slide down to turn off.

When you are not actively operating your Caddy, It is recommended to turn the Remote Control off. This will avoid accidental button pushes when not paying attention to your Caddy.

Remote Control Communication Signals

LED Light: Lights up when Remote Control is turned on and a button is pushed. This indicates that the remote is sending a signal to the Caddy.

STOPPING: Pressing the Centre Stop button on the Remote Control Handset stops the buggy.

GOING FORWARD: Pressing the UP BUTTON while the Caddy is standing still will start the Caddy in forward motion. Each push of the UP BUTTON will increase the Caddy's forward speed one level. Your Caddy has 9 forward speeds. Pushing the DOWN BUTTON will lower the forward speed one level. Once the Forward Speed reaches Zero Pressing the Down Button will begin to Reverse the Buggy.

REVERSING Each press of the Down Button increases the reversing speed by one notch until a speed of 9 is reached.

TURNING RIGHT: Press and hold the RIGHT BUTTON and the Caddy will turn to the right (from a stop and while in motion) until the button is released.

TURNING LEFT: Press and hold the LEFT BUTTON and the Caddy will turn to the left (from a stop and while in motion) until the button is released.

**Manufactured by QOD GOLF INT'L - Australia, Distributed by QOD
GOLF USA**

Warning: Product Patent Protected, Design Protected, Copyright Protected. All Rights Reserved.

MANEUVERABILITY

It will take several rounds before you get comfortable operating your QOD on the course in all conditions. We don't recommend playing in an important golf tournament or match for your first few rounds using the QOD.

The Q2 Remote Control Caddy has full braking capability . Using dual motor the Remote Caddy operates with fixed wheels. In Order to turn the buggy We stop one wheel and speed up the opposite wheel.

Manual operation of the Q1 and Q2 is similar except for the braking system on Q2.

- To steer your QOD left or right, simply push down on the handle to slightly raise the front wheels off the ground and steer left or right. The narrow rear wheel base allows for easy maneuverability.
- When traversing over inclines, declines and side hills, it is important to **ALWAYS** keep a hand on the QOD. The QOD is powerful enough to climb any hill you put in front of it, however at a certain degree of incline or side slope, gravity will take over and the cart will want to tip back or on its side.
- The QOD does not have a braking mechanism other than your hands. Depending on the thickness of grass you are walking on and the severity of the slope, gravity will eventually have more pull down a hill than the gear will provide as resistance. This is one of the trade-offs of having a caddy that always operates in “free-wheel” mode.
- The QOD does not have a parking brake so when you park your QOD on a hill, simply turn it across the slope wherever you stop. Because the QOD has four wheels and a soft suspension system in the front wheels, it will settle into the terrain more so than a standard push cart which is designed to have as little friction as possible.
- Your QOD is always in “free-wheel” mode without having to change or disengage anything. If you are in the parking lot, tight spots on the course, around the green, or you happen to forget to charge your battery, you will always be able to push or pull your QOD freely forwards or backwards.
- When going up onto a raised area of grass with a cart-path curb, you can lean the cart backwards and place the front wheels on the higher level, and then guide the rear wheels over the curb by lifting the handle bar, and if necessary, using your foot to help

**Manufactured by QOD GOLF INT'L - Australia, Distributed by QOD
GOLF USA**

Warning: Product Patent Protected, Design Protected, Copyright Protected. All Rights Reserved.

lift the rear-end onto the higher level. Some golfers prefer to turn around and pull the caddy up onto the higher ground instead, this is a personal preference.

IMPORTANT!

- **Never catch a ride in a riding cart and pull your QOD alongside of you. Even though QOD operates in freewheel mode, the gear is still engaged with the motor, so moving the wheels faster than intended using the built-in controller will put unnecessary stress on all of the parts.**
- **When dropping down from a higher level of ground onto lower terrain, like coming off of or onto a cart path curb, do not let the caddy land hard on its bottom. Support the caddy with your hands so that the front wheels gently hit the ground first and then with your hands still supporting some of the weight of the caddy in rear, gently let the rear wheels touch down behind the front wheels.**

TRANSPORTING YOUR QOD

- Always be sure to completely fold your QOD, and lock all three levers on the QOD prior to transporting in a moving vehicle.
- The wheels do not “lock” and therefore you need to secure the caddy in a position or part of the car where it will not roll.
- We highly recommend using a crate or bag like the Clean Trunk Carry Bag accessory we have in order to keep your QOD stationary and protected from scratches and debris.
- Never leave your battery in the car, always take it indoors when returning home. Exposing the battery to extreme temperatures can cause damage and will shorten the lifespan. Batteries not properly stored will not be covered under warranty.

IMPORTANT

- **Never leave your battery in a hot or freezing cold car for any time longer than it takes to drive to the course and back. Doing so will significantly reduce the lifespan of the battery and this will not be covered under warranty.**
- **Always take the battery inside and recharge and store in a cool, dry, environment.**

Manufactured by QOD GOLF INT'L - Australia, Distributed by QOD
GOLF USA

Warning: Product Patent Protected, Design Protected, Copyright Protected. All Rights Reserved.

MAINTENANCE

The more you take care of your QOD, the more it will take care of you. Many of the repair requests we receive for the QOD stem from issues caused during transport, reckless use on the course, and not taking the time to keep the cart clean, lubricated, and tightened.

- Take two minutes at the end of every round to wipe down the wheels and body of the QOD with a golf towel or damp cloth.
- If dirt, mud, or grass builds up along the ends of the sliding tubes, you can pick away the debris with a golf tee. If necessary, you can wipe the entire tube off with a towel, but remember you are also wiping off the lubricant. Therefore, if you do this, we recommend re-lubricating the tubes with a “synthetic grease” in either a spray or gel form. DO NOT USE WD-40 as it will ultimately make the tubes even more dry.
- If you find any of the locking levers or knuckles becoming loose, you can tighten them as necessary. Each lever is spring loaded and has a 13mm bolt, with a 13mm nut on the opposite side, and a 14mm Dome cap nut securing it in place on the outside.
- Secure the bolt head in place with one wrench, then loosen the dome cap nut on the opposite side. Then, adjust the nut inside of the dome cap nut to either tighten it or loosen it to your preferred tension level. Then tighten the dome cap nut against the inside nut and you are good to go.
- If either the top bag support or lower bag support become loose at any time, you can also easily tighten these by securing the bolt head on one side and tightening the nut on the other.
- If you find dirt or debris stuck in between the wheels and the caddy body, you can easily take the wheels off to clean the axle peg and the wheels bearings. Simply compress the metallic pin extending out from the wheel hub caps and pull the wheel off its axle. When finished, simply compress the pin again and push it back onto the axle until you heard the pin click into place onto the axle.
- If you find your wheels getting “sticky” or loud over time, you can remove the wheels and add a lubricant like WD-40 to the bearings to make the wheels turn more smoothly and quietly.

**Manufactured by QOD GOLF INT’L - Australia, Distributed by QOD
GOLF USA**

Warning: Product Patent Protected, Design Protected, Copyright Protected. All Rights Reserved.

IMPORTANT!

- **Never use WD-40 as a lubricant on the tubular axle shafts as this compound will ultimately leave the tubes drier and “stickier” than when they first started. If you want to re-lubricate the sliding tubes, you can clean dry with a rag, and then apply a spray or get “synthetic lubricant.”**
- **Never power-wash your caddy. Spraying the caddy with any kind of water pressure may cause water to enter the main housing of the caddy and short-circuit the electrical components. To clean your QOD, simply wipe down with a wet cloth or golf towel.**

ADJUSTING THE ALIGNMENT ON YOUR QOD

[WWW.QODGOLF.COM/ALIGNMENT](http://www.QODGOLF.COM/ALIGNMENT)

All of the caddies are aligned prior to being shipped, however with the many different styles, sizes, and weights of golf bags on the market, your QOD may require an alignment adjustment to ensure it is tracking straight. Also note, that the slope of the terrain will impact the caddy’s ability to track straight, so naturally when you are on a slope or uneven ground, the caddy will trend in the direction that the ground dictates.

The first step in diagnosing your alignment issues is to make sure that you have both sides of your golf bag as equally weighted as possible. Meaning you do not want to keep a couple of water bottles on one side of the bag, and only have a light jacket in the other. Try to disperse the weight of the items in your bag evenly on both sides of your bag.

After doing this, check the alignment of your caddy again, if you are still having issues, please continue below.

**Manufactured by QOD GOLF INT’L - Australia, Distributed by QOD
GOLF USA**

Warning: Product Patent Protected, Design Protected, Copyright Protected. All Rights Reserved.

STEP 1: Gently place the caddy on its back by leaning it back and laying the back of your handle bar on the ground.

STEP 2: Loosen the four nuts/bolts on the bottom bracket of the front wheel extension using an adjustable wrench or 10mm socket. Pliers will also work if necessary.

STEP 3: Using a Phillips screwdriver, turn tracking screw clockwise to make your caddy steer more to the left. Turn the screw counter-clockwise to make your caddy steer more to the right.

STEP 4: After making an adjustment, stand the caddy upright and test your alignment again. If you need to make an additional adjustment please do so.

STEP 5: Once you are satisfied with the tracking, lay the caddy back and tighten the four original nuts and bolts.

IMPORTANT!

Always test your alignment with your bag on the caddy as the weight of the bag will affect its direction.

Clean any debris around the tracking screw to ensure that it adjusts smoothly.

Tighten the nuts and bolts so they are secure, but do not tighten more than necessary.

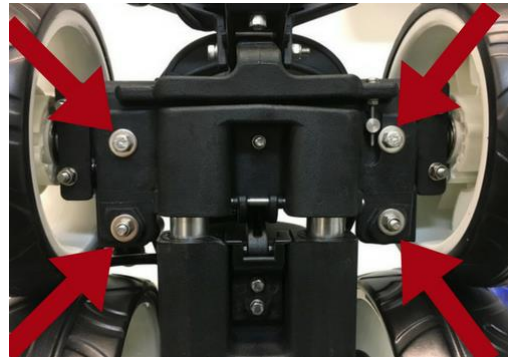

Manufactured by QOD GOLF INT'L - Australia, Distributed by QOD GOLF USA

Warning: Product Patent Protected, Design Protected, Copyright Protected. All Rights Reserved.

CADDY SPECIFICATIONS:

Drive Train/Transmission	Type: Power Polymer Gear, Steel Worm Drive, with 25:1 Gear Ratio Rate
Weight	Net Weight Caddy: Approx. 11.9 kg (26.2 lbs)
Speed	Approximately 7.2 km (4.5 mi)
Distance/Range	20 km (12.43 mi) / 18-36 Holes
Maximum Load	25 kg (55.12 lbs)
Climbing Ability	20 degrees
USB Power Output	+5v
Construction	Aluminium, Stainless Steel, Zinc-Plated Steel and Nylon 66
Dimensions	Folded: 45(L) x 37.5(W) x 33.5(H) cm 17.71(L) x 14.76(W) x 13.189(H) in Full(cm) 65(L) x 63(W) x Adjustable to 95(H) Full (in) 25.5(L) x 24.8(W) x 37.4(H) in

Manufactured by QOD GOLF INT'L - Australia, Distributed by QOD GOLF USA

Warning: Product Patent Protected, Design Protected, Copyright Protected. All Rights Reserved.

Customer Service and Technical Support Assistance

Email QOD Factory and Engineering at teamqod@godgolf.com

You may also email any of the following:

collin@godgolf.com - CEO and Principal Designer

teamqod@godgolfusa.com - United States of America

Please provide the following information:

- contact telephone number , time zone if in the USA
- your email address to respond to
- your Caddy Serial Number if an existing customer

**Manufactured by QOD GOLF INT'L - Australia, Distributed by QOD
GOLF USA**

Warning: Product Patent Protected, Design Protected, Copyright Protected. All Rights Reserved.

Warning

QOD Golf International Limited, Eagle Compac EU SARL and Oceania Lifestyle Distribution (and its associated companies) strictly enforce protection of their products, and legal enforcement will be made upon infringement on their protected areas mandatorily. The products have received design, copyright and patent protection internationally, including the following countries: European Countries, USA, Canada, China, Australia and Australasia.

As of the high-product exposure, this is an acknowledgement that the product purchased will be safe and free from any infringement type on all QOD Golf International products.

QOD Golf International product designs are exclusive property of their respective authors, and must not be reproduced or used without their express consent, and any partial or total reproduction of the content is strictly prohibited.

Copyright Protection – QOD Golf International, Eagle Compac SARL and Oceania Lifestyle Distribution (and its associated companies) individually or collectively are the exclusive owner of all right, title and interest, including all intellectual property rights.

Design Protection – The holder of a registered design right has the exclusive right to authorize or prohibit others from using the design in any way, notably by producing, importing, selling or using products based on the design.

Patent Protection – Covers the ornamental design for an object having practical utility. An object with a design that is substantially similar to the design claimed in a design patent cannot be made, used, copied or imported. The copy does not have to be exact for the patent to be infringed. It only needs to be substantially similar.

By breaching any of the copyright, patent and design protection, QOD Golf International will withhold the rights to enforce legal action at that time.

**Manufactured by QOD GOLF INT'L - Australia, Distributed by QOD
GOLF USA**

Warning: Product Patent Protected, Design Protected, Copyright Protected. All Rights Reserved.