



DataCart™ Secure Tab Setup

Purpose:

The purpose of this document is to explain how to setup the Secure Tab to your tablet.

Tools Needed:

- Philips Screw Driver
- 11/32 Wrench or Pliers

Setup Steps:

- Using the lock key, unlock the top clamp
- Move clamp up
- Using a Philips Screwdriver – Loosen the (4) Philips Screws holding the adjustable arms
- Move Arms to desired width and height placement, then tighten screws

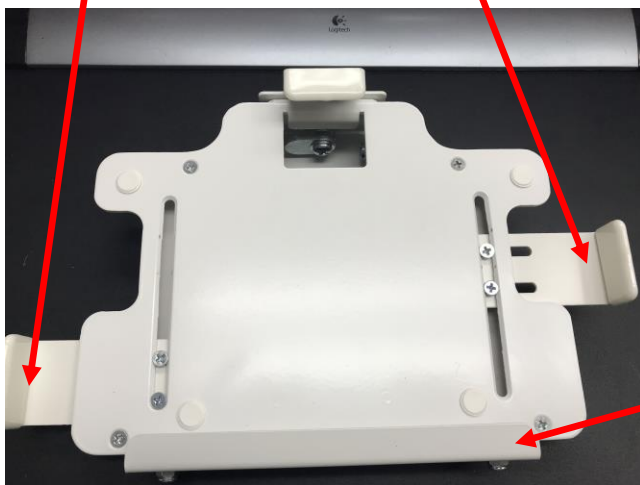
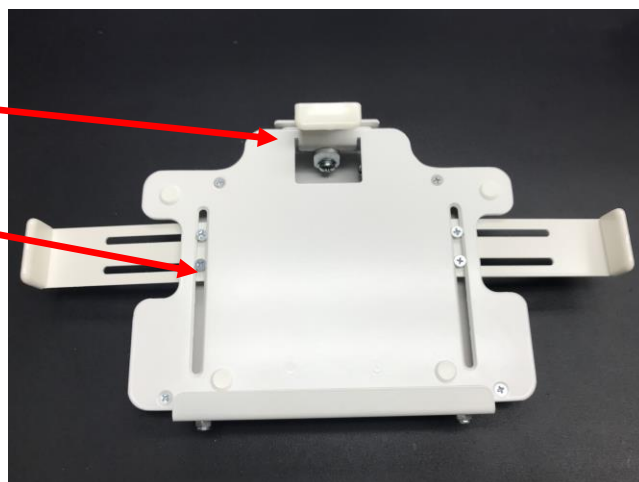

- Using the Philips Screwdriver and 11/32 Wrench, loosen the screws to adjust the bottom plate. After loosening, adjust the bottom plate to desired depth.

- Insert tablet and close the upper clamp.

Maximum Secure Tab Dimensions:

14.0" W x 8.75" H x 1.0" D