

five easy steps to naturally simple growing.

Congratulations on joining the Urbotanica gardening community. Your UrbiPod garden is simple to set up and maintain, there's just a few steps to complete and get you growing. So let's get started.

UrbiPod contents

- 4 x Pods
- 4 x False floor
- 4 x Short wicks (inserted in False floor)
- 4 x Long wicks (inserted in UrbiPod base)
- 4 x Round wicking discs
- 1 x Power adapter (inserted)
- 1 x Water bottle inserted into bottle holder & tower.
- 1 x Adjustable LED light halo fitted to tower
- 1 x Reservoir base with fitted tower

Starter Kit contents

- 1 x 250ml Nutrient bottle
- 1 x Coir pack
- 4 x Seed packs

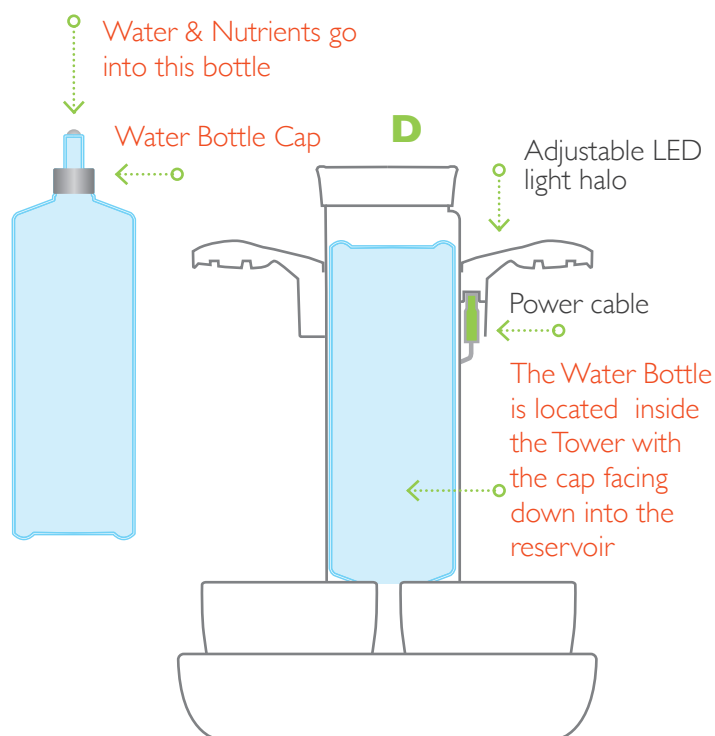
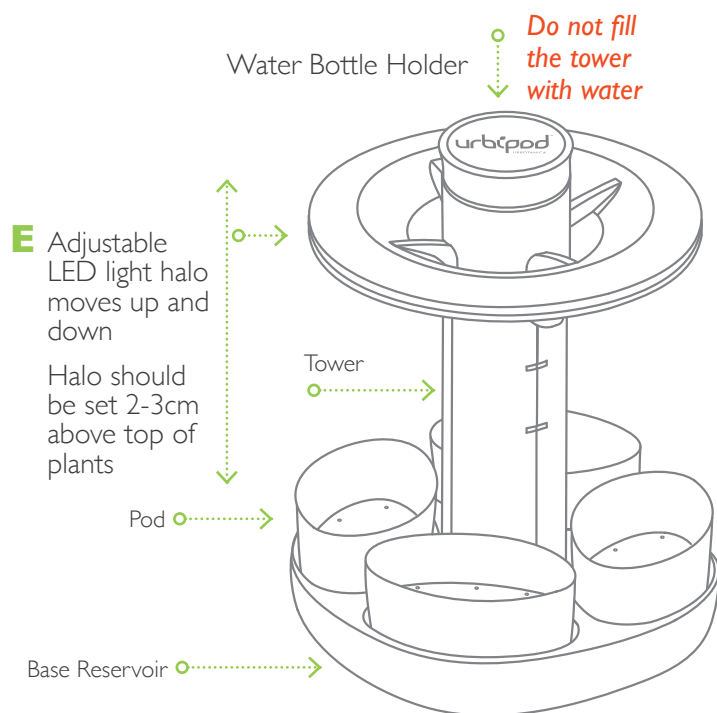

On-line set-up tips

Go to <https://www.urbotanica.com/pages/technical-stuff> for more easy instructional set up video and great growing tips.

Go to our YouTube channel
www.youtube.com/channel/UCbKSgxbWRh4Lkt9IWW7V2A

Need help?

- 1: Go to the contact us page at [urbotanica.com](https://www.urbotanica.com) and complete the form.
- 2: Go to the technical stuff page for tips and instructions.
- 3: Go to our YouTube channel <https://www.youtube.com/channel/UCbKSgxbWRh4Lkt9IWW7V2A>

Distributed by:
URBOTANICA™, Suite 13, 50
Oxford Close West Leederville WA
6007, Australia
GYO Solutions ABN 30 600 879 856

1. Set up the wicking system in each Pod.

- **A:** Make sure the short wick (already inserted into the false floor) is pushed in so as to leave 1-2 mm above the false floor.
- **B:** Place the oval shaped false floor inside the Pod, resting on the grooves inside the Pod. Ensure the central recess is facing up.
- **C:** See the round section on that false floor? Place the round wicking disc onto it, making sure the short wick and round wick disc are touching. This is important for drawing water to the plants.
The round wicking disc will not sit flush this is normal
- Repeat for all four pods and then insert each pod into the UrbiPod base.

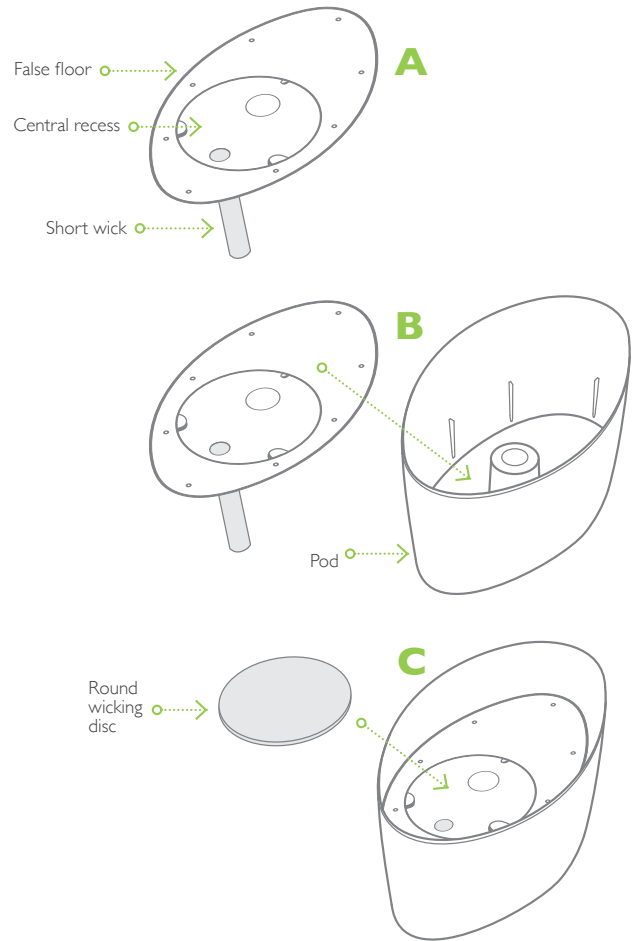

2. Coir

- Unwrap Coir discs with indent holes facing up and place one into the Pod, covering the round wicking disc.
- Slowly pour about 400ml of water evenly into the indent holes in the Coir disc – do not over water or pour too fast – this may cause spillage. If spillage does occur, don't worry it will be confined to the Pod recess and you can clean it with a sponge or cloth. Do the same for the other 3 Pods.
- Wait until the water is absorbed and the Coir disc expands to the top of the Pod and loosen the Coir to ready for seeding. The Coir disc may over expand or expand unevenly. We recommend to leave about a 10mm clearance to the top of the Pod, excess Coir can be easily removed and discarded.

3. Filling the UrbiPod water bottle with water and nutrients.

**It's important to read these instructions carefully.
Do not fill the tower directly with water.
The water bottle must be used to fill the UrbiPod.**

- **D: Remove the water bottle from the tower.**
- **Unscrew the small cap on the bottle.**
- **Fill the bottle with cold water.**
- Add 5ml (a capful) of Urbotanica plant nutrient to the bottle.
- Refit cap, turn bottle upside down and (cap first) place the bottle back into the water tower.
- Make sure to place the bottle cap first back into the tower:
You should start to hear the flow of water from the bottle to the base reservoir.
- **Repeat – (2 bottles of water and nutrient are required to fill the UrbiPod).**
- When you see all of the triangle on the side of the tower cap, it's time to refill the water bottle. Don't forget the nutrient.

(Remember it's important to not fill the tower.)

4. Plant your seeds.

- First gently rough up the now moist coir with your finger or a fork.
- Add your seeds to each Pod as instructed by each seed pack.
- Lightly cover the seeds with Coir:

5. Plug in & set the light halo to the right height.

- Once all your Pods are in the UrbiPod, seeds have been planted and the water tower is full, select the best location and near a power point.
- **D:** Firmly connect the power cable to the underside of the light halo.
Plug the AC power cable into the power point.
- **E:** Move the LED light halo to the right height for the plants (2-3 cm from top of plant) and continue to adjust the height of the halo as the plants grow by pushing up or down gently.
- Note that the lighting is pre-programmed to a cycle of 16 hours on and 8 hours off.
- Adjust the start time by simply turning the ON/OFF switch at the power point to restart the 16/8 cycle.
- The recommendation is that it's best "ON" during daylight hours to support healthy plant growth and "OFF" during most of the night hours to support plant rest.

Plugging in at 6.00am will provide a cycle as follows:

For example

- 6:00am (06:00) – 10:00pm (22:00) | "ON"
- 10:00pm (22:00) – 6:00am (06:00) | "OFF"

You can also watch and follow these steps via our instructional videos at [Urbotanica.com](https://www.urbotanica.com) or on our YouTube channel <https://www.youtube.com/channel/UCbKSgxn timer WRh4Lkt9IWW7V2A>