

KONKER

COLORS®

“Express Your Passion!”



Acrylic Paint Marker

Instructions.

HOW TO USE



1. Shake well.

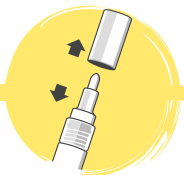

2. Remove cap.



4. Express your Passion.

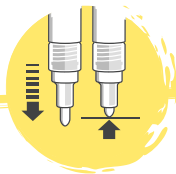

3. Compress tip until paint flows.

SAFE KEEPING

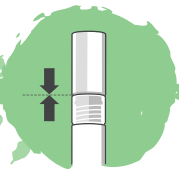

1. Snap cap on tight.



2. Store tip-side up.

KONKER
COLORS®

REPLACE TIPS



1. Pull out worn & dried tips.



2. New fresh tips push right in.

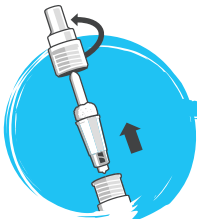

1. Unscrew top & pull out tip-holder.



2. Fill with acrylic paint & Reassemble.

REFILL



1. Easy, Just use soap & water...

CLEAN-UP

Learn more at
www.KonkerColors.com

SURFACE PREP



Proper material preparation provides ideal surfaces for paints to adhere, appear vivid, & endure the elements. Although our markers write on most surfaces, we recommend the following steps for best results & to prevent scratches, chipping, fading, & wearing away.

- 1. CLEAN:** Paint doesn't stick well to dust, dirt, oils, or chipping paint.
- 2. SAND:** Give your surface a 'tooth' for paint to bite onto.
- 3. PRIME:** Apply a layer of white gesso or paint to create an ideal surface.
- 4. SAND:** Smooth to your preference & wipe away all dust. 220 grit works great!
- 5. SEAL:** When finished with your creation, apply a varnish to protect it from time.

GENERAL TIPS: Test your process on a small area first. Let prime & paints dry between coats & sanding. Smooth materials should be sanded. Dark & porous materials should be primed. Avoid using on darker color fabrics.