

## Disassembly, Cleaning and Assembly of the Flexpert

To clean the nib/ feed on your flexpert, follow the instructions for disassembly, cleaning, and assembly using the items included in the nib block kit :

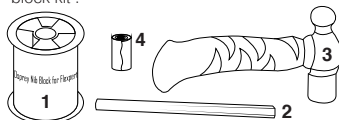

1. Nib Block 2. A Dowel 3. Hammer  
4. Grip tube or a piece of Rubber

Note: Do not use the nib block kit to remove the nib/feed from the standard #6 nib units, as the nipple at the rear of the feed may get damaged. Use of the nib block kit is applicable only to the Flexpert series of nib units i.e. the Zebra G Nib units and the #5.5 stainless steel flex nib units.

### Disassembly

#### Step 1

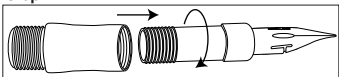

Unscrew Zebra G nib unit from the front of outer section

### Flexpert Parts and Function

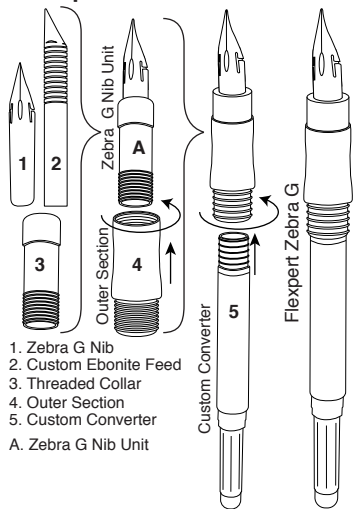

**Step 2:** Place the nib block on a level rigid surface such as wooden work table. Invert Zebra g unit facing down into the hole of the nib block

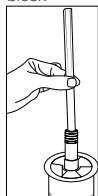
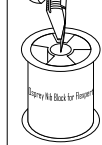

#### Step 3

Place dowel on the rear of the threaded collar. Take care that dowel is centered over the feed and is not touching the wall of the threaded insert.

#### Step 4

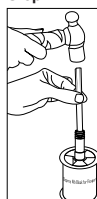

Gently tap on the dowel with a light hammer to loosen the nib and feed. This action should separate the nib and feed from the threaded collar

**Step 5** The separated nib and feed will fall into the hole of the nib block. Lift the nib block to pick up the separated pieces. Follow instructions for 'Cleaning' in the next section



## Cleaning the Nib and Feed

Soak the feed and nib in a pen cleaning solution (or add a couple of drops of liquid dish-washing detergent to some tap water to make a solution). If household ammonia is available, add a few drops, if not, just soap solution should be fine. Using an old toothbrush or cleaning brush with nylon bristles (no wire brushes please), scrub the feed of any residue until the channels (grooves on the feed) are free of any ink or pigment. Inspect the nib for signs of corrosion. If corroded, replace it with a new nib.

### Assembly

#### Step 1

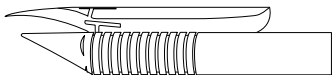

Place the cleaned or a new nib on the feed. Align the shoulders of nib with the 1st fissure of the feed.

#### Step 2

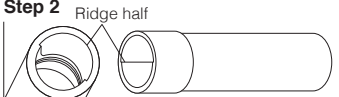

Threaded collar contains a semi-circular ridge (on one half side) that guides the nib/feed to be inserted in the correct way

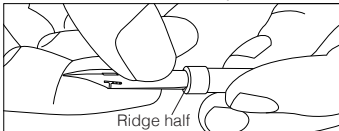

Find the ridge side of the collar and slide the aligned nib/feed with the feed facing ridge half of the Threaded collar.

#### Step 3

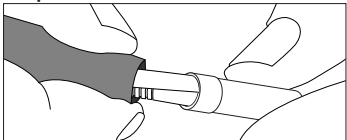

Place the grip tube on the aligned nib and feed.

#### Step 4

Push hard till the back of the feed is level with the rear of the threaded collar.

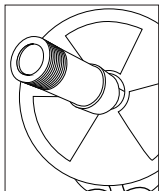

#### Step 5

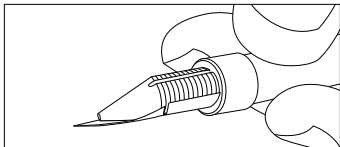

Check to make sure you have not lost the alignment of the feed and nib as explained in step 1.

#### Step 6

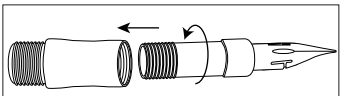

Thread the assembled Zebra G nib unit into the front portion of the outer section, turning clockwise to tighten. Be sure to hold the threaded collar and not the nib/feed when tightening. Holding the nib/feed during this step could cause misalignment while threading into the outer section.

**Step 7:** Thread the converter into the rear side of the outer section, turning anticlockwise to tighten. This completes re-assembly of the Flexpert.

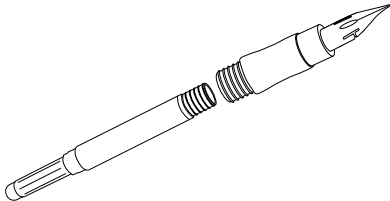

## Filling Ink In Your Flexpert

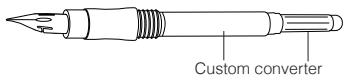

Custom converter

Method 1: Dip the nib into an ink bottle and draw ink by turning the converter clockwise



Note: This method will not fill the ink to capacity in the Converter, as some air gets drawn as you draw the ink.



You can try to expel some of the air by pointing the nib skywards and slowly turning the converter clockwise.



Repeat the action of drawing ink a second time. You will notice an air bubble or some capacity still unfilled. This is normal.

An alternate method to fill ink would be to use a Pipette/eyedropper and fill ink directly into the converter. This method allows you to fill ink up to 95% capacity.

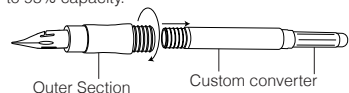

Outer Section

Custom converter

Method 2: Unscrew the converter from the outer section.

Pipette/Eye Dropper

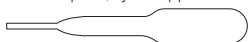

Using the Pipette add ink into the converter directly. Turning anticlockwise, thread the converter back tightly into the rear side of the outer section.

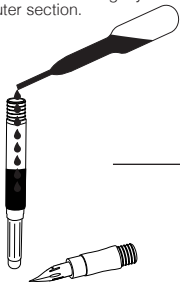

## Flex Nibs Usage and Care

### Flex Nibs Usage and Care

Upon receiving any flex nib units from Osprey, such as the FLEXPERT with the Zebra g nib, or the FLEXPERT with the #5.5 stainless steel nib, fill it with the sample ink before you use it with any other ink, to ensure that the unit performs as expected.

**Care:** Zebra G titanium nib life can be extended by cleaning the nib often, after a few uses. The stainless-steel nibs of course have a longer life, but still need to be cleaned from time-to-time to avoid railroading that may occur due to pigment deposits or other stuff that interferes with ink-flow in the feed channels. (see section on **Cleaning the Nib and Feed**). Rinse the nib thoroughly after cleaning and dry using a rag/cloth that is free of lint. Lint or paper fibers can get caught in the nib tines and result in poor performance.

**Note:** There are two factors that influence the performance of a FLEXPERT - 1) Type of ink used and 2) the type of paper it's used with, where numerous combinations are possible.

**Suggested Inks:** Using neutral inks having a PH of 7 (not acidic or alkaline) will work best and prolong Zebra g nib life. We recommend the Noodler's Black which has passed all our tests and is widely available. **DO NOT USE** India inks, Acrylic inks, Pigmented inks or other Non-Fountain pen inks with the FLEXPERT. Non-Fountain pen inks contain ingredients such as shellac that clog or gum up the ink channels in the feed. A FLEXPERT with clogged channels will not work.

**Types of Paper:** Suggestions of papers for use with the FLEXPERT yielding good results: # Rhodia dot pad - the dotted grid is great for drawing guidelines # Clairefontaine #Canson Marker A4 pad. # Canson XL Series Marker Paper Pad. # HP Printer Paper, Premium 32 - a great choice if you are looking to print some practice sheets and its also a great deal considering the price-quantity ratio!

We appreciate any feedback you give us regarding what worked or didn't work well for you, and we will be happy to share your successes with the larger community! For videos and further instructions, please visit FAQ section on our website at <https://www.ospreypens.com/pages/faq-frequentlyasked-questions>.