

# AQUAMET®

## Domestic Water Meters

Multi Jet Class B, 15mm-50mm (½"-2")



### AQUAMET

An inferential, multijet, dry type water meter with magnetic drive and vacuum sealed register.

### STANDARDS

Conforms to ISO 4064, Class-B.

### FEATURES

- Highly sensitive to low flow rates and very accurate over its entire flow range.
- Low head loss.
- Vacuum sealed, leak proof and dry Totaliser.
- Self-lubricating gears
- Long maintenance free working life.

### OPTIONS

- Remote reading facility/pulse output available on request.
- Hot Version available upto 90°C.
- Zenner Water Meters with EEC/MID/OIML Mark.

## METROLOGICAL CHARACTERISTICS

	Accuracy	15mm	20mm	25mm	32mm	40mm	50mm
		CL-B	CL-B	CL-B	CL-B	CL-B	CL-B
Lower limit of flow, Qmin I/h	±5%	30	50	70	120	200	300
Transitional flow, Qt I/h	±2%	120	200	280	480	800	1200
Nominal Flow, Qn I/h	±2%	1500	2500	3500	6000	10000	15000
Maximum Flow, Qmax I/h	±2%	3000	5000	7000	12000	20000	30000
Test pressure	MPa	2					
Temperature suitability	°C	50°C					
Dial Registration	KI	99999					
Smallest reading	lts.	0.05				0.5	

## DIMENSIONS

DESCRIPTION	15mm	20mm	25mm	32mm	40mm	50mm
Meter Thread	¾" BSP	1" BSP	1¼" BSP	1½" BSP	2" BSP	2½" BSP
End connection threads	½" BSP	¾" BSP	1" BSP	1¼" BSP	1½" BSP	2" BSP
Length of meter with coupling	250 mm	290 mm	380 mm	380 mm	430 mm	470 mm
Length of meter without coupling L	165 mm	195 mm	225 mm	230 mm	245 mm	280 mm
Height H	110 mm	113 mm	115 mm	117 mm	155 mm	175 mm
Width B	96 mm	96 mm	100 mm	104 mm	124 mm	125 mm
Weight with coupling	1.49 kg.	1.80 kg.	2.10 kg.	2.60 kg.	5.50 kg.	7.50 kg.

## DIMENSIONS (MM)

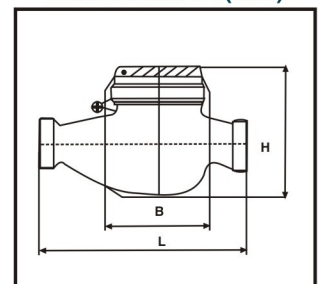

## ACCURACY CURVE

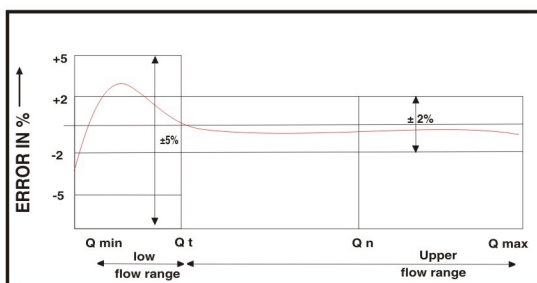

## HEAD LOSS CURVE

