

AGA94.2

Product Description

AGA94.2 is a bracket kit for mounting any VKF... butterfly valve to a Honeywell SMARTLINK DS actuator.

Components Supplied

Figure 1 shows the components supplied with the AGA94.2 bracket kit:

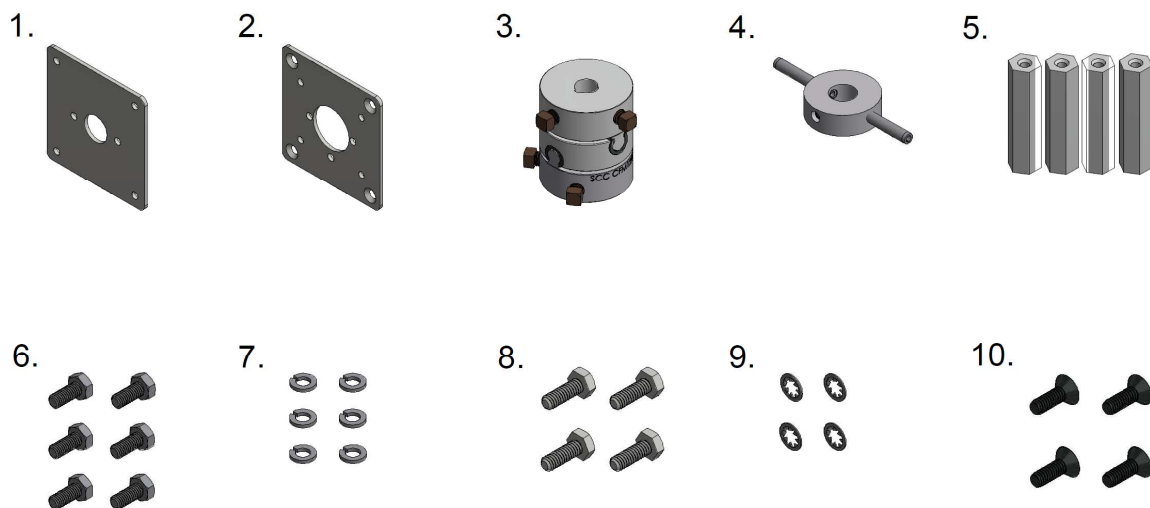

Figure 1: Pieces Supplied with the AGA94.2 Bracket Kit

- | | |
|------------------------------|--|
| 1. Valve mounting bracket | 6. (6) M6 x 14mm hex head cap screws |
| 2. Actuator mounting bracket | 7. (6) M6 split lock washers |
| 3. Coupling | 8. (4) 1/4"-20 x 3/4" hex head cap screws |
| 4. Valve position indicator | 9. (4) 1/4" external tooth lock washers |
| 5. (4) hex standoffs | 10. (4) 1/4"-20 x 3/4" flat socket head cap screws |

Recommended Installation Tools

The following tools are recommended for installing the AGA94.2 bracket kit:

- 5/32" hex key
- 2.5mm hex key
- 10mm socket and ratchet wrench
- 5/16" open-end wrench
- 7/16" open-end wrench
- Crescent wrench
- Purple Loctite

Installation Procedure

1. Using the 10mm socket and ratchet wrench along with (2) M6 x 14mm hex head cap screws and (2) M6 split lock washers, assemble the valve mounting bracket to the VKF valve.
2. Slide the valve position indicator over the VKF valve shaft. Line up the set screw in the position indicator with the small notch in the VKF valve shaft. Using a 2.5mm hex key, secure the position indicator to the VKF valve shaft.
3. Slide the coupling assembly over the VKF valve shaft. Make sure the 12mm round hub labeled "CFM12RSA" is the hub that slides over the VKF valve shaft. Line up the set screw shown in Figure 2 with the large notch in the shaft. Using the 5/16" open-end wrench, tighten the two set screws against the VKF valve shaft.
4. Using the crescent wrench and the 7/16" open-end wrench along with the (4) 1/4"-20 x 3/4" hex head cap screws and the (4) 1/4" external tooth lock washers, secure the (4) hex standoffs to the valve mounting bracket.
5. Place the actuator mounting bracket on top of the four standoffs in the orientation shown in Figure 2. Place a small amount of Purple Loctite on the tip of the (4) 1/4"-20 x 3/4" flat socket head cap screws. Using the 5/32" hex key with the (4) 1/4"-20 x 3/4" flat socket head cap screws, secure the actuator mounting bracket to the standoffs.
6. Remove the integrated coupling and mounting bracket from the SMARTLINK DS actuator so that the 1/2" keyed shaft coming directly out of the actuator is exposed. Rotate the valve shaft by hand so that the key is pointing directly at the anti-rotation pin protruding from the actuator.

7. Set the actuator on top of the actuator mounting bracket so that the ½” keyed shaft of the actuator slides into the coupling. Verify that the four mounting holes in the actuator line up with the four clearance holes in the actuator mounting bracket. Using the 10mm socket and ratchet wrench along with (4) M6 x 14mm hex head cap screws and (4) M6 split lock washers, fasten the actuator to the actuator mounting bracket.
8. Using the 5/16” open-end wrench, tighten the two set screws in the upper coupling hub labeled “CFE8RSA”.
9. The actuator needs to be programmed for clockwise (CW) rotation.

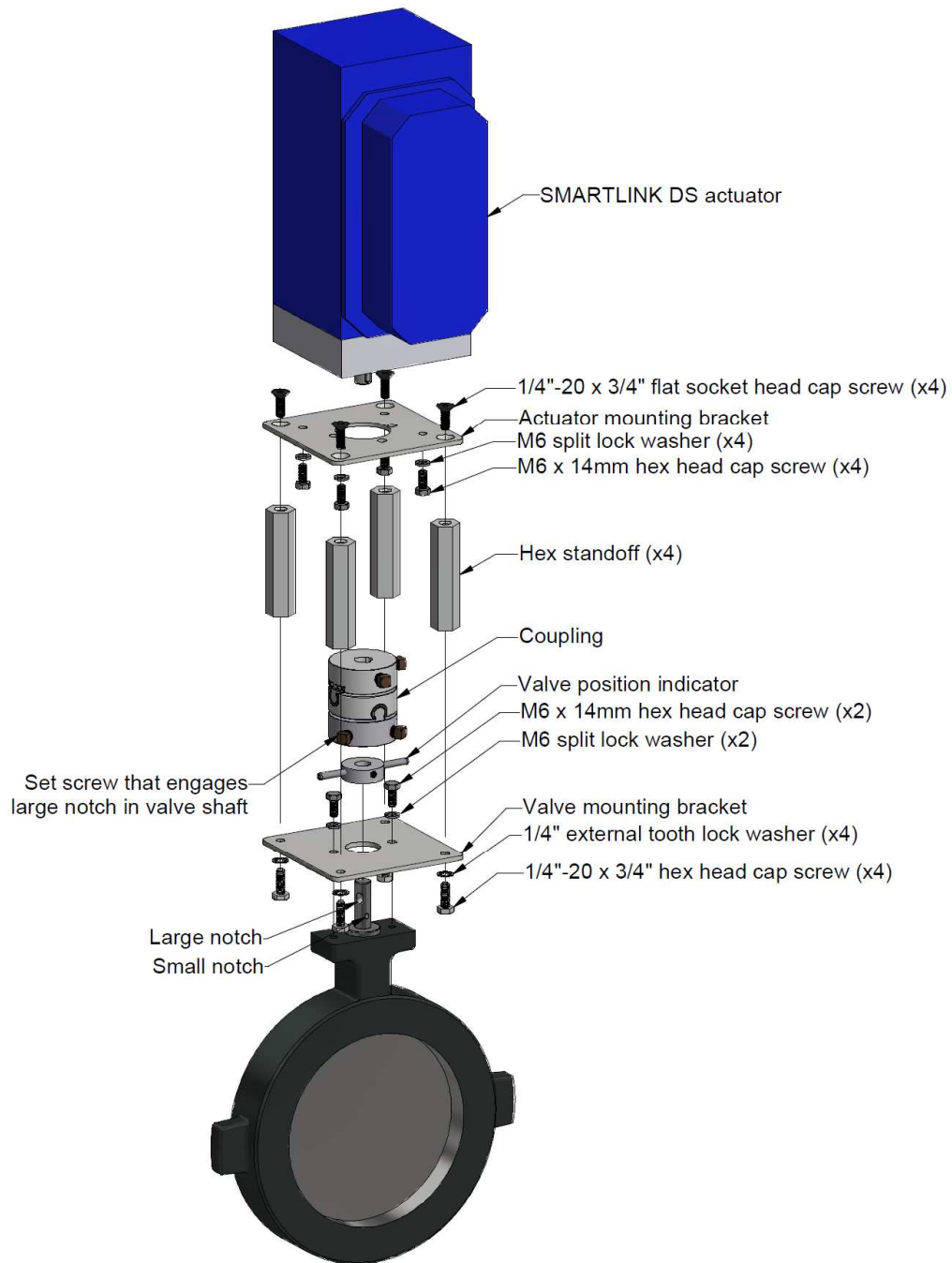

Figure 2: Exploded View of Assembly

Information in this publication is based on current specifications. The company reserves the right to make changes in specifications and models as design improvements are introduced. Product or company names mentioned herein may be the trademarks of their respective owners. © 2018 SCC Inc.