



PR LUBRICATED PLUG VALVE

NEOVALVES

Class	Max. CWP	Test Pressure	Pattern	Connections	Port	Materials		Operation
						Body & Cover	Plug	
250	500 Psi	Shell 750 Psi Seat 550 Psi	Straight-way Regular	Screwed API 5B Table 2.1 or ANSI B2.1	Rectangular Full Bore	Semi Steel ASTM A.126 Class B	Semi Steel ASTM A.126 Class B	Manual

- ANSI Class 250
- Working Pressure 500 PSI
- C.G.A. Approved
- Regular Pattern
- Rectangular Port

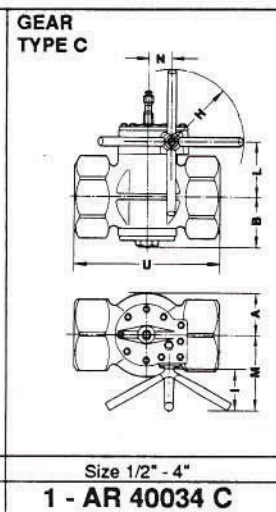
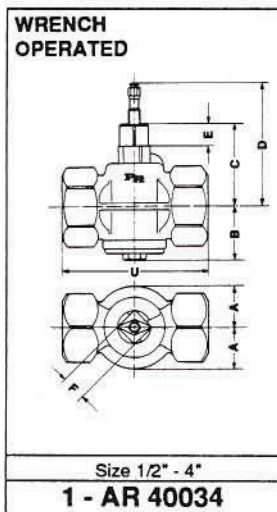
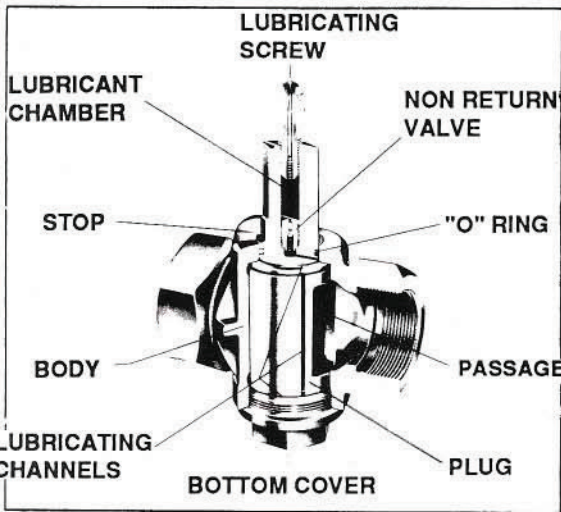

Diam.	A	B	C	D	E	F	H	I	L	M	N	U
1/2"	25	51	75	110	17	17	45	16	73	104	32	89
3/4"	25	51	75	110	17	17	45	16	73	104	32	95
1"	32	57	82	118	18	19	45	16	80	104	32	108
1-1/4"	34	64	95	143	20	24	45	16	95	104	32	121
1-1/2"	42	74	106	166	21	27	150	101	115	181	47	140
2"	48	85	120	180	23	30	150	101	130	181	47	152
2-1/2"	67	105	130	190	33	36	150	101	132	181	47	222
3"	76	120	151	231	40	50	150	101	153	195	65	238
4"	94	145	173	253	42	55	150	101	156	195	65	273

A= Wrench No.	B	C	D
17	14	140	20
19	16	150	22
24	18	200	26
27	20	225	30
30	22	280	33
36	26	330	38
50	40	420	52
55	45	815	58

WRENCH IDENTIFICATION

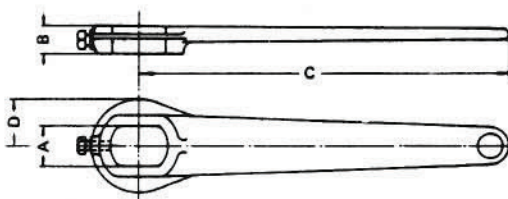

*Neo Valves carries a wide range of Plug Valves. For more information please contact your nearest Neo Valves representative.

NOTE: Due to continuous development of our range of valves, we reserve the right to alter the dimensions and information contained in all our literature as required.

