



OMIX-ADA, Inc.

460 HORIZON DR. SUITE 100 | SUWANEE, GA 30024 | PHONE: 770-614-6101 | FAX: 770-614-6069 | info@omix-ada.com

Part #11585.04

## Accessory Brake Light LED Ring



**OMIX-ADA® TECHNICAL SUPPORT**

**PHONE:** M-F 8am - 5pm EST 1-800-449-6649 | **EMAIL:** techsupport@omix-ada.com

**FOR WARRANTY INFORMATION VISIT:** [www.Omix-Ada.com](http://www.Omix-Ada.com)

## Accessory Brake Light LED Ring

1. Remove spare tire.

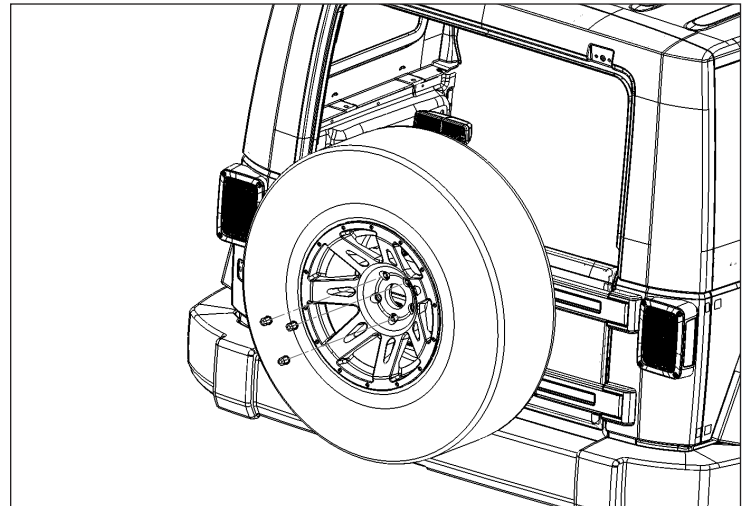

**CAUTION** Have another person help lift the tire off of the carrier.

**NOTICE** Proceed to step 2 if using Accessory Brake Light LED Ring on 07-17 Jeep Wrangler. Skip to step 10 if installing on a 94-06 Jeep Wrangler.

2. Open tailgate. Using T-20 Torx bit, remove 4 torx head screws that attach light to factory tire mount. Pull light away from tire mount.

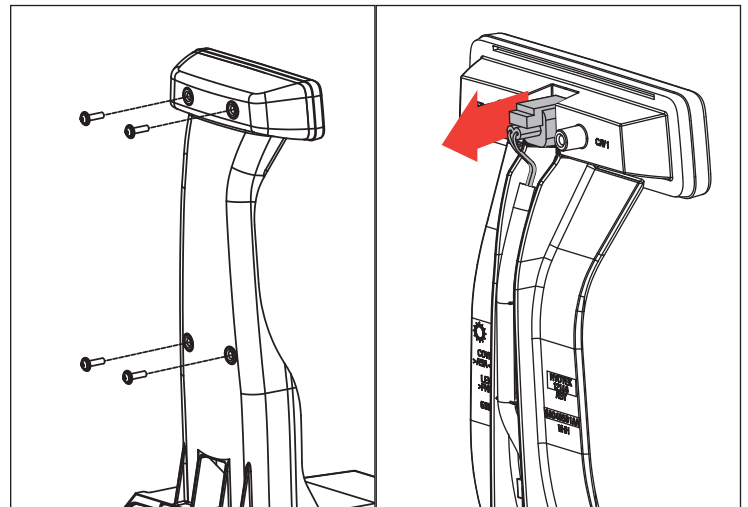

3. Remove connector by pushing down on tab and pulling. Set third brake light aside, it will be using again.

4. Attach Accessory Brake Light LED Ring to tire mount by sliding over mounting holes.

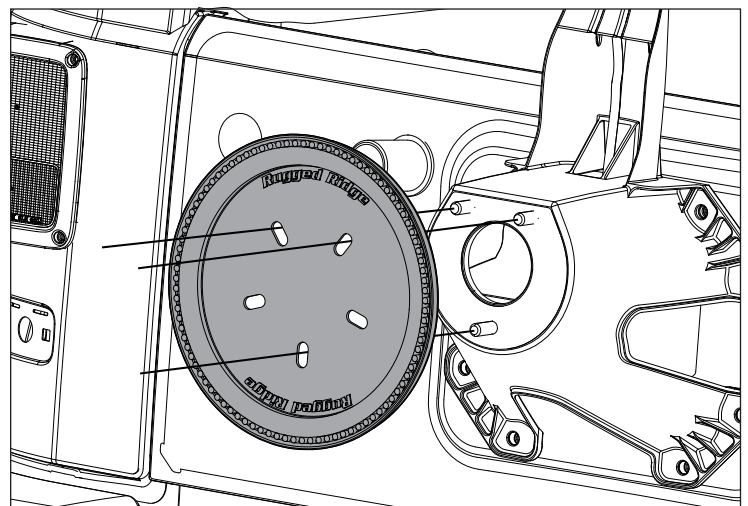

## Accessory Brake Light LED Ring

5. Connect Accessory Brake Light LED Ring wiring to factory third brake light wire harness.

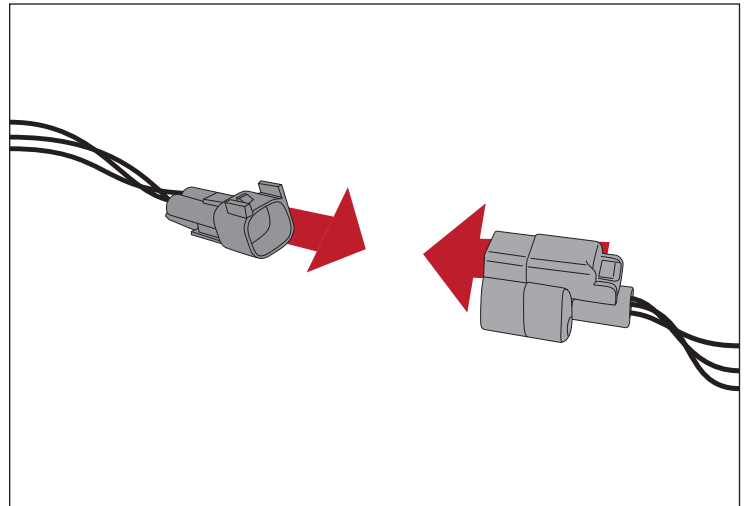

**WARNING** Third brake light is part of vehicles original safety equipment and required for highway use under federal and state laws. LED ring is custom trim piece which must be used with OEM third brake light.

6. Connect electrical connector on Accessory Brake Light LED Ring to third brake light.

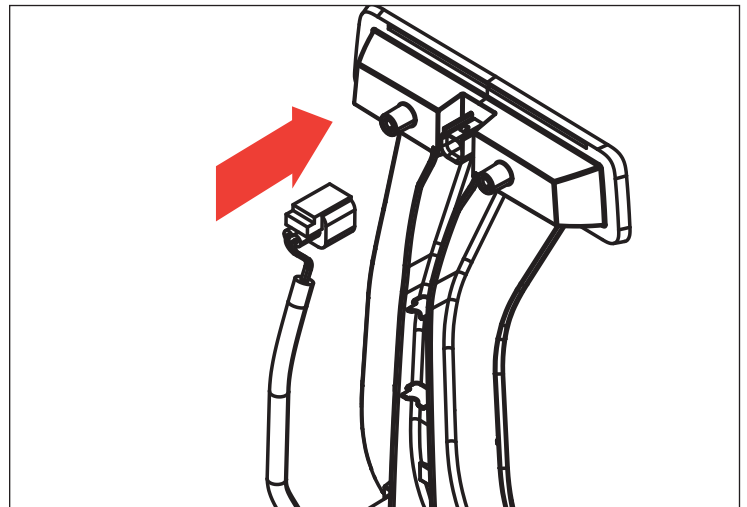

7. Press brake pedal to check brake light functionality.

8. Reattach factory third brake light to factory tire mount.

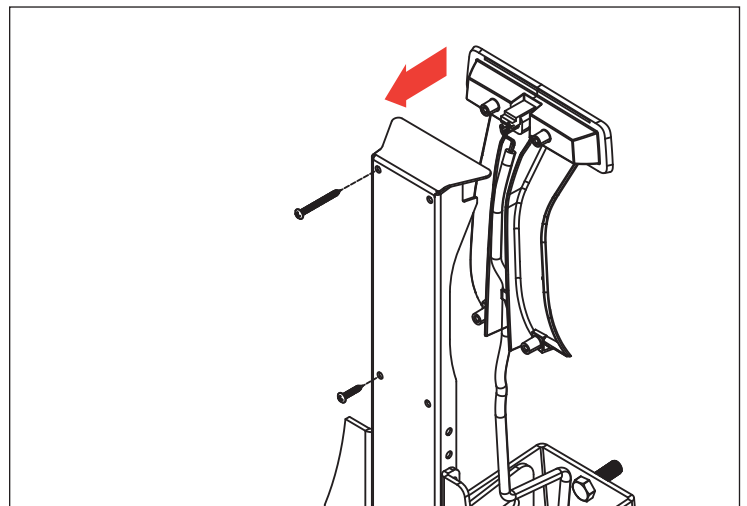

9. Re-install spare tire and torque lug nuts to 80ft•lb.

**CAUTION** Have another person help lift the tire onto tire carrier.

**WARNING** Failure to tighten lug nuts to proper torque specification could result in serious injury or property damage.

## Accessory Brake Light LED Ring

10. Attach Accessory Brake Light LED Ring to factory tire mount.

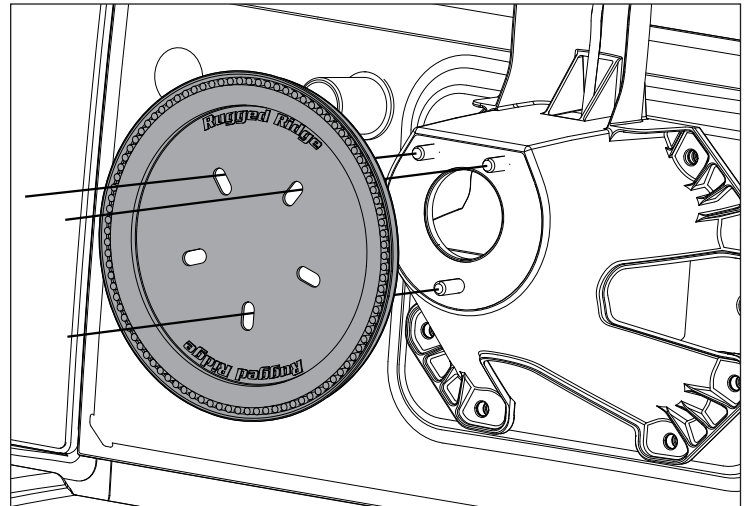

11. Unsheathe factory third brake light wires from plastic wire loom. Cut factory third brake light wires.

**CAUTION** Cutting/Sharp Edge Hazard: Cut carefully using gloves and eye protection.

**WARNING** Third brake light is part of vehicles original safety equipment and required for highway use under federal and state laws. LED ring is custom trim piece which must be used with OEM third brake light.

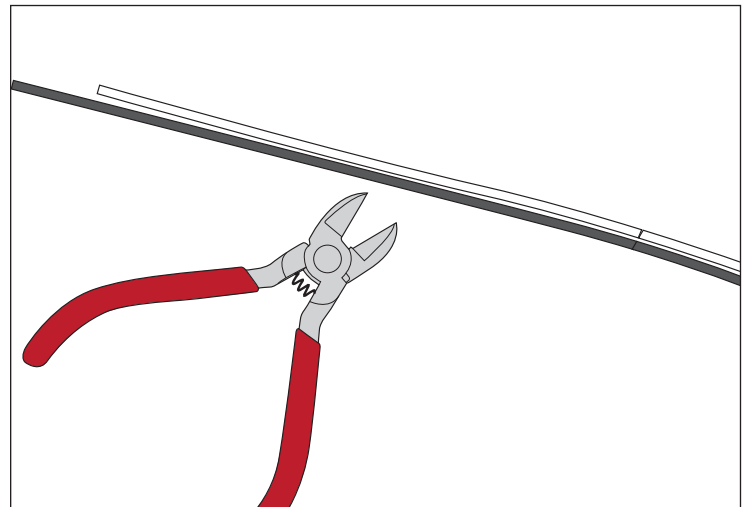

12. Cut and strip Accessory Brake Light LED Ring wires leaving plenty of extra length. Splice wires' cut using electrical connectors.

13. Reattach factory third brake light to factory tire mount.

14. Press brake pedal to check brake light functionality.

**NOTICE** For driving in wet or winter areas, protect connection with di-electric grease and weather resistant shrink tubing.

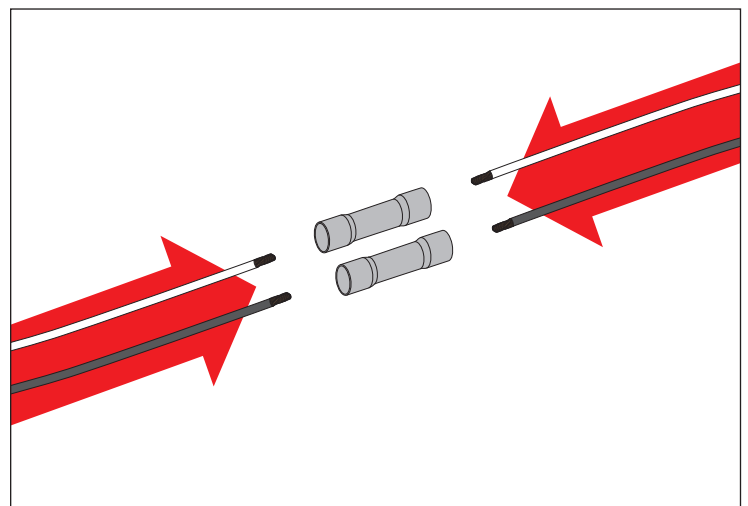

## Accessory Brake Light LED Ring

14. Re-install spare tire and torque lug nuts to 80ft•lb.

**CAUTION** Have another person help lift the tire onto tire carrier.

**WARNING** Failure to tighten lug nuts to proper torque specification could result in serious injury or property damage.

