

USER MANUAL

Wireless Multi-Alert Receiver (Chime Unit)

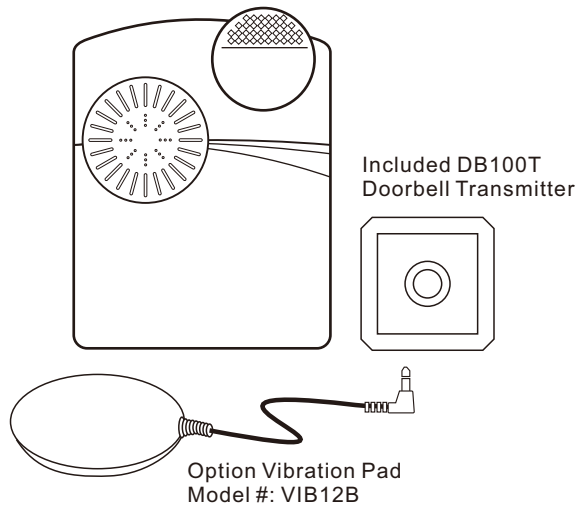

1

MAINTENANCE

- For best results, use good quality alkaline batteries.
- Always replace old or weak batteries.
- Keep doorbell dry. If wet, dry immediately.
- Do not use cleaning solvents on electronic products.
- Solvents contain chemicals that can damage circuitry. Use damp towel or cloth to clean. Dry immediately.
- Do not expose the bell unit to rain or immerse in water. It is not water resistant.

If the device is operated using an AC adapter, use only the MyAlerts approved power supply. Do not use any other type of power supply.

WARNING

The user is cautioned that changes & modifications made to the equipment without the approval of MyAlerts could void the user's warranty. The manufacturer is not responsible for any radio or TV interference caused by unauthorized modifications to this equipment.

2

PARTS & FUNCTION DOORBELL

Receiver

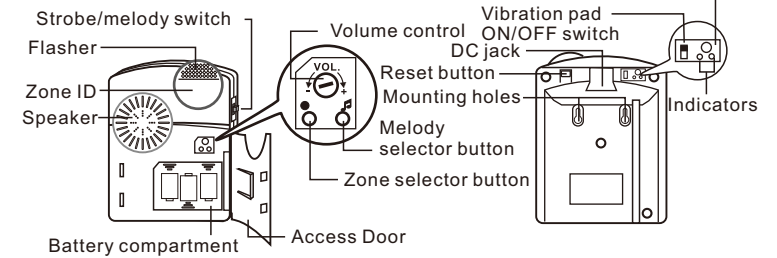

Doorbell button

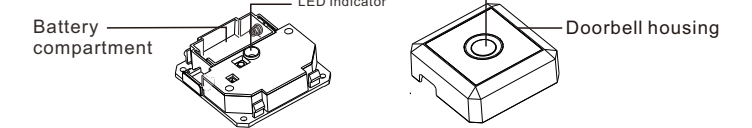

MOUNTING

Receiver

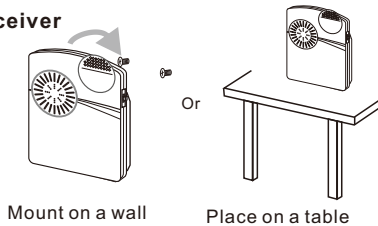

Doorbell Transmitter

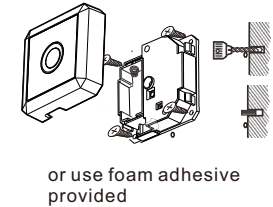

POWER

Receiver

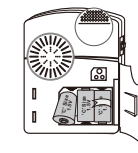

or Uses a AC/DC adaptor

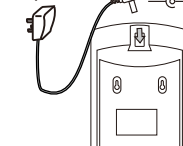

Doorbell Transmitter

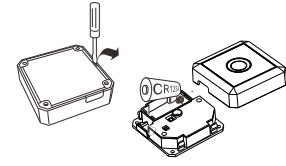

3

CODE PAIRING & MELODY SELECTION

* PLEASE NOTE THE DOORBELL BUTTON & CHIME UNIT ARE PAIRED & READY TO USE.

Step 1: Insert the battery into the transmitter to be used (Doorbell button)

Step 2: Insert the batteries into the receiver (chime unit).

Step 3: Enter pairing mode for the receiver (chime unit). Press & hold the ● zone selector button for 3 seconds. The LED in zone #1 will flash.

Step 4: Press the ● zone selector button again to move to the zone you wish to pair with. Press the 🎵 melody selector button to scroll through the melodies. Once you hear a melody you prefer, do not press any button as the melody is set for that zone.

Step 5: Once the zone & melody are selected, press the Doorbell button once to pair. If successful, the receiver (chime unit) will generate two short tones. Press the ● zone selector button to exit the pairing mode, the system is now ready to use. Press the push button once to pair. If successful, the receiver (chime unit) will generate a short tone. Press the button to exit pairing mode, the system is ready to use.

To stop the Chime while the receiver (chime unit) is alerting press the reset button.

Clearing the transmitter memory of the Receiver

First, press & hold the ● zone selector button for 3 seconds to enter the pairing mode. Press the ● zone selector button to move to the desired zone you want to delete. Press & hold the ● zone selector button & 🎵 melody selector button together for 3 seconds to delete the memory. The receiver will generate a tone to indicate the transmitter on the specific zone selected has been deleted.

Change the melody in desired zone

First, press & hold the ● zone selector button for 3 seconds to enter the pairing mode. Press the ● zone selector button to move to the desired zone then press the 🎵 melody selector button to select the melody desired. Press the ● zone selector button until the pairing mode is exited.

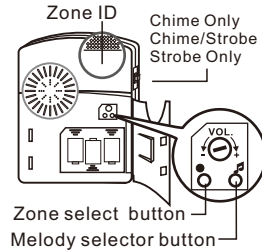

Battery low indicator

If a zone LED light is blinking, that indicates that the battery is low for this transmitter. You must replace the battery as soon as possible. If the white flash at the top of the chime blinks every 5 seconds, this indicates the receiver batteries are very low. When you see the white flash every 5 seconds, you must replace the batteries of the receiver immediately.

Notes

To cancel any alert on the remote receiver press the reset button. The reset button is located on the back of the receiver behind the flasher.

VIBRATION PAD

Parts & Function

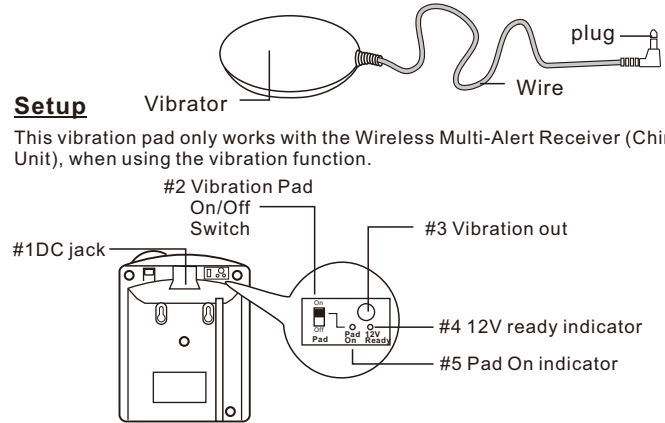

- #1 DC jack:** If using the vibration pad, you must plug in the 12V power supply into the DC 12V Input first.
- #2 Vibration pad On/Off:** Slide this switch to turn the vibration function On/Off.
- #3 Vibration Out:** Insert the vibration pad plug into the pad out jack.
- #4 12V ready indicator:** This indicator will light up red, when the 12V adaptor is connected correctly.
- #5 Pad ON indicator:** If the vibration pad On/Off switch is moved to the "ON" position, the LED indicator will light up red to indicate the Vibration function is "ON".

Notes

The Vibration Pad will not work without the power supply being connected.

When the vibration pad is activated, it will run for 15 seconds.

Both the 12V ready indicator & Pad On indicator will light up Red when they are in use.

To cancel any alert on the remote receiver press the reset button. The

FCC Statement:

This equipment has been tested and found to comply with the limits for a Class B digital device, pursuant to part 15 of the FCC Rules. These limits are designed to provide reasonable protection against harmful interference in a residential installation. This equipment generates, uses and can radiate radio frequency energy and, if not installed and used in accordance with the instructions, may cause harmful interference to radio communications.

However, there is no guarantee that interference will not occur in a particular installation. If this equipment does cause harmful interference to radio or television reception, which can be determined by turning the equipment off and on, the user is encouraged to try to correct the interference by one or more of the following measures:

- Reorient or relocate the receiving antenna.
- Increase the separation between the equipment and receiver.
- Connect the equipment to an outlet on a circuit different from that to which the receiver is connected.

This device complies with part 15 of the FCC rules. Operation is subject to the following two conditions: (1) This device may not cause harmful interference, and (2) this device must accept any interference received, including interference that may cause undesired operation.

Note: Modifications to this product will void the user's authority to operate this equipment.

For Customer Support Please Contact:

Silent Call / MyAlert

Sales@Silentcall.com / 1-800-572-5227

scdirectsales.com for DIY instructional videos and User Guides

