

babybrezza®
formula pro®

babybrezza®

This product may be covered under one or more of the following including U.S. Patent No. 8,584,901, Canada Patent No. 2,842,603, China Patent No. CN103874441, Australia Patent No. 2011374309, Spain Patent No. ES2473790B2 and pending patent application(s) in the U.S. and other countries.

babybrezza.com

© 2017 Baby Brezza Enterprises LLC



Instructions
for set-up, use and cleaning

INSTRUCTIONS FOR SAFE USE

- The appliance must not be immersed in liquid.
- Household use only.
- If the supply cord is damaged, it must be replaced by the manufacturer, its service agent or similarly qualified persons in order to avoid a hazard.
- This appliance can be used by children aged from 8 years and above if they have been given supervision or instruction concerning use of the appliance in a safe way and understand the hazards involved. Cleaning and user maintenance shall not be made by children unless they are aged from 8 years and above and supervised. Keep the appliance and its cord out of reach of children aged less than 8 years.
- Appliances can be used by persons with reduced physical, sensory or mental capabilities or lack of experience and knowledge if they have been given supervision or instruction concerning use of the appliance in a safe way and if they understand the hazards involved.
- Children should be supervised to ensure that they do not play with the appliance.

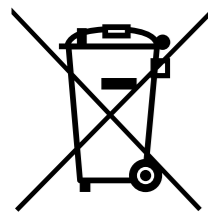

This marking indicates that products should not be disposed of with other household wastes. To prevent possible harm to the environment or human health from uncontrolled waste disposal, recycle it responsibly to promote the sustainable reuse of material resources. To return your used device, please use the return and collection systems or Contact the retailer where the product was purchased. They can take this product for environmentally safe recycling.

⚠ WARNING: For infants less than 6 months old, always use boiled water that's then been cooled to room temperature. Never pour boiling/hot water in water tank. Or use bottled, purified water suitable for infant formula preparation. Tap water and/or unsterilized baby bottles can potentially lead to adverse effects for the health of your baby. Only prepare one bottle at a time, feed immediately and follow all instructions carefully. Do not keep leftover formula mix. Always hold baby while feeding. Leaving baby unattended may cause choking. If your child was born premature, with low birth-weight or is immune deficient, please consult your pediatrician before using this machine.

Save these instructions

babybrezza®

CONGRATULATIONS!

Thank you for purchasing your new Formula Pro®. In doing so, you have chosen the most unique and innovative on-demand baby formula maker on the market. At Baby Brezza, we developed the Formula Pro® to help parents save time and frustration when it comes to feeding their babies.

Now you actually have two new babies: The hungry human baby who needs formula and the Formula Pro®. Just like a real baby, the Formula Pro® needs some tender love and care, and will bring you years of joy. We promise it's worth it, for a perfectly mixed warm bottle of formula prepared in 30 seconds. Your baby's first bottle of hassle-free formula is just a few minutes away. But keep the powder in the cupboard for now. You'll first have to hand-wash all the parts (**no dishwasher, no sterilizing and no boiling water!**) with soap and water, then assemble them and flush the Formula Pro® with water. It's easy. We'll show you how in the following pages. To get the most out of your new Formula Pro®, read these instructions and retain them for future reference.

FEATURES

- Optimal water temperature, easy assembly, and hassle-free formula preparation.
- Patented mixing technology: Accurately measures and mixes formula powder and water in seconds.
- The removable water tank: easy to fill and clean, holds 1.5 liters of water.
- Airtight formula storage, holds 700g of formula powder.
- Works with most major formula brands and types.
(check babybrezza.com for the current list of compatible formulas).

TIPS AND MAINTENANCE

- **Funnel** and especially the **Powder-Dispensing Hole**, needs to be **cleaned after every 4 bottles or once a day** (whichever comes first). A red indicator light will illuminate to remind you.
- Make sure powder level is **always filled above the min line** and never fill the powder container above the max line.
- Once a month you'll need to take apart the machine completely and hand-wash. You can't put any of the parts in a dishwasher, sterilizer or microwave, as the parts will warp and the machine will not operate.
- Each part needs to be **completely dry** when reassembling, to avoid formula clumping and growing bacteria. Some of the parts have little grooves and holes, so it may take some persistence to dry by hand.
- Refer to page 11 for a handy set-up check list.

FORMULA PRO® PARTS

Hand-wash all parts (except base) and dry thoroughly. Then assemble as shown on pages 5 & 6.

⚠ Never clean any of these parts in a dishwasher, sterilizer or microwave!



TECHNICAL DATA

Supply Voltage: 220V-240V 50/60Hz

Model: FRP0045

Current: 2.5A

Heater Power: 500W

Motor Power: 20W

FLUSHING THE FORMULA PRO® BEFORE FIRST USE

ABOUT WATER TEMPERATURE

For quickest warming time, always fill the water tank with room temperature water. Flashing green & yellow lights mean the water poured into the water tank is too hot or too cold. The machine will not operate while the green & yellow lights flash.

The heater in the water tank will warm the water and keep it warm as long as the machine is powered on. If you refill the water tank with room temperature water and need to use the machine right away, the machine can be used while water is heating (flashing yellow light).

⚠ Never fill water tank with hot or cold water. If you boil water before using it in the machine, let the water cool to room temperature before pouring it into the water tank.



Fill water tank to MAX line with room temperature water only.



Place 300ml or larger container to catch water.

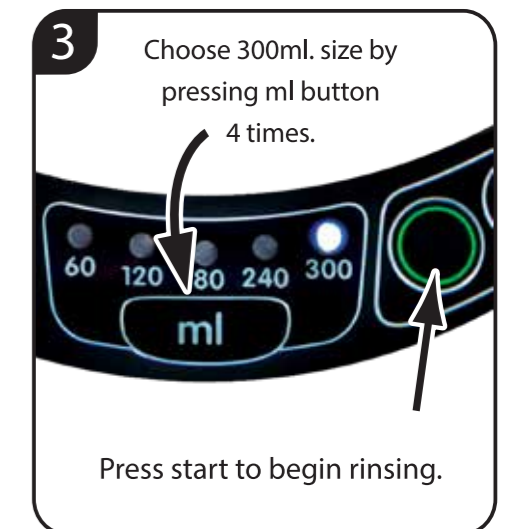

The Formula Pro® will stop after dispensing 300ml of water. Dispose of the water captured in the container.

Your Formula Pro® is now ready to use with powder.

SET-UP DETAILS

Please watch set-up and cleaning videos at babybrezza.com/video.

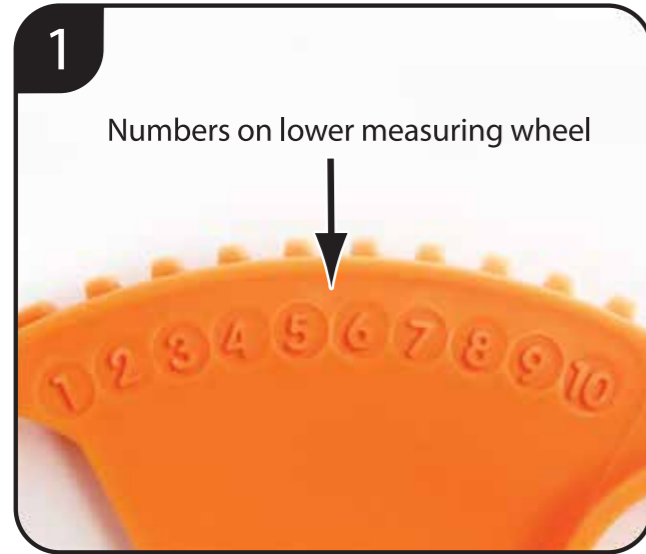

Select measuring wheel setting 1 - 10 by using the chart provided at babybrezza.com in the help section.

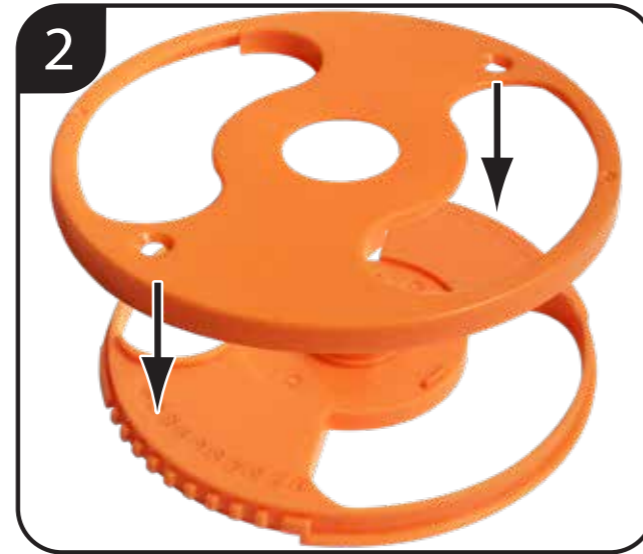

Press upper and lower measuring wheels together so powder setting shows through window as in image 2a.

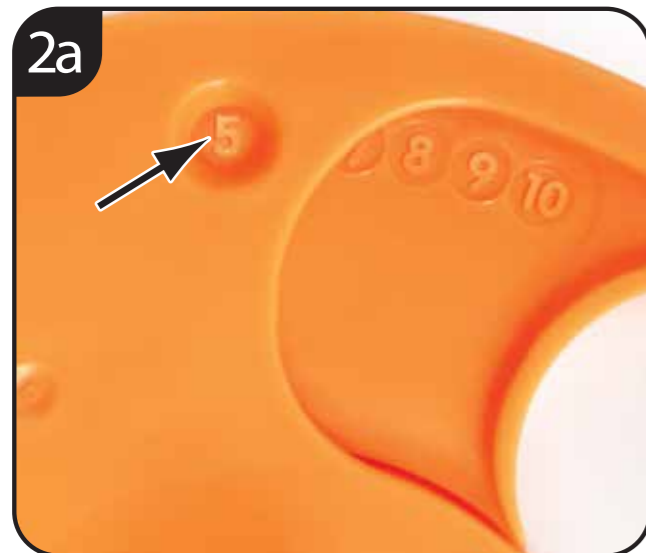

Example of measuring wheel assembled correctly on setting 5.



Place powder container on base with "MIN" & "MAX" lines facing front.

SET-UP DETAILS

Please watch set-up and cleaning videos at babybrezza.com/video.



Place assembled measuring wheel in powder container exactly as shown in photo above.



1. Place the front edge of locking cover **UNDER THE TAB** in the powder container.
2. Slide hole over axle and press down.



Place stirring wheel in powder container, align with axle and push down so it touches the locking cover.



Fit the powder container lid on the powder container with the tab towards the back/left and turn clockwise to lock into place. The powder container is now set up.

PREPARING YOUR FIRST BOTTLE



Fill tank with **room temperature water** suitable for infant formula preparation.



Choose correct drip-tray height and turn power switch to "on" position on back of machine.



Carefully fill powder container with powder and close lid. Never overfill or pack powder in container. **Wipe any powder spilled on machine with a clean damp cloth.**

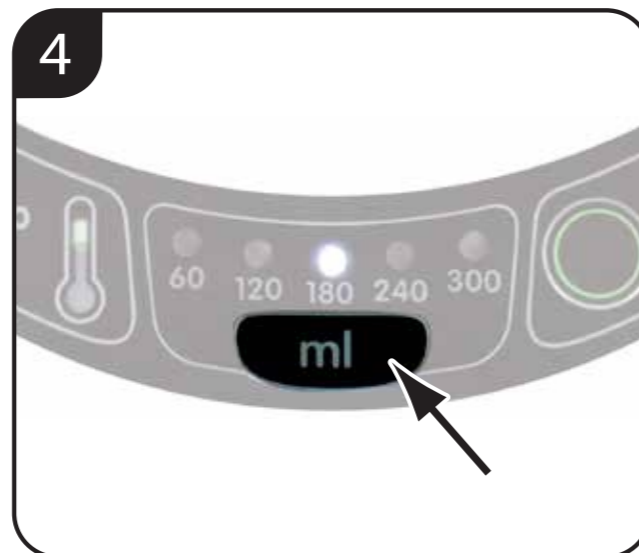

Choose ounce size by pressing "ml" button until desired size illuminates. **Ounce size indicates water volume only. It does not include the volume of powder added when mixing.**

PREPARING YOUR FIRST BOTTLE

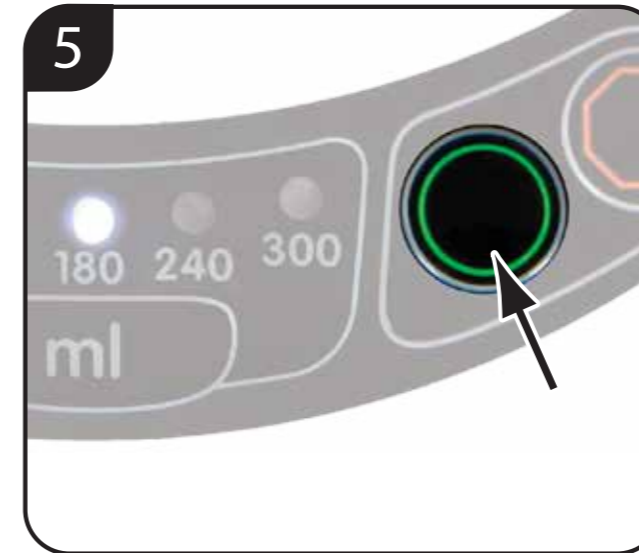

Press the "start" button to begin dispensing.



When dispensing is complete, make sure to check level of mixed formula. **Level will appear higher due to added powder volume and/or variance in bottle markings.**



Check for clumps and shake or stir the bottle if necessary. Check temperature and...



... Feed baby.

DAILY CLEANING

To wash, always use a non-abrasive sponge and hand wash with warm soapy water. **Never use hot/boiling water, or put any parts in a dishwasher or sterilizer. Dry parts thoroughly; always make sure parts are completely dry before using again.** Must be cleaned daily or after every four bottles when the funnel LED indicator light illuminates.



Remove Funnel & Funnel Cover by pulling out and down.



Wash the funnel and funnel cover and dry thoroughly before replacing.



Wipe the powder-dispensing hole using a dry paper towel or soft dry cloth.



Wipe any spilled powder off base of machine.

⚠ Always make sure the Funnel and Funnel Cover are completely DRY before placing in the machine.
 ⚠ Never use a wet or damp cloth to clean the powder dispensing hole or underside of Powder Container.

MONTHLY CLEANING

Please watch set-up and cleaning videos at babybrezza.com/video



Hand-wash powder container and associated parts and dry thoroughly.



Wash inside of water tank and wipe outside with clean damp cloth.

Never immerse base of tank in water or get it wet. It houses electronics that must remain dry. If the electronics in the base of water tank get wet, allow to dry thoroughly for at least 24 hrs before using.



Wipe base with soft, damp cloth or sponge and dry with a dry paper towel.

USER TIPS

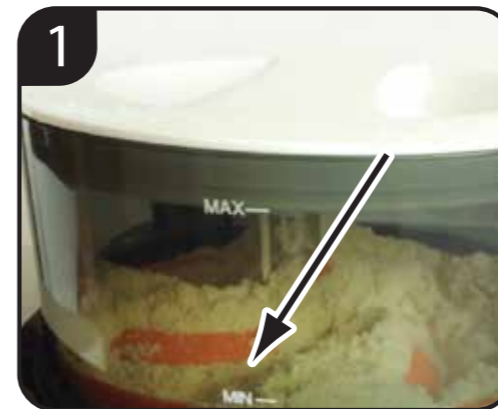

Refill when stirring wheel arms are visible. Never use machine with powder below MIN line.



Make sure powder is not above the MAX line before closing lid. Use prongs on underside of powder container lid to gently level the powder.



Wipe any spilled formula off machine including the side covered by the water tank. It is very important to keep the entire Formula Pro® clean.

TOUCH DISPLAY CONTROLS

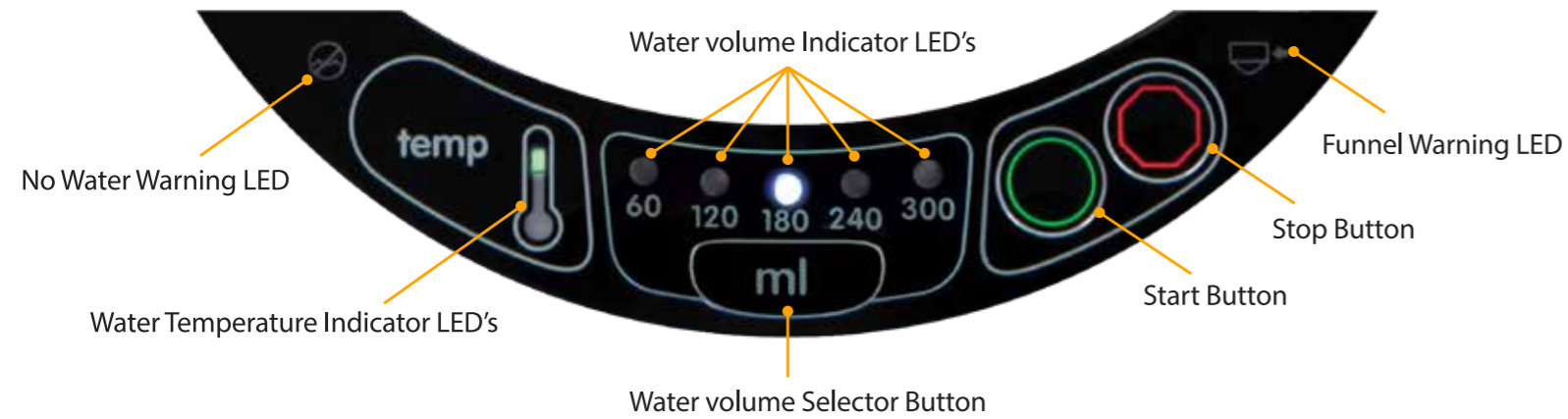

TEMPERATURE INDICATOR LIGHTS



Flashing Yellow means:
water is heating.



Solid Green means:
water is warm & ready.



Flashing Yellow & Green means:
water poured into tank is too hot
or too cold.

SETUP CHECKLIST

Your Formula Pro® is set up correctly when you have:

- Washed and thoroughly dried all removable parts according to the cleaning instructions. (no dishwasher, sterilizing, or boiling water.)
- Assembled the Formula Pro® correctly.
- Flushed the Formula Pro® with water. (use only room temperature water)

TROUBLESHOOTING

Condition	Possible Cause	Possible Remedy
Machine will not start.	Unit is unplugged.	Make sure the plug is securely inserted into the power outlet.
	Unit is not turned on.	Turn switch on lower back of unit from off to on.
	Funnel is removed or not fully inserted.	Insert funnel or push front of funnel until flush with machine.
	Water Tank is removed or not fully seated.	Place water tank on base or push down all the way.
	Water level is below "MIN" line.	Add more room temperature water to water tank.
	Powder container is removed or not fully seated.	Place powder container on base or push down all the way.
	Powder container lid is not completely closed.	Turn Powder container lid clockwise to close completely.
	Powder container lid is on backwards.	Make sure tab on outer edge of Powder Container Lid is facing the back of the machine and engaged with safety switch. See page 6, Step 7 for details.
	Water in Water Tank is too cold. (Green & Yellow Temp LED's Flashing)	Dump out and refill with room temperature water.
Water in Water Tank is too hot. (Green & Yellow Temp LED's Flashing)	Dump out and refill with room temperature water.	
Temperature of dispensed formula is too cold.	Water has not yet been heated to correct temperature.	Wait for heater to warm water in tank. Green LED in "temp" section of control panel will illuminate when water reaches correct temperature.
Funnel will not fit all the way in Funnel Compartment.	Funnel Cover is not straight on funnel or not pushed down completely.	Align tab on front of Funnel Cover with notch in Funnel and push down Funnel Cover completely.
Funnel LED flashing, Formula Pro beeps when start button is pressed.	Funnel and hole on underside of Powder Container require cleaning.	Follow Steps on Page 9 to clean and dry Funnel and hole on underside of Powder Container.

