

babybrezza®

bottle washer

babybrezza®

Please register your Bottle Washer at:

babybrezza.com/register

For product updates &
safety information.

Instruction
Manual

Limited 1-Year Warranty

The limited warranty is valid only on products bought through authorized resellers and used in the United States and Canada. Buying through an unauthorized reseller or using this product outside of the United States and Canada automatically voids this warranty.

This warranty is available to consumers only. You are a consumer if you own a Baby Brezza Bottle Washer that was purchased at retail for personal, family or household use. Except as otherwise required under applicable state law, this warranty is not available to retailers or other commercial purchasers or owners. We warrant that your Baby Brezza Bottle Washer will be free of defects in material or workmanship under normal home use for one year from the date of original purchase. Customer will be required to present original proof of purchase in order to obtain the warranty benefits. In the event that you do not have proof of purchase date, the purchase date for purposes of this warranty will be the date of manufacture. If your Baby Brezza Bottle Washer should prove to be defective within the warranty period, we will repair it or, if we consider it necessary, replace it.

**To obtain warranty services, please call Customer Service at 1-888-396-6552 or write to:
Baby Brezza, 250 Passaic Street, Newark, NJ 07104 Attn: Customer Service.**



IMPORTANT SAFEGUARDS

When using electrical appliances, basic safety precautions should always be followed, including the following:

1. Read all instructions carefully before using your bottle washer.
2. Ensure that the supply voltage marked on the appliance corresponds with your mains supply.
3. If there is any visible damage to the appliance, the plug or to the supply cord, disconnect the appliance immediately and do not use it.
4. If the power cord is damaged, it must be replaced by the manufacturer, its service agent or a similarly qualified person in order to avoid a hazard.
5. Do not allow children to touch or use the appliance. The appliance becomes very hot and the steam can cause severe scalding.
6. Do not move the appliance when it is in use or contains hot liquids.
7. Do not touch the hot surfaces.
8. Do not place the appliance on or near hot surfaces, in a heated oven or near a gas or electric heater.
9. Unplug the appliance from the power supply before cleaning or storage.
10. Do not immerse the supply cord, plug or base unit in water or any other liquid.
11. This appliance does not contain any user serviceable parts inside. Do not dismantle.
12. This appliance is for indoor household use only. Do not use outdoors.
13. This appliance is not intended for use by persons (including children) with reduced physical, sensory or mental capabilities, or lack of experience and knowledge, unless they have been given supervision or instruction concerning use of the appliance by a person responsible for their safety.
14. This appliance has a polarized plug (one blade wider than the other). To reduce risk of electric shock, this plug is intended to fit into a polarized outlet only one way. If the plug does not fit fully into the outlet, reverse the plug. If it still does not fit, contact a qualified electrician. Do not attempt to modify the plug in any way.
15. a) Short power-supply cord is provided to reduce the risks resulting from becoming entangled in or tripping over a longer cord.
b) Extension cords are available and may be used if care is exercised in their use.
c) If an extension cord is used: The marked electrical rating of the extension cord should be at least as great as the electrical rating of the appliance; The longer cord should be arranged so that it will not drape over the countertop or tabletop where it can be tripped over, snagged, or pulled on unintentionally (especially by children).
16. Children should be supervised to ensure that they do not play with the appliance.
17. Not for space heating purpose.
18. Always use on a level heat resistant surface.
19. Always keep the electric sterilizer and its plug out of reach of small children.
20. To disconnect, turn any control "off", then remove plug from wall outlet.
21. Always unplug from the electric outlet when not in use. Allow to cool before putting on or taking off any parts.
22. Do not operate any appliance with a damaged cord or plug or after the appliance malfunctions or has been damaged in any manner. Return appliance to the nearest authorized service facility for examination, repair, or adjustment.
23. The use of accessory attachments is not recommended by the appliance manufacturer as this may cause injuries.
24. This bottle washer is intended to be used in households and similar applications such as a. staff kitchen areas in shops, offices and other working environments. b. farm houses. c. by clients in hotels, motels and other residential type of environments. d. bed and breakfast.
25. Do not open while in use as this product contains boiling water. Beware of escaping steam from the vent holes in the lid.
26. Allow at least 30 minutes between operations and make sure the unit has been cooled down before starting the sequential use.
27. Steam escaping from the unit can cause burns. Always allow 5 minutes to cool down after the cycle finishes before lifting the lid.
28. KEEP CHILDREN AWAY from this bottle washer at all times.
29. This apparatus is designed to wash and sterilize baby bottle and accessories only. Do not use for other purposes
30. To provide continued protection against risk of electric shock, connect to properly grounded outlets only.
31. CAUTION: Risk of electric shock, disconnect electric power before servicing.

SAVE THESE INSTRUCTIONS

Get to know your **Baby Brezza Bottle Washer**

Components

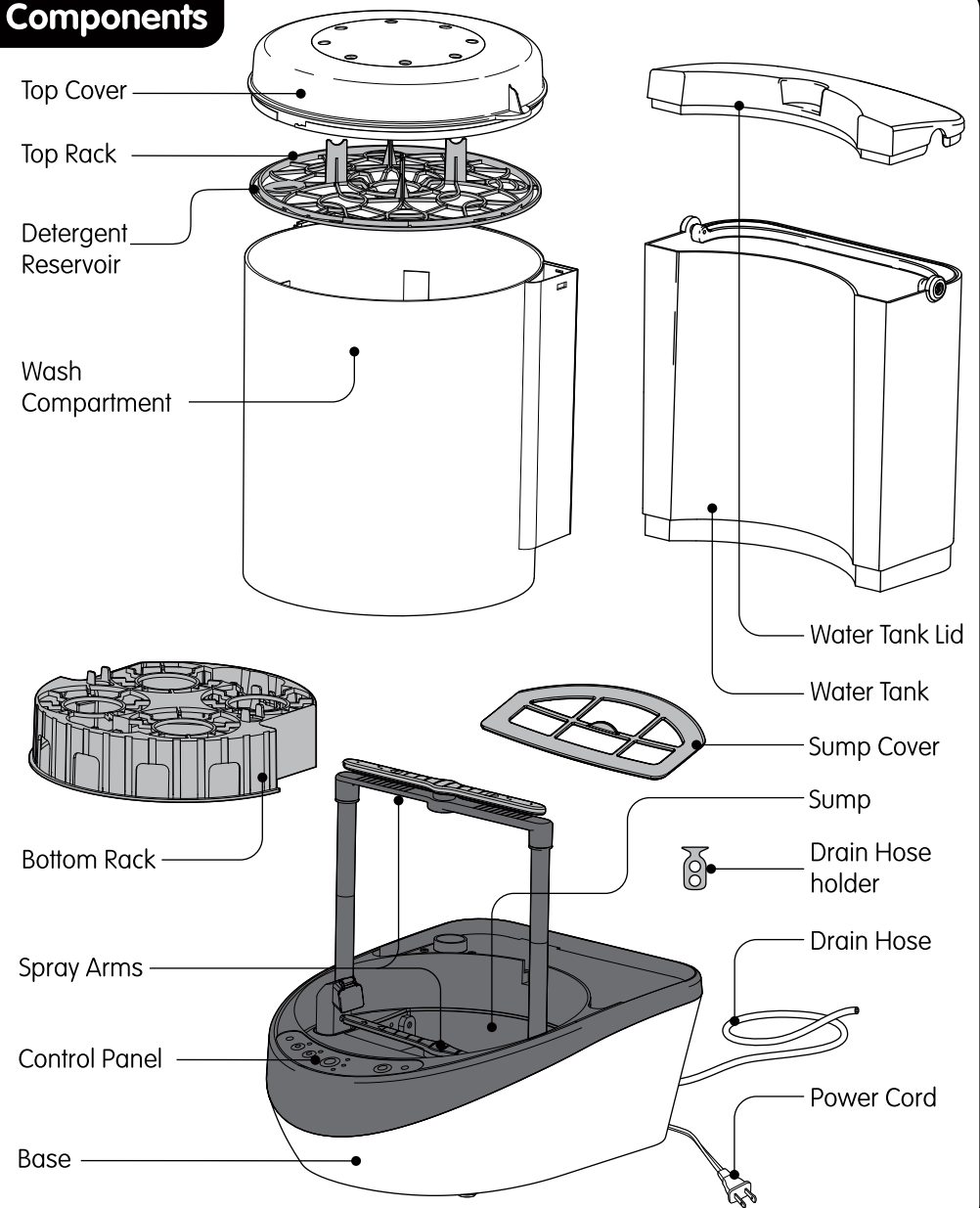

TECHNICAL DATA

Supply voltage: 120V ~ 60Hz

Model: BRZ00138

Current: 5A

Power - Heater : 600W

Controls + LED Icons

Assembly Error LED

Illuminates when lid or wash compartment is not placed securely

Sterilize LED

Dry LED

Wash Mode LEDs

No Water Icon

Illuminates when water is below MIN line.

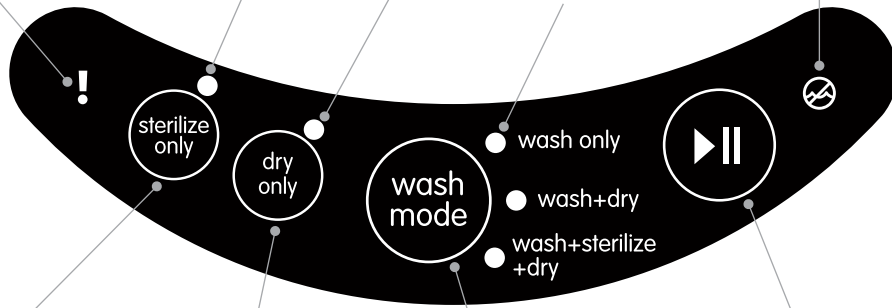

Sterilize Only Button

Press once then press Start button to begin sterilize cycle.

Dry Only Button

Press once then press Start button to begin dry cycle.

Wash Mode Button

Press repeatedly to cycle through wash mode options.

Start/Pause Button

Start or Pause operation.

Set Up + Use

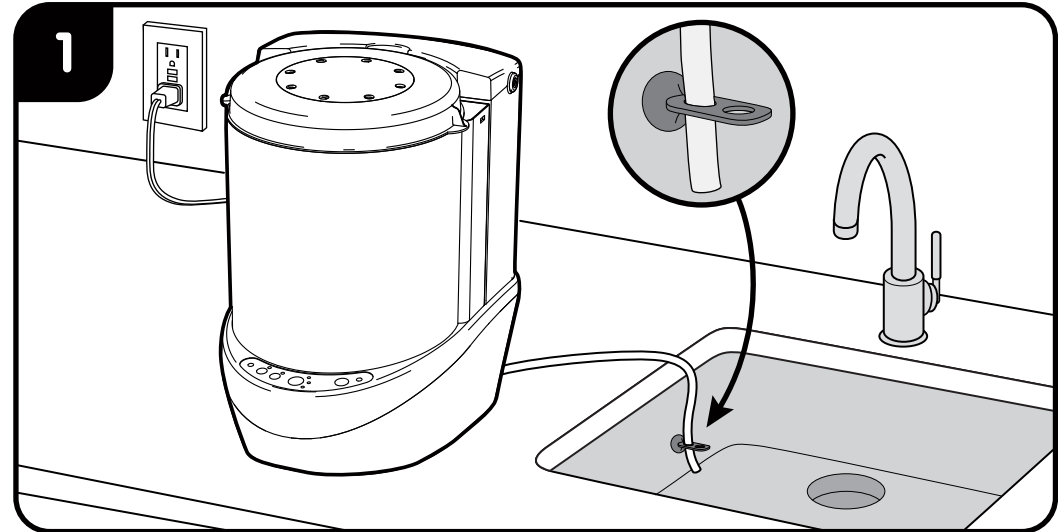

Place the bottle washer on a clean, dry, level surface close to a kitchen sink.

Connect one end of drain hose to back/bottom of unit, secure the other end of the drain hose to the sink wall with the drain hose holder.

Make sure the drain hose is aimed downwards or at the sink drain.

Plug power cord into an electrical outlet away from water source.

Air filter

Clean filter once a month - see page 9 for details.

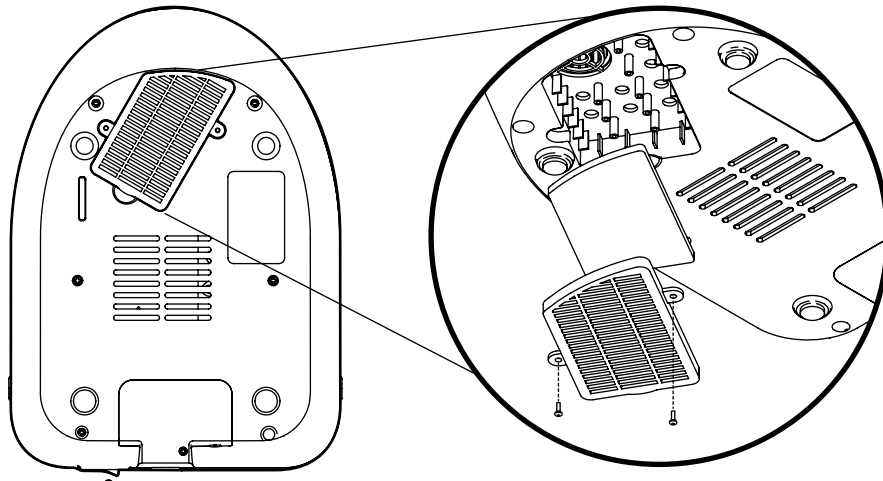

Power Switch

Filter and Filter Cover
(Remove 2 screws to clean filter)

2

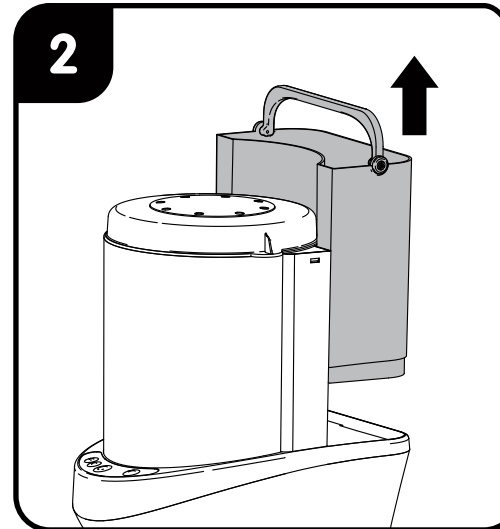

Remove water tank lid and pull the water tank up by the handle.

3

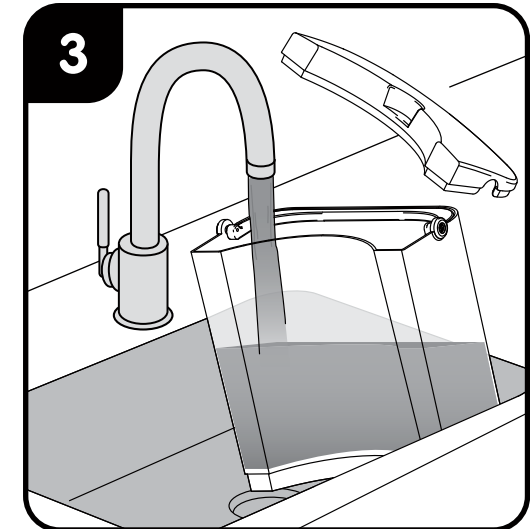

Fill the water tank with clean TAP WATER to the max line.

DO NOT USE DISTILLED WATER

Set Up + Use

4

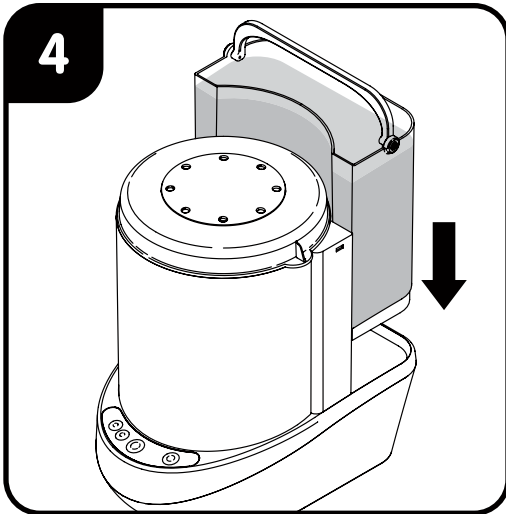

Place filled water tank back onto the base and replace the water tank lid.

5

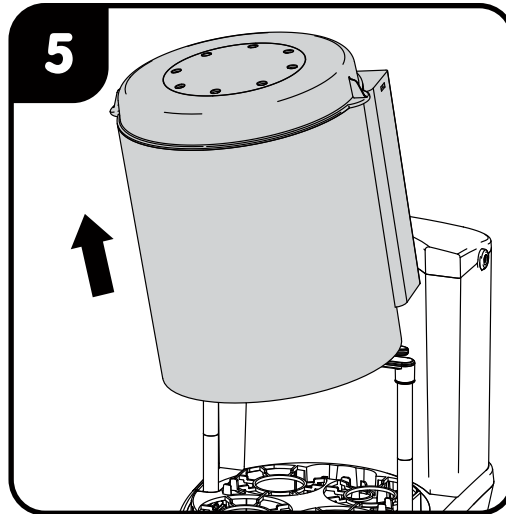

Remove wash compartment by lifting straight up.

7a

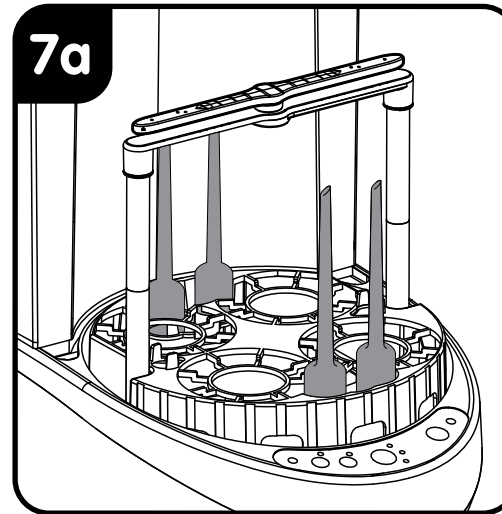

Tall bottle vent tubes should be placed on insets the front & back of the bottom rack.

7b

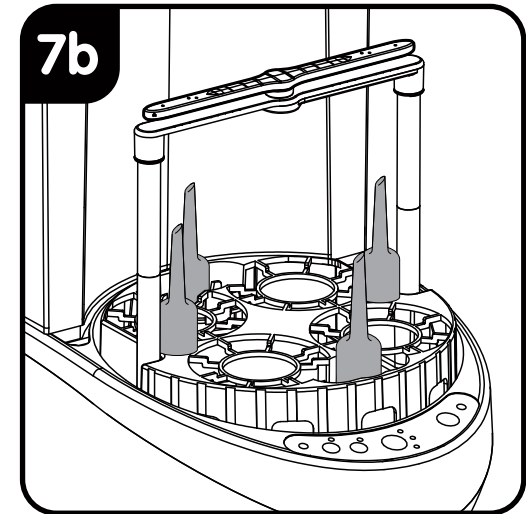

Short bottle vent tubes should be placed on insets on the front, back & sides of the bottom rack.

6a

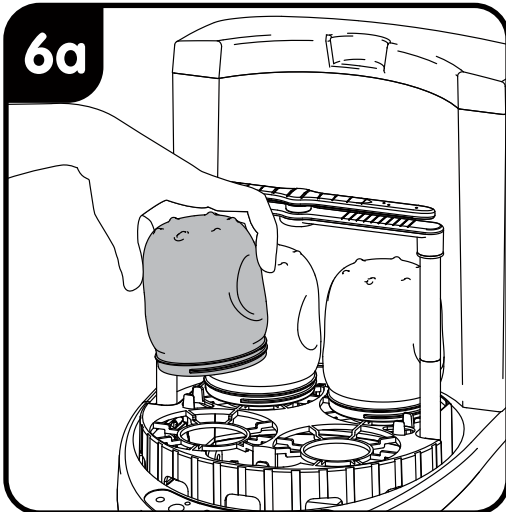

Place bottles on bottom rack, centered on rings.

6b

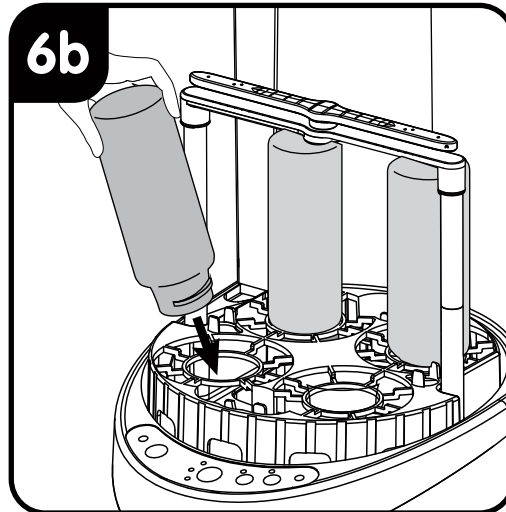

Narrow neck bottles can be placed through the center rings on the bottom rack.

8

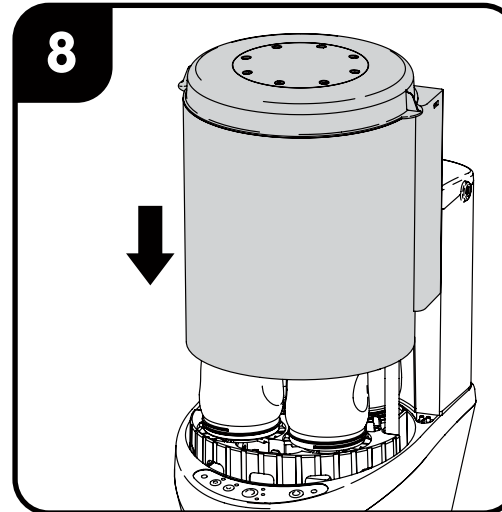

Place wash compartment back onto base.

9

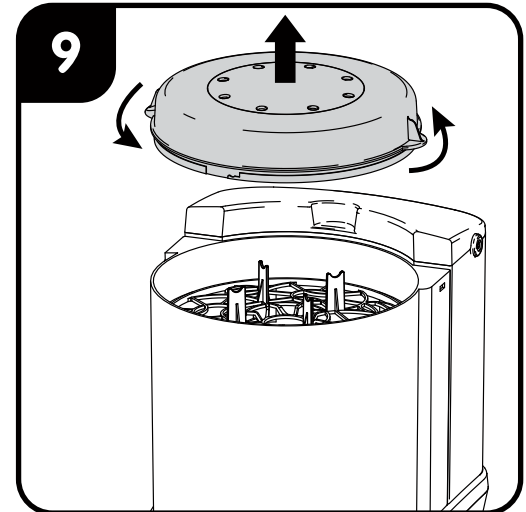

Remove the top cover from the wash compartment by twisting counter-clockwise and lifting up.



Do not place more than 4 bottles on bottom rack. See pages 6 and 7 for accessory placement.

Set Up + Use

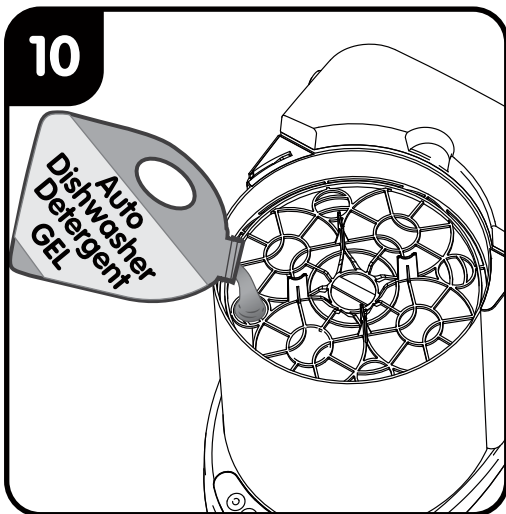

10

Fill detergent reservoir with automatic dishwasher detergent. **GEL DETERGENT WORKS BEST.**



CAUTION: Never use handwashing dish soap or any foaming soap.

Fill detergent reservoir to edge. **Do not overfill.** Never use handwashing dish soap or any foaming soap.

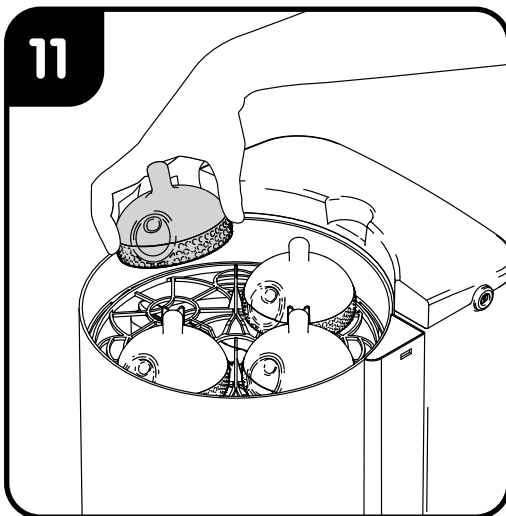

11

Place nipples & collars on the top rack. **ALWAYS PLACE NIPPLES POINTING UP**

Make sure the top rack is placed securely, level and not tilted.

Do not overfill top rack with accessories.

Do not let accessories protrude through the top and bottom racks.

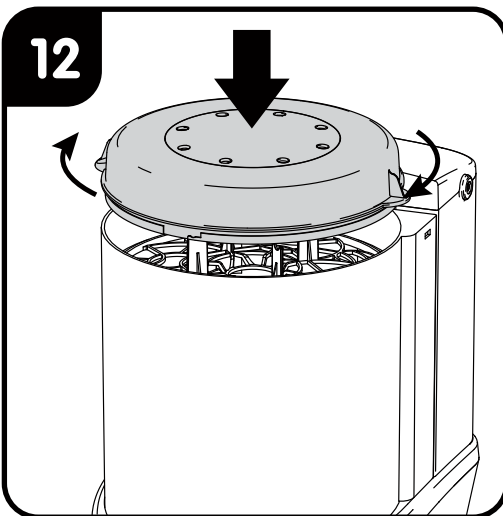

12

Place the top cover back onto the wash compartment and secure it by turning the top cover clockwise.

Choosing the Wash Cycle

CAUTION: Always make sure drain hose is placed properly in sink before starting any wash cycle.

All wash cycles start by draining any residual water from the sump. Make sure drain hose is not crimped or blocked in any way and is clean and clear of any debris. Waste water must be evacuated freely through this hose to ensure that bottles are cleaned properly.

Press the "Wash Mode" button until the desired mode LED is illuminated, then press ► || to start the cycle.

LEDs inside wash compartment will flash when water is filling and draining. The machine is silent when filling and will take about 2 minutes to begin spraying.

- **Wash only:** Washes and rinses bottles without sterilizing or drying. Complete cycle time: approximately 40 minutes.
- **Wash+Dry:** Washes, rinses, and dries bottles without a sterilization cycle. Complete cycle time: approximately 1 hour 45 minutes.
- **Wash+Sterilize+Dry:** Washes, rinses, sterilizes, and dries bottles. Complete cycle time: approximately 2 hours.

If you want to use the **Sterilize only** & **Dry only** cycles separately, press the desired cycle button then press ► || to start. The Sterilize cycle is approximately 20 minutes. The Dry cycle is approximately 1 hour 20 minutes.

Sterilize and Dry functions can be used together: Press the "Sterilize" button, followed by the "Dry" button, then press ► || to start. After the sterilization cycle is complete, the drying function will begin automatically.

If you want to pause the bottle washer during operation, press ► ||. The cover can be removed to insert or remove bottles and accessories. Operation will resume when the cover is placed back on base.



The bottle washer uses HOT WATER and STEAM to wash and sterilize bottles & accessories.



USE CAUTION when handling bottles after washing, sterilizing and/or drying in this bottle washer.

Cleaning the Bottle Washer

Make sure to keep your bottle washer clean.

Check the sump regularly - every few days or at least once a week - and make sure there is no residue or excessive build up of minerals.

- Always unplug the bottle washer before cleaning.
- Do not immerse the base or power cord in water or other liquids.
- Do not clean base under water tap.
- Use a soft damp cloth to clean the base and control panel.
- Never use solvents, cleaning products, or abrasive pads to clean the plastic parts of the machine as they may damage the appliance and surface of the base.
- The top cover, bottom rack, and top rack can be cleaned in hot soapy water.
- Drain hose can be removed from base and washed with hot soapy water.
- Dismantle the filter box and clean the filter once a month by rinsing it in clean water. Make sure the filter is completely dry before placing back to the filter box. Refer to page 3 for filter components.
- The heating element and sump should be cleaned regularly to remove mineral scale.
- To clean the sump, remove the sump cover and wipe any residue from the interior walls.
- To remove mineral scale from the heating element, pour a mixture of 1/3 cups white vinegar and 1/3 cups water into the sump. Let mixture sit overnight. Fill the water tank to max line and run one "wash only" cycle to complete sump cleaning.
- Stainless steel heating element can be gently scrubbed with an abrasive scouring pad to remove any remaining mineral scale.

If the upper or lower spray arms stop spinning, check the holes on the side of each end and make sure that they are not blocked with debris.*

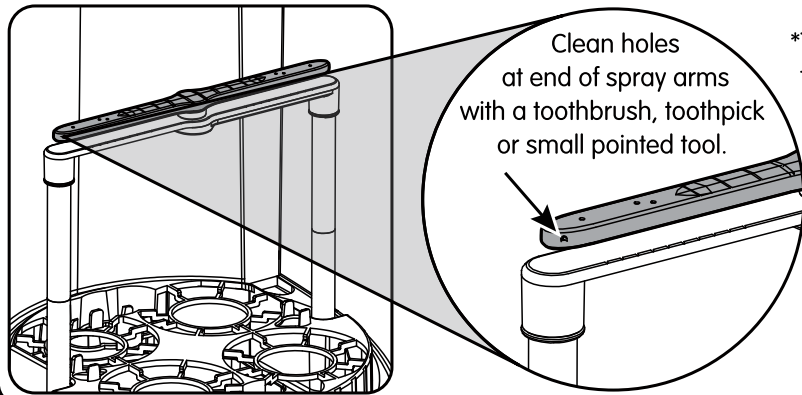

*To prevent the holes from being blocked, always rinse bottles and accessories before placing in the bottle washer and make sure there is no debris that may clog the spray arms.

Troubleshooting

Condition	Possible Cause	Remedy
Bottle Washer will not start.	Unit is unplugged.	Make sure the plug is securely inserted into the power outlet.
	Unit is not turned on.	Turn power switch located on back of unit to on position.
	Insufficient water is in water tank.	Add water to max line of water tank.
Scaling on heating element.	Mineral rich water used persistently.	Clean heater plate after each use.
	Bottles not rinsed before placed in bottle washer, excess milk poured in bottle washer.	Rinse all bottles and accessories before placing in bottle washer.
Assembly Error icon "!" is on.	Wash Compartment is not securely assembled on base.	Ensure that all parts are assembled into place securely. Do not over fill Wash Compartment with bottle parts and accessories.
	Wash Compartment Lid is not properly assembled on base.	
No Water icon "⊘" is on.	Water Tank is low or empty.	Refill Water Tank to the Max Fill line.
	Water Tank is not assembled securely on base.	Make sure Water Tank is assembled on base securely.
Spray arms not rotating.	Spray arms are physically blocked.	Make sure bottles / accessories are not protruding through top or bottom racks, or contacting spray arms in any way.
		Make sure the top rack is not tilted and blocking upper spray arm.
	Spray arm jets are blocked.	Clean jets with brush, small pointed tool or toothpick. See cleaning detail on page 9.
Bottle Washer is not draining.	Drain Hose is blocked or crimped.	Disconnect Drain hose from Base, clean hose of any debris or build up, and reconnect to base. Make sure hose is not crimped or compressed in any way.
Excessive soap bubbles & foam in wash compartment.	Wrong type of detergent/soap used.	Use GEL AUTOMATIC DISHWASHER DETERGENT only. Never use foaming dish detergent or any other soap that foams.
	Too much detergent/soap used.	Do not overfill detergent reservoir.
Bottles and/or top rack items not dry.	Nipples or parts placed upside-down on top rack collect excess water. Indentations on bottom of some bottle types collect excess water, elongating drying time.	Always place nipples & accy's in a position to eliminate collecting or pooling water. An extra dry cycle may be needed for bottles with deep base indentations.