

# babybrezza® *superfast* sterilizer-dryer

Please visit  
[babybrezza.com](http://babybrezza.com)

## ACTIVATE YOUR WARRANTY

Scan here



[www.babybrezza.com/register](http://www.babybrezza.com/register)

**Benefits:** Faster customer support,  
extended customer service hours & more



## Instructions

**PLEASE NOTE:** All bottles, pump parts & accessories must be empty, clean and rinsed before use in this sterilizer-dryer

# IMPORTANT SAFEGUARDS - READ ALL INSTRUCTIONS

When using electrical appliances, basic safety precautions should always be followed, including:

- Always use the steam sterilizer dryer on a flat surface.
- DO NOT expose the sterilizer dryer to a source of heat such as a radiator or sun shining through a window.
- To protect against risk of electrical shock, NEVER put sterilizer power base in water or other liquid.
- Clean the sterilizer dryer with a dry cloth.
- This appliance shall not be used by children. Keep the appliance and its cord out of reach of children.
- Appliances can be used by persons with reduced physical, sensory or mental capabilities or lack of experience and knowledge if they have been given supervision or instruction concerning use of the appliance in a safe way and understand the hazards involved.
- Children shall not play with the appliance. Cleaning and user maintenance shall not be made by children without supervision.
- If the power cord is damaged, it must be replaced by the manufacturer, its service agent or similarly qualified persons in order to avoid a hazard.
- NEVER use detergent or corrosive substances to clean the steam sterilizer dryer.
- NEVER use the machine without water.
- The sterilizer will stop automatically with a warning signal in case of no water or not enough water and the heater plate boils dry. If this happens, please run a complete sterilizing cycle with 120ml (4oz) water to ensure proper sterilizing is achieved.
- Please always fill with 120ml (4oz) of water or otherwise it may alter the sterilization quality.
- Unplug the sterilizer dryer from outlet when not in use, before cleaning or changing accessories.
- DO NOT operate the sterilizer dryer with a damaged cord or plug or after appliance malfunctions, or is dropped or damaged in any manner. Return appliance to the nearest Authorized Service Center for examination, repair or electrical or mechanical adjustment.
- Any servicing should be performed by an authorized service representative.
- NEVER unplug the product during the sterilizing cycle or otherwise it will reset the sterilizing cycle. In case of mistakenly unplugging of the product during the sterilizing cycle, you need to restart the sterilizing cycle completely again to ensure a correct sterilizing quality is achieved.
- Use of any attachments, not recommended or sold by the manufacturer may cause fire, electric shock or injury.
- DO NOT use outdoors.
- Working and storage environment temperature: 50° F - 95° F (10° C - 35° C)
- DO NOT let cord hang over edge of table or counter.
- DO NOT let cord contact any hot surface.
- Ensure nothing is rested on the heating element surface (the stainless-steel surface on the base) before starting the sterilizing process.
- When in use, the sterilizer dryer contains boiling water and hot steam will escapes from the vent in the lid. NEVER touch the Lid, open the Lid, or stand over the appliance when in use.
- Take care when opening as steam can burn and bottles/contents can be hot after Sterilize & Dry cycle.
- NEVER touch the stainless-steel heating element when appliance is on, during or just after use.
- NEVER place any items on top of the sterilizer dryer.
- If it is necessary to stop the sterilizer during any cycle, press the button then unplug from the power outlet.
- NEVER tilt the appliance backwards.
- NEVER run the appliance without Filter tray.
- Do not spill water when filling, especially near power outlets.
- Misuse or use other than described in these instructions may cause injury.
- The heating element surface is subject to residual heat after use. Always allow unit to cool before handling.
- Allow appliance to cool between uses and do not use more than 2 times in 1 hour.
- The recommended maximum capacity is 6 bottles and accessories.
- Wash hands before touching sterilized parts.

THIS PRODUCT IS INTENDED FOR HOUSEHOLD USE ONLY

## SAVE THESE INSTRUCTIONS

- a) A short power-supply cord (or short detachable power-supply cord) is provided to reduce the risks resulting from becoming entangled in or tripping over a longer cord.
- b) Extension cords (or longer detachable power-supply cords) are available and may be used if care is exercised in their use.
- c) If an extension cord (or a long detachable power-supply cord) is used:
  - 1) The marked electrical rating of the detachable power-supply cord or extension cord should be at least as great as the electrical rating of the appliance;
  - 2) If the appliance is of the grounded type, the extension cord should be a grounding-type 3-wire cord; and
  - 3) The longer cord should be arranged so that it will not drape over the countertop or tabletop where it can be tripped over, snagged, or pulled on unintentionally (especially by children).

## Superfast Sterilizer Dryer Parts

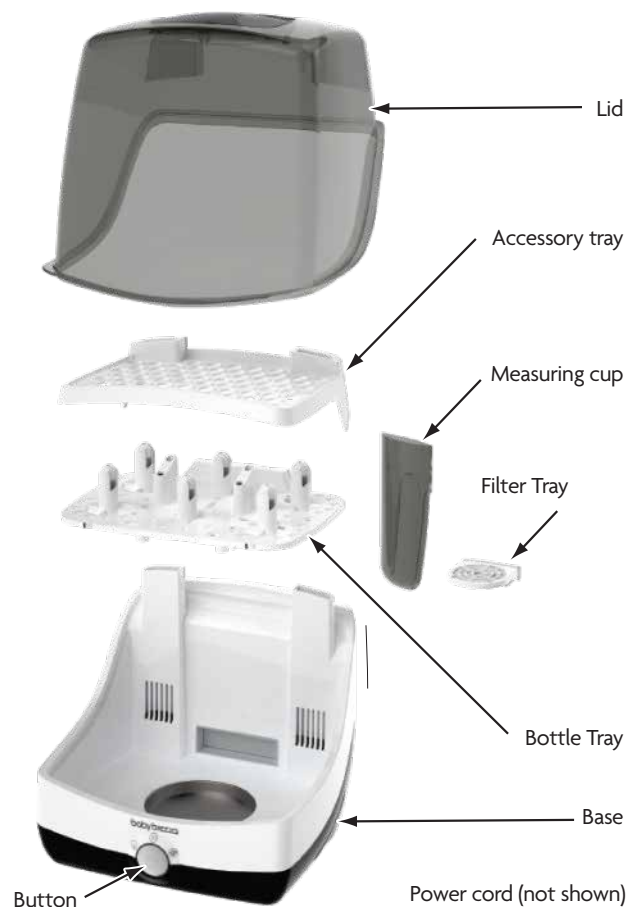

### TECHNICAL DATA

Supply voltage: 120V ~ 60Hz

Model: BRZ0083



Power: 1500W

### Set-up and Use

Prior to first use, wash Lid, Bottle Tray, Accessory Tray, and Measuring Cup.

**Before placing items in the appliance for sterilization it is important that all bottles, pump parts and accessories must be EMPTY, CLEAN & FULLY RINSED BEFORE USE in this sterilizer dryer.**

Standby mode: When the appliance is plugged in, all LEDs flash for 0.5 seconds then enters standby mode.

1. Place the appliance on a flat surface where it is out of reach of children and it will not be knocked or moved during operation.
2. Remove the lid, and Bottle Tray from the sterilizer base.
3. Fill Measuring Cup to max line and pour 120ml/4oz water on the base/heater surface. Do not overfill. We recommend using distilled water to avoid mineral scale build-up on the heating plate. However, you can use bottled water or tap water but you may need to descale more frequently.
4. Place the Bottle Tray on the base.
5. Place clean bottles with their opening facing downward over the nozzles on the Bottle Tray (Do not place more than 6 bottles on the Bottle Tray).
6. Place accessories on the Accessory Tray (nipples, collars, caps, etc)
7. Place the Lid securely on the base.
8. Press the Button repeatedly to select your desired mode:  
Sterilize & Dry , Sterilize Only , Dry Only   
The selected function will start automatically after 3 seconds.

### Automatic Sterilize & Dry Function:

Press the Button one time for Automatic Sterilize & Dry mode. 

The red LED switches on and the Sterilize cycle runs for approximately 5m 30s.

After Sterilizing, the LED changes to blue, the Dry cycle begins automatically and runs for approximately 4m 30s. After Drying the appliance turns off and enters standby mode. If the button is pressed at any point during the cycle the appliance stops and enters standby mode.

### Sterilize Only Function:

Press the Button two times for Sterilize Only mode. 

The red LED switches on and the Sterilize cycle runs for approximately 5m 30s.

After sterilizing the appliance turns off and enters standby mode. If the Button is pressed at any point during the cycle the appliance stops and enters standby mode.

### Dry Only Function:

Press the Button three times for Sterilize Only mode. 

The Blue LED switches on and the Dry cycle runs for approximately 6 minutes.

If the Button is pressed at any point during the cycle the appliance stops and enters standby mode.

**After each use, pour away any remaining water from the base. Always POUR AWAY FROM FAN OPENING.**

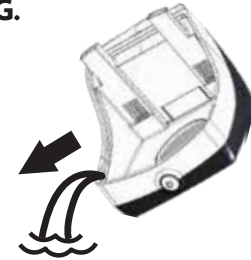

### Cleaning

- Always unplug the sterilizer dryer before cleaning.
- Do not immerse the base, the power cord or the plug in water or other liquids.
- Do not clean base under water tap.
- Use a soft damp cloth to clean the base and control console.
- Never use abrasive pads to clean the plastic parts of the machine.
- The Lid, Bottle Tray, and Accessory Tray can be cleaned in hot soapy water.
- Mineral residue, particularly in hard water areas, may deposit on the heating plate after a few sterilization cycles. To avoid scale build up, wipe the surfaces with a soft moist cloth after each operation.
- Deposits can be removed with scale removers or by leaving 60ml/2oz water and vinegar solution (50/50 water & vinegar mix) on the heating plate for approximately 30 minutes. The plate should then be wiped clean with a clean, dry cloth. Some discoloration spots may remain after cleaning with a vinegar solution, but these are harmless.
- Do not use abrasives or solvents for cleaning; they may damage the appliance and the surface of the heating plate.
- Before plugging in the sterilizer again make sure the base unit is completely dry.
- The filter can be removed and rinsed clean with water once a week. Make sure filter is completely dry before replacing.

## Descaling

- Using filtered water with your sterilizer can reduce mineral scale build up.
- You should descale your sterilizer every 3 weeks to ensure it works efficiently
- Mineral scale build-up may affect the operation of the sterilizer and cause it to shut off prematurely.
- Mineral scale can be removed with the Baby Brezza Descaler (available for purchase on [www.babybrezza.com](http://www.babybrezza.com)) or by leaving 60ml water & 60ml vinegar solution on the heating plate and let it sit for approximately 30 minutes. The plate should then be wiped with a clean, dry cloth. Some discoloration or spots may remain after cleaning with a vinegar solution, but these are harmless. Then rinse and wipe out the sterilizer and it is ready for use again.

## Troubleshooting

Condition	Possible Cause	Remedy
Appliance will not start.	Unit is unplugged.	Make sure the plug is securely inserted into the power outlet.
	Insufficient water is in heater plate area.	Add 120ml (4oz) water to heater plate area.
Unit stops during sterilize cycle. "No Water Indicator" on.	Not enough water added to heater plate area.	Make sure to fill to max line, at least 120ml (4oz) water to heater plate area.
Scaling on heater plate.	Mineral rich water used persistently.	Clean heater plate after each use and use distilled water.
Items not dry after drying cycle.	Water is collecting on recessed or indented areas of items placed in sterilizer.	Make sure parts are placed so they they do not collect water.
	Too many items in sterilizer blocking air flow.	Use only 6 bottles and accessories and make sure bottles are placed over nozzles on bottle tray.
All LEDs flashing continuously.	Not enough water added to base.	Let the Sterilizer Dryer cool, add 120ml (4oz) water to heater plate area and run sterilize & dry again.

If you can not remedy problems with the machine by using the troubleshooting chart above, please contact Customer Service at 1-888-396-6552 or email [cs@babybrezza.com](mailto:cs@babybrezza.com). Any other servicing should be performed by an authorized service representative.

## Limited 1-Year Warranty

The limited warranty is valid only on products bought through authorized resellers and used in the United States and Canada. Buying through an unauthorized reseller or using this product outside of the United States and Canada automatically voids this warranty.

This warranty is available to consumers only. You are a consumer if you own a Baby Brezza appliance that was purchased at retail for personal, family or household use. Except as otherwise required under applicable state law, this warranty is not available to retailers or other commercial purchasers or owners. We warrant that your Baby Brezza appliance will be free of defects in material or workmanship under normal home use for one year from the date of original purchase.

Customer will be required to present original proof of purchase in order to obtain the warranty benefits. In the event that you do not have proof of purchase date, the purchase date for purposes of this warranty will be the date of manufacture. If your Baby Brezza appliance should prove to be defective within the warranty period, we will repair it or, if we consider it necessary, replace it. To obtain warranty services, please call Customer Service at 1-888-396-6552 or write to: Baby Brezza, 250 Passaic Street, Newark, NJ 07104 Attn: Customer Service.