

TECHNICAL SERVICE BULLETIN



BCS Two Wheel Tractors PowerSafe® models OPC Operating Cable Adjustment

Symptom: No drive to the tines and/or wheels.

Solution: Cable adjustment.

1. On top of the PowerSafe® clutch unit on the gearbox are 2 operating arms, one is for the operation of the clutch and one for the activation of the Operator Presence Control (OPC).
2. With the engine turned OFF pull the clutch lever up and depress the OPC lever down fully. The clutch and OPC levers need to be kept in this position by assistance from a colleague or by using a cable tie, elastic band, or equivalent.
3. With the clutch lever and OPC levers depressed check by using finger pressure that the OPC operating arm on the PowerSafe® clutch unit is not able to be rotated any further **anti-clockwise**, a firm stop should be able to be felt.
4. If there is any **anti-clockwise** movement of the OPC operating arm on the PowerSafe® clutch unit a simple cable adjustment is required. Using the cable adjuster on top of the gearbox adjust the OPC operating cable until the OPC operating arm on top of the PowerSafe® clutch unit is no longer able to move **anti-clockwise**.

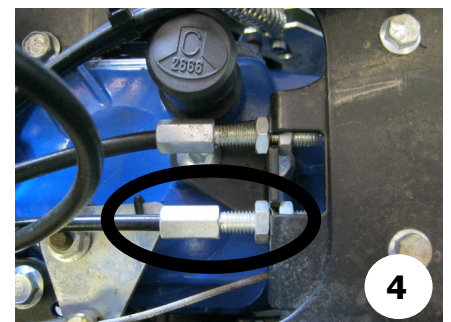
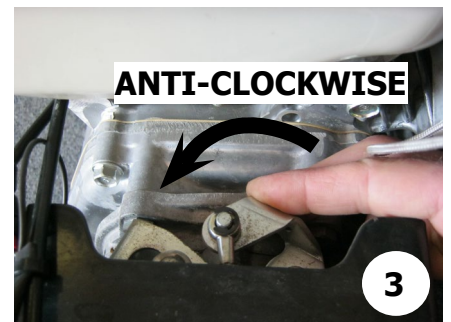
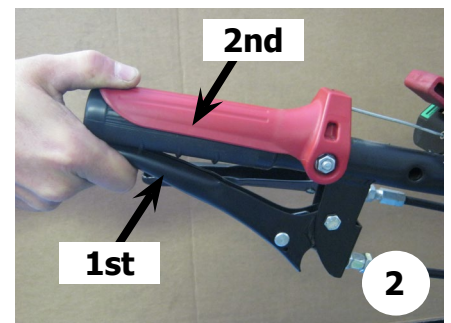
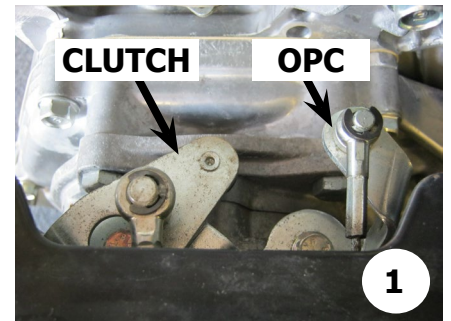

If you require any further assistance please contact our Technical Team via email technical@tracmaster.co.uk or telephone 01444 247689.