

# SPROCKET

# NO.60

## Stock Bore

## 3/4" PITCH

### Single Type-A

No. Teeth	Catalog No.	Outside Dia. Do	Pitch Dia.	Stock Bore d	Weight Lbs.
8	60A8	2.260	1.959		
9	60A9	2.510	2.193		
10	60A10	2.760	2.427	3/4	.44
11	60A11	3.000	2.663	3/4	.54
12	60A12	3.250	2.898	3/4	.68
13	60A13	3.490	3.134	3/4	.80
14	60A14	3.740	3.371	3/4	.94
15	60A15	3.980	3.608	3/4	1.08
16	60A16	4.220	3.845	3/4	1.24
17	60A17	4.460	4.082	3/4	1.44
18	60A18	4.700	4.319	3/4	1.62
19	60A19	4.950	4.557	3/4	1.84
20	60A20	5.190	4.794	3/4	2.12
21	60A21	5.430	5.033	3/4	2.28
22	60A22	5.670	5.270	3/4	2.48
23	60A23	5.910	5.508	3/4	2.68
24	60A24	6.150	5.746	23/32	3.00
25	60A25	6.390	5.984	23/32	3.34
26	60A26	6.630	6.222	23/32	3.54
27	60A27	6.870	6.461	23/32	3.96
28	60A28	7.110	6.698	23/32	4.14
29	60A29	7.350	6.937	23/32	4.40
30	60A30	7.590	7.175	23/32	4.78
31	60A31	7.830	7.413	23/32	5.24
32	60A32	8.070	7.652	23/32	5.52
33	60A33	8.300	7.890	15/16	5.86
34	60A34	8.540	8.129	15/16	6.16
35	60A35	8.780	8.367	15/16	6.78
36	60A36	9.020	8.606	15/16	6.82
37	60A37	9.260	8.844	15/16	7.52
38	60A38	9.500	9.083	15/16	7.84
39	60A39	9.740	9.321	15/16	8.28
40	60A40	9.980	9.560	15/16	8.56
41	60A41	10.220	9.798	15/16	9.10
42	60A42	10.460	10.037	15/16	9.84
43	60A43	10.700	10.271	15/16	9.74
44	60A44	10.940	10.514	15/16	10.76
45	60A45	11.180	10.752	15/16	11.08
46	60A46	11.420	10.991	15/16	11.50
47	60A47	11.650	11.229	15/16	12.32
48	60A48	11.890	11.468	15/16	12.42
49	60A49	12.130	11.706	15/16	12.92
50	60A50	12.370	11.945	15/16	13.98
51	60A51	12.610	12.183	15/16	14.58
52	60A52	12.850	12.422	15/16	14.60
53	60A53	13.090	12.660	15/16	15.84
54	60A54	13.330	12.899	15/16	15.92
55	60A55	13.570	13.137	1 1/4	16.96
56	60A56	13.810	13.376	1 1/4	17.60
57	60A57	14.040	13.615	1 1/4	17.62
58	60A58	14.280	13.853	1 1/4	19.00
59	60A59	14.520	14.092	1 1/4	19.20
60	60A60	14.760	14.330	1 1/4	20.02
64	60A64	15.720	15.285	1 1/4	23.00
65	60A65	15.960	15.524	1 1/4	23.24
66	60A66	16.190	15.762	1 1/4	24.42
68	60A68	16.670	16.240	1 1/4	25.54
70	60A70	17.150	16.717	1 1/4	27.20
72	60A72	17.630	17.195	1 1/4	28.90
76	60A76	18.580	18.149	1 1/4	32.34
80	60A80	19.540	19.103	1 1/4	45.50
84	60A84	20.490	20.058	1 1/4	40.18
90	60A90	21.930	21.490	1 1/4	43.44
96	60A96	23.360	22.922	1 1/4	52.02
112	60A112	27.180	26.742	1 1/4	70.80

### Single Type-B

Catalog No.	Bore: d (inches)		Hub (inches)		Weight Lbs.
	Stock	Rec Max	Dia Dh	LTB. L	
60B8	5/8	5/8	1 15/32 *	1 1/4	.54
60B9	3/4	7/8	1 9/16 *	1 1/4	.64
60B10	3/4	1 1/8	1 15/16 *	1 1/4	.99
60B11	3/4	1 5/16	2 1/16 *	1 1/4	1.16
60B12	3/4	1 3/8	2 3/8 *	1 1/4	1.47
60B13	3/4	1 1/2	2 11/32	1 1/4	1.66
60B14	3/4	1 3/4	2 9/16	1 1/4	2.00
60B15	3/4	1 7/8	2 7/8	1 1/4	2.51
60B16	3/4	2	3 1/16	1 1/4	2.81
60B17	3/4	2 1/4	3 1/4	1 1/4	3.22
60B18	3/4	2 3/8	3 1/2	1 1/4	3.72
60B19	3/4	2 5/8	3 1/2	1 1/4	3.92
60B20	3/4	2 3/4	3 7/8	1 1/4	4.63
60B21	3/4	2 3/4	4	1 1/4	5.00
60B22	3/4	2 3/4	4	1 1/4	5.25
60B23	3/4	2 3/4	4	1 1/4	5.48
60B24	3/4	2 3/4	4	1 1/4	5.78
60B25	3/4	2 3/4	4	1 1/4	6.13
60B26	3/4	2 3/4	4	1 1/4	6.38
60B27	3/4	2 3/4	4	1 1/4	6.72
60B28	3/4	2 3/4	4	1 1/4	6.88
60B29	3/4	2 3/4	4	1 1/4	7.28
60B30	3/4	2 3/4	4	1 1/4	7.58
60B31	3/4	2 3/4	4	1 1/4	7.72
60B32	3/4	2 3/4	4	1 1/4	8.26
60B33	1	2 3/4	4	1 1/4	8.42
60B34	1	2 3/4	4	1 1/4	8.80
60B35	1	2 3/4	4	1 1/4	9.04
60B36	1	2 3/4	4	1 1/4	9.60
60B37	1	2 3/4	4	1 1/4	10.24
60B38	1	2 3/4	4	1 1/4	10.84
60B39	1	2 3/4	4 1/4	1 1/4	11.36
60B40	1	2 3/4	4 1/4	1 1/4	11.50
60B41	1	2 3/4	4 1/4	1 1/4	12.14
60B42	1	2 3/4	4 1/4	1 1/4	12.74
60B43	1	2 3/4	4 1/4	1 1/4	13.35
60B44	1 5/16	2 3/4	4 1/4	1 1/4	13.88
60B45	1 5/16	2 3/4	4 1/4	1 1/4	13.98
60B46	1 5/16	2 3/4	4 1/4	1 1/4	14.60
60B47	1 5/16	2 3/4	4 1/4	1 1/4	15.00
60B48	1 5/16	2 3/4	4 1/4	1 1/4	15.82
60B49	1 5/16	2 3/4	4 1/4	1 1/4	16.70
60B50	1 5/16	2 3/4	4 1/4	1 1/4	17.66
60B51	1 5/16	2 3/4	4 1/4	1 1/4	18.60
60B52	1 5/16	2 3/4	4 1/4	1 1/4	19.66
60B53	1 5/16	2 3/4	4 1/4	1 1/4	20.66
60B54	1 5/16	2 3/4	4 1/4	1 3/4	21.60
60B55	1 1/4	2 3/4	4 1/4	1 3/4	21.75
60B56	1 1/4	2 3/4	4 1/4	1 3/4	21.88
60B57	1 1/4	2 3/4	4 1/4	1 3/4	22.88
60B58	1 1/4	2 3/4	4 1/4	1 3/4	23.80
60B59	1 1/4	2 3/4	4 1/4	1 3/4	24.65
60B60	1 1/4	2 3/4	4 1/4	1 3/4	25.22
60B64	1 1/4	2 3/4	4 1/4	1 3/4	27.40
60B65	1 1/4	2 3/4	4 1/4	1 3/4	28.92
60B66	1 1/4	2 3/4	4 1/4	1 3/4	29.65
60B68	1 1/4	2 3/4	4 1/4	1 3/4	30.38
60B70	1 1/4	2 3/4	4 1/4	1 3/4	31.98
60B72	1 1/4	2 3/4	4 1/4	2	34.18
60B76	1 1/4	2 3/4	4 1/4	2	38.06
60B80	1 1/4	2 3/4	4 1/4	2	41.88
60B84	1 1/4	3 1/4	4 3/4	2	46.46
60B90	1 1/4	3 5/16	5	2 1/4	63.20
60B96	1 1/4	3 3/4	5 1/2	2 1/4	63.08
60B112	1 1/4	3 3/4	5 1/2	2 1/4	81.78

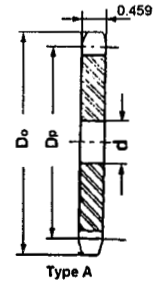

Type A

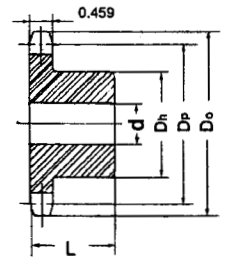

Type B

\* Has recessed groove in hub for chain clearance.