



USA
Bearings
& Belts
"We get things moving!"

SPROCKET

NO.50

Stock Bore

5/8" PITCH

Double Type-B

No Of Teeth	Catalog Num.	Pitch Dia Dp	Outside Dia Do	TYPE	Double Type B				Wt(App) (lbs)
					Bore: d		HUB		
					Min	Max	Dh	L	
11	D50B11	2.219	2.500	B	5/8	15/16	115/32	13/4	0.96
12	D50B12	2.415	2.710	B	5/8	11/8	111/16	13/4	1.25
13	D50B13	2.612	2.910	B	5/8	15/16	17/8	13/4	1.56
14	D50B14	2.803	3.110	B	5/8	13/8	21/16	13/4	1.86
15	D50B15	3.006	3.320	B	3/4	11/2	25/16	13/4	2.22
16	D50B16	3.204	3.520	B	3/4	13/4	21/2	13/4	2.62
17	D50B17	3.401	3.720	B	3/4	17/8	211/16	13/4	3.04
18	D50B18	3.599	3.920	B	3/4	115/16	215/16	13/4	3.58
19	D50B19	3.797	4.120	B	1	21/8	31/8	13/4	3.90
20	D50B20	3.995	4.320	B	1	21/4	31/4	13/4	4.26
21	D50B21	4.194	4.520	B	1	23/8	31/2	13/4	4.90
22	D50B22	4.392	4.720	B	1	23/8	39/16	17/8	5.58
23	D50B23	4.590	4.920	B	1	21/2	35/8	17/8	6.10
24	D50B24	4.788	5.120	B	1	21/2	35/8	17/8	6.50
25	D50B25	4.987	5.320	B	1	21/2	35/8	17/8	6.94
26	D50B26	5.185	5.520	B	1	21/2	33/4	17/8	7.54
30	D50B30	5.979	6.320	B	1	21/2	33/4	17/8	9.40
32	D50B30	6.376	6.720	B	1	21/2	33/4	17/8	10.46
35	D50B35	6.972	7.320	B	1	21/2	33/4	17/8	12.28
36	D50B36	7.171	7.520	B	13/16	23/4	4	21/8	13.94
40	D50B40	7.966	8.320	B	13/16	23/4	4	21/8	16.54
42	D50B42	8.363	8.720	B	13/16	23/4	4	21/8	17.92
45	D50B45	8.960	9.310	B	13/16	23/4	4	21/8	20.30
48	D50B48	9.556	9.910	B	13/16	23/4	41/4	23/8	24.08
52	D50B52	10.351	10.710	B	13/16	23/4	41/4	23/8	27.42
54	D50B54	10.749	11.110	B	13/16	23/4	41/4	23/8	29.16
60	D50B60	11.942	12.300	B	15/16	3	41/2	23/8	35.88
68	D50B68	13.533	13.890	B	15/16	3	41/2	23/8	44.98
72	D50B72	14.329	14.690	B	15/16	3	41/2	23/8	50.22
76	D50B76	15.124	15.486	B	15/16	3	41/2	23/8	45.64
84	D50B84	16.715	17.080	B	15/16	3	41/2	23/8	51.64
95	D50B95	18.903	19.270	B	15/16	3	41/2	23/8	64.32
96	D50B96	19.102	19.470	B	15/16	3	41/2	23/8	67.42
102	D50B102	20.295	20.660	B	15/16	3	41/2	23/8	72.68
112	D50B112	22.285	22.650	B	15/16	35/16	51/4	23/8	90.22

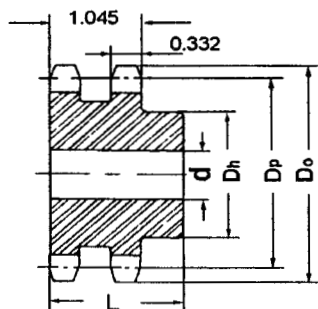

Type B