

# THREE BOLT FLANGE UNITS

## SBFCT DUCTILE IRON LIGHT DUTY SET SCREW TYPE SAFCT DUCTILE IRON LIGHT DUTY ECCENTRIC LOCKING COLLAR TYPE

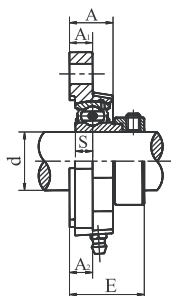
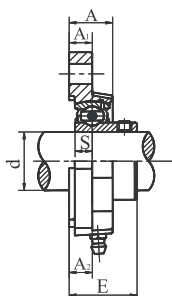
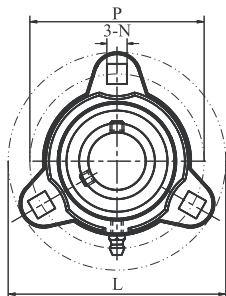

**SBFCT**  
SET SCREW TYPE

**SAFCT**  
ECCENTRIC LOCKING  
COLLAR TYPE

- Ductile iron housing
- Narrow inner ring bearing

FLANGES

Unit No.	Shaft Dia. d		Dimension (in) (mm)								Bolt Size	Bearing No.	Housing No.	Weight (lb)	
	(in.)	(mm)	L	P	A <sub>1</sub>	A	A <sub>2</sub>	N	S	E					
<b>SBFCT201G</b> 201-8G 202G 202-10G 203G 203-11G	1/2 5/8 11/16	12 15 17													
			3-3/16 81	2-1/2 63.5	13/32 10.7	3/4 19.1	13/32 10.7	9/32 7.1	1/4 6	1-1/32 26.7	1/4	SB201G 201-8G 202G 202-10G 203G 203-11G	FCT203	0.46	
<b>SBFCT204-12G</b> 204G	3/4	20	3-9/16 90.5	2-13/16 71.4	7/16 11.1	25/32 19.8	7/16 11.1	11/32 8.7	9/32 7	1-5/32 29.1	5/16	SB204-12G 204G	FCT204	0.71	
<b>SBFCT205-14G</b> 205-15G 205G 205-16G	7/8 15/16 1	25	3-3/4 95.2	3 76.2	13/32 10.3	25/32 19.8	13/32 10.3	11/32 8.7	9/32 7.5	1-3/16 29.8	5/16	SB205-14G 205-15G 205G 205-16G	FCT205	0.79	
<b>SBFCT206-18G</b> 206G 206-19G 206-20G	1-1/8 1-3/16 1-1/4	30	4-7/16 113	3-9/16 90.5	15/32 12	7/8 22	15/32 12	13/32 10.3	5/16 8	1-11/32 34	3/8	SB206-18G 206G 206-19G 206-20G	FCT206	0.82	
<b>SBFCT207-20G</b> 207-21G 207-22G 207G 207-23G	1-1/4 1-5/16 1-3/8 1-7/16	35	4-13/16 122.5	3-15/16 100	1/2 12.7	15/16 23.8	1/2 12.7	13/32 10.3	11/32 8.5	1-7/16 36.2	3/8	SB207-20G 207-21G 207-22G 207G 207-23G	FCT207	1.57	

Unit No.	Shaft Dia. d		Dimension (in) (mm)								Bolt Size	Bearing No.	Housing No.	Weight (lb)
	(in.)	(mm)	L	P	A <sub>1</sub>	A	A <sub>2</sub>	N	S	E				
<b>SAFCT201G</b> 201-8G 202G 202-10G 203G 203-11G	1/2 5/8 11/16	12 15 17												
			3-3/16 81	2-1/2 63.5	13/32 10.7	3/4 19.1	13/32 10.7	9/32 7.1	1/4 6.5	9/32 32.8	1/4	SA201G 201-8G 202G 202-10G 203G 203-11G	FCT203	0.57
<b>SAFCT204-12G</b> 204G	3/4	20	3-9/16 90.5	2-13/16 71.4	7/16 11.1	25/32 19.8	7/16 11.1	11/32 8.7	9/32 7.5	11/32 34.5	5/16	SA204-12G 204G	FCT204	0.75
<b>SAFCT205-14G</b> 205-15G 205G 205-16G	7/8 15/16 1	25	3-3/4 95.2	3 76.2	13/32 10.3	25/32 19.8	13/32 10.3	11/32 8.7	9/32 7.5	5/16 33.7	5/16	SA205-14G 205-15G 205G 205-16G	FCT205	0.86
<b>SAFCT206-18G</b> 206G 206-19G 206-20G	1-1/8 1-3/16 1-1/4	30	4-7/16 113	3-9/16 90.5	15/32 12	7/8 22	15/32 12	13/32 10.3	11/32 9	1-1/2 38.7	3/8	SA206-18G 206G 206-19G 206-20G	FCT206	1.34
<b>SAFCT207-20G</b> 207-21G 207-22G 207G 207-23G	1-1/4 1-5/16 1-3/8 1-7/16	35	4-13/16 122.5	3-15/16 100	1/2 12.7	15/16 23.8	1/2 12.7	13/32 10.3	3/8 9.5	1-21/32 42.1	3/8	SA207-20G 207-21G 207-22G 207G 207-23G	FCT207	1.81

\* Full cover metal shroud seal standard. Full contact rubber seal (2RS suffix) optional.  
Non-relubricatable units also available (remove G suffix). Contact factory.

