

# SPROCKET

# NO.100

## Stock Bore

## 1 1/4" PITCH

### Single Type-A

No. Teeth	Catalog No.	Outside Dia. Do	Pitch Dia.	Stock Bore d	Weight Lbs.
7	100A7	3.350	2.881	1	1.2
8	100A8	3.770	3.266	1	1.4
9	100A9	4.180	3.655	1	1.6
10	100A10	4.600	4.045	1	2.0
11	100A11	5.010	4.438	1 1/4	2.5
12	100A12	5.420	4.830	1 1/4	3.0
13	100A13	5.820	5.224	1 1/4	3.5
14	100A14	6.230	5.618	1 1/4	4.1
15	100A15	6.630	6.013	1 1/4	4.7
16	100A16	7.030	6.408	1 1/4	5.4
17	100A17	7.440	6.803	1 1/4	6.1
18	100A18	7.840	7.199	1 1/4	7.0
19	100A19	8.240	7.595	1 1/4	7.8
20	100A20	8.640	7.990	1 1/4	8.8
21	100A21	9.040	8.388	1 1/4	9.8
22	100A22	9.440	8.784	1 1/4	10.5
23	100A23	9.840	9.180	1 1/4	11.8
24	100A24	10.250	9.576	1 1/4	12.8
25	100A25	10.650	9.974	1 1/4	13.9
26	100A26	11.050	10.370	1 1/4	15.0
27	100A27	11.440	10.768	1 1/4	16.0
28	100A28	11.840	11.164	1 1/4	17.4
29	100A29	12.240	11.561	1 1/4	19.6
30	100A30	12.640	11.959	1 1/4	20.1
31	100A31	13.040	12.355	1 1/4	21.5
32	100A32	13.440	12.753	1 1/4	22.6
33	100A33	13.840	13.150	1 1/4	24.1
34	100A34	14.240	13.548	1 1/4	26.0
35	100A35	14.640	13.945	1 1/4	27.2
36	100A36	15.040	14.343	1 1/4	30.0
37	100A37	15.440	14.740	1 1/4	31.0
38	100A38	15.840	15.138	1 1/4	33.0
39	100A39	16.230	15.535	1 1/4	35.0
40	100A40	16.630	15.933	1 1/4	36.0
41	100A41	17.030	16.330	1 1/4	39.0
42	100A42	17.430	16.728	1 1/4	40.0
43	100A43	17.830	17.125	1 1/2	43.0
44	100A44	18.230	17.523	1 1/2	45.0
45	100A45	18.630	17.920	1 1/2	47.0
46	100A46	19.020	18.318	1 1/2	48.0
47	100A47	19.420	18.715	1 1/2	52.0
48	100A48	19.820	19.113	1 1/2	54.0
49	100A49	20.220	19.510	1 1/2	56.0
50	100A50	20.620	19.908	1 1/2	57.0
51	100A51	21.020	20.305	1 1/2	63.0
52	100A52	21.420	20.703	1 1/2	64.0
53	100A53	21.810	21.100	1 1/2	64.2
54	100A54	22.210	21.498	1 1/2	68.0
55	100A55	22.610	21.895	1 1/2	70.0
56	100A56	23.010	22.294	1 1/2	72.0
57	100A57	23.410	22.691	1 1/2	75.8
58	100A58	23.810	23.089	1 1/2	76.0
59	100A59	24.200	23.486	1 1/2	77.0
60	100A60	24.600	23.884	1 1/2	80.0
70	100A70	28.580	27.861	1 1/2	113
72	100A72	29.380	28.658	1 1/2	119
76	100A76	30.973	30.248	1 1/2	133
80	100A80	32.570	31.839	1 1/2	146
84	100A84	34.160	33.430	1 1/2	162
90	100A90	36.550	35.818	1 1/2	193
96	100A96	38.930	38.204	1 1/2	215

### Single Type-B & C

Catalog No.	Bore: d (inches)		Hub (inches)		Weight Lbs.
	Stock	Rec Max	Dia Dh	LTB. L	
100B8	1	1 1/4	27/16*	17/8	2.3
100B9	1	1 5/8	213/16*	17/8	3.2
100B10	1	1 7/8	31/4*	17/8	4.1
100B11	1	2 1/4	39/16*	17/8	5.3
100B12	1	2 1/4	4*	17/8	6.4
100B13	1	2 3/8	37/8	15/8	6.6
100B14	1 1/4	2 3/4	43/16	15/8	7.4
100B15	1 1/4	3	4 1/2	13/4	9.2
100B16	1 5/16	3	4 1/2	13/4	9.9
100B17	1 5/16	3	4 1/2	13/4	10.8
100B18	1 5/16	3	4 1/2	13/4	11.5
100B19	1 5/16	3	4 1/2	2	13.1
100B20	1 5/16	3	4 1/2	2	14.2
100B21	1 5/16	3	4 1/2	2	15.3
100B22	1 5/16	3	4 1/2	2	16.1
100B23	1 1/4	3	4 1/2	2	17.2
100B24	1 1/4	3	4 1/2	2	19.2
100B25	1 1/4	3	4 1/2	2	19.5
100B26	1 1/4	3 5/16	5	2	21.7
100B27	1 1/4	3 5/16	5	2	23.0
100B28	1 1/4	3 5/16	5	2	24.4
100B29	1 1/4	3 5/16	5	2	25.0
100B30	1 1/4	3 5/16	5	2	26.9
100B32	1 1/4	3 5/16	5	2	29.8
100B35	1 1/4	3 5/16	5	2 1/2	36.9
100B36	1 1/4	3 5/16	5	2 1/2	38.6
100B38	1 1/4	3 5/16	5	2 1/2	41.5
100B39	1 1/4	3 5/16	5	2 1/2	43.6
100B40	1 1/4	3 5/16	5	2 1/2	46.9
100B42	1 1/4	3 5/16	5	2 1/2	50.4
100B45	1 1/2	3 5/16	5	2 1/2	54.0
100B48	1 1/2	4	6	2 1/2	66.0
100C54	1 1/2	4	6	3 1/4	78.0
100C60	1 1/2	4	6	3 1/4	89.0
100C70	1 1/2	5 1/4	7	3 3/4	125
100C72	1 1/2	5 1/4	7	3 3/4	134
100C76	1 1/2	5 1/4	7	3 3/4	143
100C80	1 1/2	5 1/4	7	3 3/4	151
100C84	1 1/2	5 1/4	7	3 3/4	170
100C90	1 1/2	5 1/4	7	3 3/4	184
100C96	1 1/2	5 1/4	7	4 1/2	203

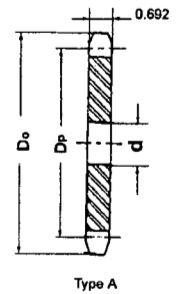

Type A

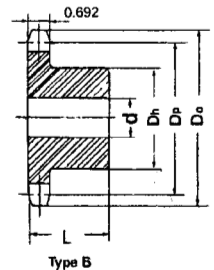

Type B

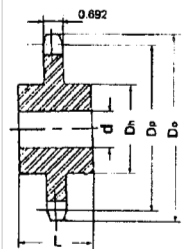

Type C

\* Has recessed groove in hub for chain clearance.