



Adjustable Windshield System

Kawasaki Vulcan S

Please read this entire manual before proceeding with installation.

What is in the box:

- (1) MadStad windshield**
- (2) Adjustable brackets** (*left and right*)
- (2) Mounting plates** (*with hardware*)



Mounting plate hardware:

- (4) 1/2" x 20mm spacers
- (2) M8 x 60 Socket Head screws
- (2) M8 x 45 Button Socket screws
- (4) M8 flat washers

Windshield hardware:

- (4) M5 Phillips screws
- (4) M5 plastic washers
- (4) soft rubber washers

Other:

- (1) Plastic zip tie



PREPARATION

Before installing the mounting plates, please use the included zip tie to strap your throttle-side cables to the handlebar as shown below. This will get them out of the way so they don't interfere with the mounting or operation of the adjustable brackets.



STEP 1: Install the mounting plates.

The plates are symmetrical and they attach to the fork clamps. You will need to remove two of the three clamp bolts on one side of the bike (as shown at right). ONLY WORK ON ONE SIDE AT A TIME! Do not remove bolts from both the left and right forks, and do not remove the lowest clamp bolt. In other words, only two fork clamp bolts should be out at any given time.

Each mounting plate has two extensions, one with a round hole and one with a larger slotted hole. The top of the plate is the part with the smaller round-hole extension as shown in the photo below.

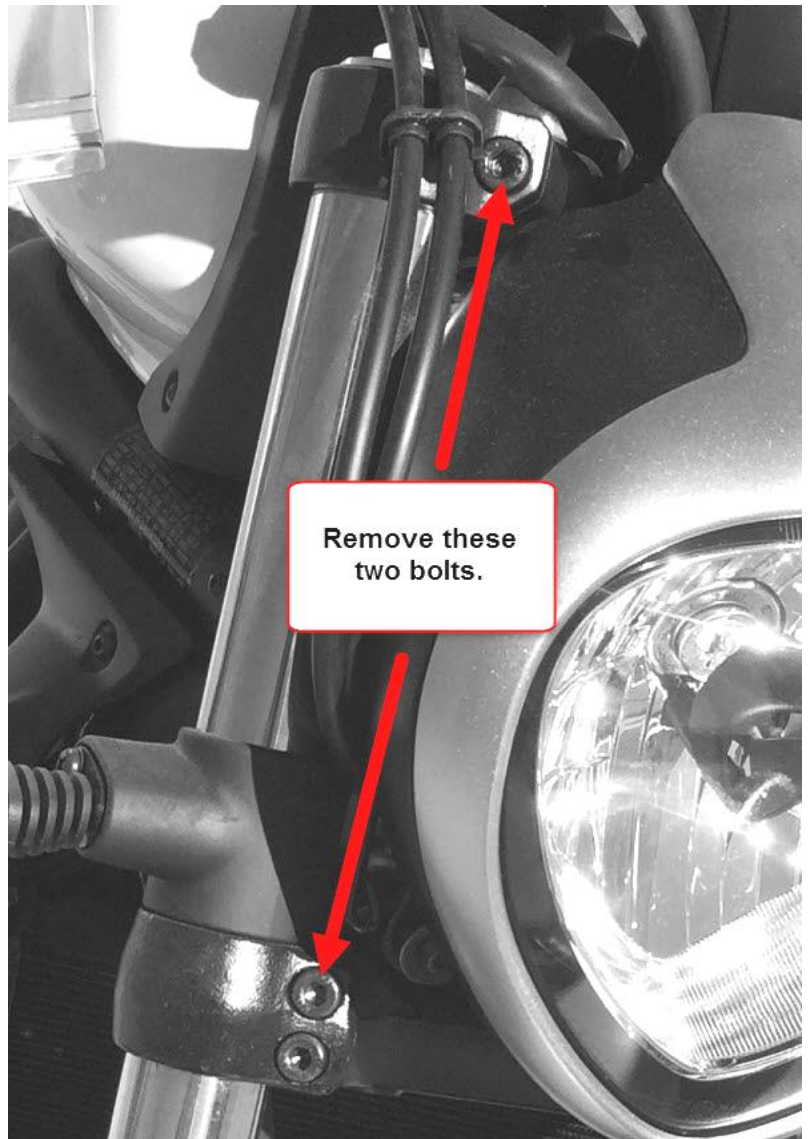

NOTE: Q-R Spools are now Black
Take one of the longer M8 x 60 mm screws, slide a flat washer onto it, run it through the top mounting plate hole then slide a spacer onto it. Set it into the fork clamp and thread it in by hand. Do not tighten it yet.

Do the same at the lower slotted hole except use the shorter M8 x 45 mm screws. Once both screws with spacers are threaded in, go ahead and tighten them up with an M5 Allen wrench. See the next page for photos.

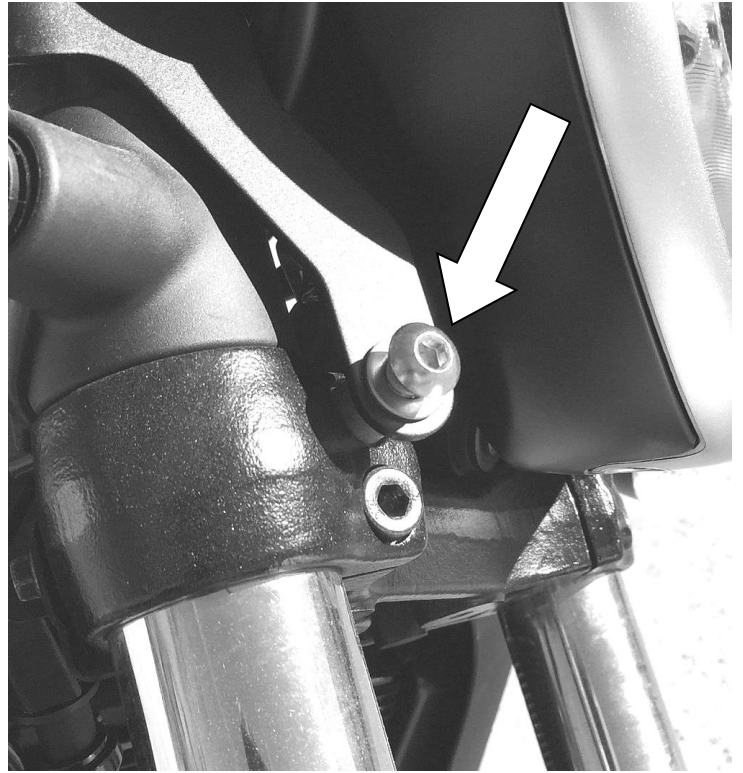
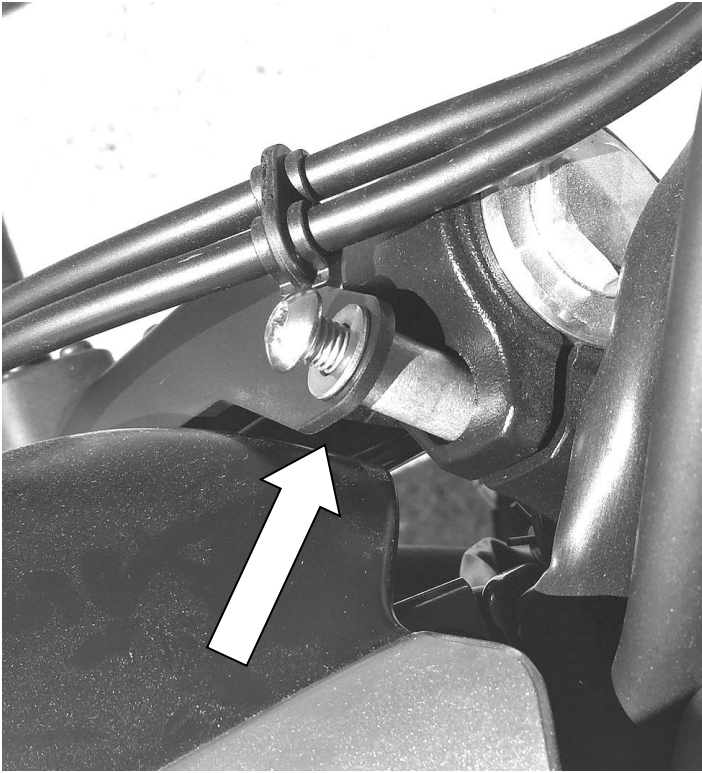

STEP 2: Attach the adjustable brackets to the mounting plates.

The hardware that comes pre-installed on the mounting plates (the aluminum “buttons”) are supposed to be loose. You will tighten these after attaching the adjustable brackets because these buttons need to seat themselves into the bracket slots. The adjustable brackets have a spring-loaded post on the lower section and that post needs to be to the outside of the bike, and toward the front. Make sure that the pivoting tab which is attached to that post is not covering in the way of either of the mounting slots. If it is, just move it between them as seen in the following photos, and follow these photos to see how the brackets slide onto the mounting buttons, bottom slot first, then pivot back onto the upper button:



To lock the brackets in, pivot the locking tab up and onto the upper button, and allow it to snap completely over (see photos below). You might have to wiggle the buttons or bracket around a bit but make sure the locking tab snaps fully down around the button.

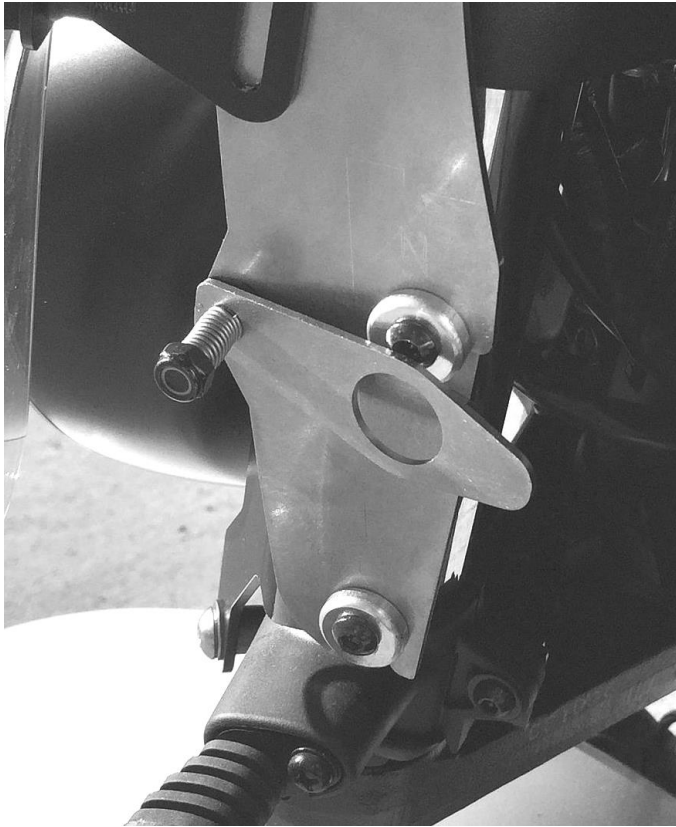

Once the brackets are snapped onto the buttons it is time to **tighten those buttons down using a 4 mm Allen wrench and a 10 mm open-end or box-end wrench** (see **photo at right**). Make sure you tighten both the upper and lower buttons. Repeat this bracket installation process on the other side.



STEP 3:

Windshield Installation

1. Pre-install the Truss screws & washers into the windshield holes as shown in the image below.
2. Once all four of the screws are in place, gently guide the screws into the Well Nuts in the brackets until all four are set.
3. Hand tighten the Truss screws until they swell up behind the bracket and are firmly holding the windshield.

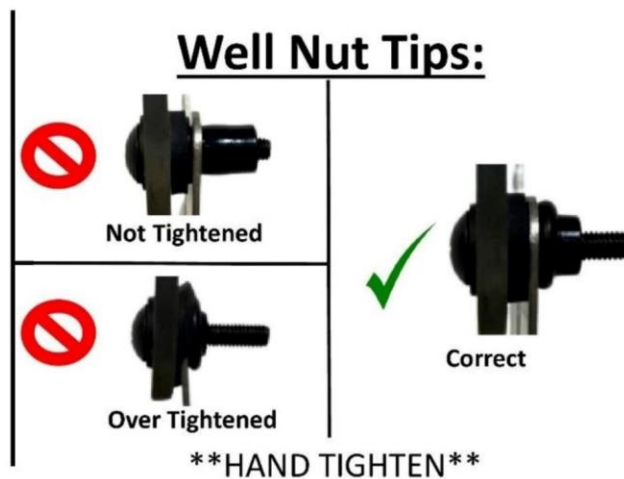
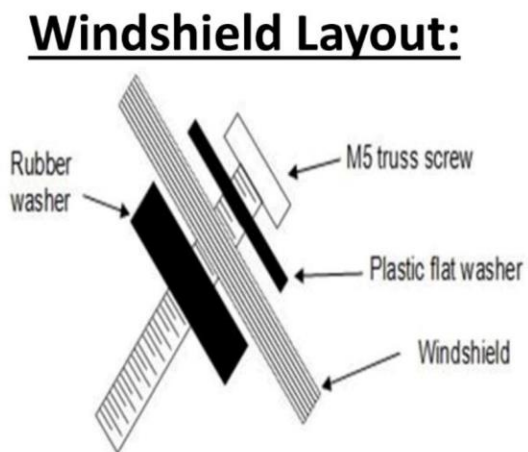

Adjusting the Windshield Brackets

The black plastic knobs on the brackets release the windshield allowing it to slide and tilt. These knobs must always be tightened securely before riding. **DO NOT** attempt to adjust the brackets while riding! You must come to a complete stop before making adjustments. You only need to loosen the knobs 1-2 turns to free up the mechanism. Initially set the windshield so the top edge is at about your chin level as you look straight ahead while seated on the bike. Set the angle at approximately 60 degrees. (Use the angle guide on the back page of this manual as a guide.) Tighten the knobs and go for a ride to see how the airflow feels and where it is going. Do this on a calm day if at all possible; windy days make it hard to judge the airflow. Don't ever try to adjust the mount while in motion!

To try a different windshield position, bring the motorcycle to a complete stop and out of traffic. Loosen the two knobs and tilt the windshield forward or back 2-3 degrees or so, and/or adjust it up or down if necessary. Re-tighten the knobs and go for another ride.

Continue experimenting with different positions at different speeds until you find a combination of height and rake angle that eliminates buffeting and gives a smoother ride. You may have more than one favorite position, for example shield tilted forward on cooler days, and shield tilted back for hot days to let more air to your body.

REMOVING THE WINDSHIELD

The windshield and adjustable brackets come off together. On each side of the brackets where they attach to the mounting plates, pull up the locking tab and rotate it down off of the top button. Stand at the front of the bike, grab the sides of the windshield and lift it slightly as you tilt it forward and off of the mounting plates. To put the shield system back on, simply do the reverse: insert the bottom slot of each bracket onto the bottom buttons, then pivot the system forward to seat the upper slots onto the upper buttons, then set the locking tab up and onto each top button to lock the system in, making sure that the tabs snap down fully.

Disclaimer

Neither MadStad Engineering nor its owners shall be liable for any damages, consequential or inconsequential, resulting from the use of our products. Installation of any of our products constitutes acceptance of these terms.

It is the responsibility of the user to make sure all fasteners are tightened securely, the windshield is mounted properly and the adjustment knobs are tightened snugly before putting the motorcycle in motion. MadStad systems ARE NOT intended to be adjusted while the vehicle is in motion; you must pull over out of the way of traffic and come to a complete stop before making any changes. The user must never place the windshield in such a position as to interfere with the safe and complete movement of the handlebars and controls.

Returns and Warranty

MadStad adjustable brackets carry a lifetime warranty against manufacturing defects. This does not include cosmetic issues nor any parts that inherently wear out or degrade over time such as rubber and plastic parts. Windshields, deflectors, and other similar plastic parts are warrantied for 1 year against manufacturing defects, not against cosmetic issues or issues related to normal wear and tear. Please visit our website for further details.

MadStad Engineering, Inc.

1451 E. Jefferson St.
Brooksville, FL 34601 U.S.A.
Phone: 352-848-3646

Web Site: <http://www.madstad.com>

Email: support@madstad.com

Thank you for your support, and ride safely!

