

MADSTAD

ENGINEERING

Honda CTX700N – Lowers Kit



TOP
VIEW

Remove plastic side covers, use long M5 screws with washers and metal spacers between brackets and bike. Attach through the factory holes by the radiator, secure with lock nuts.

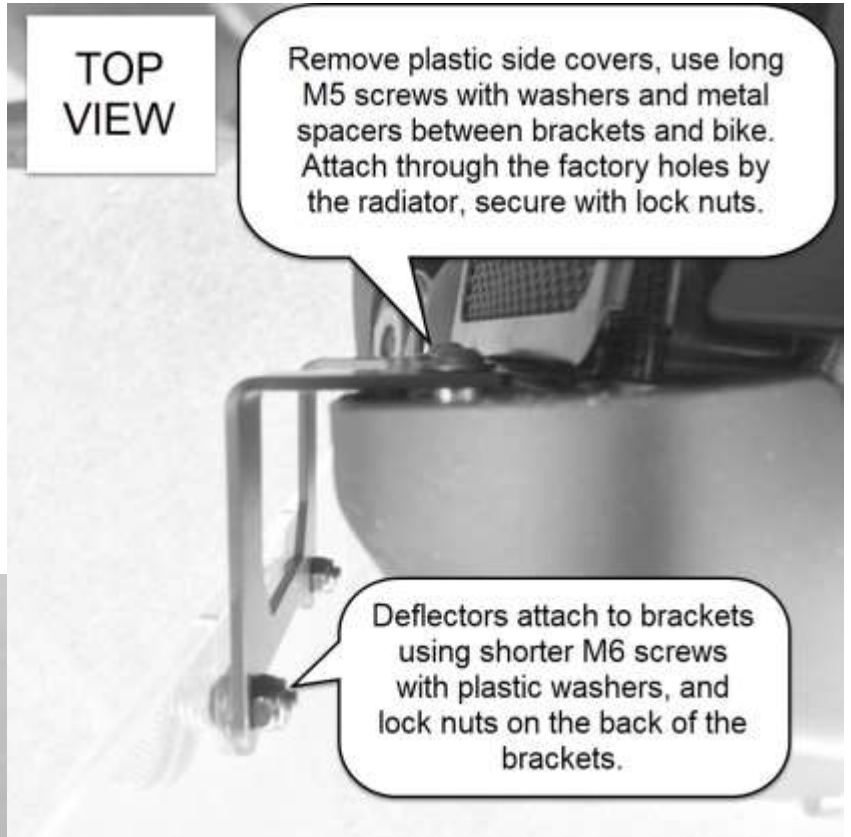

Deflectors attach to brackets using shorter M6 screws with plastic washers, and lock nuts on the back of the brackets.



Deflectors can be mounted wide side down OR up.

