

MED0140GD-NR | Bromic MediFridge™ Display Chiller 145L

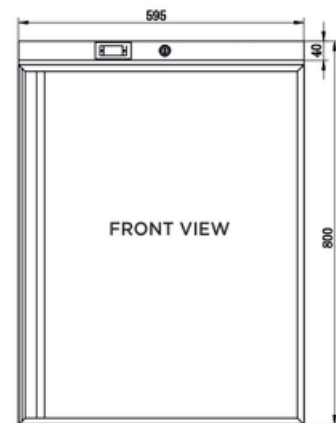
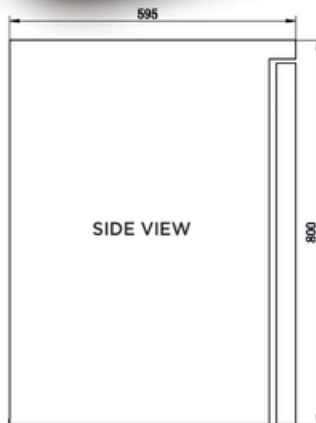
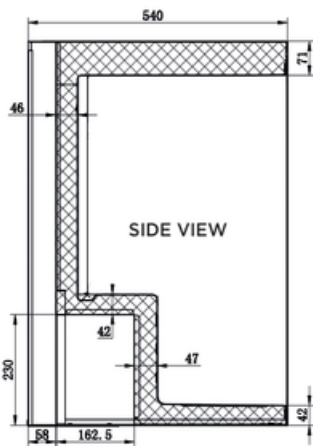

FEATURES

Integrated temperature Alarm System ensures sensitive stock is maintained and managed according to requirements

Fan Forced air circulation ensures even temperature throughout the unit

Increased air circulation around the unit thanks to unique custom wire 'open rung' shelves at the top and bottom to prevent overstocking

Consistent air circulation throughout the unit ensures mandated temperatures of 2°C to 8°C

Backed by Bromic national services & warranty

DIMENSIONS

	External (mm)	Internal (mm)
Width	595	491
Depth	595	510
Height	820	687

MED0140GD-NR | Bromic MediFridge™ Display Chiller 145L

SPECIFICATIONS

Part Number	3736257	External (mm)		Internal (mm)
Capacity	145L	Width	595	491
Weight	40kg	Depth	595	510
Air Circulation	Fan-Forced	Height	820	687
Temperature	Range+	+2°C to 8°C		
	Max Ambient Temperature	30°C		
	Min/Max Temp Recorder	Yes		
	Display	Digital		
Exterior Finish	Material	Powder Coated Sheet Metal		
	Solid or Glass	Low-E Glass + Argon Gas		
Door	Shape	Flat		
	Self-Closing	Yes		
	Door Lock	Yes		
	Door Style	Right hand hinged		
	Door opening (W x H)	595mm x 687mm		
	Reversible	No		
	Shelves	No. of Shelves	4	
Style of Shelves		PVC Coated Wire open rung 7mm apart		
Depth of Shelf		3 Shelves at 365 mm 1 Shelf at 235 mm		
Adjustable		Yes (middle 2 shelves only)		
Electrical	Voltage	240V		
	Frequency	50Hz		
	Input Power	100W		
	Power Consumption	1.26kWh/24hr		
Refrigeration System	Refrigerant Type	R600a		
	Electronic Controller	Digital		
Australian Standard Plug	Type	Yes, 10A		
Alarms	Temperature	Yes		
	Door	Yes		
	Audible & Visual	Yes		
Lighting	LED Internal Light	Yes		
Defrost	Automatic	Yes		
	Type of Defrost System	OFF Cycle		
Insulation Type	Cyclopentane			
Footing	30mm Feet at Front. Rollers at back			
Approvals	Quality Care Pharmacy Program Compliance - Cold Chain Testing (QCPP), MEPS, The Pharmacy Guild of Australia			
Warranty	5 year warranty			
Data Logger	Available, part #350700050			