

NOTES: UNLESS OTHERWISE SPECIFIED

1. SEE DRAWING NO. CB-00288 AND PROCEDURE P-1000 FOR ASSEMBLY AND TEST INSTRUCTION. PROCEDURES AND ASSEMBLY DRAWINGS ARE FOR INTERNAL USE ONLY.
2. ALL TESTING IS PERFORMED IAW BATTERY COUNCIL INTERNATIONAL STANDARDS.
3. DIMENSIONS ARE INCH [MILLIMETER].
4. ABBREVIATION USED IN TITLE IS: SEALED LEAD ACID (SLA).
5. TERMINAL HARDWARE KIT PROVIDED, PART NUMBER 6923.

REVISIONS			
REV	DESCRIPTION	DATE	APPROVED
A	UPDATED TO LATEST CONTAINER AND COVER DESIGN	1/8/07	JBT
B	CHANGED HANDLE DIRECTION	2/26/07	JBT
C	REVISED COVER & HANDLES	11/6/07	JBT
D	REVISED TERMINAL DAMS, TERMINAL HEIGHT & HANDLES	9/16/09	JBT
E	REVISED TERMINAL HEIGHT	5/29/20	PH

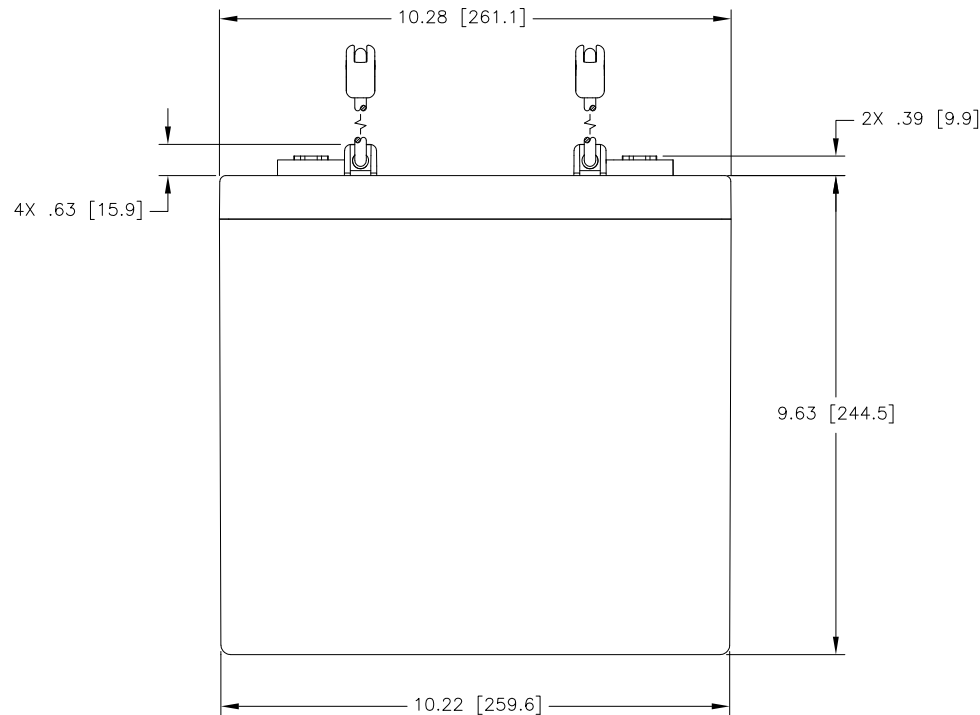
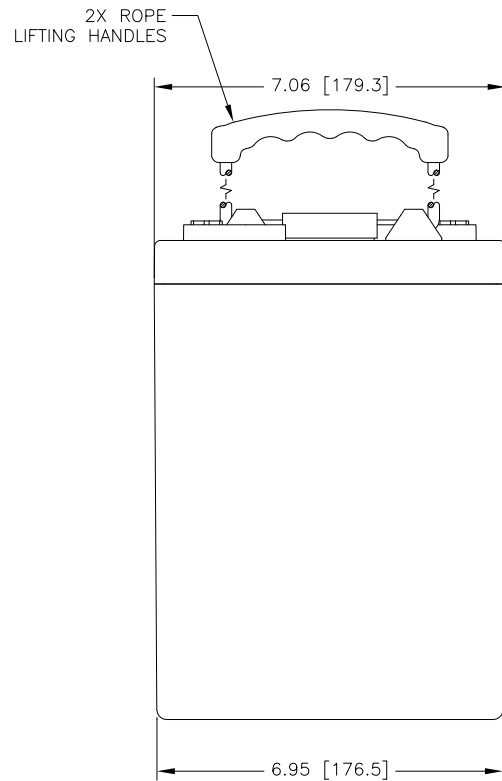
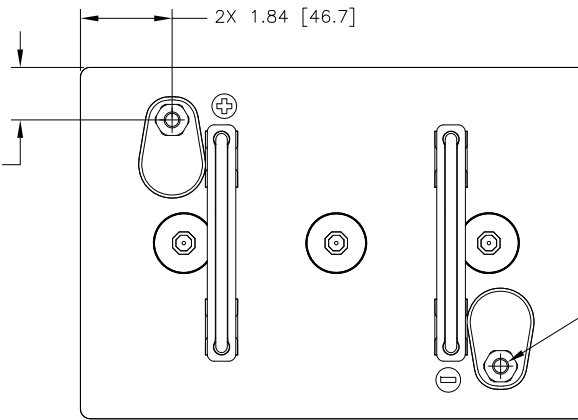

ENVELOPE DRAWING

CAPACITY RATINGS	
PART NUMBER	PVX-2240T
NOMINAL WEIGHT	67 LBS [30.4 KG]
AMPERE HOUR CAPACITY @ 24 HOUR 1.75 VOLTS/CELL @ 77°F (25° C)	224 AH

QTY	RECD	CAGE CODE	PART OR IDENTIFYING NO.	NOMENCLATURE OR DESCRIPTION	MATERIAL SPECIFICATION	ITEM NO.
PARTS LIST						
UNLESS OTHERWISE SPECIFIED DIMENSIONS ARE IN INCHES TOLERANCES ARE:				CONCORDE BATTERY CORPORATION 2009 SAN BERNARDINO RD, W. COVINA, CA 91790		
FRACTIONS DECIMALS ANGLES ± 1/32 .XX ± .12 ± 1° .XXX ± .060				APPROVALS		DATE
TREATMENT NONE				DRAWN	AMIII	9/23/02
FINISH NONE				CHECKED	HRF	9/23/02
SIMILAR TO				APPROVED	JBT	10/1/02
ACT WT OLC WT				ISSUED	DH	6/1/20
SIZE	C	CAGE CODE	63017	DWG NO.	PVX-2240T	REV E
SCALE	1/2		SHEET		1 OF 1	