

Specifications

| | | |
|---|--------------|---|
| Nominal Voltage | | 12 V |
| Capacity (25°C) | 20HR(10.5V) | 5Ah |
| | 10HR(10.5V) | 4.7Ah |
| | 1HR(9.60V) | 3.25Ah |
| Dimension | Length | 90±1mm (3.54inch) |
| | Width | 70±1mm (2.76inch) |
| | Height | 101±1mm (3.98inch) |
| | Total Height | 107±1mm (4.21inch) |
| Approx. Weight | | 1.65kg (3.64lbs)±5% |
| Terminal type | | T1/T2 |
| Internal resistance (Fully charged, 25°C) | | Approx. 26mΩ |
| Capacity affected by temperature (20HR) | 40°C | 102% |
| | 25°C | 100% |
| | 0°C | 85% |
| | -15°C | 65% |
| Self-discharge (25°C) | 3 month | Remaining Capacity: 91% |
| | 6 month | Remaining Capacity: 82% |
| | 12 month | Remaining Capacity: 65% |
| Nominal operating temperature | | 25°C±3°C (77°F±5°F) |
| Operating temperature range | Discharge | -15°C~50°C (5°F~122°F) |
| | Charge | -10°C~50°C (14°F~122°F) |
| | Storage | -20°C~50°C (-4°F~122°F) |
| Float charging voltage(25°C) | | 13.60 to 13.80V Temperature compensation: -18mV/°C |
| Cyclic charging voltage(25°C) | | 14.50 to 14.90V Temperature compensation: -30mV/°C |
| Maximum charging current | | 1.5A |
| Terminal material | | Copper |
| Maximum discharge current | | 75A(5 sec.) |
| Designed floating life(20°C) | | 3~5 years |

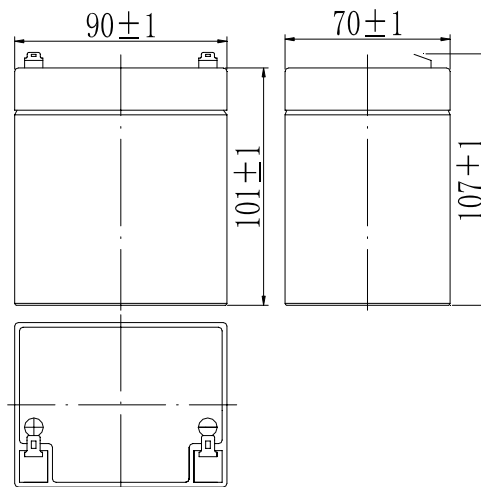

Dimensions



Terminal

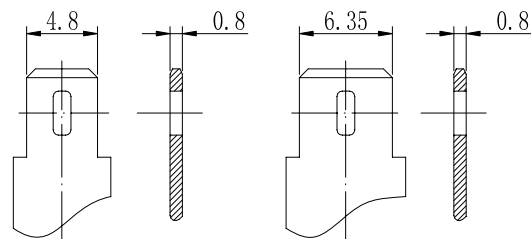

Terminal T1

Terminal T2

- ◆ Absorbent glass mat technology;
- ◆ Recognized by UL & CE;
- ◆ ABS container.

Constant Current Discharge Characteristics (A, 25°C)

| F.V/TIME | 5min | 10min | 15min | 30min | 60min | 2h | 3h | 4h | 5h | 10h | 20h |
|----------|------|-------|-------|-------|-------|------|------|------|------|------|------|
| 9.60V | 19.0 | 12.0 | 9.50 | 5.30 | 3.25 | 1.78 | 1.28 | 1.02 | 0.87 | 0.47 | 0.25 |
| 9.90V | 18.4 | 11.6 | 9.27 | 5.19 | 3.20 | 1.77 | 1.27 | 1.01 | 0.86 | 0.47 | 0.25 |
| 10.2V | 17.7 | 11.2 | 8.93 | 5.04 | 3.12 | 1.75 | 1.26 | 1.01 | 0.86 | 0.47 | 0.25 |
| 10.5V | 16.9 | 10.7 | 8.63 | 4.91 | 3.06 | 1.72 | 1.25 | 1.00 | 0.85 | 0.47 | 0.25 |
| 10.8V | 16.0 | 10.1 | 8.17 | 4.73 | 2.96 | 1.68 | 1.21 | 0.97 | 0.82 | 0.46 | 0.25 |

Constant Power Discharge Characteristics (Watt, 25°C)

| F.V/TIME | 5min | 10min | 15min | 30min | 60min | 2h | 3h | 4h | 5h | 10h | 20h |
|----------|------|-------|-------|-------|-------|------|------|------|------|------|------|
| 9.60V | 212 | 135 | 108 | 60.7 | 37.6 | 20.8 | 15.1 | 12.1 | 10.4 | 5.66 | 3.05 |
| 9.90V | 206 | 131 | 106 | 59.5 | 37.1 | 20.7 | 15.1 | 12.1 | 10.3 | 5.64 | 3.03 |
| 10.2V | 197 | 126 | 102 | 57.7 | 36.1 | 20.5 | 15.0 | 12.0 | 10.2 | 5.61 | 3.02 |
| 10.5V | 189 | 120 | 98.3 | 56.3 | 35.4 | 20.2 | 14.9 | 11.9 | 10.1 | 5.58 | 3.00 |
| 10.8V | 178 | 114 | 93.1 | 54.2 | 34.3 | 19.7 | 14.4 | 11.6 | 9.84 | 5.47 | 2.94 |

Note: The above characteristics data can be obtained within three charge/discharge cycles.

Discharge Characteristics(25°C)

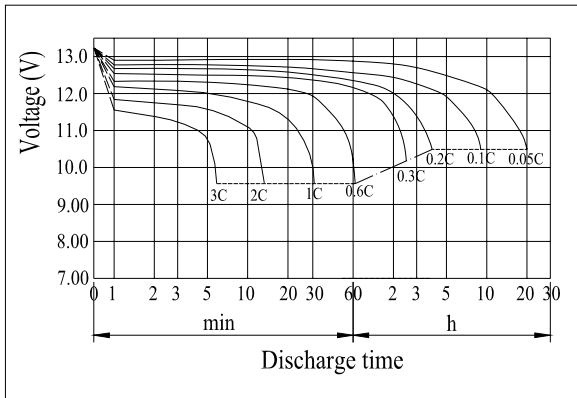

Charging Characteristics(25°C)

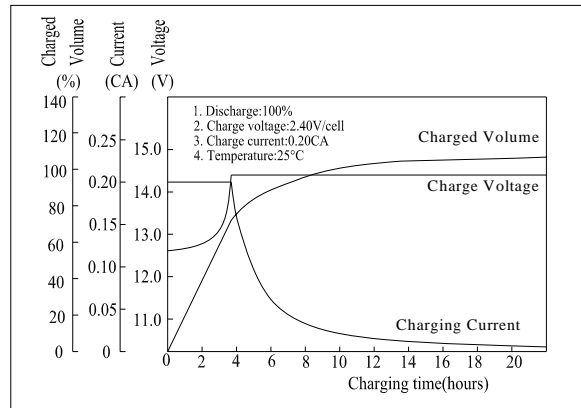

Effect of Temperature on Capacity

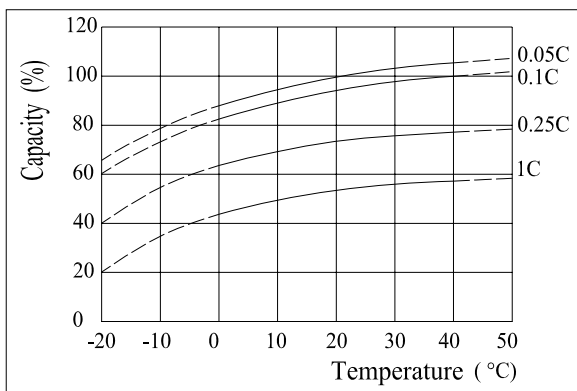

Self-discharge Characteristics

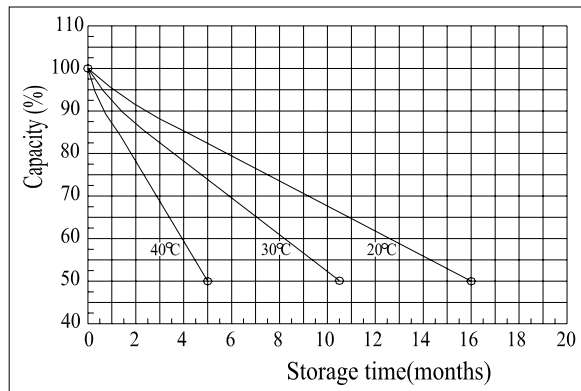

The Relationship for Open Circuit Voltage and Residual Capacity (25°C)

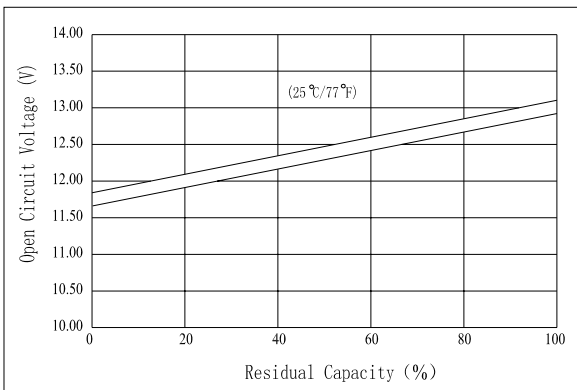

The Relationship for Charging Voltage and Temperature

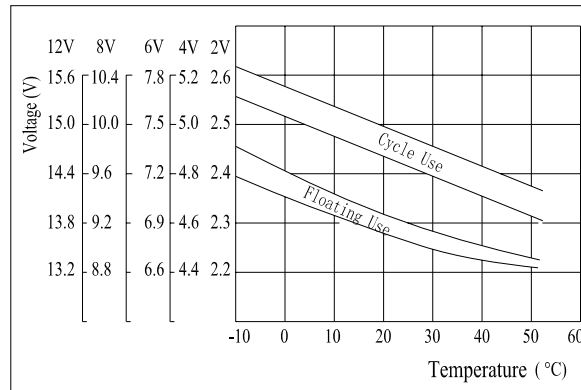

Floating Life on Temperature

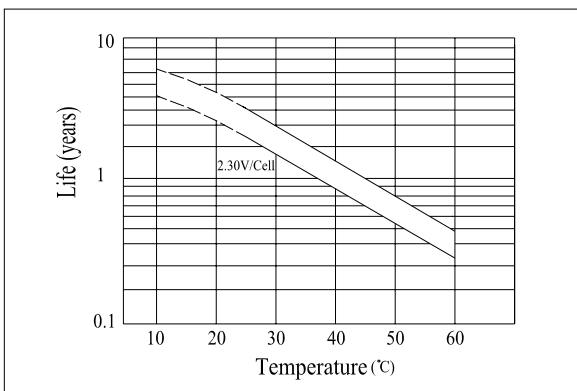

Cycle Life on D.O.D(25°C)

