

**Specifications**

|   |              |   |
|---|--------------|---|
| Nominal Voltage                           |              | 12 V  |
| Capacity (25°C)                           | 20HR(10.5V)  | 28 Ah   |
|   | 10HR(10.5V)  | 26Ah  |
|   | 1HR(9.60V)   | 17.6Ah  |
| Dimension                                 | Length       | 166±2mm (6.54inch)                                    |
|   | Width        | 175±2mm (6.89inch)                                    |
|   | Height       | 125±2mm (4.92inch)                                    |
|   | Total Height | 125±2mm (4.92inch)                                    |
| Approx. Weight                            |              | 8.6kg (19.0lbs)±4%                                    |
| Terminal type                             |              | T3/T8   |
| Internal resistance (Fully charged, 25°C) |              | Approx. 10mΩ  |
| Capacity affected by temperature (20HR)   | 40°C         | 102%  |
|   | 25°C         | 100%  |
|   | 0°C          | 85%   |
|   | -15°C        | 65%   |
| Self-discharge (25°C)                     | 3 month      | Remaining Capacity: 91%                               |
|   | 6 month      | Remaining Capacity: 82%                               |
|   | 12 month     | Remaining Capacity: 65%                               |
| Nominal operating temperature             |              | 25°C±3°C(77°F±5°F)                                    |
| Operating temperature range               | Discharge    | -15°C~50°C(5°F~122°F)                                 |
|   | Charge       | -10°C~50°C(14°F~122°F)                                |
|   | Storage      | -20°C~50°C(-4°F~122°F)                                |
| Float charging voltage(25°C)              |              | 13.60 to 13.80V<br>Temperature compensation: -18mV/°C |
| Cyclic charging voltage(25°C)             |              | 14.50 to 14.90V<br>Temperature compensation: -30mV/°C |
| Maximum charging current                  |              | 8.4A  |
| Terminal material                         |              | Copper  |
| Maximum discharge current                 |              | 420A(5 sec.)  |
| Designed floating life(20°C)              |              | 3~5 years   |

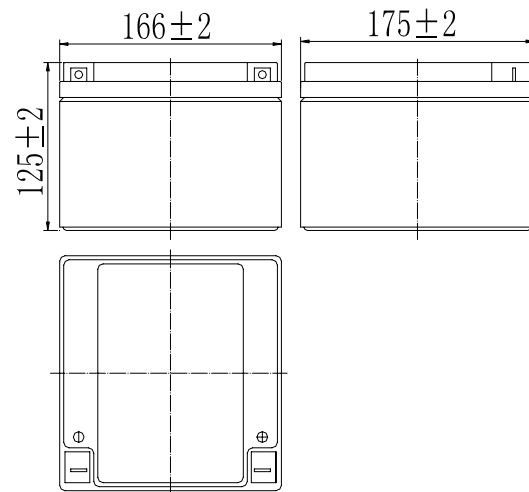

**Dimensions**



**Terminal**

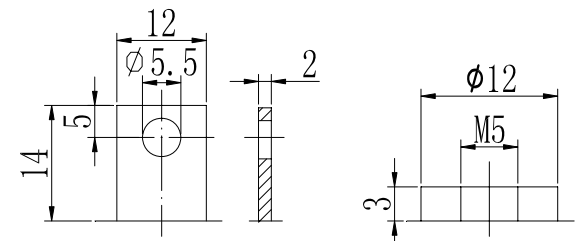

Terminal T3

Terminal T8

- ◆ Absorbent glass mat technology;
- ◆ Recognized by UL & CE;
- ◆ ABS container.

**Constant Current Discharge Characteristics (A, 25°C)**

| F.V/TIME | 10min | 15min | 30min | 60min | 2h   | 3h   | 4h   | 5h   | 8h   | 10h  | 20h  |
|----------|-------|-------|-------|-------|------|------|------|------|------|------|------|
| 9.60V    | 64.8  | 51.3  | 28.6  | 17.6  | 9.95 | 7.14 | 5.71 | 4.86 | 3.14 | 2.64 | 1.42 |
| 9.90V    | 62.9  | 50.1  | 28.0  | 17.3  | 9.89 | 7.10 | 5.68 | 4.83 | 3.12 | 2.63 | 1.42 |
| 10.2V    | 60.3  | 48.2  | 27.2  | 16.8  | 9.80 | 7.05 | 5.64 | 4.79 | 3.10 | 2.62 | 1.41 |
| 10.5V    | 57.7  | 46.6  | 26.5  | 16.5  | 9.65 | 7.00 | 5.60 | 4.76 | 3.08 | 2.60 | 1.40 |
| 10.8V    | 54.4  | 44.1  | 25.6  | 16.0  | 9.41 | 6.79 | 5.43 | 4.62 | 2.99 | 2.55 | 1.37 |

**Constant Power Discharge Characteristics (Watt, 25°C)**

| F.V/TIME | 10min | 15min | 30min | 60min | 2h  | 3h   | 4h   | 5h   | 8h   | 10h  | 20h  |
|----------|-------|-------|-------|-------|-----|------|------|------|------|------|------|
| 9.60V    | 731   | 585   | 328   | 203   | 116 | 84.8 | 68.0 | 58.0 | 37.7 | 31.7 | 17.1 |
| 9.90V    | 709   | 571   | 321   | 200   | 116 | 84.3 | 67.6 | 57.6 | 37.5 | 31.6 | 17.0 |
| 10.2V    | 680   | 550   | 312   | 195   | 115 | 83.7 | 67.2 | 57.2 | 37.2 | 31.4 | 16.9 |
| 10.5V    | 651   | 531   | 304   | 191   | 113 | 83.2 | 66.7 | 56.8 | 37.0 | 31.2 | 16.8 |
| 10.8V    | 614   | 503   | 293   | 185   | 110 | 80.7 | 64.7 | 55.1 | 35.9 | 30.6 | 16.5 |

Note: The above characteristics data can be obtained within three charge/discharge cycles.

**Discharge Characteristics(25°C)**

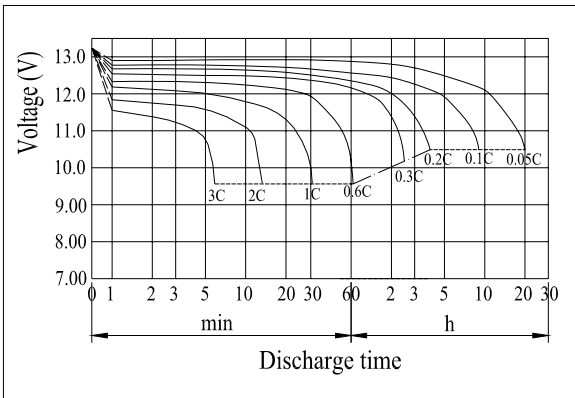

**Charging Characteristics(25°C)**

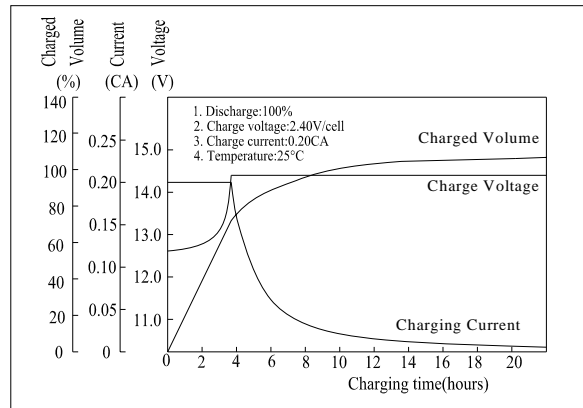

**Effect of Temperature on Capacity**

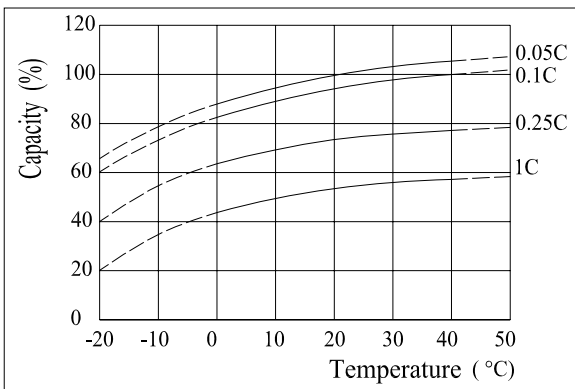

**Self-discharge Characteristics**

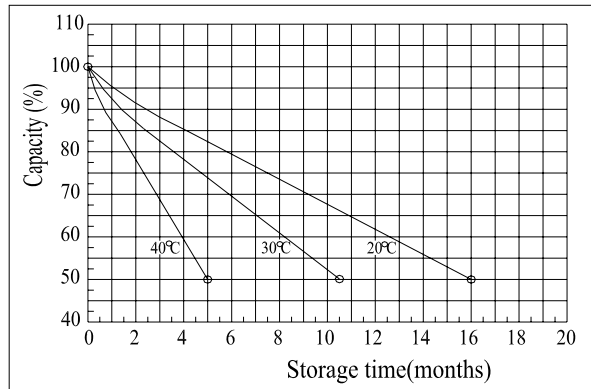

**The Relationship for Open Circuit Voltage and Residual Capacity (25°C)**

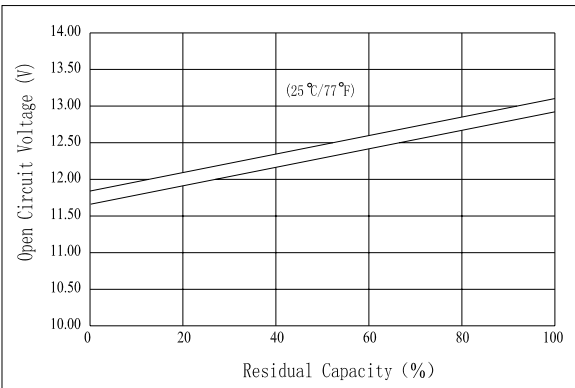

**The Relationship for Charging Voltage and Temperature**

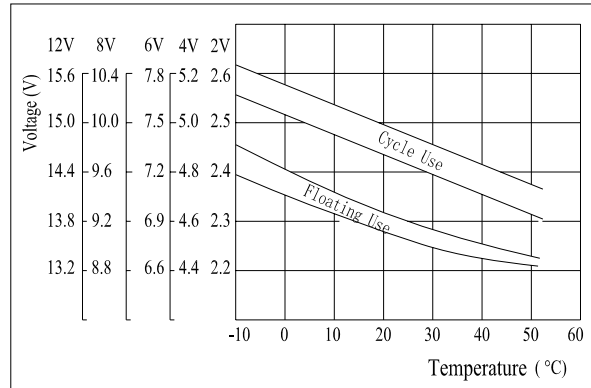

**Floating Life on Temperature**

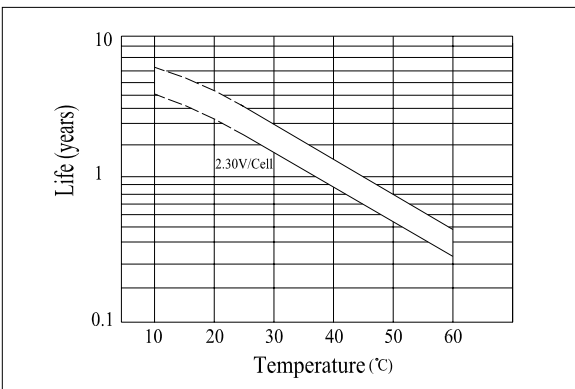

**Cycle Life on D.O.D(25°C)**

