

Yamaha Drive Rear Flip Seat Kit

instruction manual

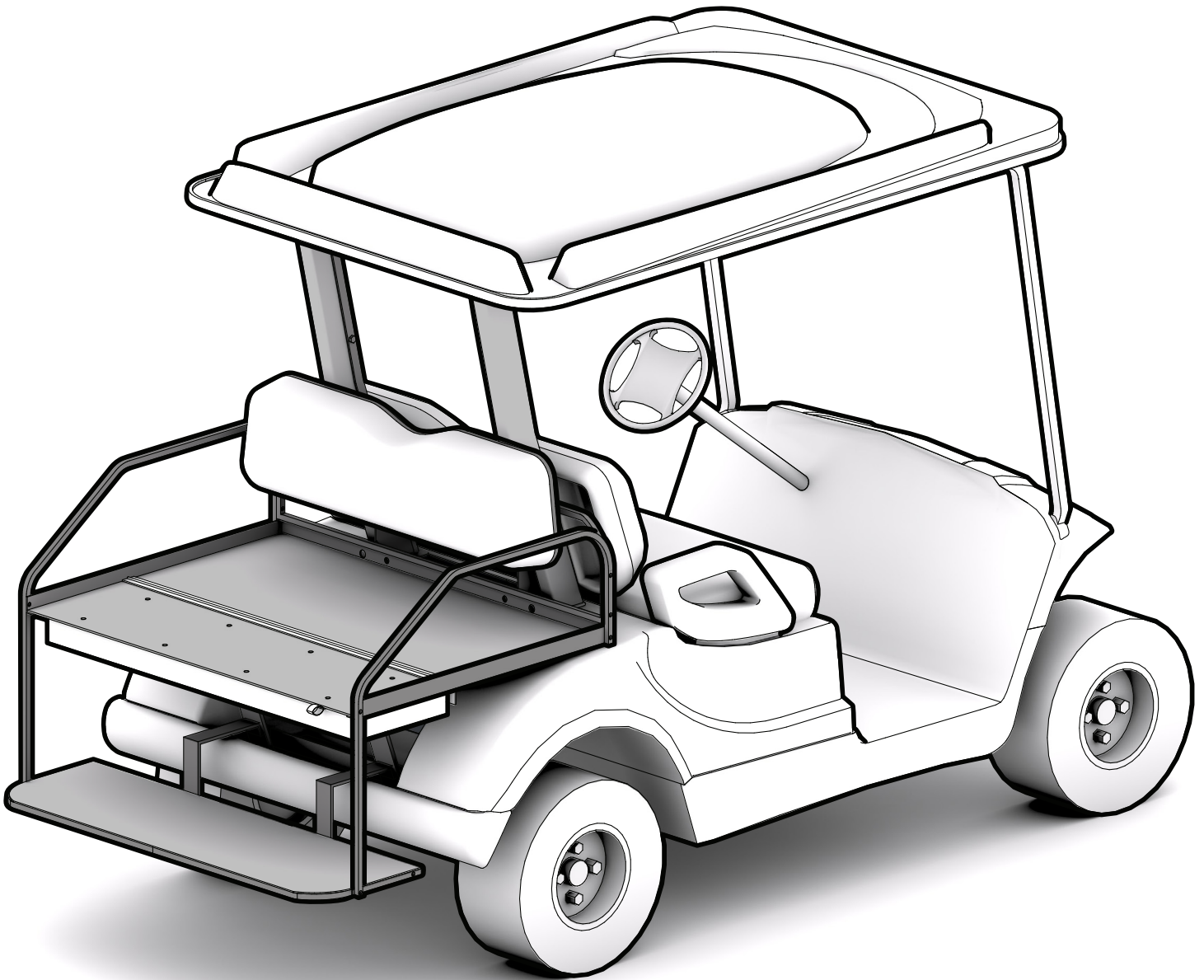

Parts List

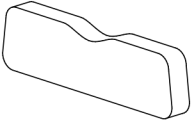

Back Pad (1)

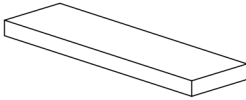

Seat Pad (1)

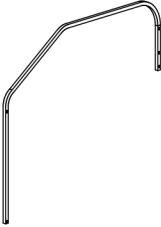

Side Frame (2)

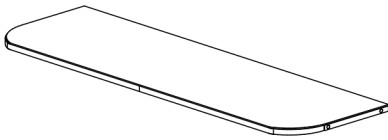

Step Plate (1)

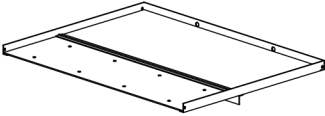

Flip Seat Frame (1)

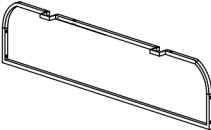

Back Frame (1)

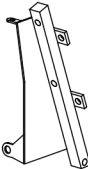

Front Supports(2)

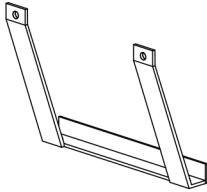

Rear Support



Step Plate Supports(2)

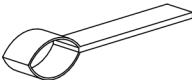

Seat Pull(1)

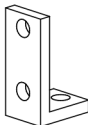

Rear Seat Supports(2)

*Parts not shown in proportion.

Bolts - **actual size**

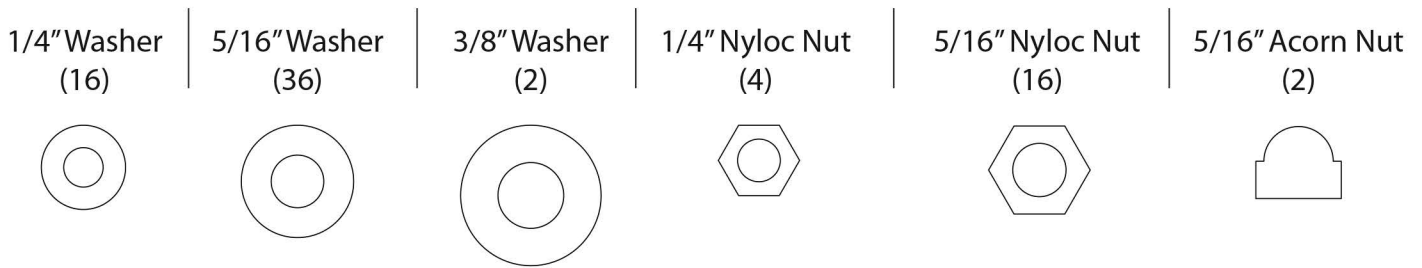
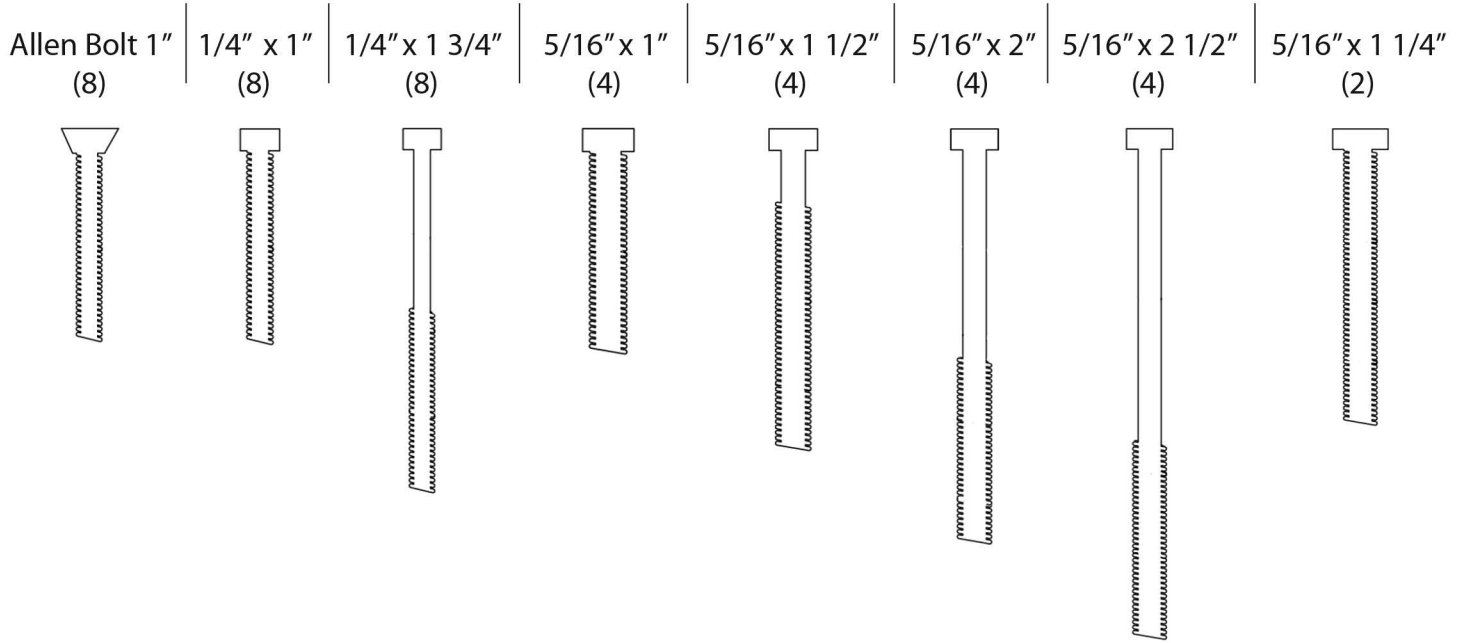

Installation

1. Unbolt Supports.

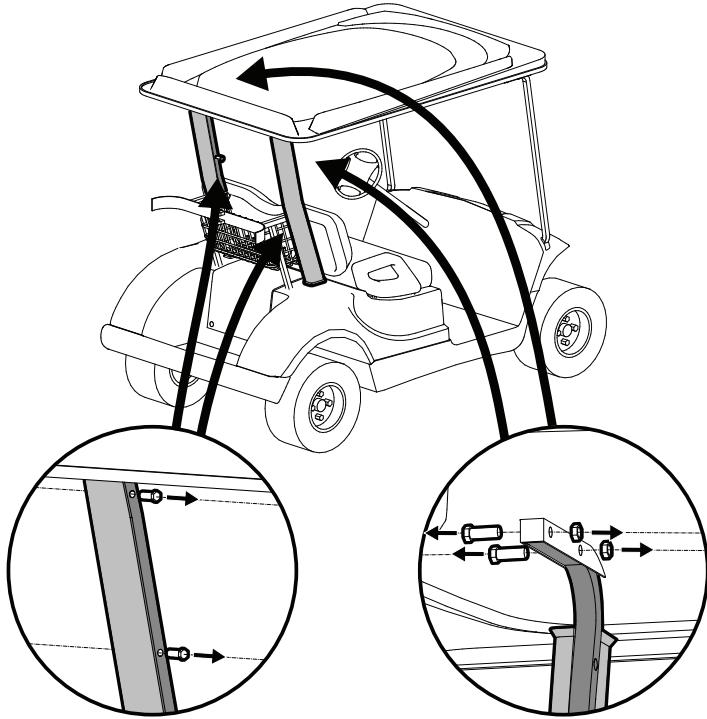

Remove bolts connecting gutters to roof supports.

Remove bolts connecting roof supports to roof.

2. Remove gutters and roof supports.

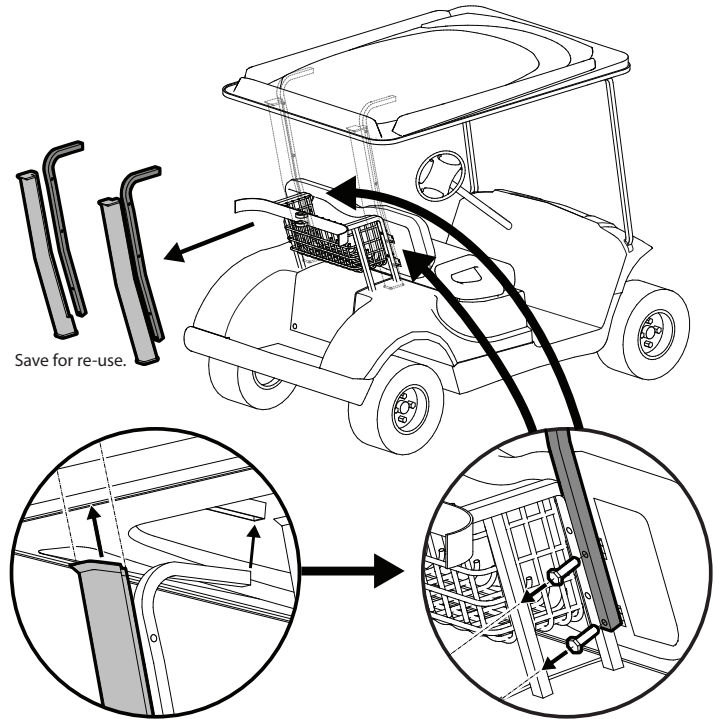

Raise roof and remove gutters by sliding upwards.

Remove bolts connecting roof supports to bag holder.

3. Remove seat cushion and access panel.

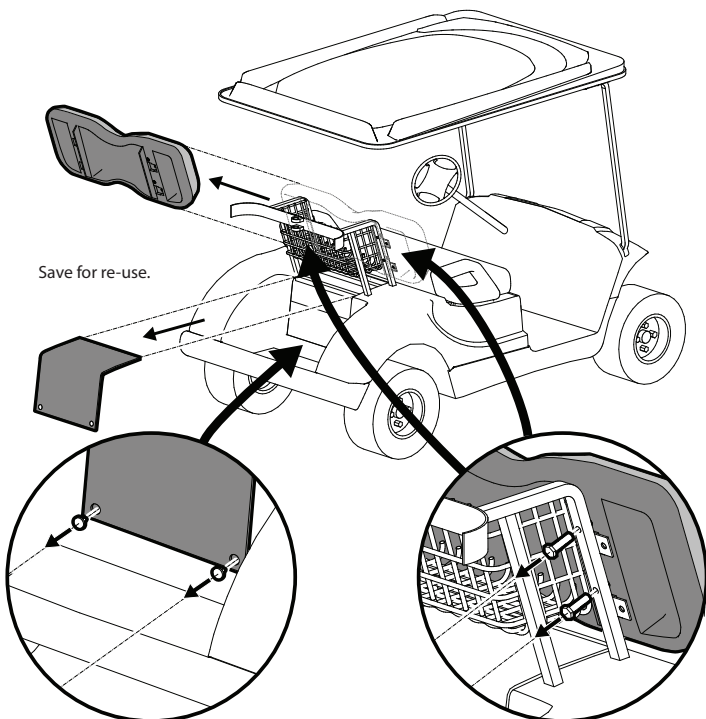

Remove rivets connecting access panel to body.

Remove bolts connecting seat cushion to bag holder.

4. Remove bag holder.

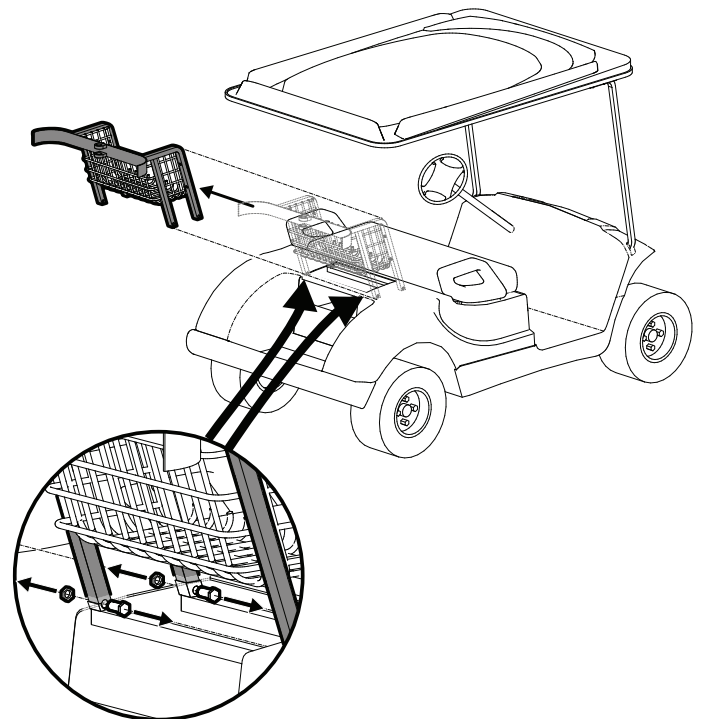

Remove bolts connecting bag holder to horizontal frame bars located underneath the body.

Installation

5. Install frame supports and access panel.

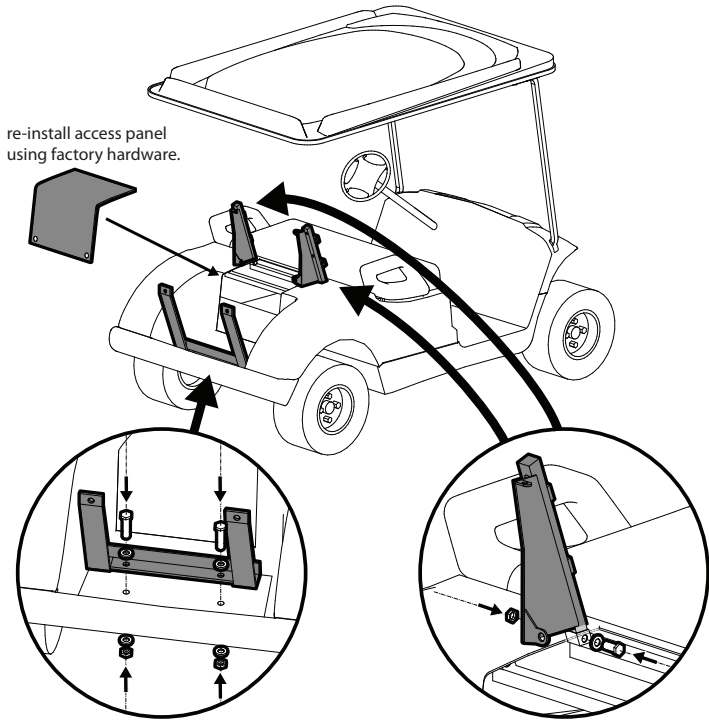

re-install access panel using factory hardware.

Remove existing bolts in bagwell. Drill holes to 3/8". Bolt rear frame support to bagwell using 5/16" x 2" bolts, washers, and nuts.

Bolt front supports to front horizontal frame bar using factory hardware.

6. Install flip seat frame.

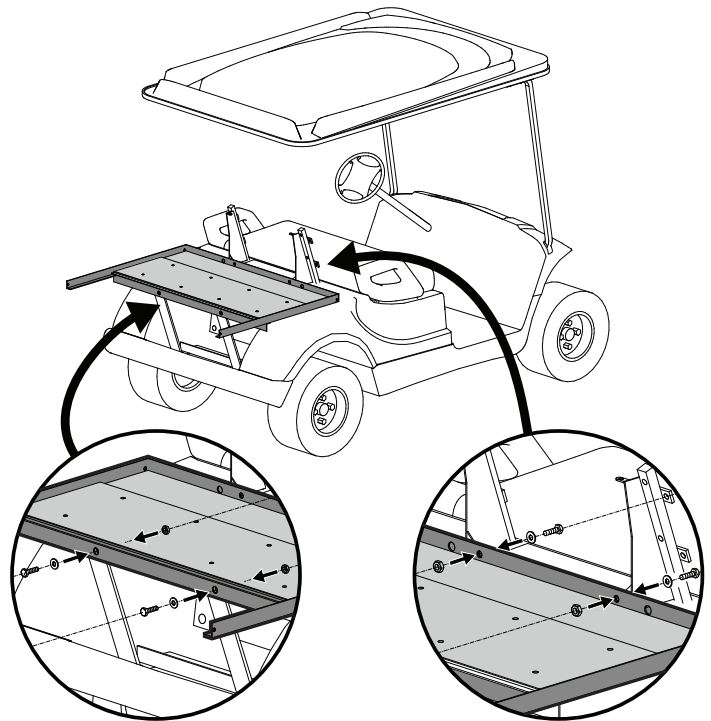

Bolt rear supports to underside of flip seat frame with 5/16" x 1" bolts, flat washers, and nuts.

Bolt front supports to outer side of flip seat frame with 5/16" x 1" bolts, flat washers, and nuts.

7. Install side rails.

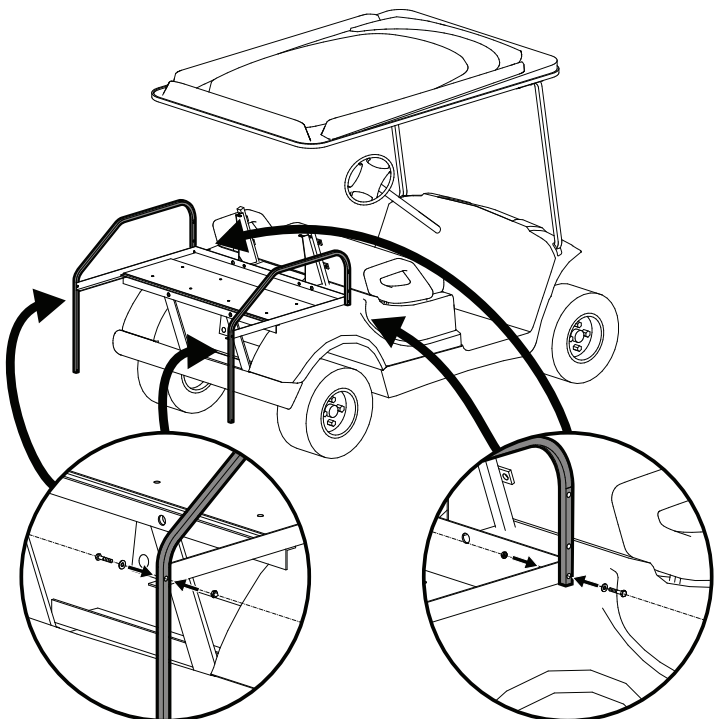

Bolt side frames to rear of flip seat frame with 5/16" x 1 1/2" bolts, flat washers, and acorn nuts.

Bolt side frames to front of flip seat frame with 5/16" x 1 1/2" bolts, flat washers, and nyloc nuts.

8. Install back frame.

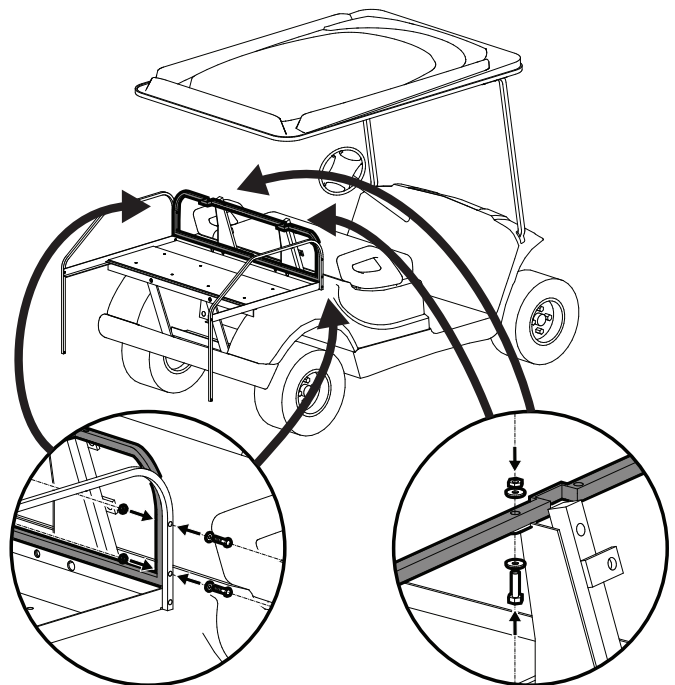

Bolt back frame to side frames with 5/16" x 2 1/2" bolts, flat washers, and nyloc nuts.

Bolt back frame to front supports with 5/16" x 1 1/2" bolts, flat washers, and nyloc nuts.

Parts not shown in proportion.

Installation

9. Install step plate.

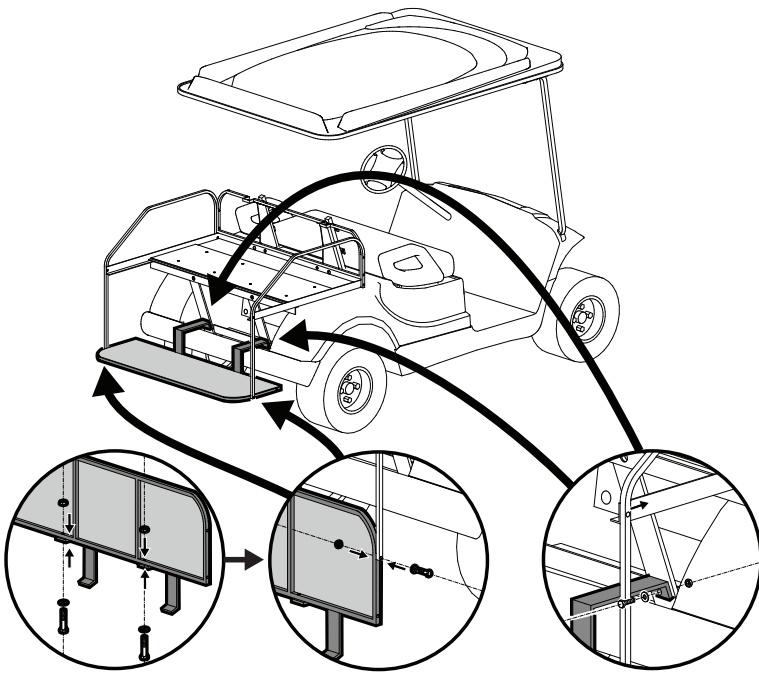

Bolt step plate supports loosely to step plate with 5/16" x 2" bolts(2), flat washers(2), and nuts(2).

Bolt step plate to side frames with 5/16" x 2 1/2" bolts(2), flat washers(2), and nuts(2).

connect step plate supports to rear supports with 5/16" x 1" bolts, flat washers, and nuts.

10. Re-install roof supports and seat cushion.

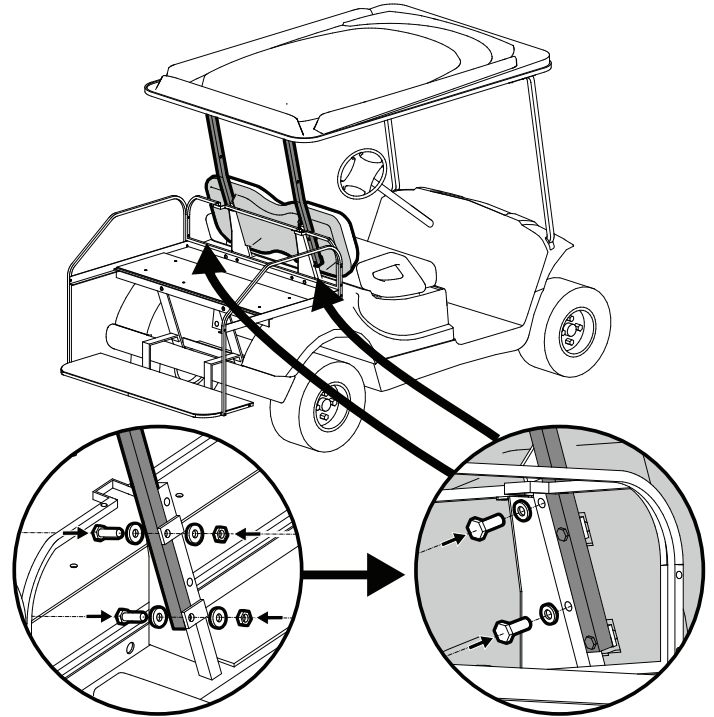

Bolt roof supports to front frame supports using 1/4" x 2 1/2" bolts, flat washers, and nyloc nuts.

Bolt Seat cushion to front frame supports using factory hardware.

11. Re-install gutters.

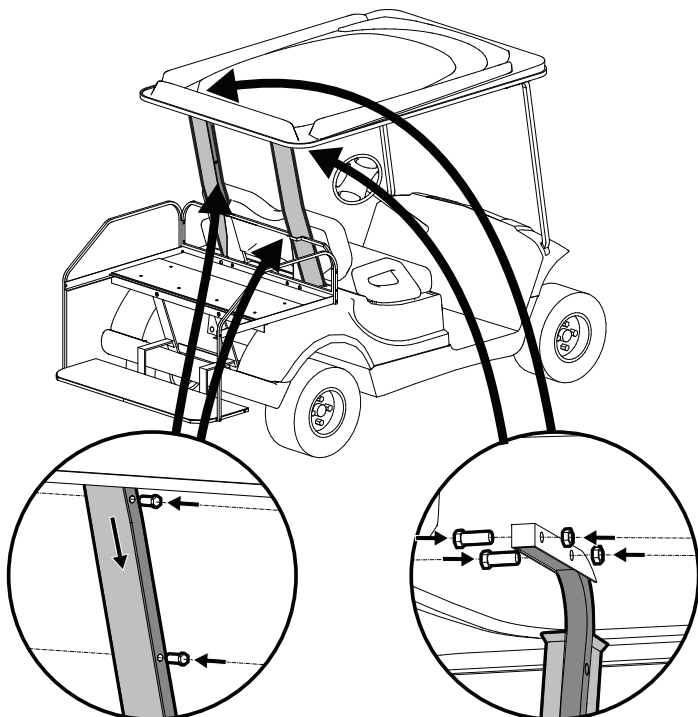

Slide gutter in place and bolt to roof supports using factory hardware.

Bolt roof supports to roof using factory hardware.

12. Install rear seat back cushion.

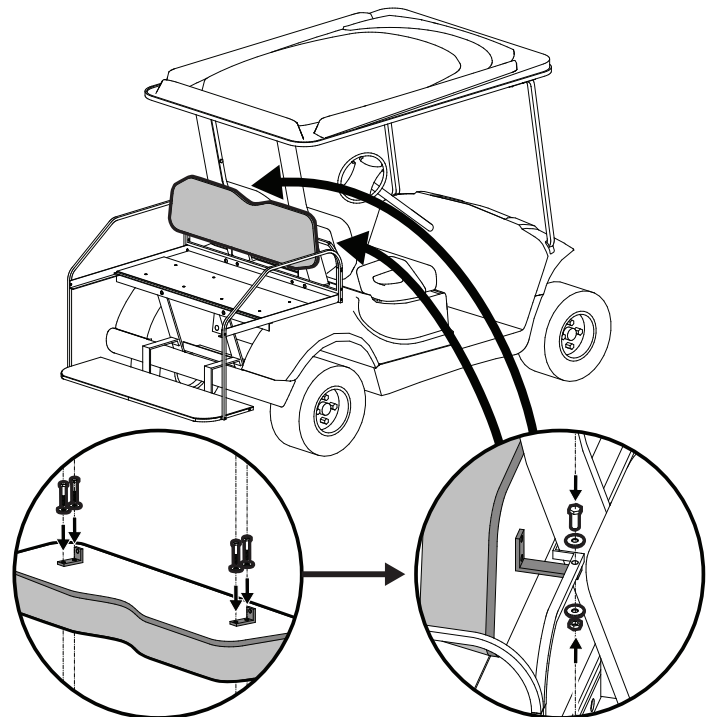

Bolt rear seat supports to back of rear seat back pad with 1/4" x 1" bolts and flat washers.

Bolt rear seat back pad to underside of back frame with 1/4" x 1 3/4" bolts, flat washers, and nuts.

Installation

13. install flip-seat pad.

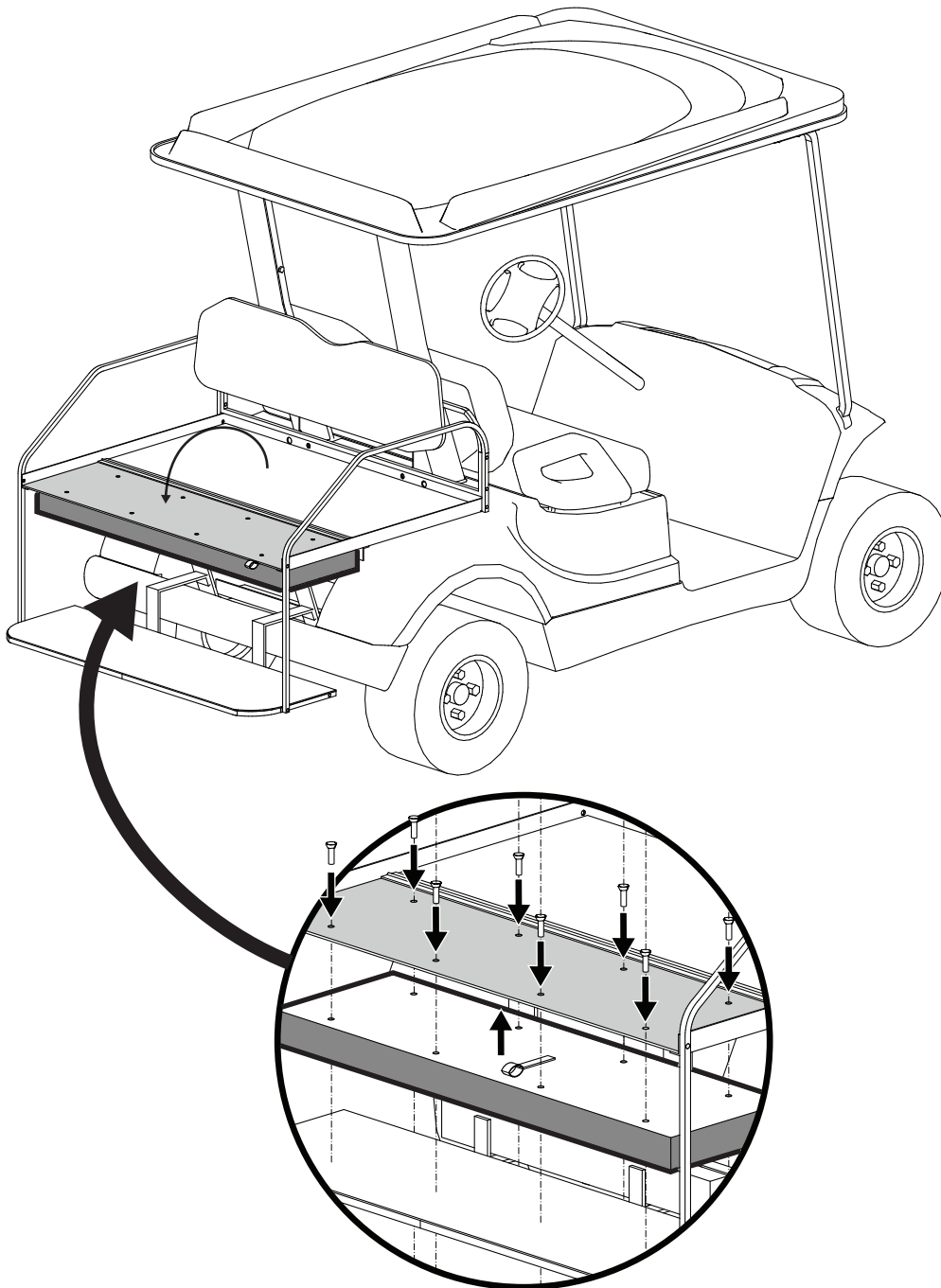

Attach flip seat pad to underside of cargo panel with allen bolts(8). Secure seat pull in between pad and panel.