

Service Bulletin SB-02 covers the replacement of broken brake handles on the Clicgear Cart, Model 1.0 and Model 2.0

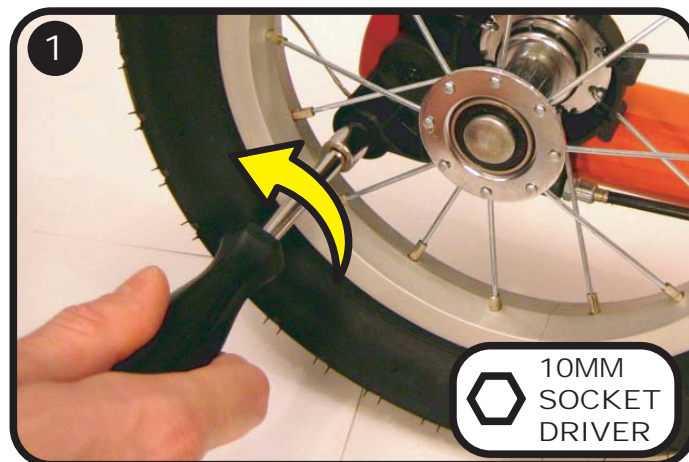

Remove the 10mm Nut from the Cable Nut Assembly. This should loosen the cable and the Brake Hammer should swing upwards when free.



Remove the two washers and lock nut from the cable nut assembly. Leave the cable nut and protective cable end cap attached to the brake cable as shown.

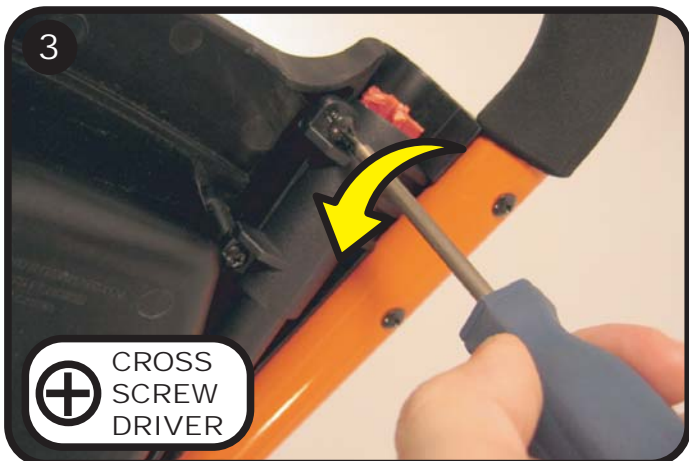

Unscrew the two screws that secure the Brake Cylinder to the under side of the tray.

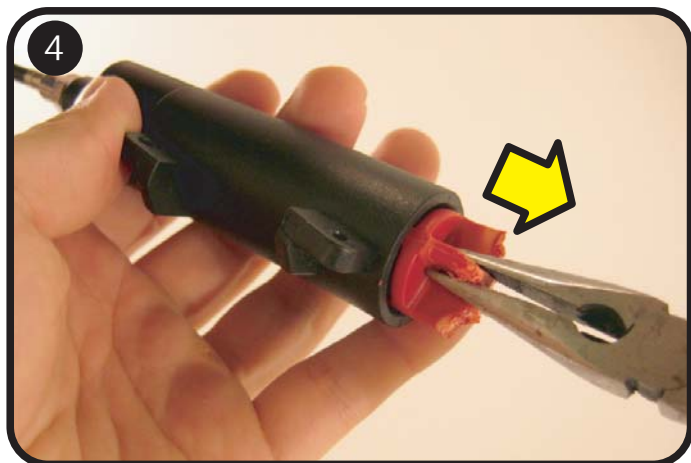

Using needle nose or similar pliers, remove the remaining portion of the Brake Handle from the Brake Cylinder.

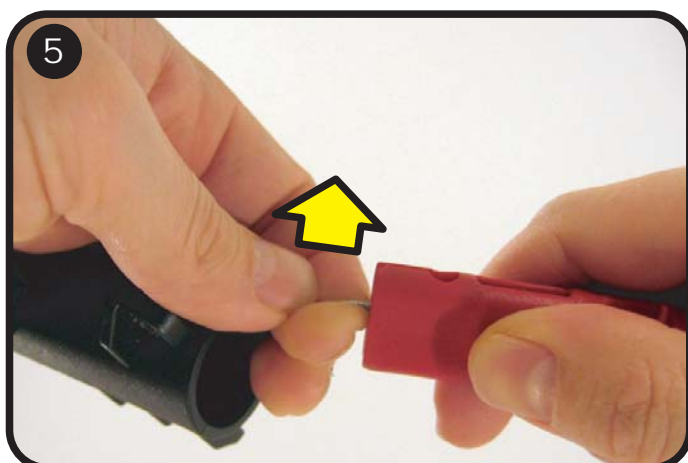

Pull the cable barrel end up and out of the brake handle.

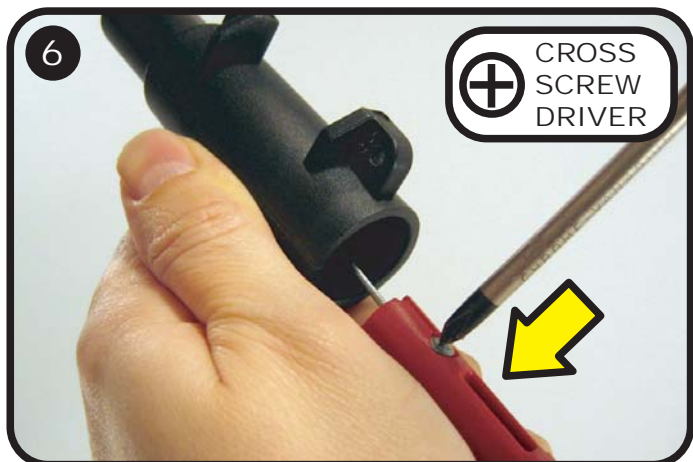

6 Install the new Brake Handle onto the cable. Carefully seat the cable end barrel into the handle using a small cross screw driver.

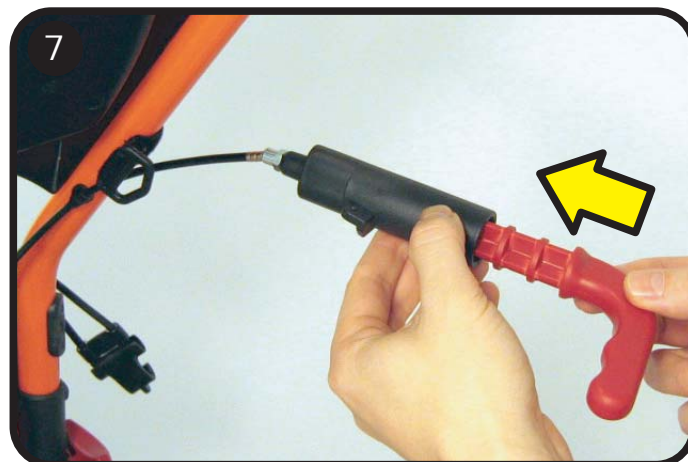

7 Insert the new brake handle into the brake cylinder. Push any excess cable back inside the cable housing.



8 Reinstall the two screws that hold the brake and brake cylinder assembly to the bottom of the tray.



9 Push the cable bolt with one (1) washer into the brake hammer with the washer between the cable and plastic. Then install the second washer and lock nut on the opposite side of the brake hammer.

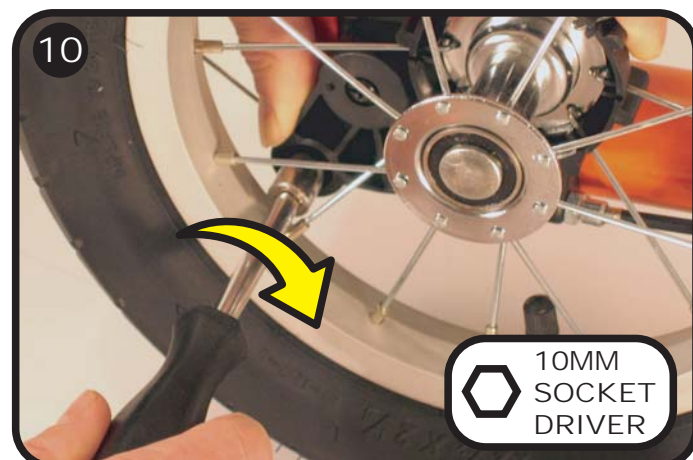

10 Tighten the cable lock nut while holding the brake hammer in the approximate position shown.

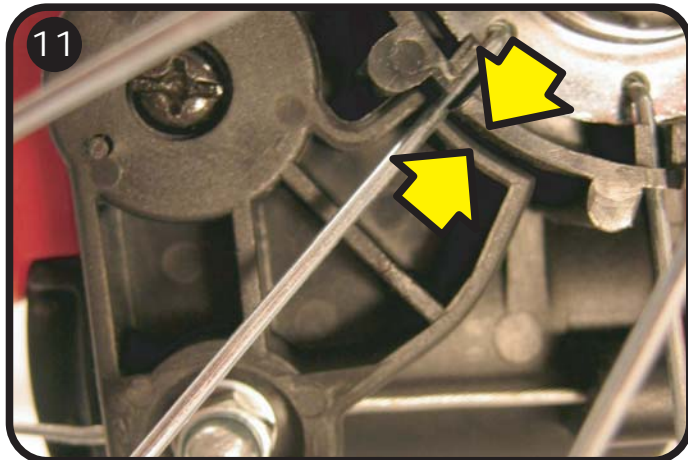

11 Adjust the brake cable until the brake hammer fully engages the brake gear, as shown, when the brake is in the ON position.