



[www.kidzshack.com.au](http://www.kidzshack.com.au)  
2023 CATALOG



# About Kidzshack

Kidzshack Owner Emma, is a single mum. She created her brand Kidzshack when she was pregnant with her second child, when she realised how inaccessible playground equipment was. 'I was on the search for some playground equipment for my outdoor area for my toddler, and everything was so expensive and nothing was available for viewing, but 'Online Only'. I wanted to create a Brand of amazing affordable kids outdoor products, making them more accessible for families for viewing and collection from a local business.' When I was a kid my Dad made us a cubby house out of an old crate, we had so much fun, and I have many amazing memories playing with my siblings. I wanted to create a range, that excites kids and families, and encourages kids to get back to outdoor play, and away from technology, the way I did, when I was a child'.

Our Mission is to create high-quality, engaging, and safe products that inspire and empower children to learn, grow, and explore their creativity, while providing joy and entertainment for families Australia Wide.

Our Values;

**Family Memories:** Playtime with our kids will always be remembered, fill our hearts and create those core memories which will stay with us forever.

**Getting Kids Outside MORE!:** These days Ipads, and Video Games are so easily accessible, we want to encourage Kids and Families to get outside more and create family memories!

**Play:** What is more important than PLAY. Life can get serious, and remembering to reconnect to our inner child through play with our kids, is uplifting. Give your child a gift, that will inspire their imagination, and watch how you become apart of that play, and the way it makes you FEEL!

**Safety & Quality:** Ensuring that the play equipment is safe for children to use is of utmost importance. Kidzshack have rigorous testing, quality control, and adherence to safety standards. Safety is our main priority, all KidzShack Cubby Houses are made to the Australian Standard AS/NZS ISO 8124-1,2,3 & 6. Our range of products, how through an extensive testing and QC process of every batch, ensuring our products are safe for Australian Kids. Detailed Instructions on how to protect your cubby house and ensure its longevity are listed on our warranty page

**Innovation:** Kidzshack are constantly seeking to innovate and introduce new features and designs that excite kids around Australia. Our Range is refreshed every 2-3 years, with exciting new features.

Our KidzShack warehouse and Display Centre is in Bibra Lake WA, and distribute Australia Wide.

Head Office & Display Centre:

2/37 Discovery Drive, Bibra Lake 6163

Monday - Friday 9:00am - 2:30pm

Saturday & Sunday - 9:00am - 12:00pm

Call us on 08 6170 5064 or email us at [sales@kidzshack.com.au](mailto:sales@kidzshack.com.au)

Company Name: Kidzshack Cubbies Pty Ltd

ABN: 45 762 391 386



# Our Vision

Our Products are extremely popular, we sell 1000s of Cubby Houses every year from Perth WA and Freight around the country.

We would love to have our products more easily accessible through Retail Stores Australia Wide, where our customers can view and collect, saving on freight costs ,or paying a local delivery fee only.

Our customers would also love to have their cubby installed for them, with the help of Retailers around the country, this would be possible!

If you are interested in stocking our products, please contact Emma on 0409 008 509 or [emma@kidzshack.com.au](mailto:emma@kidzshack.com.au)





# Lovely Shack

\$1690.00

## About Cubby:

This is our tallest cubby, making it perfect for all ages. Whether that's for younger children wanting mum and dad to visit for tea or older children that need a getaway, the Lovely Shack fits all. The verandah is completely covered allowing your young ones to get a bit of fresh air while being away from direct sunlight. It's also a great spot for having afternoon tea and biscuits.

## Special Features:

Opening Side Windows

1.2m Door

Overall Size: 1.8 (W) X 2.3 (H) X 2.2 (D) M

Internal Cubby Dimensions: 1.75m X 1.45m

Large Verandah + Fence

Letterbox Incl

Shop Shelves Incl





# Lovely Shack Drawing



The Lovely Shack comes in a grey, white and wooden finish. For painting and warranty information Go To Page 24



# Lovely Shack with Mud Kitchen

**\$2180.00**

## About Cubby:

This is our tallest cubby, making it perfect for all ages. The Lovely Shack come with a fenced verandah, allowing your young ones to get a bit of fresh air while being away from direct sunlight. The \$2180 price includes a beautiful mud kitchen installed with 4 stove tops, shelves, a tap that can be attached to a hose and shelving. It's the ideal spot to keep your young ones entertained for hours on end.

## Special Features:

Opening Side Windows

1.2m Door

Overall Size: 3.3 (W) X 2.3 (H) X 2.2 (D) M

Internal Cubby Dimensions: 1.75m X 1.45m

Large Verandah + Fence

Letterbox + Shop Shelves Incl

Side Sandpit & Mud Kitchen Incl





# Lovely Shack with Mud Kitchen Drawing



The Lovely Shack comes in a grey, white and wooden finish. For painting and warranty information Go To Page 24



# Club Shack

\$1790.00

## About Cubby:

The Club Shack has been designed for those who are looking for a Ground Level Cubby, and want their slide too! Large cubby space with verandah and letterbox. Opening Window to one side, and Fort with Slide to the other side (with Door Opening to the Fort). All windows have perspex. There is a ladder inside the cubby space so a child can climb to the fort platform and includes handrails.

## Special Features:

- Ground Level + Fort & Slide
- Overall Size: 2.6 (W) X 1.9 (H) X 2.6 (D)
- Internal Cubby Dimensions: 1.8m X 1.3m
- Verandah + Fence Incl
- Internal Stairs To Fort Incl
- Letterbox Incl





# Club Shack Drawing

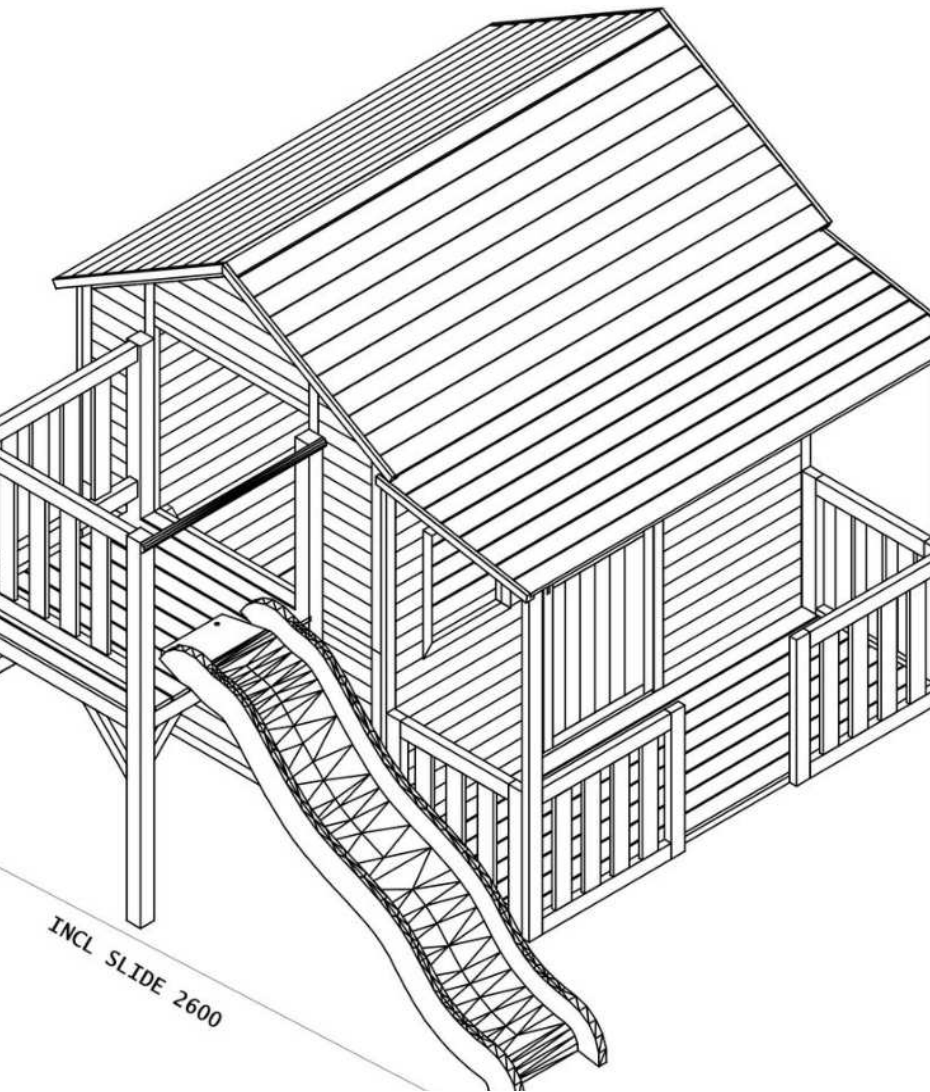
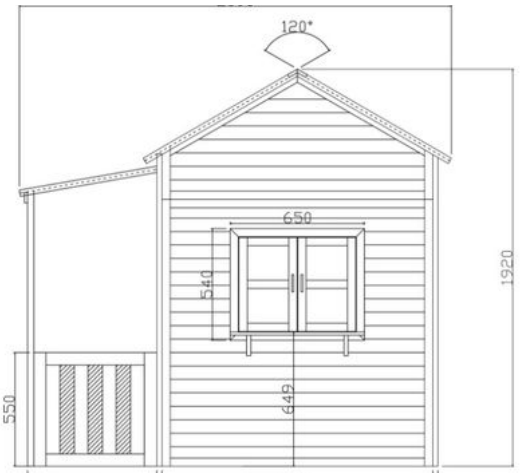
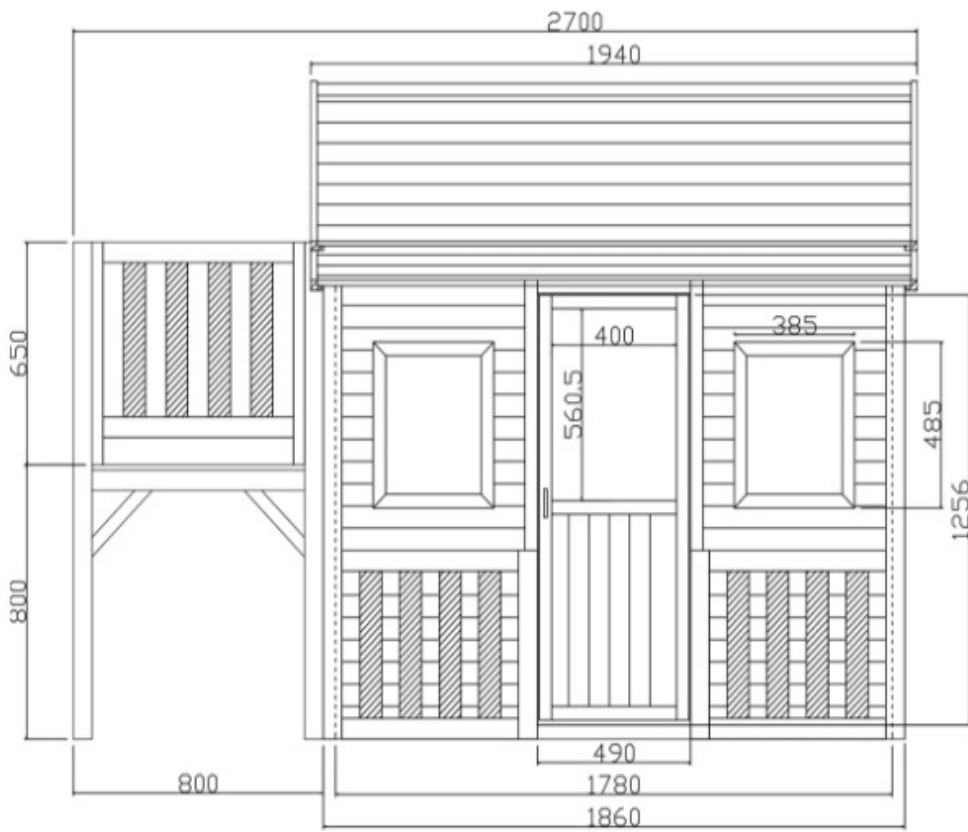

The Club Shack comes in a grey, white, yellow and wooden finish. For painting and warranty information Go To Page 24





# Club Shack with Mud Kitchen

**\$2180.00**

## About Cubby:

The Club Shack has been designed for those who are looking for a ground level cubby, and want their slide too! Large cubby space with verandah and letterbox. Opening window to one side, and fort with slide to the other side. There is a ladder inside the cubby so your child can climb to the fort platform and includes handrails. All windows have perspex. Includes an undercover sandpit/mud kitchen area with stove, working tap, sink and shelf!

## Special Features:

- Ground Level + Fort & Slide
- Mud Kitchen 1.5m(L) X 1.2m(W) X 1.3m(H)
- Overall Size: 3.8m(L) X 1.92m(H) X 2.6 (D) M
- Verandah + Fence
- Internal Stairs To Fort Incl
- Letterbox Incl
- Sandpit / Mud Kitchen Included





# Club Shack w/ Mud Kitch Drawing

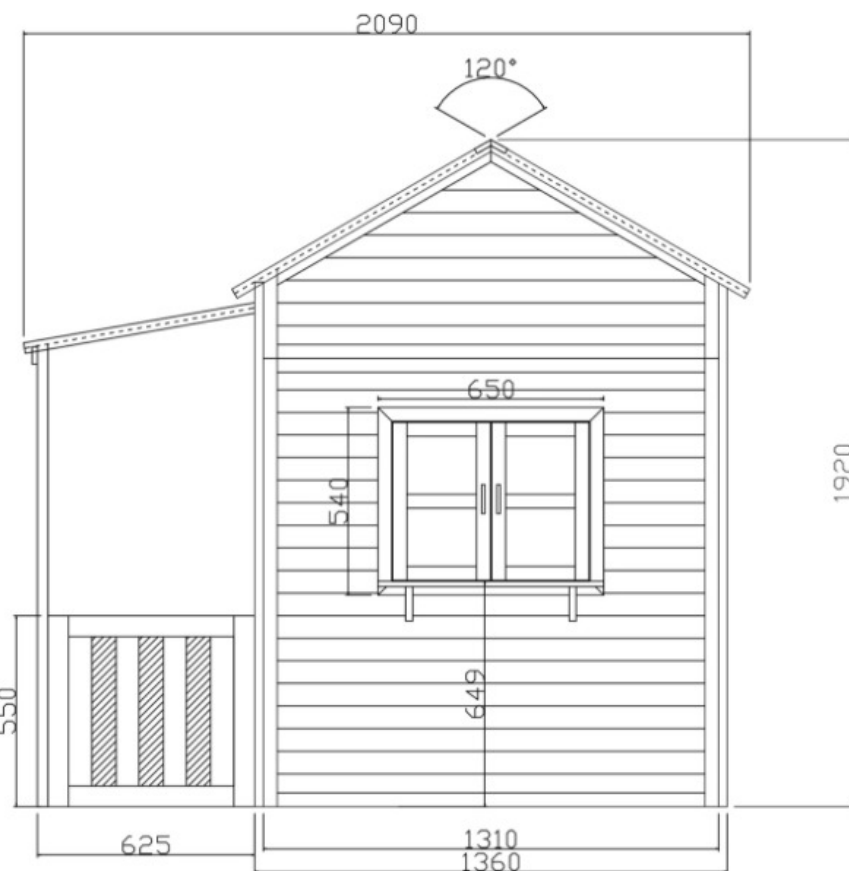
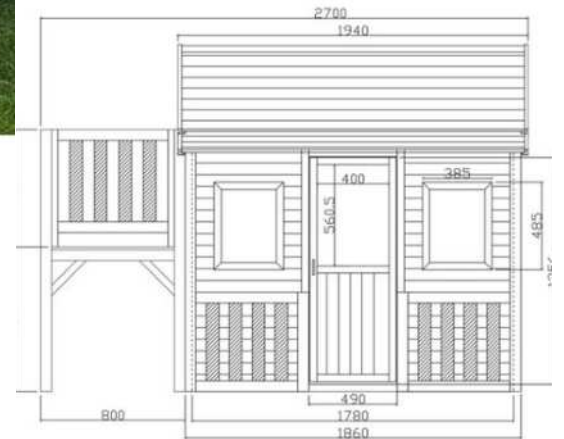

The Club Shack comes in a grey, white, yellow and wooden finish. For painting and warranty information Go To Page 24



# Barra Shack

\$1790.00

## About Cubby:

The Barra Shack is our largest ground level cubby house with an overall size of 2400mm x 2400mm. There are two opening windows to the sides, with shop shelves and closed windows to the front, all with perspex. The Barra includes a large 900mm wide verandah with fence, letterbox and two planter boxes. Internal dimensions of the cubby space is 1300mm x 2200mm.

## Special Features:

- Largest Ground Level Opening Side Windows
- 2.4 (W) X 2.1 (H) X 2.4 (D) M
- Internal Size: 2.2m X 1.3m
- Verandah + Fence
- Letter Box & Planter Boxes Incl
- Shop Shelves Incl





# Barra Shack Drawing

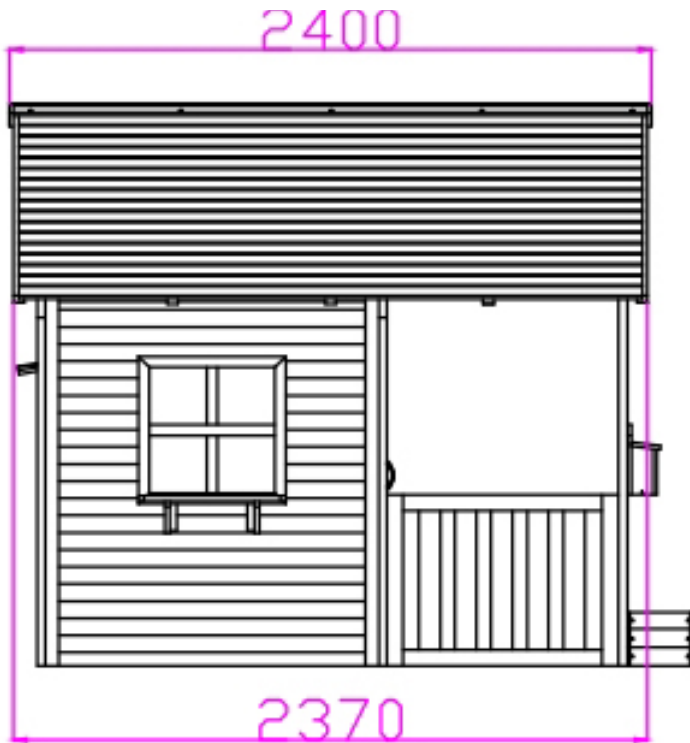
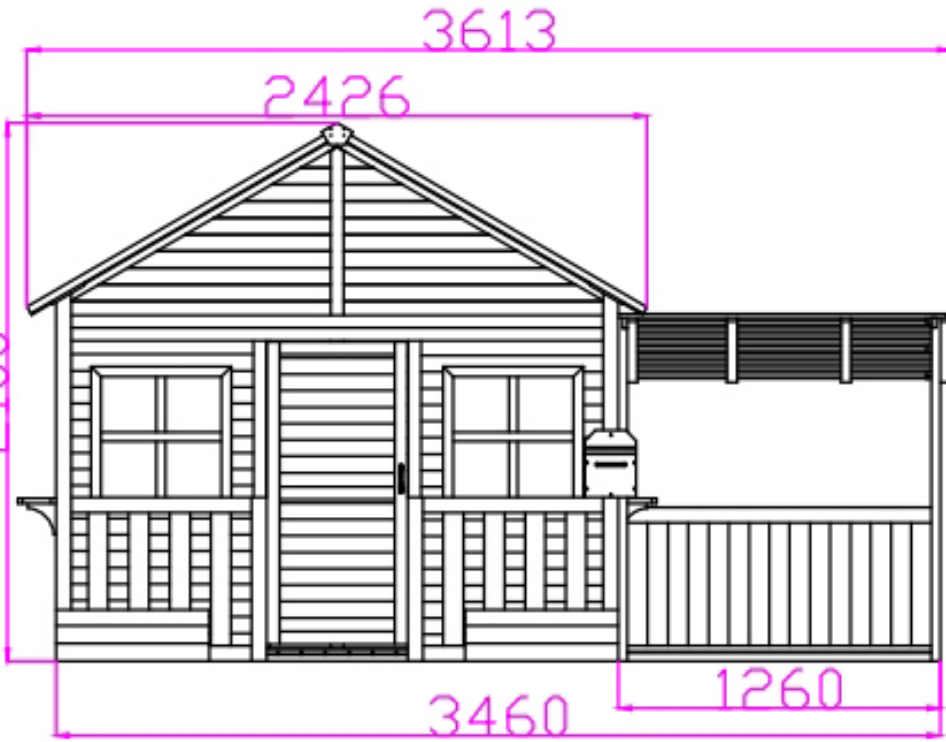

The Barra Shack comes in a grey and white finish. For painting and warranty information Go To Page 24



# Barra Shack with Carport

**\$2180.00**

## About Cubby:

The Barra Shack is our largest ground level cubby house with an overall size of 2400mm x 2400mm. There are two opening windows to the sides, with shop shelves and closed windows to the front, all with perspex. The Barra includes a large 900mm wide verandah with fence, letterbox and two planter boxes. Internal dimensions of the cubby space is 1300mm x 2200mm. Includes Carport

## Special Features:

- Largest Ground Level
- Opening Side Windows
- 2.4 (W) X 2.1 (H) X 2.4 (D) M
- Internal Size: 2.2m X 1.3m
- Verandah + Fence
- Letter Box & Planter Boxes Incl
- Shop Shelves Incl Carport Incl





# Barra Shack with Carport Drawing

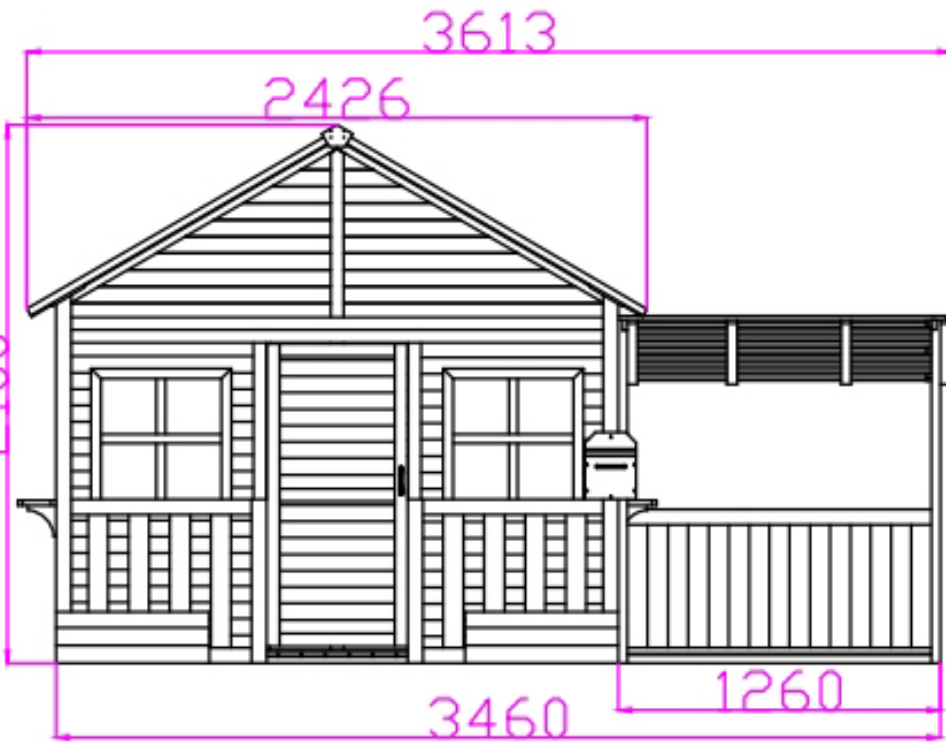

The Barra Shack comes in a grey and white finish. Carport Plain Colour. For painting and warranty information Go To Page 24



# Fun Shack

\$2400.00

## About Cubby:

Fun Shack Cubby House with Mud Kitchen and Slide!  
Large 1200x1800mm Cubby, with a wide 1000x1800mm Balcony! Big Slide, Rock Climbing Wall, Rope Wall and a Larger Sandpit with Ground Cover.

Includes a mud kitchen underneath, with cupboards, sink with taps, and stove top.

Perspex to all windows & wooden door included.

## Special Features:

Largest Elevated Cubby

Rock Climbing Wall & Rope Wall

2.2 (W) X 3.0 (H) X 4.0 (D) M

Internal Cubby Dimensions: 1.75m X 1.15m

Verandah + Fence

Slide + Handles Included

Sandpit + Mud Kitchen Included





# Fun Shack Drawing

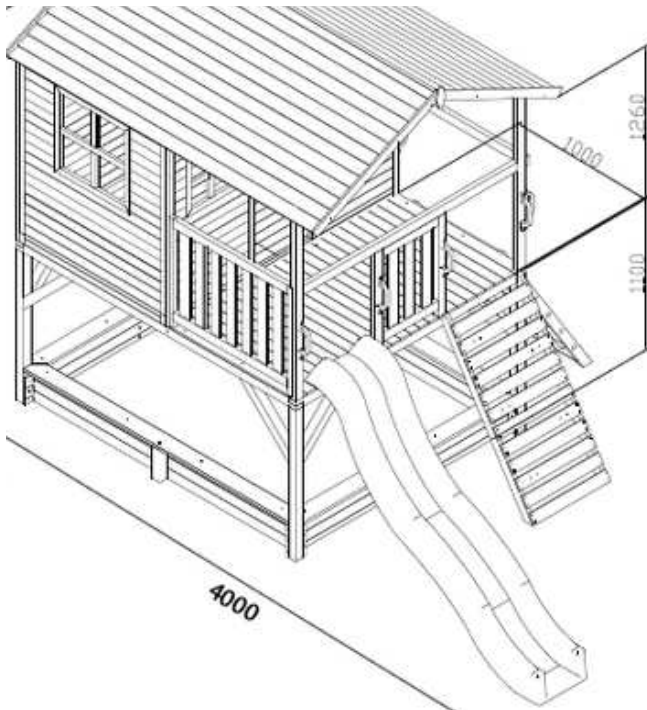
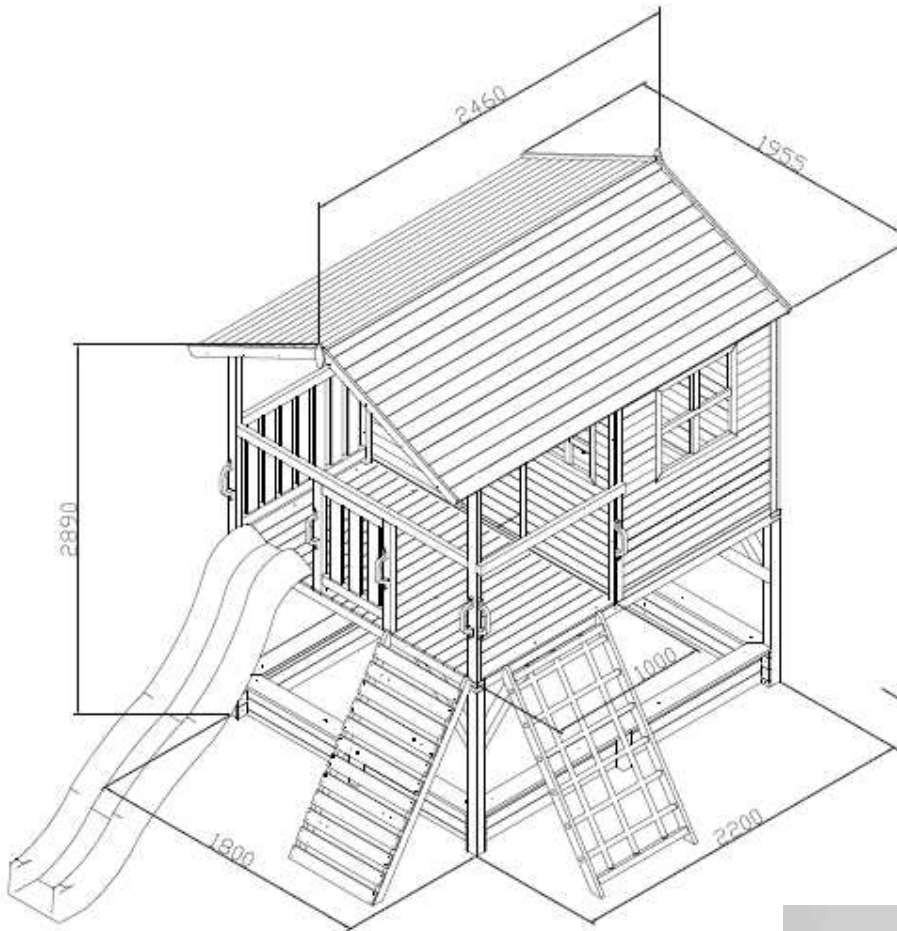

The Fun Shack comes in a grey and white, wood look finish. For painting and warranty information Go To Page 24



# Sunshine Shack

\$1740.00

## About Cubby:

The Sunshine Shack is an elevated cubby house with a sandpit (with ground cover) and mud kitchen underneath. The Mud Kitchen includes two sinks, two taps, opening cupboards and a shelf. Also included is a large 2.2m slide, wooden door and opening front windows (with perspex) which open to the inside of the cubby.

## Special Features:

- Elevated Cubby House
- Opening Front Window
- Overall Size: 2.0 (L) X 2.8 (H) X 3.7 (D) M
- Internal Size: 1.45m X 1.15m
- Verandah + Fence Incl
- Sandpit & Mud Kitchen Incl
- 2.2m Slide + Ladder Incl





# Sunshine Shack Drawing

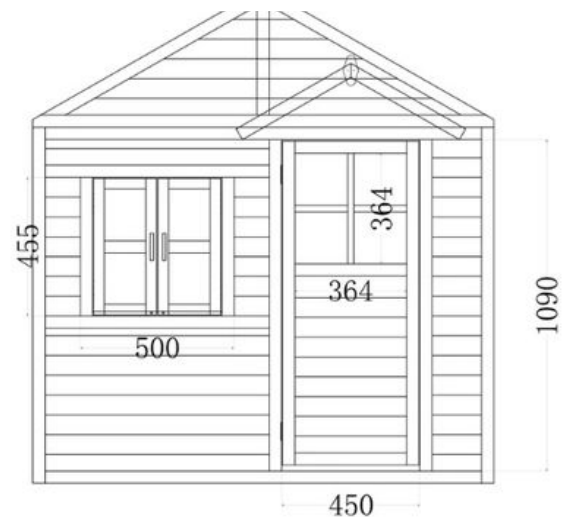
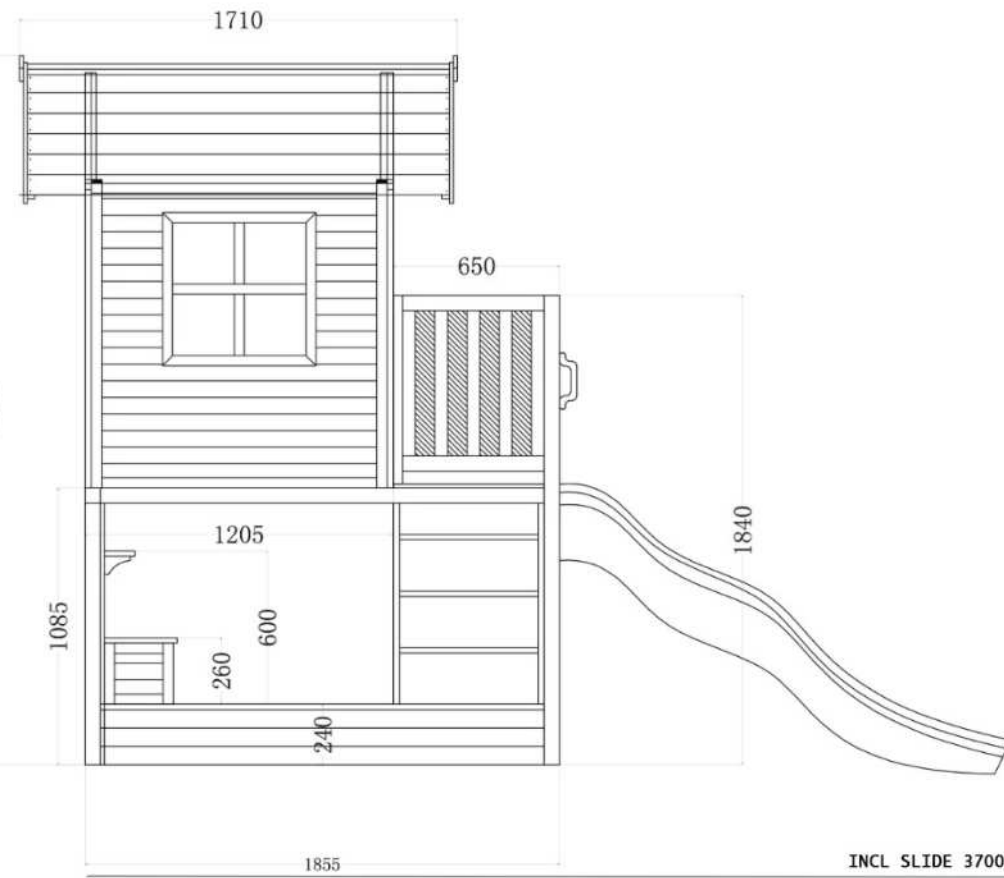

The Sunshine Shack comes in a white, wood look finish. For painting and warranty information Go To Page 24



# Beach Shack

\$1190.00

## About Cubby:

The Beach Shack is a great affordable cubby house. An Elevated Cubby with a Balcony and a 1.8m Slide. Includes Full Door, Ladder and Safety Rails. Perspex is included to all Windows.

## Special Features:

Affordable Cubby House  
Closed Windows, Full Door  
Overall Size: 1.8 (W) X 2.5 (H) X 3.6 (D) M  
Internal Size: 1.45 (W) X 1.15 (D) M  
Verandah + Fence + Handles  
1.8m Slide Incl





# Beach Shack Drawing

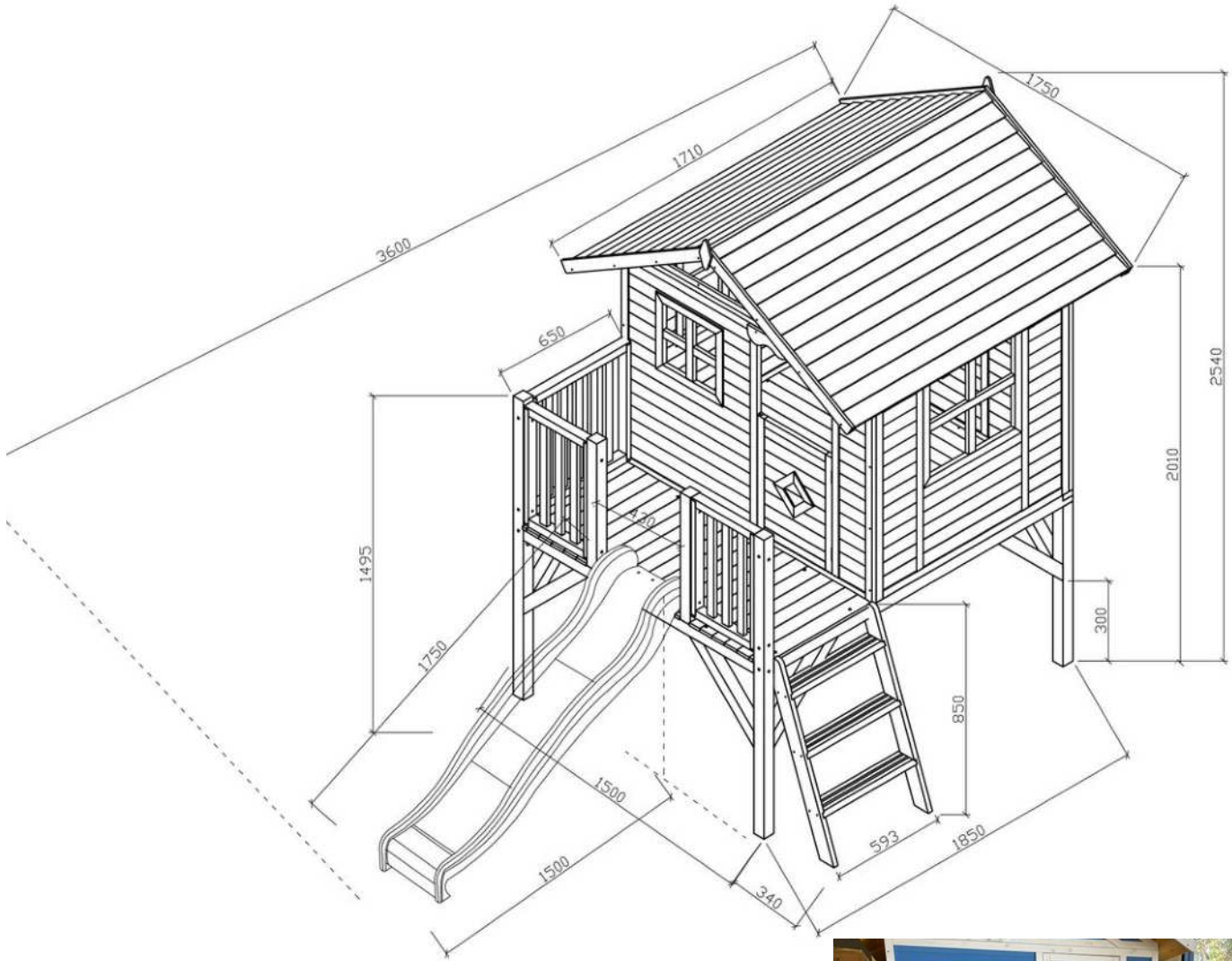

The Beach Shack comes in a blue and white finish. For painting and warranty information Go To Page 24



# Play Shack

\$1690.00

## About Cubby:

Our Play Shack is an elevated cubby with opening front windows, which open to the inner side of the cubby and XOXO Game to the Front. Includes a good size cubby space for 2-3 children to play, wrap around balcony, rock climbing wall, ladder, slide and hand rails included.

## Special Features:

- Elevated Cubby House
- Opening Front Windows
- Overall Size: 2.4 (W) X 2.5 (H) X 3.6 (D) M
- Internal Size: 1.15m X 1.35m
- Verandah + Fence + XOXO Games
- 1.8m Slide + Handles Incl
- Rock Wall & Ladder Incl





# Play Shack Drawing

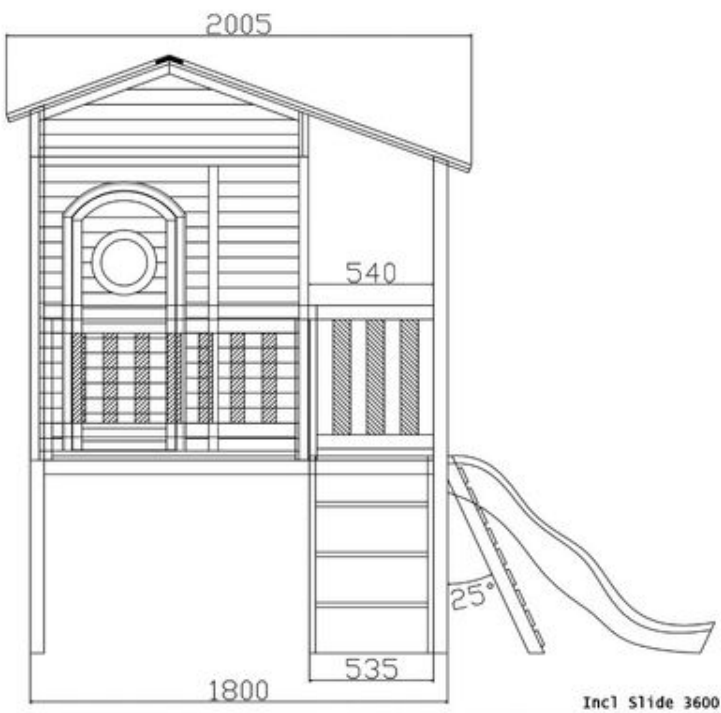
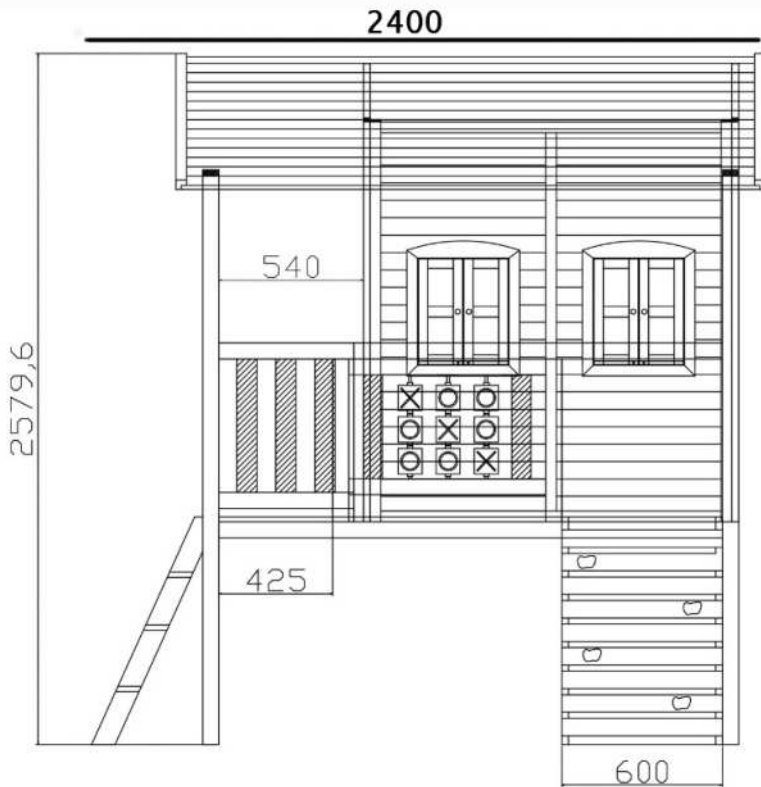

The Play Shack comes in a red/yellow/ wood look finish. For painting and warranty information Go To Page 24

# Installation & Painting Instructions

Our KidzShack Cubby Houses are nice and easy to assemble. They will arrive to you mostly in pre-made panels, assembly time takes 2-4 hours with two people and a battery drill. Picture instructions are included inside the packaging. We recommend using a battery drill fitted with a phillips head drill bit for ease of assembly.

All accessories that get added to our cubbies ie. binoculars, telescope, steering wheel, phone, etc. all need to have holes pre-drilled into your cubby to eliminate cracking. Please pre-drill before screwing accessory into place.

KidzShack suggests placing your new Cubby House on pavers, concrete or slabs. Do not place your cubby house directly onto grass as this can lead to moisture rot, due to retaining water. Please refer to a Warranty Page, for a detailed description of surface required for your install.

Some Kidzshack Cubby Houses do come pre-stained (temporary water-based stain). The stain does not provide any weather protection. For total protection and warranty purposes, you must paint your cubby house within 4 weeks of outdoor exposure. For added waterproofing, please use a silicon to seal up any gaps for extra water proofing - prior to painting - as cubbies have not been made to be water tight and are not marketed as water tight.

We recommend painting your new KidzShack Cubby House - inside and out - with two coats of the Taubmans 3-in-1 exterior primer, followed by two coats of Taubmans All Weather Exterior. (We dont recommend using any clear finishes) Please note that failing to follow painting guidelines voids all warranty.

For further Warranty Information, please visit the [Kidzshack Website](#).





# The Kidzshack "Mum" Difference



Mums know Mums!

Once you become a mum, you become apart of the Mum Club. Parenting is a whole new world, that only someone who has been through it can understand, Emma employees a support team of other mums who understand what parents of younger children want and need. Our customer service team is available by phone and email 7 days a week, to assist our customers.

Kidzshack have an amazing group of Influencer Mums who create content around, parenting, diy tips and how to dos, capturing family moments and joy with their children. The content can be accessed and viewed online, via social media and youtube.

Kidzshack Cubbies are very easy to assemble, which is a huge selling point., no Dad wants to spend his whole weekend building outdoor play equipment!

Panels are premade, holes predrilled, assembly is only 2-4 hours with 2 people and a battery drill, or we can assemble for you!

Kidzshack Panels come stained in a colour finish, however we recommend to paint for longevity.. Mums love to showcase their creativity and do a #cubbyhack, and create something magical for their kids.

Side Wall Panels are thicker than others on the market! Kidzshack pride ourselves on having the best quality cubby houses in Australia. All our cubby houses and test and meet Australian Standards.

Kidzshack have a great range of sizes and features to suit any backyard, and is always designing new products and keeping up with the latest trends.

We offer delivery Australia Wide!





**For more information  
Please call us on  
08 6170 5064**

**[www.kidzshack.com.au](http://www.kidzshack.com.au)**

