

PRODUCT CATALOG

*The Leader in
Fueling Systems Since 1967*

WORK FASTER, CLEANER, SAFER

Wiggins
Systems



Automatic Shutoff Valves

JNX-01-02



Min. Flow Rate	25 gpm (95 lpm)
Max. Flow Rate	211 gpm (800 lpm)
Operating Pressure	75 psig (520 kPa)
Weight	3.33 lbs (1.51 kg)

- Standard automatic shutoff valve
- ZN2 style receiver interface to mate with ZZ9A1 or ZZ9A2 nozzle
- 2" NPT male thread for mounting to tank
- Works with JVX (short) or JVXL (long) jet level sensor/vent
- 211 gpm (800 lpm) maximum flow rate

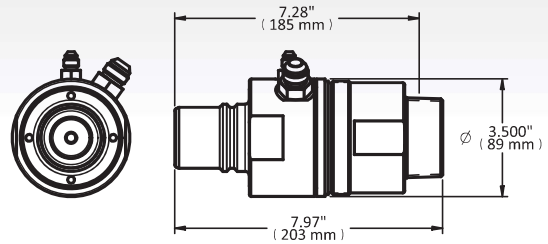

JNX-01-02-25



Min. Flow Rate	25 gpm (95 lpm)
Max. Flow Rate	211 gpm (800 lpm)
Operating Pressure	75 psig (520 kPa)
Weight	3.94 lbs (1.79 kg)

- Standard automatic shutoff valve
- ZN2-style receiver interface to mate with ZZ9A1 or ZZ9A2 nozzle
- Bolt-on mounting flange
- Works with JVX (short) or JVXL (long) jet level sensor/vent
- 211 gpm (800 lpm) maximum flow rate

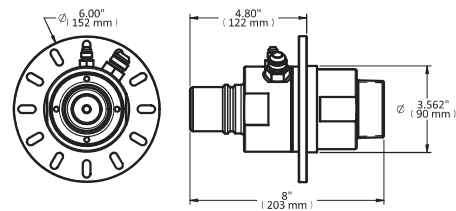

JNX-01-02C-25S



Min. Flow Rate	25 gpm (95 lpm)
Max. Flow Rate	211 gpm (800 lpm)
Operating Pressure	75 psig (520 kPa)
Weight	3.94 lbs (1.79 kg)

- Standard automatic shutoff valve
- Stainless steel ZN2-style receiver interface to mate with ZZ9A1 or ZZ9A2 nozzle
- Bolt-on mounting flange
- Works with JVX (short) or JVXL (long) jet level sensor/vent
- 211 gpm (800 lpm) maximum flow rate

