

# User Manual

---

## Wireless Inspection Camera with Color LCD Monitor

Model No.: WIC-2409C

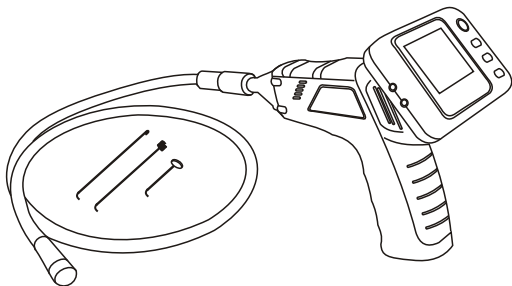

The Whistler Group Corporate Headquarters  
3604 NW Frontage Rd. • Bentonville, AR 72712  
Tel 479.273.6012 • Fax 479.273.2927

Customer Return Center  
551 N. 13th St. • Rogers, AR 72756  
Customer Service Tel 800.531.0004

[www.whistlergroup.com](http://www.whistlergroup.com)  
Version No.: 1.0

---

Please read this User Manual carefully before using the product!

---

# CONTENTS

WELCOME .....	1
PACKING LIST .....	2
COMPONENT / CONTROLS .....	3
INSTALLATION .....	4-6
MONITOR POWER CONNECTION .....	6
GENERAL SAFETY INFORMATION .....	7
OPERATION .....	7-8
SPECIFICATIONS .....	9
CAUTION .....	10
WARRANTY .....	11
ACCESSORIES .....	12
FCC INFORMATION .....	Back Cover

# WELCOME

Thank you for choosing our wireless inspection camera. Please read the user manual carefully before using this product. This product is designed as a remote inspection device. It can be used to look into tight spots and wirelessly transmit real-time video to the monitor. Typical applications include HVAC, automotive inspection, cable routing, etc.

If you have questions concerning the operation of this Whistler product, please call:

**Customer Service**

**1-800-531-0004**

**Monday - Friday • 8:00 am - 5:00 pm CT**

**or visit our website:**

**[www.whistlergroup.com](http://www.whistlergroup.com)**

Please keep the receipt in a safe place. You may register your product online at [www.whistlergroup.com](http://www.whistlergroup.com). For warranty verification purposes, a copy of your dated store receipt must accompany any unit sent in for warranty work. If the unit is returned without a dated store receipt, an out of warranty service charge applies. Note: Your warranty period begins at the time of purchase. The warranty is validated only by dated store receipt! Please record the serial numbers (located on the back of the monitor and inside the grip's battery compartment door) in the space provided in the warranty section of the manual.

Enjoy your Whistler Inspection Camera.

Sincerely,

The Whistler Group, Inc.

## PACKING LIST



Handheld Grip



9mm Camera with  
3 ft. tube



2.4 in. LCD Monitor



Mirror Accessory  
Clip



Magnet Accessory  
Clip



Hook Accessory  
Clip



Accessory Collar



Adapter Cable



Power Adapter

# COMPONENTS / CONTROLS

## Camera

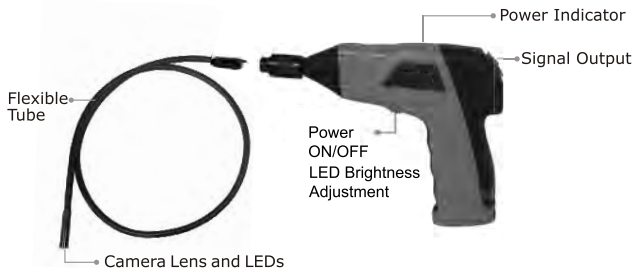

## Monitor

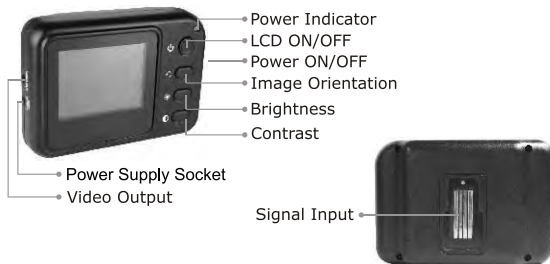

# INSTALLATION

## To Install Batteries

1. Using a screwdriver, remove screw and cover.

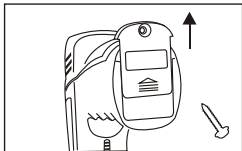
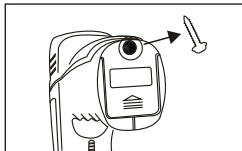

2. Remove battery compartment and insert four new AA batteries into the proper slots in the battery compartment. Proper battery orientation is indicated on the battery compartment.

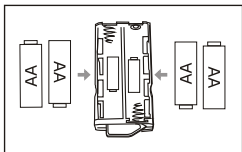
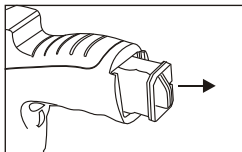

3. Reinstall battery compartment, cover, and screw.

**NOTE!** Dry your hands before installation or replacing batteries.

## To Install The Camera With Flexible Tube

Connect the camera with tube to the body, make sure the keyed ends are properly aligned. Once they are aligned, finger tighten the knurled knob to hold the connection in place.

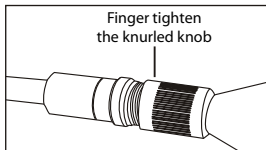
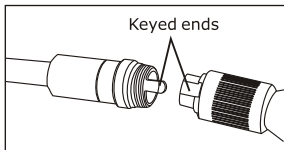

## To Install Accessory

The three included accessories (mirror, hook, and magnet) all attach to the camera (image head) in the same manner. Slide the accessory through the plastic holder, aligning it with the notch in holder. Engage the "hook" on the accessory end with hole in the camera head. Slide the plastic holder onto the camera head until it clicks to lock.

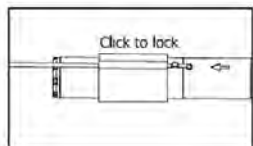
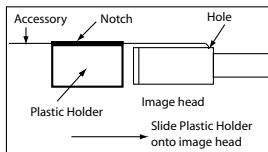
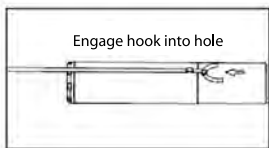

## Accessory Installed

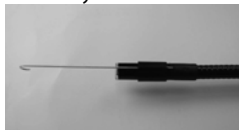

## To Install Monitor for Wired Use

Align monitor slot with connector on grip and slide monitor downward for proper engagement.

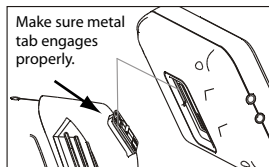
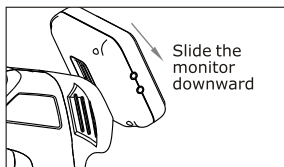
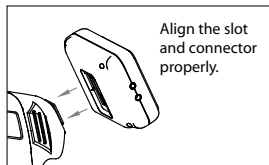
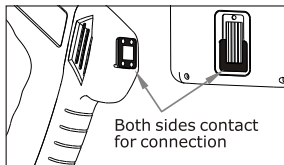

## To Install Monitor for Wired Use

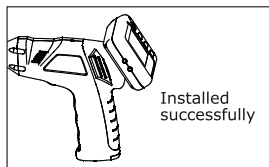
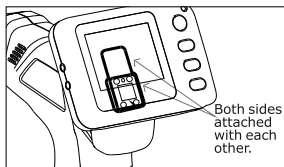

## **MONITOR POWER SUPPLY**

Plug the adapter cable into the power socket on the monitor, plug the other end of the adapter cable into the end of the power adapter. Plug the power adapter into a 110v AC outlet.

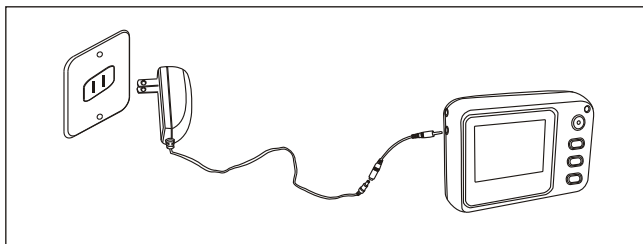

The built-in Li-battery will charge after the adapter is plugged in. The red indicator light will illuminate during charging and will turn off after charging is complete.

**TIP!** The monitor can be used while charging.



# GENERAL SAFETY INFORMATION

WARNING! Read and understand all instructions. Failure to follow all instructions listed below may result in electric shock, fire and/or serious personal injury.

---

## SAVE THESE INSTRUCTIONS!

---

- ※ **Prevent object and liquid entry.** Never spill liquid of any kind on the video display unit. Liquid increases the risk of electrical shock and damage to the product.
- ※ **The unit is not shock-resistant.** Do not use it as a hammer or drop it.
- ※ **Do not immerse the grip and monitor in water.** Store in a dry place. Such measures reduce the risk of electric shock and damage. The imager head and cable are water resistant when the unit is fully assembled, but the grip and monitor are not.
- ※ **Do not use the camera if condensation forms inside the lens.** Let the water evaporate before using again.

## Operation

1. Rotate the ON/OFF switch to turn on the camera. The power indicator on top of the grip will illuminate. The intensity of the LEDs that surround the camera on the imager head can be adjusted by rotating the switch.

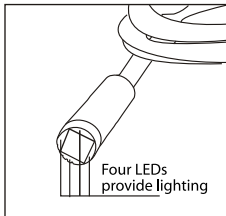
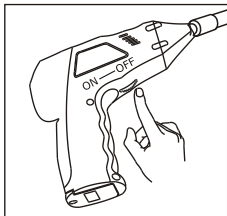

2. Slide the ON/OFF switch to the ON position. The power indicator will illuminate green and a picture will appear on the monitor when the handheld unit is turned on. Adjust the brightness, contrast, and orientation. Adjust the camera LED intensity for a better image.

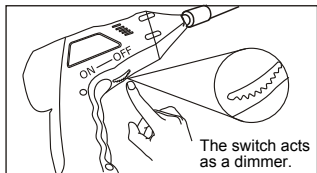
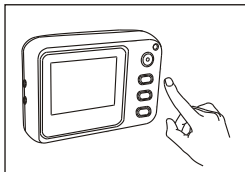

3. Gently guide the tube into the desired location. Slight adjustments can be made while maneuvering the head in a forward direction.



wireless

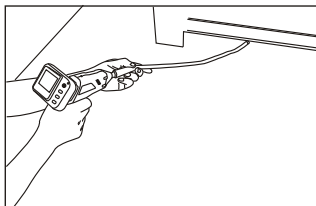

wired

- TIP!** The flexible tube can be bent to accommodate exploration in a variety of locations.

4. The accessories can be used to retrieve small items such as screws or rings.

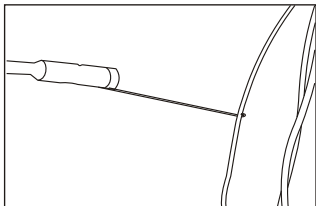

# SPECIFICATIONS

CAMERA	Model No.	GB8803
	Imaging Sensor	CMOS
	Total Pixels	640 x 480 (NTSC)
	Horizontal View Angle	45 degree
	Transmission Frequency	2468MHz
	Minimum Illumination	0 Lux
	Modulation Type	FM
	Bandwidth	18MHz
	Tube Diameter	9mm
	Power Supply	4 AA batteries
	Unobstructed Effective Range	32.8 ft.
	Waterproof Capacity	IP67(only for imager head)
	Dimensions(W×D×H)	7.3 x 5.7 x 1.6 (in.) (Exclude Flexible Tube)
Weight (Approximately)	0.99 lbs.	
MONITOR	Model No.	GB7802
	LCD Screen Type	2.36" TFT-LCD
	Effective Pixels	480 × 240
	Video System	NTSC
	Transmission Frequency	2468MHz
	Exterior Supply Voltage	8V-36VDC <sub>DC</sub>
	Consumption Current (Max.)	490mA
	Video Output Level	0.9-1.3V <sub>P-P</sub> @75ohm
	Dimensions(W×D×H)	3.9 x 2.75 x 1.18 (in.)
	Weight (Approximately)	4.94 oz.
Operating Temperature	-10°C~+50°C/+14°F~+122°F	
Operating Humidity(Max.)	15~85%RH	

- \* Actual transmission range may vary according to the weather, location, interference and building construction.
- \* All the specifications are subject to minor change without prior notice.

## CAUTION

- Do not expose the monitor or grip to dripping or splashing liquids.
- Turn off the camera and monitor when not in use.
- Use only the AC adaptor and cable supplied with the unit.
- Remove the batteries when cleaning the unit.
- Remove the batteries before storing the unit for a long time.
- When necessary, **REPLACE ALL FOUR BATTERIES** in this unit with new ones.
- Use only the size and type of battery specified.
- Be sure to install the batteries with the correct polarity as indicated on the battery compartment.
- Properly dispose of the batteries. Exposure to high temperatures can cause the batteries to explode. Do not dispose of batteries in a fire. When stored, place tape over the terminals to prevent direct contact with other objects. Some countries have regulations concerning battery disposal. Please follow all applicable regulations.

## WARRANTY INFORMATION

### Consumer Warranty

This Whistler Inspection Camera is warranted to the original purchaser for a period of one year from the date of original purchase against all defects in materials and workmanship. This limited warranty is void if the unit is abused, modified, installed improperly, or if the housing and/or serial numbers have been removed. There are no express warranties covering this product other than those set forth in this warranty. All express or implied warranties for this product are limited to the above time. Whistler is not liable for damages arising from the use, misuse, or operation of this product. During the warranty period, defective units will be repaired without charge to the purchaser when returned with a dated store receipt to the address below. Units returned without a dated store receipt will be handled as described in section "Service Out of Warranty".

*Note: Damage caused by incorrect battery placement or battery leakage is not covered under this warranty.*

When returning a unit for service, please follow these instructions:

1. Ship the unit in the original carton or in a suitable sturdy equivalent, fully insured, with return receipt request to: Whistler Repair Dept.  
551 N. 13th St.  
Rogers, AR 72756

Please allow 3 weeks turnaround time.

**Important: Whistler will not assume responsibility for loss or damage incurred in shipping. Therefore, please ship your unit insured with return receipt requested. CODs will not be accepted!**

2. Include with your unit the following information, clearly printed:

- Your name and street address (for shipping via UPS), a daytime telephone number and an email address, if applicable.
- A detailed description of the problem (e.g., "Cannot adjust brightness on monitor").
- A copy of your dated store receipt or bill of sale.

3. Be certain your unit is returned with its serial number. For reference, please write your unit's serial numbers in the following spaces: Monitor S/N: \_\_\_\_\_ Grip S/N: \_\_\_\_\_

Units without serial numbers are not covered under warranty. Important: To validate that your unit is within the warranty period, make sure you keep a copy of your dated store receipt. You may register your warranty online at [www.whistlergroup.com](http://www.whistlergroup.com), however, for warranty verification purposes, a copy of your dated store receipt must accompany any unit sent in for warranty work.

### Service Out of Warranty

Units will be repaired at "out of warranty" service rates when:

- The unit's original warranty has expired.
- A dated store receipt is not supplied.
- The unit has been returned without its serial number.
- The unit has been abused, modified, installed improperly, or had its housing removed.

The minimum out of warranty service fee for your Whistler Inspection Camera is \$75.00 (U.S.). If you require out of warranty service, please return your unit as outlined in the section "Service Under Warranty" along with a certified check or money order for \$75.00. Payment may also be made by MasterCard, VISA, or American Express; personal checks are not accepted. In the event repairs cannot be covered by the minimum \$75.00 service fee, you will be contacted by a Whistler technical service specialist who will outline options available to you. If you elect not to have your unit repaired, it will be returned to you along with your certified check or money order.

## **ACCESSORIES**

Call 1-800-531-0004 or visit [www.whistlergroup.com](http://www.whistlergroup.com) for available accessories.

<b>ORDER#</b>	<b>DESCRIPTION</b>	<b>PRICE</b>
WIC-100P	Accessory Pack <i>includes hard case, 3 ft. extension shaft, and magnetic swivel mount</i>	\$99.95

## FCC INFORMATION

This device complies with part 15 of the FCC Rules. Operation is subject to the following two conditions:

- (1) this device may not cause harmful interference,
- (2) this device must accept any interference received, including interference that may cause undesired operation.

Changes or modifications not expressly approved by the party responsible for compliance could void the user's authority to operate the equipment.

**FCC ID: TW5GB8802-GB8803**

Note: Changes or modifications not expressly approved by Whistler could void the user's authority to operate the equipment.

### **EU Environmental Protection**

Waste electrical products should not be disposed of with household waste. Please recycle where facilities exist. Check with your Local Authority or retailer for recycling advice.

