



## INTRODUCTION

Dear Whistler Owner,

If you have questions concerning the operation of this Whistler product please call:

**CUSTOMER SERVICE  
1-800-531-0004**

Monday - Friday • 8:00 am - 5:00 pm CT  
or visit our website  
**www.whistlergroup.com**

Please keep the receipt in a safe place. You may register your product online at www.whistlergroup.com. For warranty verification purposes, a copy of your dated store receipt must accompany any unit sent in for warranty work. If the unit is returned without a dated store receipt, an out of warranty service charge applies.

[www.whistlergroup.com](http://www.whistlergroup.com)

Enjoy your Whistler detector and please drive safely.

Sincerely,

The Whistler Group, Inc.

## TABLE OF CONTENTS

Model Features Summary.....	3 - 5
<b>Installation.....</b>	<b>5-6</b>
• Mounting Guidelines	5
• Windshield Mounting	5-6
• Power Connection	6
• Fuse Replacement	6
<b>Operation.....</b>	<b>7 - 12</b>
• Power On Self Test & Volume	7
• Integrated Real Voice®	7
• Feature Engaged Confirmation	7
• Self Test Mute	7
• Setting Saver	8
• Auto Quiet Mode	8
• Quiet Mode	8
• City/City I/ City 2 Modes	9
• Highway Mode	9
• TFSR - Traffic Flow Signal Rejection	10
• Alert Periscopes	10
• Dim/Dark Mode	10 - 11
• Engaging / Disengaging VG-2 Detection	11
• Vehicle Battery Saver Mode	12
• Stay Alert	11 - 12
<b>Laser &amp; Radar Alerts.....</b>	<b>13 - 14</b>
• Laser Audio / Visual Alerts	13
• Laser Tips	13
• Pulse Protection®	13
• Safety Warning System®	14
<b>VG-2 Alerts.....</b>	<b>14</b>
<b>POP™ Mode.....</b>	<b>15</b>
<b>Option Select Mode.....</b>	<b>15 - 16</b>
• Reset Features	16
<b>Troubleshooting Guide.....</b>	<b>16 - 17</b>
• Care & Maintenance	17
<b>Are Detectors Legal?.....</b>	<b>18</b>
• FCC Information	18
<b>Speed Monitoring.....</b>	<b>19 - 21</b>
• Radar Facts	19
• Laser Facts	19 - 20
• Other Speed Detection Systems	20 - 21
<b>Warranty Information.....</b>	<b>22 - 24</b>
<b>Specifications.....</b>	<b>25</b>
<b>Accessories.....</b>	<b>26</b>

## CR70 FEATURES

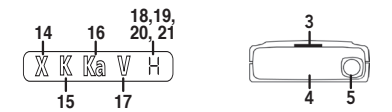

### Features of CR70

- Total Band Protection™
- Numeric Icon Display
- Detects POP™ Mode
- 360° Protection
- Real Voice®
- VG-2 Cloaking
- 3 City Modes
- Quiet/Auto Quiet Mode
- Dim/Dark Mode
- Stay Alert
- Setting Saver
- Vehicle Battery Saver™
- Safety Warning System™
- Alert Priority
- Alert Periscopes
- Laser Atlanta™ Stealth Mode Detection
- Traffic Flow Signal Rejection

## OPERATION

### Traffic Flow Signal Rejection (TFSR)

Recently, many new products operate on X or K band causing nuisance alerts to radar detectors. Some of these are radar based Traffic Monitoring Systems mounted to poles alongside the highway and others are K Band Lane Change Assistants and Blind Spot Detectors found on some automobiles. When turned on in option mode, helps eliminate excessive alerts from erroneous X and K-band sources. Traffic flow monitoring systems are getting more common. Many of these systems generate radar signals to measure the flow of traffic across multiple lanes. Most detectors will alert you to it unnecessarily. This rejection feature examines the incoming signal and will aid in reducing the alerts to such sources.

We suggest you turn TFSR on if you are experiencing excessive X or K band false alerts every half mile or so along stretches of roadway that contain these traffic flow sensors.

### Alert Periscopes

Whistler's Alert Periscopes provide an added attention getting visual alert. The two extra LED's flash on and off when the unit alarms to provide a unique visual alert. This alert can be programmed through the Option Select Mode to be: ON, OFF, or FLASHING during alerts.

## FEATURE DESCRIPTIONS

- Bracket Release Button** – provides quick and easy release of the mounting bracket.
- Speaker** – provides distinct audio warnings for X, K, Ka band radar, safety warning system, laser and VG-2.
- Mounting Bracket Location** – slot holds mounting bracket firmly.
- Radar Antenna** – compact, high-efficiency antenna receives radar signals.
- Front Laser** – high gain optical lens provides increased sensitivity and field of view for leading-edge laser detection.
- Rear Laser** – an integrated optical waveguide provides superior detection of laser signals transmitted from behind.
- City Button** - reduces the annoyance of false alerts typically encountered in urban driving areas.
- Quiet Button** - pressing QUIET before a radar signal is detected engages Auto Quiet Mode which provides “clicking” sounds after the initial warning. Pressing QUIET during a radar encounter silences audio alerts, while allowing visual alerts to keep you informed.
- Power / Volume Control** - turns unit on/off and adjusts audio level.
- Dim / Dark Mode** - engages Dim/Dark modes.
- Menu Button** - enters option select mode.
- Numeric Icon Display** - combines icon display with a 7 segment digital display that shows signal strength indication and band identification.
- Alert Periscopes** - provide an additional attention getting visual alert.
- X-band Icon** - indicates the unit is receiving a X-band signal.
- K-band Icon** - indicates the unit is receiving a K-band signal.

## OPERATION

### Dim/Dark Mode

Dim/Dark Mode reduces the illumination of the display.

- Press and release the Dark button to reduce illumination to a dim setting.
- Press and release the Dark button a second time to engage Dark Mode. The display illumination is further reduced.

Dim or Dark can be engaged during an alert. In Dark Mode, the display goes dark for as long as a signal is being detected and 20 seconds after, then the display returns to the dimmer setting.

- Press and release the Dark button a third time to restore the display to full illumination.

### Engaging/Disengaging VG-2

See Option Select Mode to turn this feature on.

### Vehicle Battery Saver Mode

The Vehicle Battery Saver Mode automatically shuts off your detector after 6 hours. The timer is reset if the detector is turned off, unplugged or any button is pressed before the time has expired. The detector will alert you with an audible and visual warning before it shuts off. During this warning, you can momentarily reset the unit by pressing any button. This will reset the timer. If the unit has automatically turned itself off, press any button to turn the unit back on.

## FEATURE DESCRIPTIONS

- Ka-band Icon** - indicates the unit is receiving a Ka-band signal.
- V** - indicates that the unit is receiving a VG-2 signal. Indicates that VG-2 is engaged.
- H** - indicates unit is in Highway mode.
- C - City Icon** - indicates that the unit is operating in city mode.
- Signal Strength Icon** - indicates the strength of the signal being detected.
- L** - indicates that the unit is receiving a laser signal.

## INSTALLATION

### Mounting Guidelines

- Mount the unit as low as possible near the center of the windshield.
- Do not mount the unit behind wipers, ornaments, mirrored sunscreens, etc. These obstructions have metal surfaces which can affect radar and laser signals and reduce critical warning time. (Regular tinted glass does not affect reception.)
- Some windshields have an Instaclear™ or Electriclear™ type coating, which affects radar signals. Consult your dealer or the owner's manual to determine if your windshield has this coating.
- Avoid placing unit in direct contact with the windshield.
- To reduce the possibility of theft, conceal the unit when not in use.

### Windshield Mounting

- Install the two suction cups and rubber bumper onto the bracket by fitting them into their holes.
- Press the suction cups onto the windshield at the location you have chosen.

## OPERATION

### Stay Alert Feature

The Stay Alert Feature is designed to test a driver's alertness. To engage (when unit is not alarming):

- Press and hold the City button for less then 2 seconds. The “H” or “C” will flash indicating Stay Alert is activated. Within 30-60 seconds two beeps are sounded; to show alertness, the driver must press either the City, Menu or Quiet button within 3-5 seconds. If the button is pressed within 3-5 seconds, the cycle is repeated. If a button was not pressed within 3-5 seconds, the alarm sounds and the display flashes all the LEDs.
- Press Dark to cancel Stay Alert.

**WARNING!!!** Stay Alert is NOT intended as a substitute for adequate rest. You should NOT operate a vehicle if you are drowsy. During extended periods of vehicle operation, you should take frequent breaks. Improper reliance on the Stay Alert may result in vehicle damage, personal injury or death.

**NEVER OPERATE A  
VEHICLE IF YOU  
ARE DROWSY!**

## INSTALLATION

### Windshield Mounting (Continued)

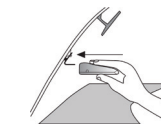

**IMPORTANT:**  
Make sure the unit is level.

**Note:** Some newer cars have a plastic safety coating on the inside of the windshield. The windshield bracket may leave permanent marks on this type of surface. To find out if your vehicle has this type of windshield, check the owner's manual or ask your dealer. We recommend that you do not leave the suction cup bracket on the windshield in direct sunlight. If the detector is removed, this may cause blistering of the dash in some vehicles.

### Power Connection

- Plug the small end of the power cord into the unit's power jack.
- Plug the large end into the vehicle's cigarette lighter.

### Fuse Replacement

The lighter socket plug is equipped with a replaceable 2 amp, 3AG fuse located behind the silver tip. To replace the fuse, carefully unscrew the tip of the plug.

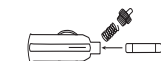

**IMPORTANT:** Unscrew slowly. The tip contains a spring which may fly out when disassembling. Insert the new fuse with the spring and screw on the tip. With use, the screw cap on the plug may loosen. Retighten it occasionally.

## LASER/RADAR ALERTS

### Laser Audio / Visual Alerts

When a laser signal is detected, the unit indicates an “L” on the display. The audio alert is continuous for a minimum of 3 seconds.

### Laser Tips

If you are the targeted vehicle, a laser gun can often determine your speed within a few seconds after you receive an alert. In this situation there is generally no time to safely adjust your speed. However, if you are traveling near or behind the targeted vehicle and receive an alert, response time should be sufficient. Any laser alert, regardless of duration, requires immediate action!

### Pulse Protection®

Pulse (or instant-on) radar is more difficult to detect than conventional radar because it remains “off” until activated to measure the speed of a targeted vehicle. When a pulse type transmission is detected, your Whistler detector sounds an urgent 3-second audio warning and a “P” will be displayed. After the 3-second pulse alert, the standard alert pattern continues for as long as the signal is present. It is important to respond promptly to a pulse alert, since warning time may be minimal.