

Dear Whistler Customer,

If you have questions concerning the operation of this Whistler product please call:

Customer Service
1-800-531-0004

Monday - Friday • 8:00 am - 5:00 pm CT
or visit our website

www.whistlergroup.com

Please keep the receipt in a safe place. You may register your product online at **www.whistlergroup.com**. For warranty verification purposes, a copy of your dated store receipt must still accompany any unit sent in for warranty work. If the unit is returned without a dated store receipt, an out-of-warranty service charge applies. Note: Your warranty period begins at the time of purchase. The warranty is validated only by the dated store receipt! Please record the serial number of the unit in the space provided in the accessories section of the guide.

To fully acquaint yourself with the operation of your Whistler detector and to better understand the differences between detecting radar, laser, and safety radar signals, we recommend reading this entire guide or visiting our FAQ page on our website **www.whistlergroup.com**

Enjoy your Whistler detector and please drive safely.

Sincerely,
The Whistler Group, Inc.

Model Features Summary	4-6
Installation	7-8
• Mounting Guidelines	
• Windshield Mounting	
• Power Connection	
• Fuse Replacement	
Operation	9-13
• Power On Self Test & Volume	
• Feature Engaged Confirmation	
• Self Test Mute	
• Setting Saver	
• Auto Quiet Mode	
• Quiet Mode	
• City/City 1/City 2 Modes	
• Highway Mode	
• FDSR/TFSR Rejection Modes	
• Alert Periscopes	
• Dim/Dark Mode	
• Engaging/Disengaging VG-2 Detection	
• Vehicle Battery Saver Mode	
Laser & Radar Alerts	14-15
• Laser Audio/Visual Alerts	
• Laser Tips	
• Pulse Protection®	
• Safety Warning System™	
VG-2 Alerts	15
POP™ Mode	16
Option Select Mode	16
Reset Features	17
Troubleshooting Guide	17-18
• Care & Maintenance	
Are Detectors Legal?	19
• FCC Information	
Speed Monitoring	20-22
• Radar Facts	
• Laser Facts	
• Other Speed Detection Systems	
Warranty Information	23-26
Specifications	27
Accessories	28

WHISTLER FEATURES

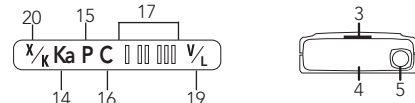
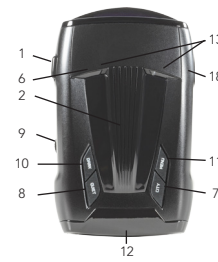

Features

- Total Band Protection™
- Icon Display
- Detects POP™ Mode
- 360° Maxx Coverage
- VG-2 Cloaking
- 3 City Modes/Highway Mode
- Quiet/Auto Quiet Mode
- Dim/Dark Mode
- High Gain Lens
- Setting Saver
- Vehicle Battery Saver™
- Safety Warning System™
- Alert Priority
- Alert Periscopes
- Total Laser Detection
- Traffic Flow Signal Rejection
- Field Disturbance Sensor Rejection

4

5

6

7

8

OPERATION

Power On Self Test & Volume

Each time your Whistler detector is turned on, an automatic self-test sequence confirms that the speaker and visual displays are functional. To increase the volume, continue turning the volume knob.

Feature Engaged Confirmation

Each time a button is pressed, one beep confirms the feature is “on”, two beeps confirm feature “off”.

Self Test Mute

Press the Quiet button during the self-test sequence to cancel the Self-Test audio. This will not affect radar/laser alerts. To restore the Self-Test audio, press the Quiet button during the next Self-Test.

Setting Saver

Setting Saver stores your personalized settings so that when the detector is turned off and then on again, you do not have to re-enter them.

9

OPERATION

Auto Quiet Mode

Pressing QUIET before a radar signal is detected provides an alternate alert pattern, consisting of several beeps (indicating X, K, Ka or Safety Warning System™) followed by reduced tone. The reduced tone will continue for as long as the detected signal is present or any new signal is detected within 20 seconds, becoming more rapid as the strength of the signal increases.

- Press Quiet (before a signal is detected) to engage Auto Quiet.
- Once the Auto Quiet mode is engaged, you may cancel the audio alarm by pressing Quiet.
- Press Quiet (when the unit is not alarming) to cancel Auto Quiet mode.

Quiet Mode

Quiet mode cancels audio during an alert and any new alert within 20 seconds. After 20 seconds of no alerts, the audio is restored for any new alerts.

- Press Quiet to cancel the audio.
- Press Quiet a second time during an alert to restore the standard audio alert pattern; or turn the unit off, then on.

10

OPERATION

City/City 1/City 2 Mode

Whistler's Three Stage City Mode is designed to reduce the annoyance of automatic door openers, intrusion alarms and other devices which share frequencies with police radar. Generally, X band is used for these devices.

- Press City button to cancel Highway Mode and engage City Mode.
- Press City button again to enter City 1 Mode
- Press City button again to enter City 2 Mode
- Press City button a fourth time to cancel City 2 Mode and return the unit to Highway Mode.

In City Mode, weak speed/safety warning system™ signals give an initial alarm of two beeps, and then remains quiet unless the signal becomes very strong. When the signal strength increases, two additional beeps are provided. City 1 and City 2 Modes operate the same as Highway Mode, but in City 1 Mode, X band requires a stronger signal to alert. In City 2 Mode, X-band is not detected.

CAUTION: Some towns/small cities may still be using X band radar. City Mode does not change the audio alert for laser or VG-2.

Highway Mode

Highway mode provides full audio warnings any time radar (X, K, Ka, Safety Warning System™) or laser signals are detected, and is recommended for open road driving.

11

FEATURE DESCRIPTIONS

- Bracket Release Button** - provides quick and easy release of the mounting bracket.
- Speaker** - provides distinct audio warnings for X, K, Ka band radar, safety warning system, laser and VG-2.
- Mounting Bracket Location** - slot holds mounting bracket firmly.
- Radar Antenna** - compact, high-efficiency antenna receives radar signals.
- Front Laser** - high gain optical lens provides increased sensitivity and field of view for leading-edge laser detection.
- Rear Laser** - an integrated optical waveguide provides superior detection of laser signals transmitted from behind.
- City Button** - reduces the annoyance of false alerts typically encountered in urban driving areas.
- Quiet Button** - pressing QUIET before a radar signal is detected engages Auto Quiet Mode which provides “reduced tone” sounds after the initial warning. Pressing QUIET during a radar encounter silences audio alerts, while allowing visual alerts to keep you informed.
- Power / Volume Control** - turns unit on/off and adjusts audio level.
- Dim / Dark Mode** - engages Dim/Dark modes.
- Menu Button** - enters option select mode.

12

FEATURE DESCRIPTIONS

- Icon Display** - offers easy-to-read display to indicate power, city mode, radar band identification, and signal strength.
- Alert Periscopes** - provide an additional attention getting visual alert.
- Ka-band Icon** - indicates the unit is receiving a Ka-band signal.
- P** - indicates unit is in Highway mode.
- C** - indicates that the unit is operating in city mode.
- Signal Strength Icon** - indicates the strength of the signal being detected.
- Power Jack** - provides connection for the power cord.
- VG-2/Laser Icon** - indicates that the unit is receiving either VG2 or laser signal.
- X/K -band Icon** - shows the unit is receiving a X or K band signal.

13

INSTALLATION

Mounting Guidelines

- Mount the unit as low as possible near the center of the windshield.
- Do not mount the unit behind wipers, ornaments, mirrored sunscreens, etc. These obstructions have metal surfaces which can affect radar and laser signals and reduce critical warning time. (Regular tinted glass does not affect reception.)
- Some windshields have an Instaclear™ or Electriclear™ type coating, which affects radar signals. Consult your dealer or the user guide to determine if your windshield has this coating.
- Avoid placing unit in direct contact with the wind shield.
- To reduce the possibility of theft, conceal the unit when not in use.

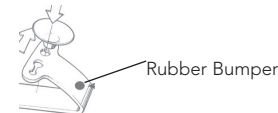

Windshield Mounting

- Install the two suction cups and rubber bumper onto the bracket by fitting them into their holes.
- Press the suction cups onto the windshield at the location you have chosen.

NOTE: Some newer cars have a plastic safety coating on the inside of the windshield. The windshield bracket may leave permanent marks on this type of surface.

14

INSTALLATION

To find out if your vehicle has this type of windshield, check the user guide or ask your dealer. We recommend that you do not leave the suction cup bracket on the windshield in direct sunlight. If the detector is removed, this may cause blistering of the dash in some vehicles.

IMPORTANT: Make sure the unit is level.

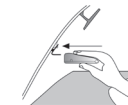

Power Connection

- Plug the small end of the power cord into the unit's power jack.
- Plug the large end into the vehicle's cigarette lighter.

Fuse Replacement

The lighter socket plug is equipped with a replaceable 2 amp, 3AG fuse located behind the silver tip. To replace the fuse, carefully unscrew the tip of the plug.

IMPORTANT: Unscrew slowly. The tip contains a spring which may fly out when disassembling. Insert the new fuse with the spring and screw on the tip. With use, the screw cap on the plug may loosen. Retighten it occasionally.



LASER/RADAR ALERTS

Safety Warning System/Audio/Visual Alerts

When your Whistler detector detects a safety warning system, it provides a distinctive audio tone and illuminates the first and last alert LED.

NOTE: You will not be able to receive SWST™ alerts if transmitters are not located in your area.

VG-2 ALERTS

VG-2 Detection Mode

The VG-2, also known as a “radar detector detector,” is a special receiver used by police to detect signals radiated by a radar detector. See speed monitoring section for more information on VG-2.

When the VG-2 signal is detected, the VG-2 alert is sounded. After 3 seconds, the audio is cancelled and the VG-2 indicator flashes at a slower rate. Every 30 seconds, the detector checks for a VG-2 signal. This cycle is repeated if the VG-2 signal is detected again. If no signal is detected, two beeps are provided indicating an “all clear” condition.

During the period a VG-2 signal is detected, a radar signal cannot be detected. However, because the VG-2 alert has confirmed that a patrol car is nearby, you are already aware of the potential for speed monitoring and can adjust your speed accordingly. Laser detection is not affected while a VG-2 signal is detected.

15

POP™ MODE ALERTS

POP™ Mode Alerts

Because POP™ Mode radar utilizes the same K or Ka band frequencies, POP™ Mode Alerts will be displayed as regular radar alerts.

OPTION SELECT MODE

Option Select Mode

Press the Menu button to enter Option Select Mode. Each press of the Menu button changes to the next selectable feature. The Dark (D) button and the Quiet (Q) button turns the feature ON/OFF or Blinking for example. Model 4500ES will illuminate the “III” icon. When the feature is off these indicators will not be shown. A button must be pressed within 20 seconds or Option Select Mode will automatically be exited.

Feature	Display Shows	To Change D=Dark / Q=Quiet	Option
VG-2	V/L	D = ON Q = OFF	VG-2 = ON VG-2 = OFF (default)
ALERT PERI-SCOPES	III	D or Q to Select	Alert Periscopes ON, OFF or Blinking (default)
POP™	P	D = ON Q = OFF	POP™ = ON POP™ = OFF (default)
NOTE: TFSR, FDSR and SWS are ON by default (not selectable on the 4500ES)			

NOTE: To exit Option Select Mode press and hold the menu button.

16

WARRANTY INFORMATION

Consumer Warranty

This Whistler Laser/Radar detector is warranted to the original purchaser for a period of one year from the date of original purchase against all defects in materials and workmanship. **This limited warranty is void if the unit is abused, modified, installed improperly, if the housing has been removed, or if the serial number is missing.** There are no express warranties covering this product other than those set forth in this warranty. All express or implied warranties for this product are limited to the above time. Whistler is not liable for damages arising from the use, misuse, or operation of this product.

NOTE: Units that cannot be repaired will be replaced with the same or similar model. Replacement unit's warranty will be based on the original unit's purchase date.

Service Under Warranty

During the warranty period, defective units will be repaired without charge to the purchaser when returned with a dated store receipt to the address below. Units returned without a dated store receipt will be handled as described in section **“Service Out-Of-Warranty.”**

Due to the specialized equipment necessary for testing a Laser-Radar receiver, there are no authorized service stations for Whistler brand detectors other than Whistler.

23

RESET FEATURES

All user features can be reset to factory settings.

Factory Reset

1. Unplug Power Cord from unit
2. Press and hold Quiet
3. Plug the Power Cord into the unit (Power switch turned on)
4. Wait for 2 beeps
5. Release the Quiet button

Unit is now reset.

Factory Settings are:

- Highway Mode
- Dim/Dark Mode to full illumination of display
- Auto Quiet Mode OFF
- VG-2 Detection Mode OFF
- Self Test Mute OFF
- Alert Periscope to Blink
- POP™ Mode OFF

TROUBLESHOOTING GUIDE

Your Whistler detector is expertly engineered and designed to exacting quality standards to provide you with reliable, trouble-free operation. If your unit has been correctly installed following the guidelines in this guide, but is not operating optimally, please refer to the troubleshooting guide below.

17

WARRANTY INFORMATION

When returning a unit for service, please follow these instructions:

1. Ship the unit in the original carton or in a suitable sturdy equivalent, fully insured, with return receipt requested to:

Whistler Repair Dept.
1412 South 1st St.
Rogers, AR. 72756

Please allow 3 weeks turnaround time.

IMPORTANT: Whistler will not assume responsibility for loss or damage incurred in shipping. Therefore, please ship your unit insured with return receipt requested. **CODs will not be accepted!**

2. Include with your unit the following information, clearly printed:

- Your name and street address (for shipping via UPS), a daytime telephone number and an email address, if applicable.
- A detailed description of the problem (e.g., “Unit performs self-test but does not respond to radar”).
- A copy of your dated store receipt or bill of sale.

3. Be certain your unit is returned with its serial number. For reference, please write your unit's serial number in the space provided on the Accessory page of this guide.

24

TROUBLESHOOTING

PROBLEM: Unit does not turn on - check fuse in plug; replace if necessary with a 2 amp, 3AG type. Make sure lighter socket is clean. No or low audio - cancel Auto Quiet Mode or City Mode. Check the audio level setting.

PROBLEM: Unit alarms when vehicle hits bumps. Check for loose lighter socket; tighten and clean. Check connections at both ends of power cord. Substitute another cord to determine if the cord is defective. Return the defective cord to the factory.

If difficulties occur which cannot be solved by information in this Troubleshooting Guide, please call Whistler Customer Service at **1-800-531-0004** or visit our FAQ page at **www.whistlergroup.com** before returning your unit for service.

Care & Maintenance

During the summer months, avoid prolonged exposure to direct sunlight by removing your unit from the dash when your vehicle is parked for an extended period of time. Do not spray water, cleaners, or polishes directly onto the unit. The spray may penetrate through the openings and damage the unit. Also, do not use any abrasive cleaners on the unit's exterior.

18

WARRANTY INFORMATION

Units without serial numbers are not covered under warranty.

IMPORTANT: To validate that your unit is within the warranty period, make sure you keep a copy of your dated store receipt. You may register your warranty online at www.whistlergroup.com, however, for warranty verification purposes, a copy of your dated store receipt must accompany any unit sent in for warranty work.

Service Out-of-Warranty

Units will be repaired at “out-of-warranty” service rates when:

- The unit's original warranty has expired.
- A dated store receipt is not supplied.
- The unit has been returned without its serial number.
- The unit has been abused, modified, installed improperly, or had its housing removed.

The minimum out-of-warranty service fee for your Whistler 4500ES detector is \$35.00 (U.S.). If you require out-of-warranty service, please return your unit as outlined in the section “Service Under Warranty” along with a certified check or money order in the amount stated above. Payment may also be made by MasterCard, VISA or American Express; **personal checks are not accepted.**

ARE DETECTORS LEGAL?

In Most States YES!

Laser-Radar detectors are legal in every state for automobiles and light trucks (under 10,000 lbs.) except Virginia and Washington, D.C., which have local regulations restricting the use of radar receivers in any vehicle.

The Federal Highway Administration (FHWA) passed a nationwide regulation, effective January 1994, which prohibited radar and laser detector use in vehicles over 10,000 lbs.

FCC Information

FCC ID: H5XWH23

This device complies with part 15 of the FCC Rules. Operation is subject to the following two conditions:

- (1) this device may not cause harmful interference.
- (2) this device must accept any interference received, including interference that may cause undesired operation.

IMPORTANT: FCC requirements state that changes or modifications not expressly approved by Whistler could void the user's authority to operate the equipment.

19

WARRANTY INFORMATION

In the event repairs cannot be covered by the minimum service fee, you will be contacted by a Whistler technical service specialist who will outline options available to you.

If you elect not to have your unit repaired, it will be returned to you along with your certified check or money order.

IMPORTANT: When returning your unit for service, be certain to include a daytime telephone number and an email address (if applicable).

Customer Service

If you have questions concerning the operation of your Whistler detector, or require service during or after the warranty period, please call Customer Service at:

1-800-531-0004

Representatives are available to answer your questions

Monday - Friday from 8:00 a.m. to 5:00 p.m. (CT).

www.whistlergroup.com

26

SPEED MONITORING

Radar Facts

A radar gun operates by transmitting radio waves at certain frequencies which reflect off objects and are then picked up by the radar gun's receiving section. When a radar beam reflects off a moving target, a measurable frequency shift occurs. The radar unit converts this shift into miles per hour to determine your vehicle's speed. Currently, the FCC (Federal Communications Commission) permits operation of traffic radar guns at X Band (10.500 - 10.550 GHz), K Band (24.050 - 24.250 GHz), and Ka Band (33.400 - 36.000 GHz).

NOTE: A radar detector will only alarm if an officer is transmitting on any one of the above radar bands.

Laser Facts

It's well documented that many radar guns cannot reliably provide the speed of a targeted vehicle that is traveling in a group of vehicles. In contrast, a laser gun can target a specific vehicle out of a line of traffic and determine its speed. The advantage of laser over radar in terms of target identification is the result of the laser gun's narrow beam.

A radar transmission can cover more than a four-lane highway at a distance of 1,000 feet, compared with a laser transmission which covers about 3 feet at the same distance. For best protection, keep these points, listed on the following section, in mind:

20

SPECIFICATIONS

Laser Wavelength:

905 ± 50 nanometers (nm)

Radar Frequencies:

10.500 - 10.550 GHz (X Band)

24.050 - 24.250 GHz (K Band)

33.400 - 36.000 GHz (Ka Superwideband)

Operating Temperature Range:

-10° C to +70° C (+14° F to +158° F)

Power Requirements:

Operational 12 to 15 volts DC, 250mA nominal

Vehicle Battery Saver, 30mA nominal.

Patents can be viewed here:

www.whistlergroup.com/pat

POP™ Mode is a trademark of MPH Industries, Inc.

SWS™ is a trademark of Safety Warning System L.C.

Specifications are subject to change without notice.



27

SPEED MONITORING

- Because the vehicle's license plate or headlights are the laser gun's primary targets, mounting the Whistler detector on the dashboard can improve laser detection at short range.
- Do not follow closely behind any vehicle. If you can't see past a vehicle ahead of you, chances are your detector won't either.
- The receiving range of laser signals will not be the same as radar signals. Laser guns are most often used at short range.
- Whistler Laser-Radar detectors receive all current laser guns which operate at a laser wavelength of 905 ± 50 nm including but not limited to the following:

- Ultra Lyte
- LTI 20 - 20
- LTI TruSpeed® S
- Pro Laser™ I II III
- Laser Ally
- Laser Atlanta® Stealth Mode

Other Speed Detection Systems

Several techniques other than radar or laser are used to measure vehicle speeds. When these methods are being used, no detector can provide a warning. These techniques include:

- **Pacing** - A patrol car drives behind you and matches your driving speed.
- **Vascar/Aircraft** - The time it takes a vehicle to travel a known distance is measured.

21

ACCESSORIES

These and other accessories can be ordered directly from Whistler by calling **1-800-531-0004** or visiting our online store at www.whistlergroup.com.

Order #	Description	Price
202151	Windshield Bracket Kit	\$9.95
206552	Power Cord (5')	\$14.95
206880	Hardwire Kit (10') (for wiring to fuse box)	\$9.95
206666	Modular* Cord Package (includes coiled an straight cords, and power adapter)	\$17.95
159032	Package of 8 suction Cups	\$2.95
402080	Non Skid Dash Pad	\$6.95

***Modular: Interconnecting pieces cord and plug. Shipping and handling (per order) \$5.00. Prices are subject to change without notice.**

write serial number in the space provided

28

SPEED MONITORING

Radar Detector Detectors (VG-2) Spectre The Interceptor VG-2, or simply VG-2, is a microwave receiver used by police to detect signals radiated by the local oscillator of a radar detector.

Because its purpose is to identify persons driving with radar detectors, the VG-2 is known as a “radar detector detector”. The VG-2 is a tool used by the police to identify radar detector equipped vehicles. If caught, in a state where detectors are illegal drivers risk losing their radar detector and receiving a fine. In addition, instant-on radar is almost always used in combination with a VG-2, leaving unsuspecting motorists vulnerable to receiving two tickets—one potentially for speeding, the other for possession of a detector. Having a radar detector capable of detecting the VG-2 may alert you to the presence of a speed trap.

For more information on speed monitoring technologies, please visit our FAQ page on our website: www.whistlergroup.com

It is the responsibility of the individual radar detector operator to know and understand the laws in your area regarding the legality of the use of radar detectors.

NOTE: The newest tool Police have to detect radar detectors is called Spectre. Spectre can detect the majority of undetectable (VG-2) laser/radar detectors on the market.

22

USER GUIDE

4500ES HIGH PERFORMANCE LASER-RADAR DETECTOR

The Whistler Group Corporate Headquarters

1716 Commerce Dr. Ste. 8
Bentonville, AR 72712
Tel 479.273.6012 • Fax 479.273.2927

Whistler Customer Return Center

1412 South 1st St. • Rogers, AR 72756
Customer Service Tel 800.531.0004

www.whistlergroup.com

P/N 260057 03D17

© 2017 The Whistler Group, Inc.



WHISTLER