

TIGERGRIP | DS-Grab 1 - 4.5

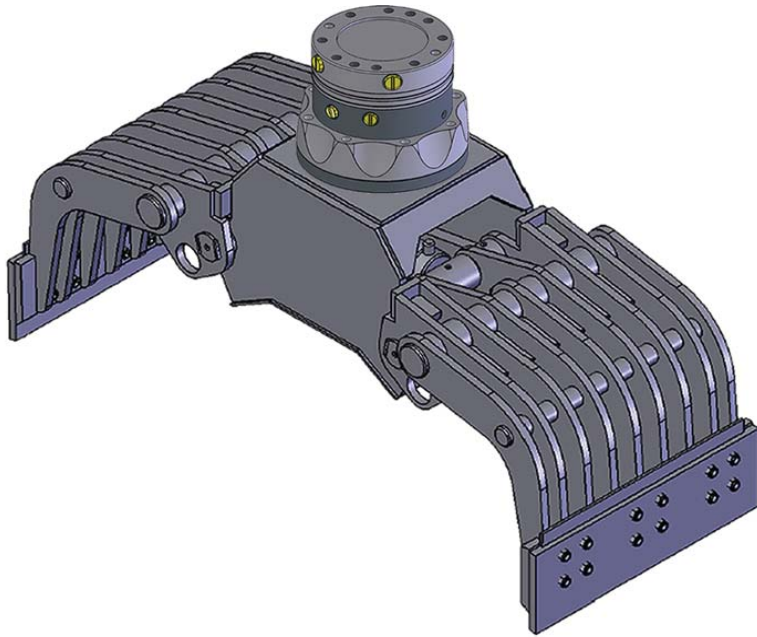

KEY FEATURES

- Heavy duty
- Double guide bars
- High pressure cylinder with double piston rod seals
- High tensile wear resistant steel (400 HB)
- Extra reinforced body for rigid mounting - Excavator design
- Self lubricating bushings (not DS-Grab 1 and 1,5)
- Reversible cutting edges
- High tensile wear resistant steel cutting edges (500 HB)
- Pilot operated check valve

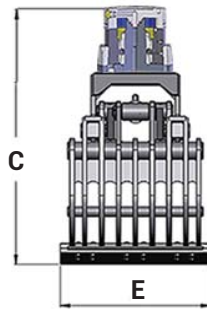
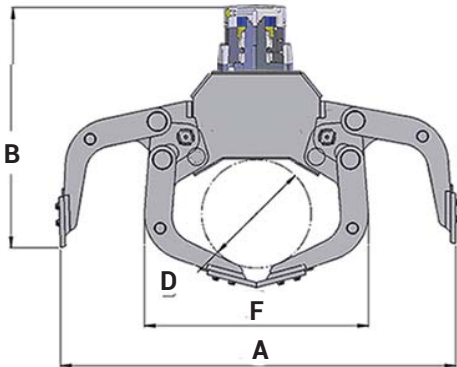

	DS-Grab 1	DS-Grab 1.5	DS-Grab 2	DS-Grab 3.5	DS-Grab 4.5
A	1154	1430	1556	1556	1936
B	712	809	970	966	1173
C	838	922	1130	1126	1375
D	315	370	430	430	530
E	390	476	532	680	800
F	650	847	882	882	1085

MODEL SPECIFICATIONS



Model	Kg	m²	Bar	l/min	kN	ton
DS-Grab 1	250	0.14	250	30/20	17.5	3-6
DS Grab 1.5	418	0.18	250	40/25	18.5	5-8
DS-Grab 2	583	0.20	320	50/25	33	7-11
DS-Grab 3.5	785	0.20	320	50/25	33	8-13
DS-Grab 4.5	1001	0.35	320	60/25	57	12-18

INTERMERCATO

High performance lift and load attachments for Forestry, Transport, Construction and Recycling.

