

GRX

5-FINGER GRAB

Bent body in *Strenx® 700*
high strength
structural steel

Claws in *Hardox® 450*
wear-resistant steel

Check valve and
accumulator optional on
GRX20-5 & 25-5



Universal hole pattern for
Angled excavator attachment | RMR compact rotator | WDR worm drive

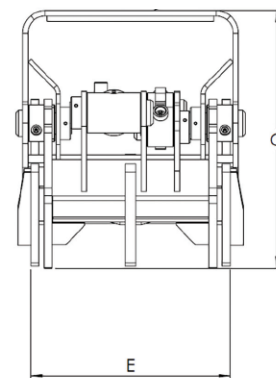
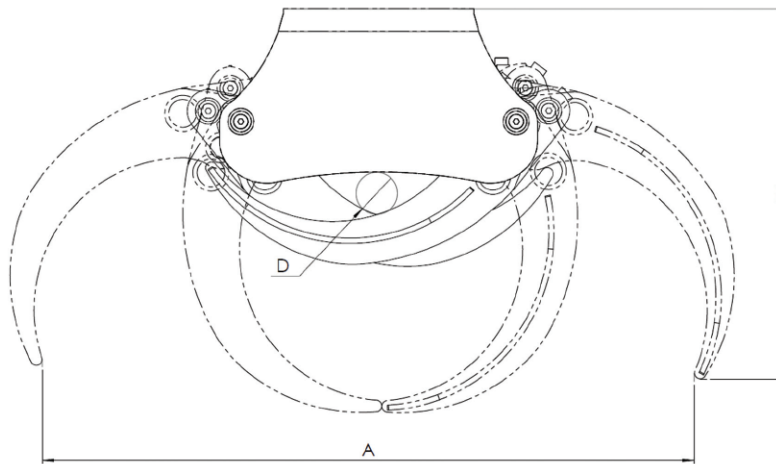

MODEL SPECIFICATION



MODEL	Kg	m ²	Bar	l/min	kN	ton
GRX 15-5	95	0,14	200	20	7,2	3-6
GRX 20-5	170	0,19	250	30	11,3	5-9
GRX 25-5	248	0,24	250	40	14,9	8-13

	GRX 15-5	GRX 20-5	GRX 25-5
A	940	1234	1385
B	578	688	790
C	394	485	533
D	63	78	85
E	316	377	419