

DOC 101

For tractors 20-50 hp

REAR HEDGE MOWERS

DOC 101 3.0

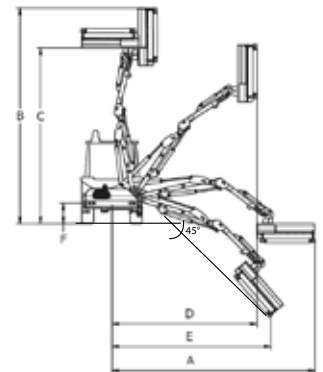

DOC 101	3.0
A (mm)	3.000
B (mm)	3.200
C (mm)	2.100
D (mm)	2.000
E (mm)	1.200
F (mm)	550

Hydraulic hedge mower with side shift and mechanical release safety device for tractors HP 20/50 and weight 1000/2500 kg, with smaller size in phase of closing and with the possibility of several solutions of attachment: rear right, rear left, front right, front left.

ARM MOWER

TRACTOR

Model	Extension E (mm)	Weight (kg)	Oil tank (L)	Head (model)	Pump (l/min)	Hydraulic Motor (HP [kW])	Power (HP [kW])	3-point linkage	Weight (kg)	Width (m)	PTO (giri/min) (rpm)
DOC 101 3.0	3.000	400	60	T3	40+15	20 (15)	20 / 30 (15 / 22)	Cat. I	1.000	1,00	540



RELEASE SAFETY DEVICE



TECHNICAL FEATURES AND STANDARD EQUIPMENT

- Frame - 1st arm - 2nd arm in structural steel ST 52
- Three points attachment 1nd category
- Oil tank 60 l
- Double gear pump group 2+2 - 40+15 l/min
- Bidirectional hydraulic motor HP 20 power
- Distributor with remote controls with mm 3000 flexible cables
- Self-levelling floating system
- Feeler roller recordable on 3 positions
- Head rotating angle 200°
- Helicoidal rotor with jointed cut blade KC1
- Number revs to rotor 3000 rpm
- Fixing tie-rods
- Rear underrun protection with lights
- Flail head mm 900 MODEL T3 90 with direct transmission



KC1
Ø max 3 cm

standard equipment

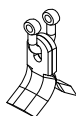

HF2 Ø
max 5 cm



HC1 Ø max 4 cm



ACCESSORIES ON REQUEST

Heat exchanger

On-off electro-hydraulic distributor with joystick

Flail head mm 700 T3 70

Tie rods adapter Cat. 1 o 2

TERMINAL TOOLS - IN REPLACEMENT OF THE STANDARD MULCHER

HEDGE CUTTING BAR

BF15



pag. 26