

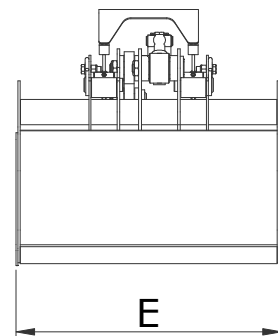

Hydraulic Equipment Industries

# MBO

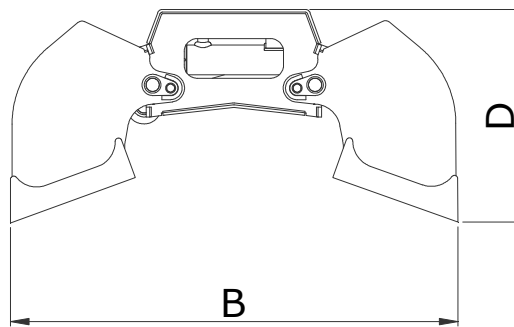
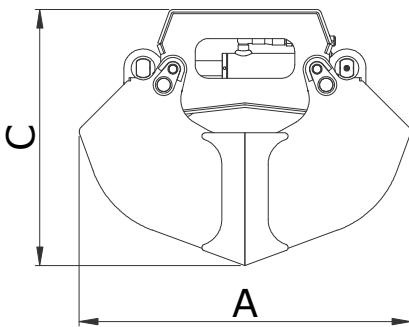

MODELLO MODEL MODÈLE MODELL	CAPACITA' CAPACITY CAPACITÉ INHALT	PRESSIONE PRESSURE PRESSION DRUCK	PESO WEIGHT POIDS GEWICHT	DENTI TEETH DENTS ZÄHNE	CILINDRI CYLINDERS CYLINDRES ZYLINDER	FORZA FORCE FORCE KRAFT	DIMENSIONI (mm) SIZES (mm) DIMENSIONS (mm) ABMESSUNGEN (mm)					MACCHINA MACHINE MACHINE MASCHINE
	LT	MAX-BAR	KG	n°	n°	t	A	B	C	D	E	MAX- TON
MBO 11	110	280	190	3	1	1.6	1000	1350	780	640	380	4-7
MBO 20	200	280	230	5	1	1.6	1000	1350	780	640	670	4-7
MBO 25	250	280	250	5	1	1.6	1000	1350	780	640	830	6-10
MBO 30	300	280	300	5	1	1.2	1200	1500	860	670	800	6-10
MBO 40	400	280	340	7	1	1.2	1200	1500	860	670	1050	6-10
MBO 50	500	280	380	7	1	1.2	1200	1500	860	670	1300	6-10



Call for advice on: 0844 770 7969 e-mail us: [sales@approvedhydraulics.co.uk](mailto:sales@approvedhydraulics.co.uk)