

EST.  
1877

# Horizon Go

*Silver Cross*<sup>®</sup>

THE BEST START IN LIFE

1.1

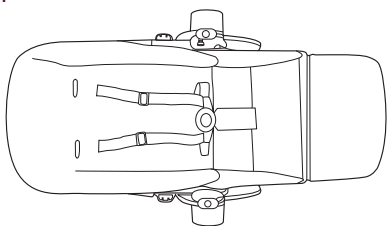

1.2

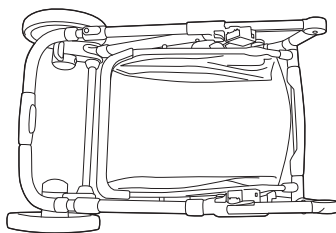

1.3

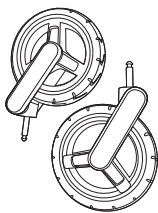

1.4



1.5

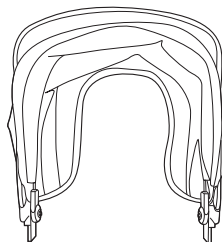

1.6

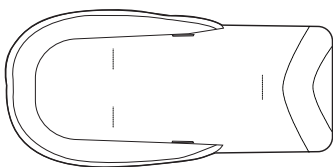

1.7

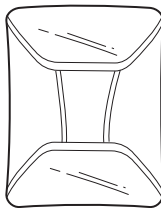

1.8

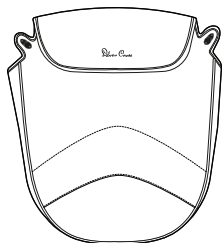

1.9

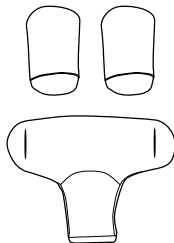

2.1

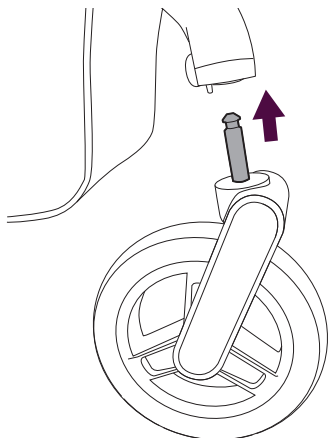

x2

2.2

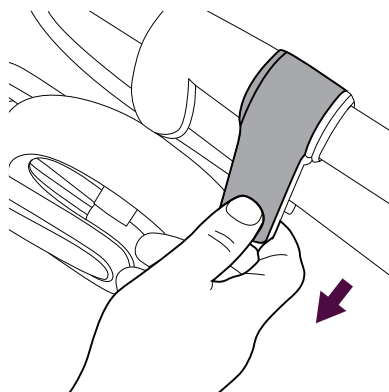

2.3

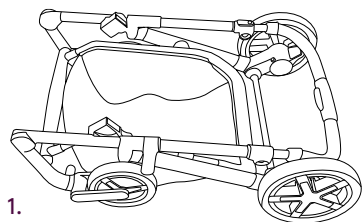

1.

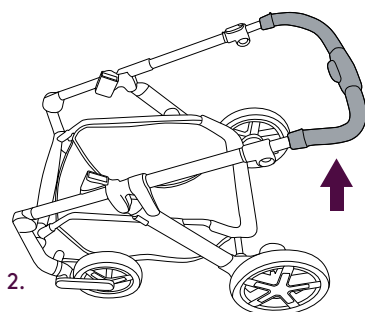

2.

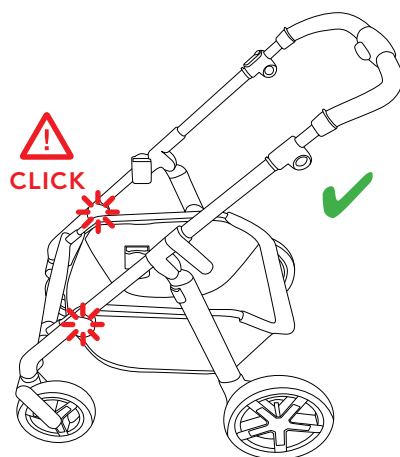

3.

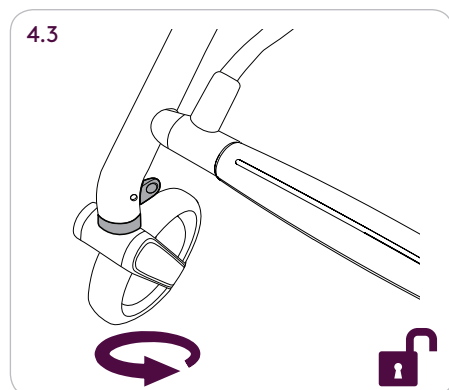
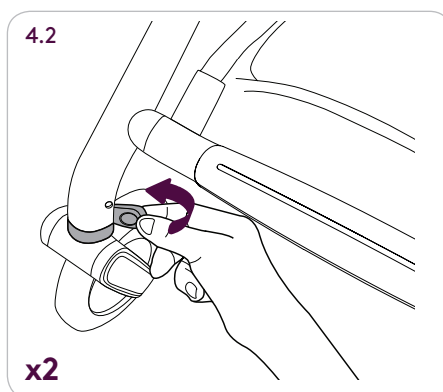
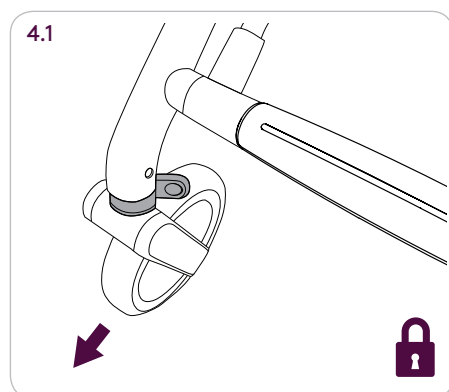
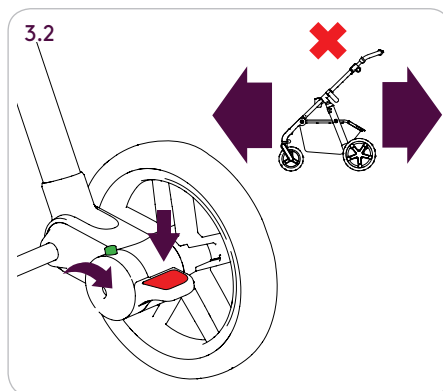
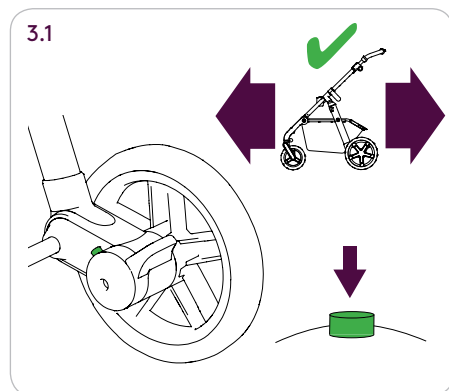

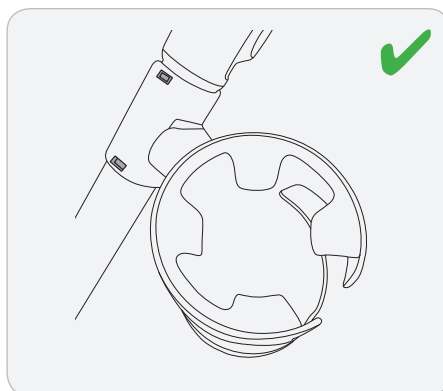
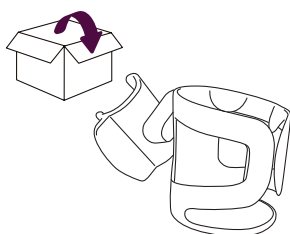
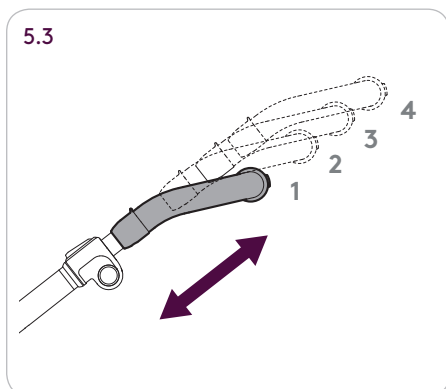
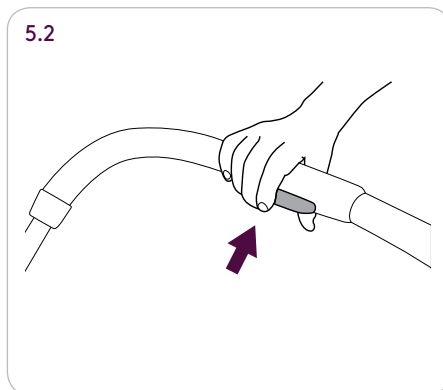
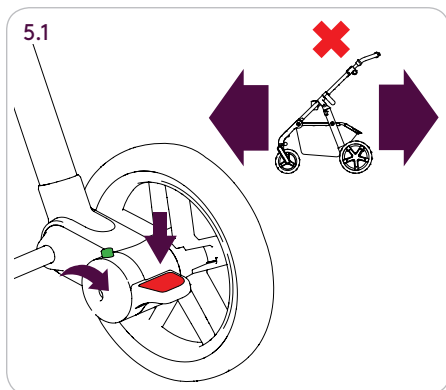

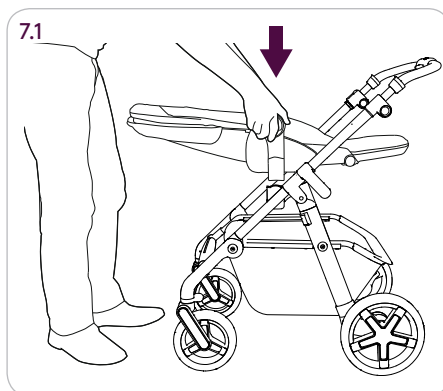
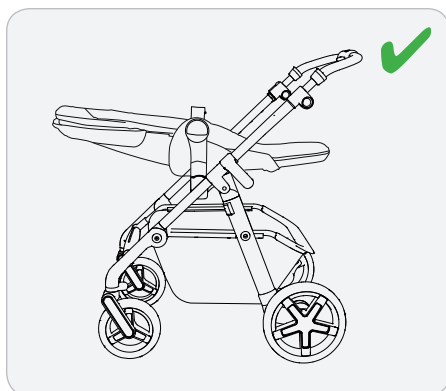
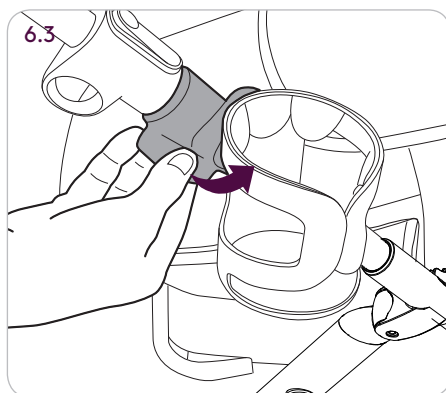
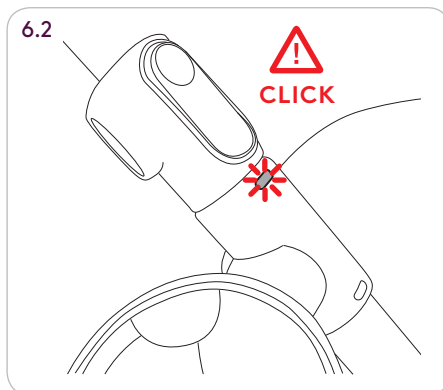
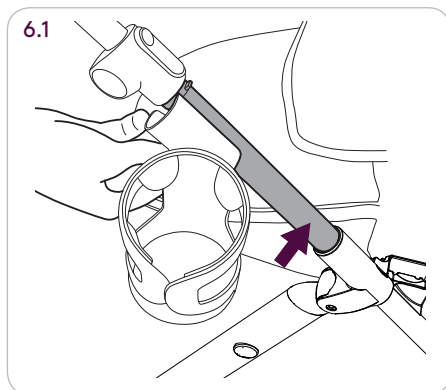

7.2

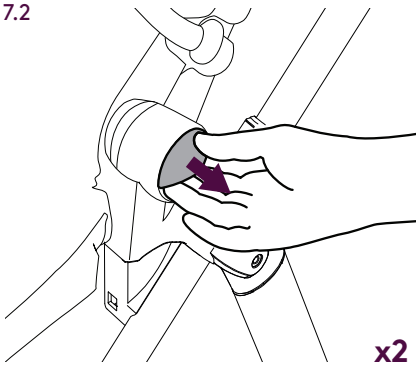

7.3

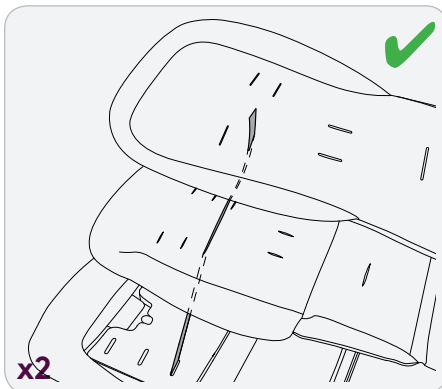
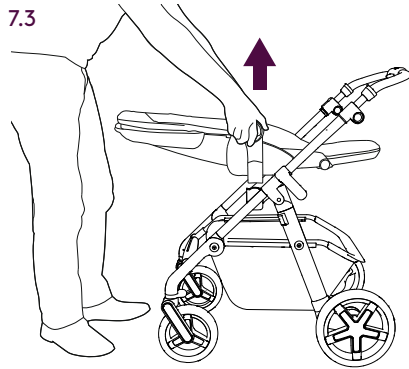

8.1

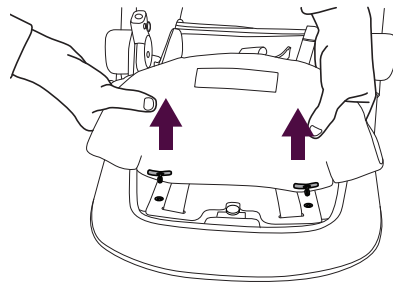

8.2

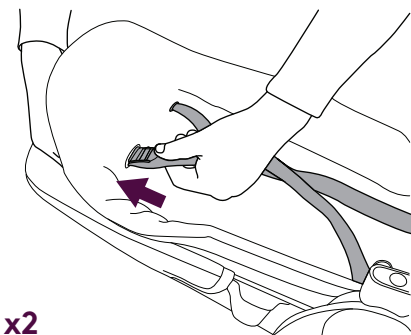

8.3

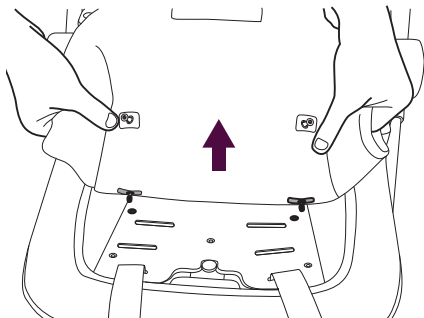

8.4

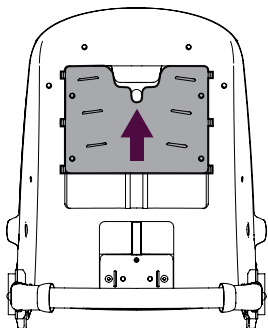

8.5

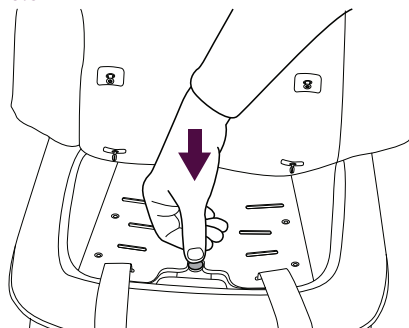

8.6

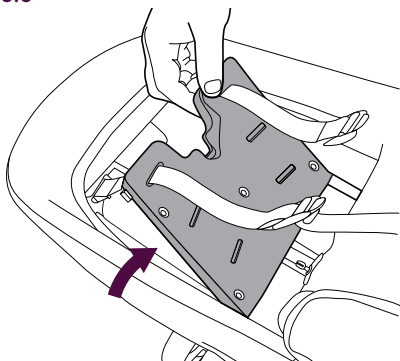

8.7

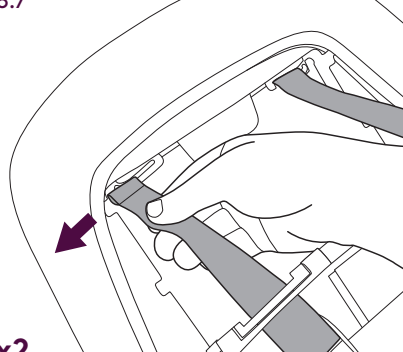

x2

8.8

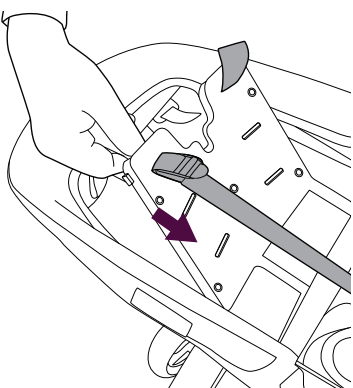

x2

8.9

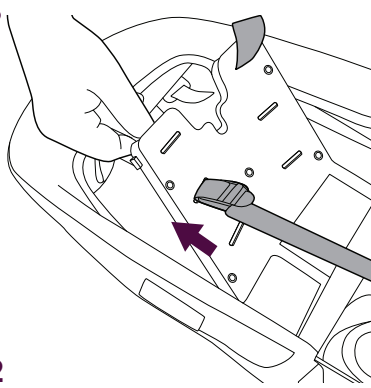

x2

8.10

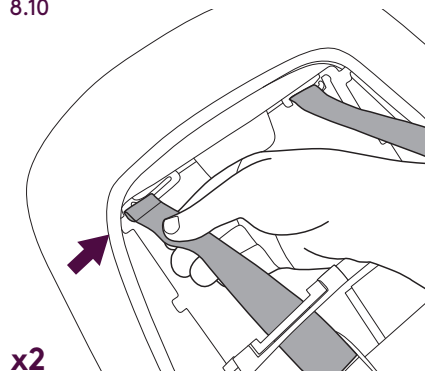

8.11

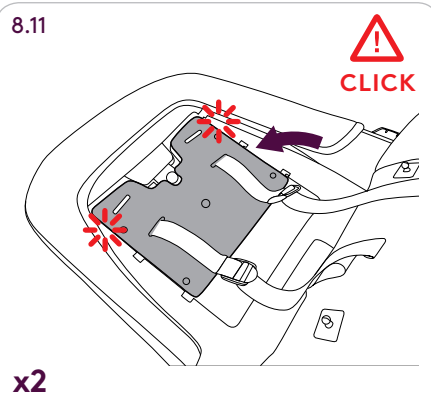

8.12

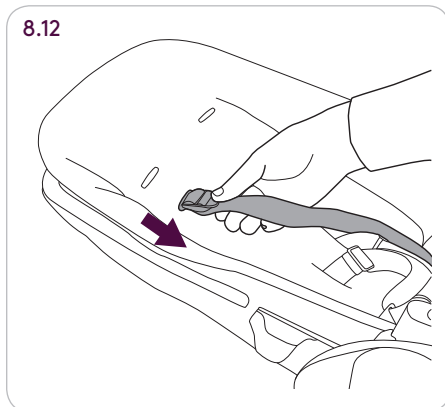

8.13

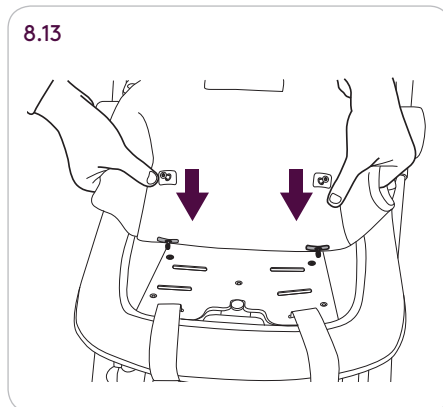

8.14

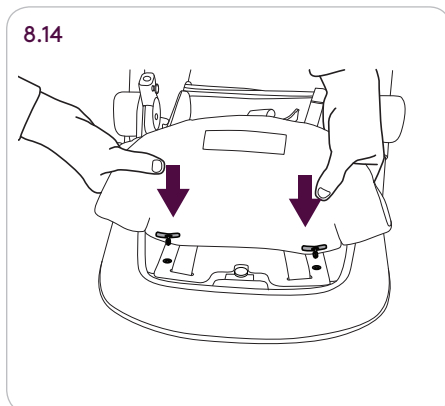

9.1

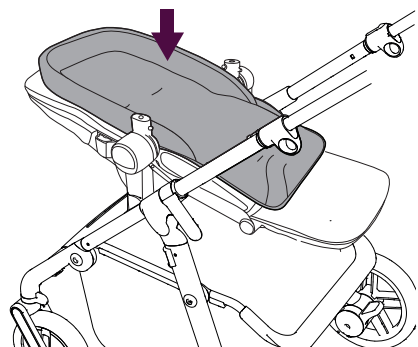

9.2

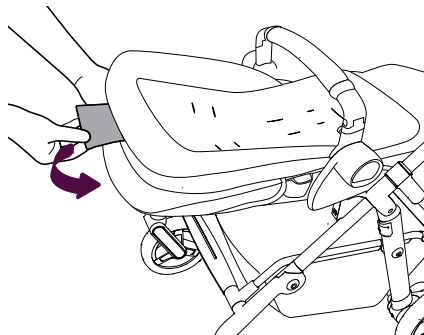

9.3

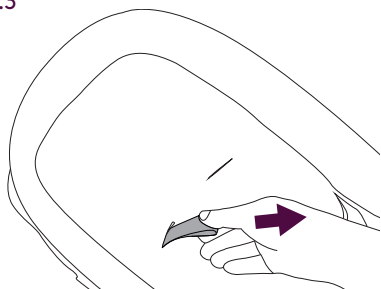

x2

9.4

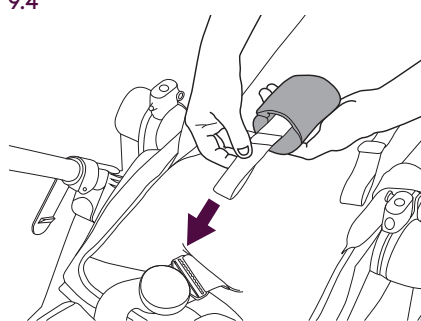

x2

9.5

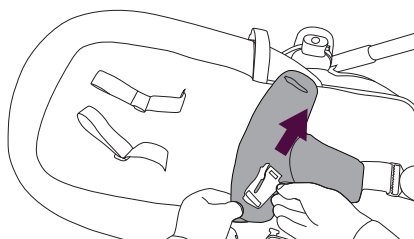

x2

9.6

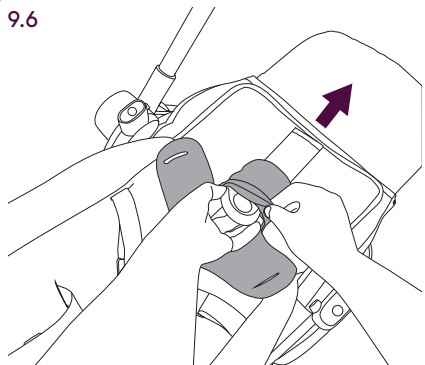

10.1

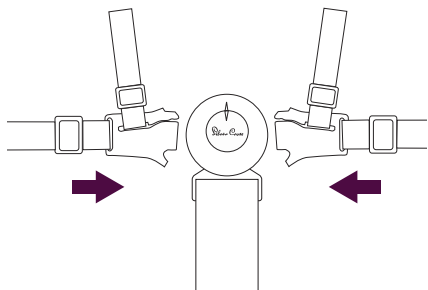

10.2

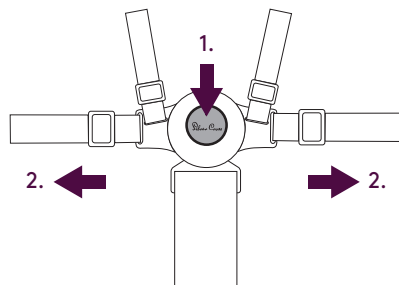

10.3

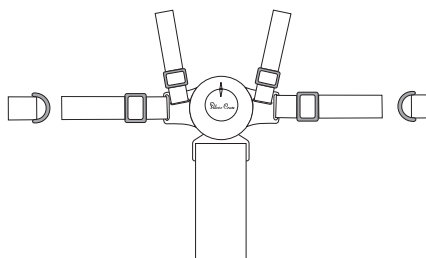

10.4

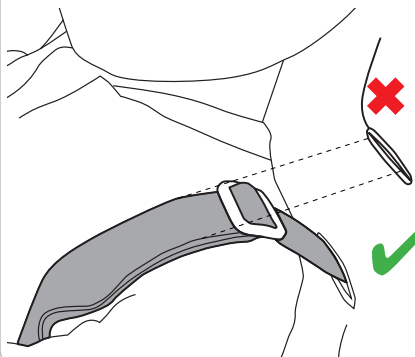

10.5

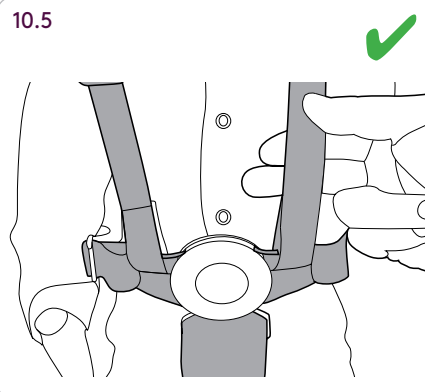

10.6

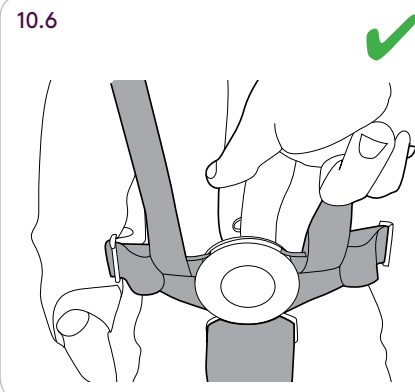

10.7

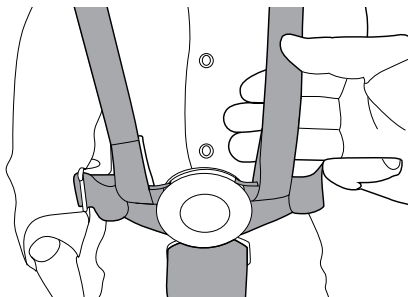

10.8

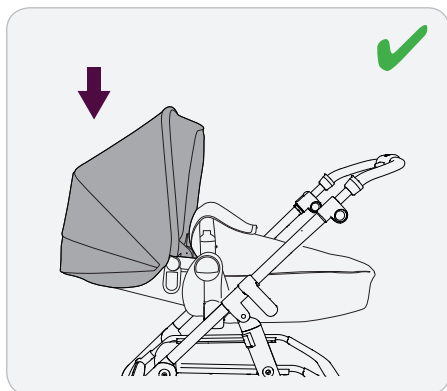
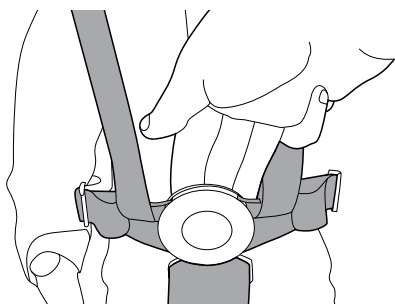

11.1

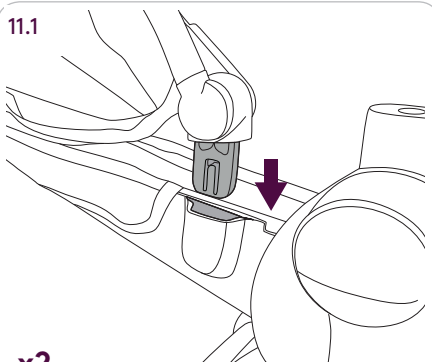

11.2

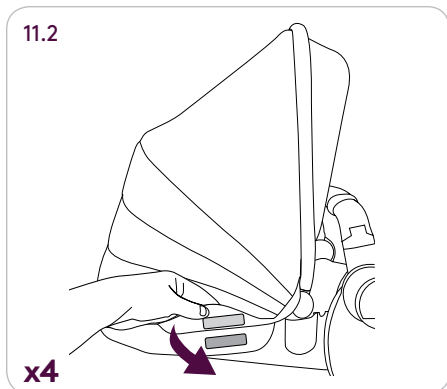

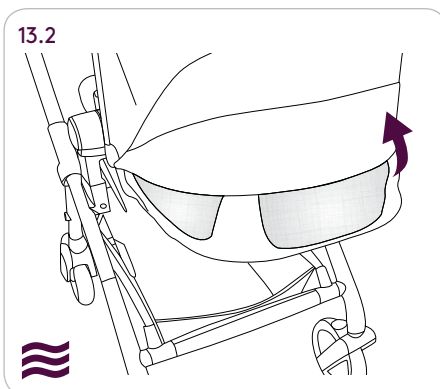
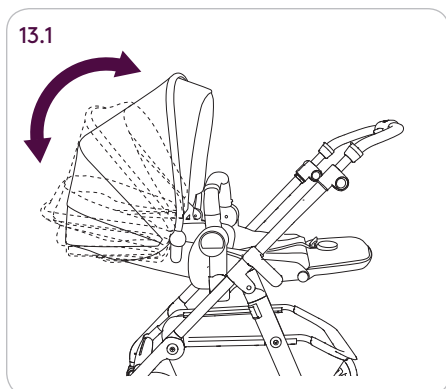
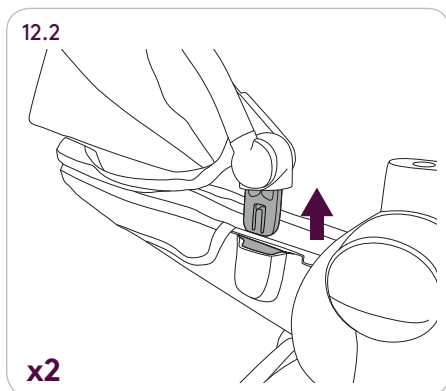
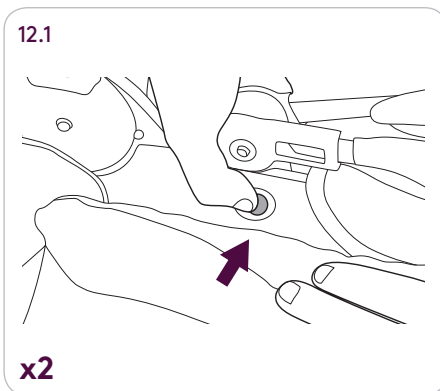
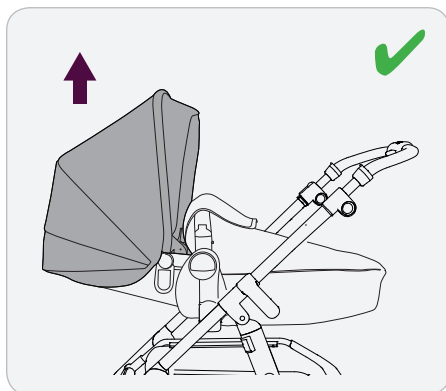

13.3

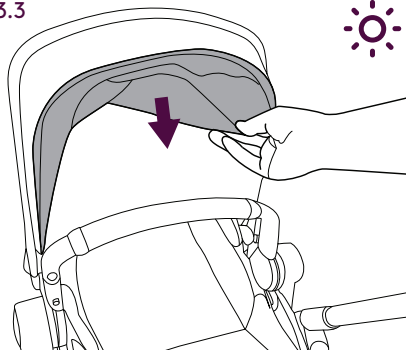

14.1

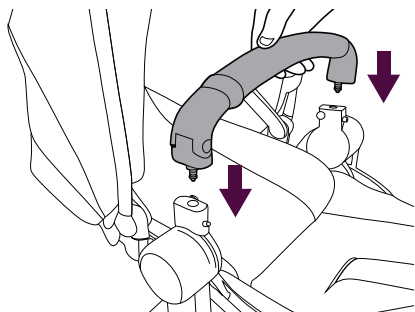

14.2

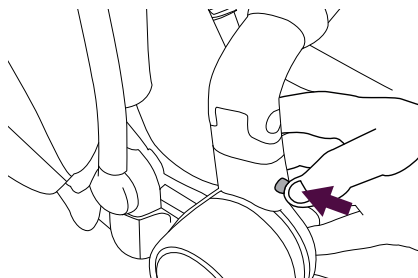

14.3

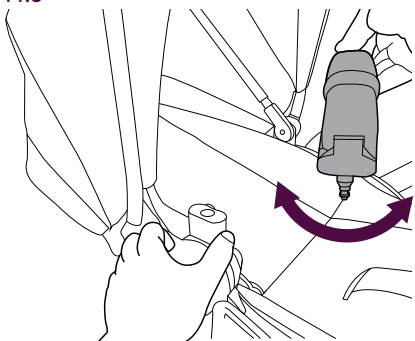

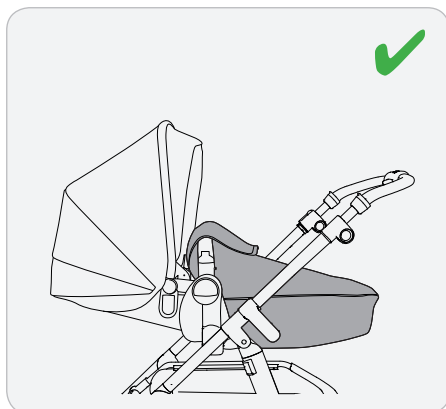

15.1

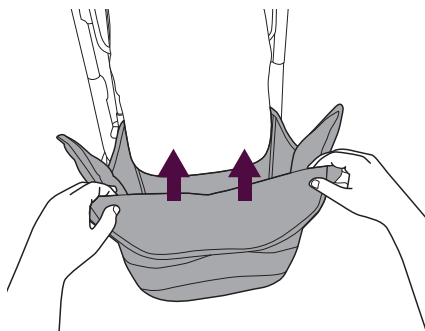

15.2

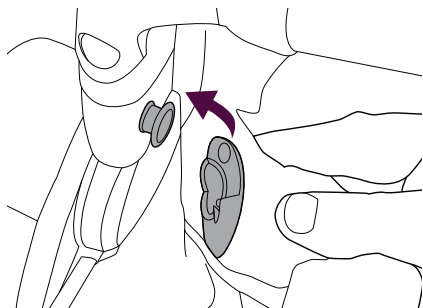

x2

15.3

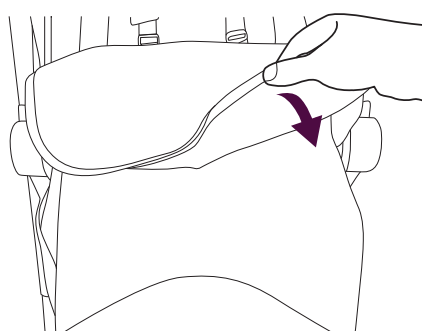

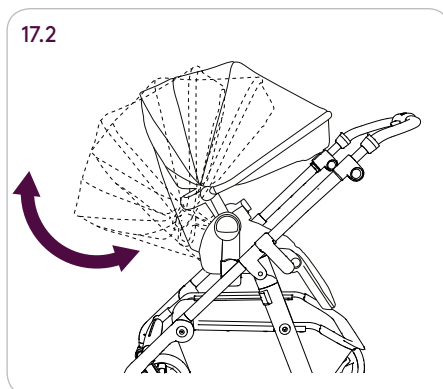
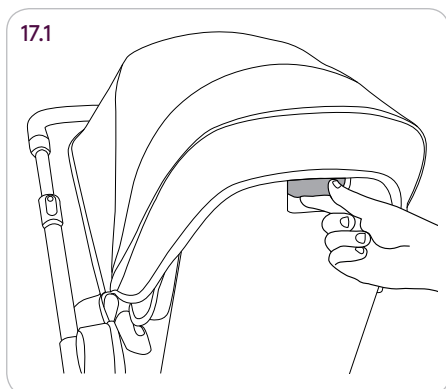
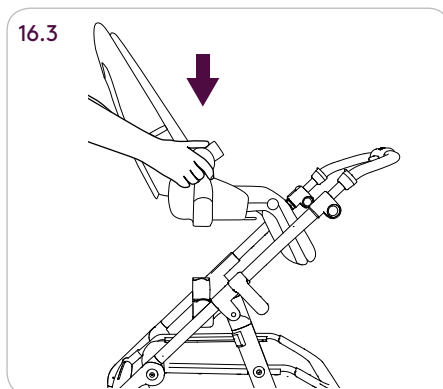
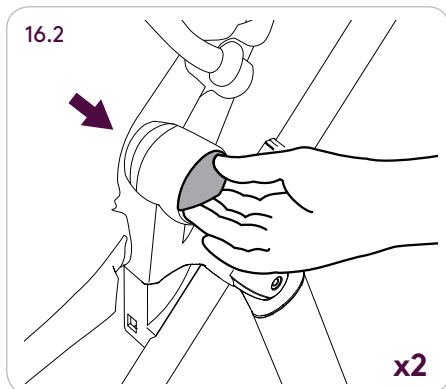
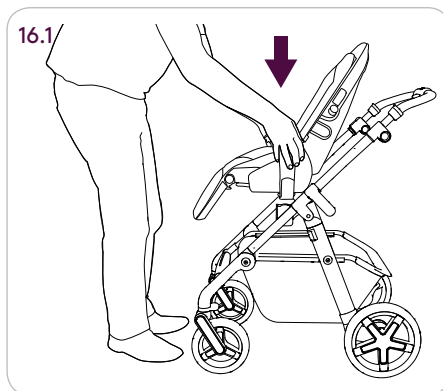
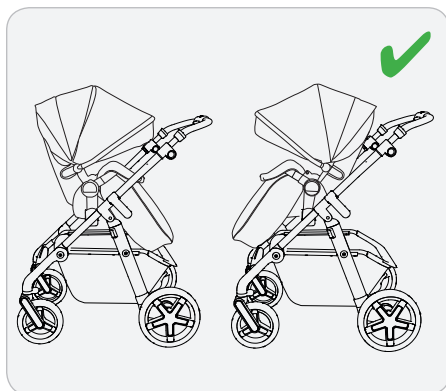

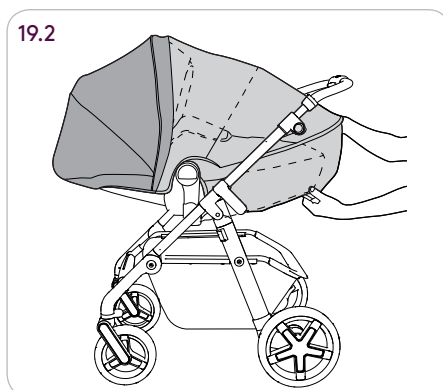
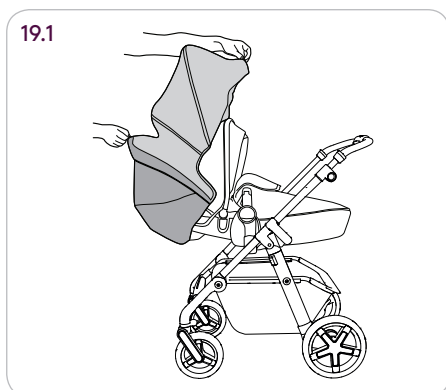
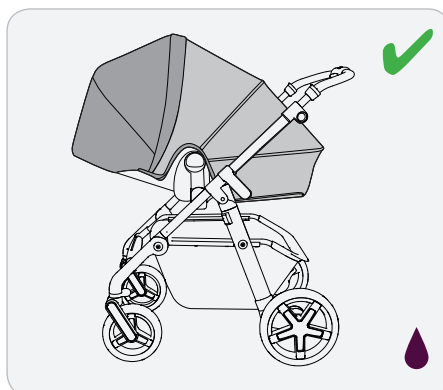
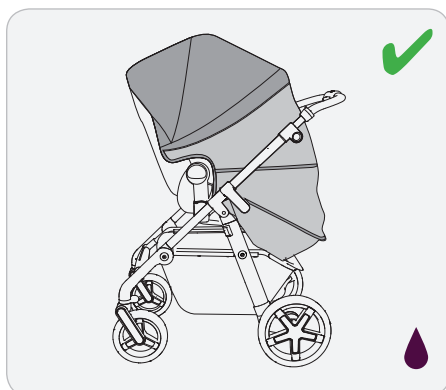
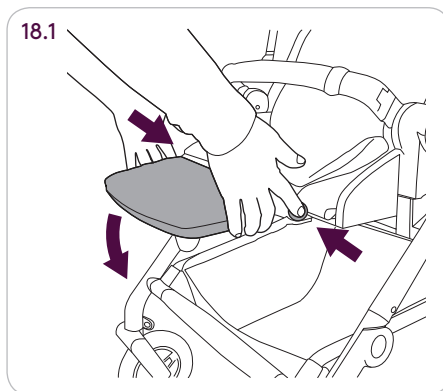
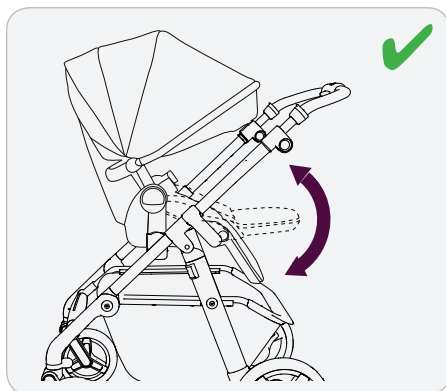

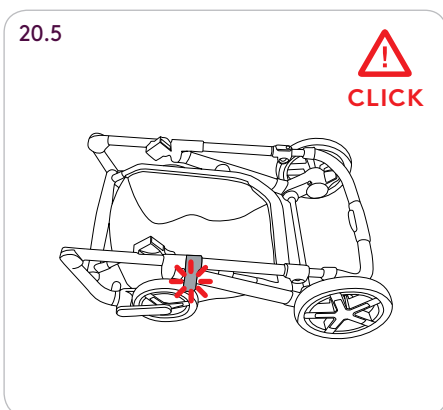
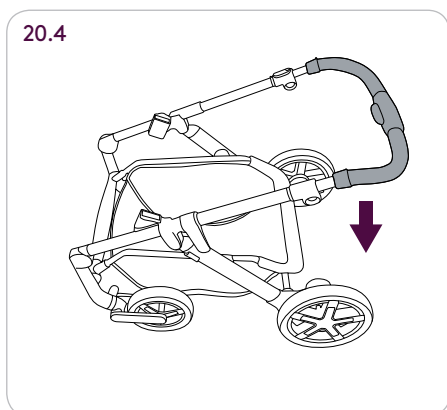
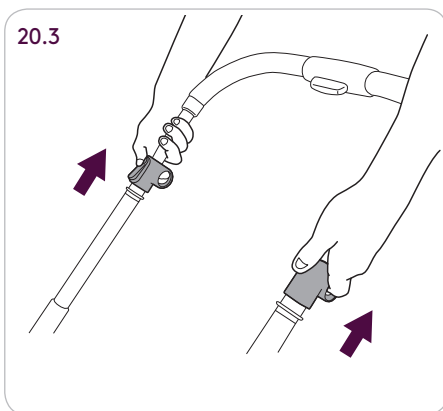
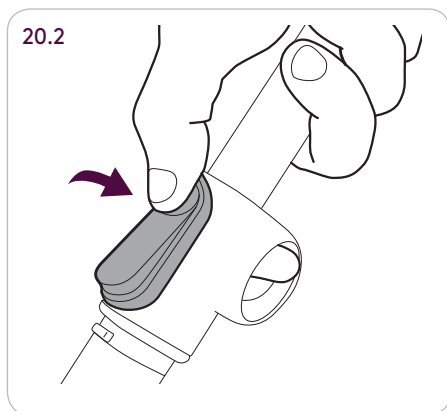
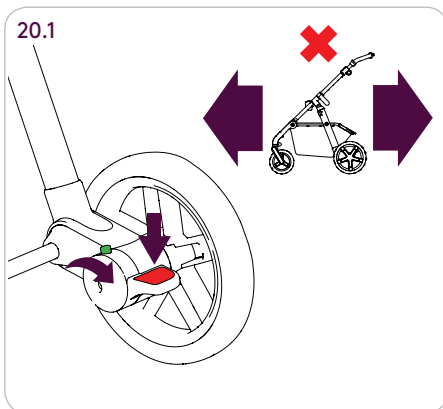
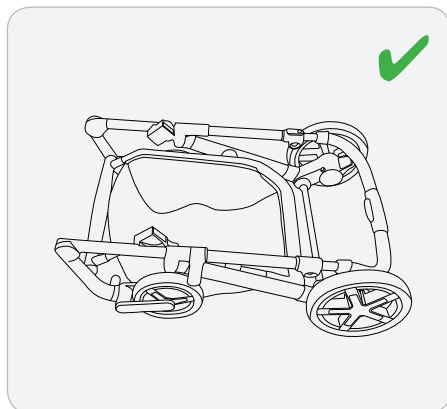

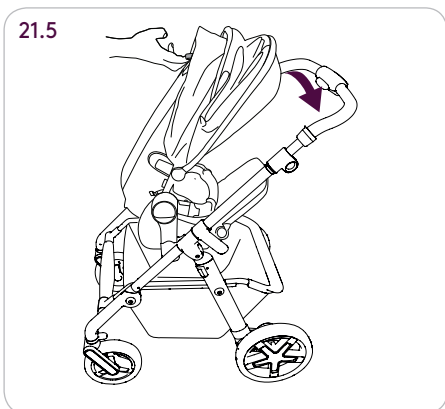
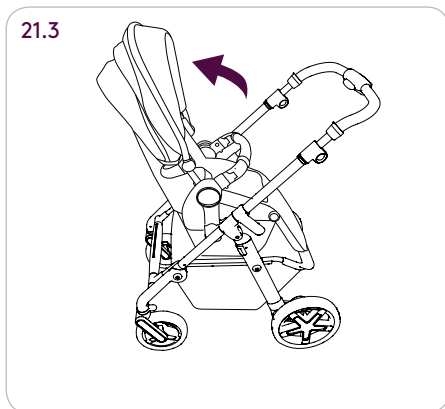
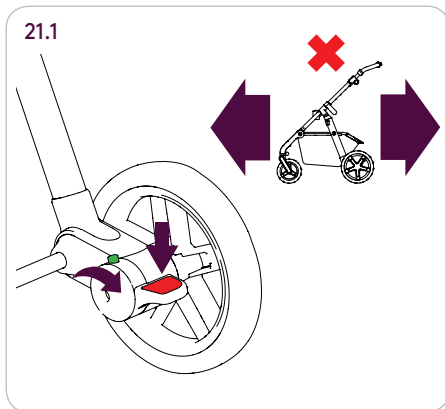
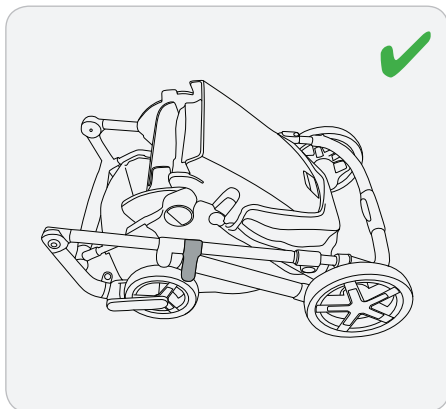

21.6

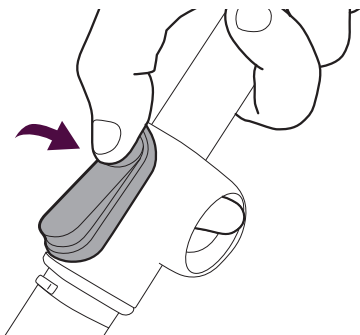

21.7

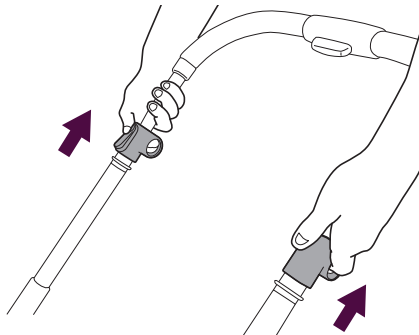

21.8

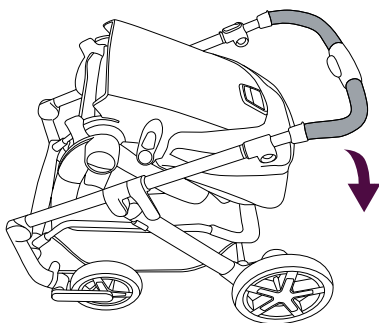

21.9

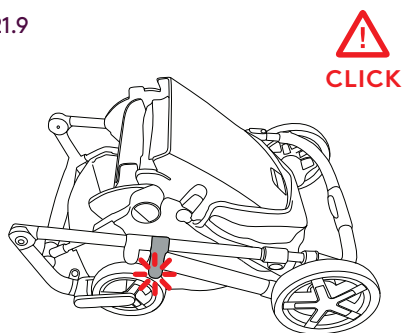

22.1

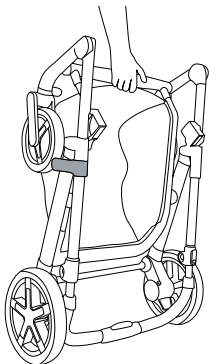

22.2

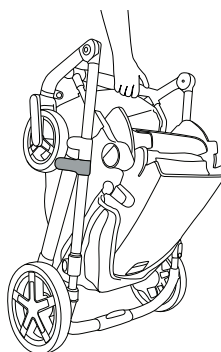

## Safety Notes

The Horizon travel system is a high quality Silver Cross product. It complies with AS/NZS 2088:2013 and with correct use and maintenance will give good service. If, however, you should have any problems with the pushchair, please contact your Silver Cross retailer who will take appropriate action. The Horizon carrycot complies with EN 1466:2014.

The Horizon Go chassis is designed and tested to be used with the Horizon pushchair seat, Horizon Carrycot (sold separately).

This product is suitable from birth up to 9kg with the carrycot, and from birth up to 25kg with the seat unit.

Silver Cross recommend the use of the most reclined seat position for new born babies.

Check the wheels are secure by gently pulling the wheels away from the chassis. Always check when using the parking brake it is fully engaged by gently moving the chassis backwards and forwards.

**IMPORTANT:** Remove the child from the pushchair seat before detaching the pushchair seat from the chassis.

To ensure your Horizon Go chassis folds correctly remove all items from the shopping basket before attempting to fold.

Only replacement parts supplied or recommended by Silver Cross shall be used.

A tether strap has been provided

 **WARNING**  
USE THIS STRAP TO STOP THE PRAM/STROLLER ROLLING AWAY

 **WARNING**  
CARE SHOULD BE TAKEN IF THE PRAM/STROLLER IS USED ON STAIRS OR ESCALATORS

 **WARNING**  
CHECK THE FRONT WHEEL IS SECURE BY PULLING GENTLY DOWNWARDS. CHECK THE REAR WHEEL IS SECURE BY PULLING GENTLY OUTWARDS.

 **WARNING**  
CHECK THAT THE CARRYCOT OR SEAT UNIT OR CAR SEAT ATTACHMENT DEVICES ARE CORRECTLY ENGAGED BEFORE USE.

 **WARNING**  
ALWAYS APPLY THE PARKING BRAKE WHEN YOU ARE STANDING STILL.

 **WARNING**  
ALWAYS APPLY THE BREAK WHEN PLACING AND REMOVING THE CHILD.

## **WARNING**

TO AVOID POSSIBLE INJURY OR DAMAGE, ALWAYS ENSURE THE FOLD LOCK HAS BEEN ENGAGED BEFORE LIFTING AND CARRYING THE CHASSIS (SEE 21.9)

CARRY THE FOLDED CHASSIS USING THE FRONT CHASSIS FOOT PLATE (SEE 22.1 & 22.2)

## **WARNING**

DUE CARE SHOULD BE TAKEN WHEN FOLDING AND UNFOLDING THIS PUSHCHAIR. PLEASE ENSURE FOLDING MECHANISMS ARE KEPT CLEAR TO AVOID POSSIBLE FINGER ENTRAPMENTS OR INJURIES TO PARTS OF THE BODY.

## **WARNING**

DO NOT LEAVE YOUR CHILD UNATTENDED.

## **WARNING**

THE BUMPER BAR MUST BE SECURELY CONNECTED AT ALL TIMES WHEN IN USE. THE SAFETY OF YOUR CHILD IS YOUR RESPONSIBILITY.

## **WARNING**

ALWAYS REMOVE YOUR CHILD FROM THE SEAT UNIT BEFORE ATTEMPTING TO LIFT AND REMOVE THE SEAT UNIT.

## **WARNING**

THE HARNESS CAN FORM LOOPS WHICH MAY BE A STRANGULATION HAZARD. NEVER LEAVE THE HARNESS CONNECTED WHEN NOT FITTED TO A CHILD IN THE PUSHCHAIR.

## **WARNING**

ALWAYS USE THE CROTCH STRAP IN COMBINATION WITH THE WAIST AND SHOULDER STRAPS

## **WARNING**

SECURE THE CHILD IN THE HARNESS AT ALL TIMES.

## **WARNING**

ENSURE ALL LOCKING DEVICES ARE ENGAGED BEFORE USE.

## **WARNING**

ALWAYS ENSURE YOUR BUMPER BAR IS ATTACHED WHEN YOUR CHILD IS IN THE SEAT UNIT.

## **WARNING**

DO NOT USE THIS SEAT WITH ANY OTHER MODELS OF PRAM/STROLLER. MAX WEIGHT: 25KG.

## **WARNING**

DO NOT CARRY EXTRA CHILDREN OR BAGS ON THIS PRAM/STROLLER.

**⚠ WARNING**

MAKE SURE CHILDREN ARE CLEAR OF ANY MOVING PARTS IF YOU ADJUST THE PRAM/STROLLER.

**⚠ WARNING**

TO AVOID INJURY ENSURE THAT YOUR CHILD IS KEPT AWAY WHEN FOLDING AND UNFOLDING THIS PRODUCT.

**⚠ WARNING**

DO NOT CARRY MORE THAN ONE CHILD IN THIS PUSHCHAIR.

**⚠ WARNING**

THIS PRODUCT IS NOT SUITABLE FOR RUNNING OR SKATING.

**⚠ WARNING**

CHECK THAT THE PRAM BODY OR SEAT UNIT ARE CORRECTLY ENGAGED BEFORE USE.

**⚠ WARNING**

DO NOT LET YOUR CHILD PLAY WITH THIS PRODUCT.

**⚠ WARNING**

DO NOT USE IF ANY PART IS BROKEN, TORN OR MISSING.

**⚠ WARNING**

THIS VEHICLE IS DESIGNED FOR USE ON A FLAT OR GENTLY SLOPING SURFACE. CARE SHOULD BE TAKEN ON HIGHER SLOPING AND UNEVEN SURFACES, FOR THE POSSIBILITY OF THE VEHICLE TIPPING OVER.

**⚠ WARNING**

ANY LOAD ATTACHED TO THE HANDLE AND/OR BACKREST AND/OR SIDES OF THE VEHICLE WILL AFFECT STABILITY OF THE VEHICLE.

**⚠ WARNING**

ACCESSORIES AND REPLACEMENT PARTS WHICH ARE NOT APPROVED BY SILVER CROSS SHOULD NOT BE USED.

**⚠ WARNING**

NEVER LEAVE YOUR CHILD IN THE PUSHCHAIR WITH THE RAINCOVER FULLY FITTED OTHER THAN IN NORMAL OUTSIDE USE.

**⚠ WARNING**

THE HORIZON SEAT UNIT AND HORIZON CARRYCOT SHOULD ONLY BE USED ON THE HORIZON CHASSIS.

**⚠ WARNING**

CARE SHOULD BE TAKEN WHEN USING THE PRAM ON STAIRS AND ESCALATORS.

Changing Bag: Maximum load = 1kg (sold separately)

Cup holder: Maximum load = 340g

Basket: Maximum load = 5kg

The child should always wear a safety harness complying with BS6684. 'D' rings are provided for the attachment of an additional harness. These are located on the existing harness close to where it is attached to the seat frame. Shopping or luggage should only be carried in the basket and should not exceed 5kg in weight, evenly distributed.

Always hold the seat when making adjustments.

Never try to fold your Horizon when the child is seated as this may trap the child. If you have difficulty in folding or unfolding the pushchair, do not force. This will cause damage. Read the "To fold or unfold" instructions carefully in the Horizon Instructions. It may be unsafe to fit accessories or spare parts other than those supplied or recommended by Silver Cross. If anyone other than the owner is going to use the Pushchair (e.g. grandparent, child minder), please show them how to use it correctly.

## Care and maintenance

Chassis - Always check your pushchair for signs of wear. Regularly lubricate all moving parts. Check for freedom of movement of all locking devices. Polish metal work with a clean, dry cloth.

Dirt and dust within moving mechanisms may be rinsed away with clean water. Do not soak or submerge.

Fabric items - Please refer to the washcare instructions on each individual item's washcare label.

Seat Unit - To clean, sponge area with warm soapy water. Rinse well with clean water to avoid staining. Allow to dry naturally, away from direct heat and strong sunlight.

Never machine wash, tumble dry, iron or bleach any of the fabric items or seat unit. A certain degree of fading may occur over time through everyday use.

---

## NOTES

---

NOTES

---

## NOTES



Premium Brands Pty Ltd, 10 Capital Court, Braeside Victoria 3195, Australia  
[silvercross.com.au](http://silvercross.com.au)

SX-HORIZON-GO-AUS-0918