

Tight House Power Point Box



Product Description

The Tight House Power Point Box is mounted in the wall space behind a power point to draught-proof and to protect the power point from spray foam insulation. Made of moulded plastic, this power point box will sit inside the wall space and can be secured to a wood batten. It must be installed by a licensed electrician.

Features and Benefits

- Assists sealing electrical penetration for a more airtight building envelope.
- By preventing unwanted air infiltration, airtight construction helps keep out pollutants, allergens, and moisture, leading to better indoor air quality.
- Consistent indoor temperatures and reduced drafts contribute to a more comfortable living or working environment.
- Keeps electrical connections orderly, making it easier to manage and troubleshoot wiring.
- Electrical boxes shield wiring and components from dust, dirt, and moisture, which can cause damage or electrical faults.

Product Dimensions

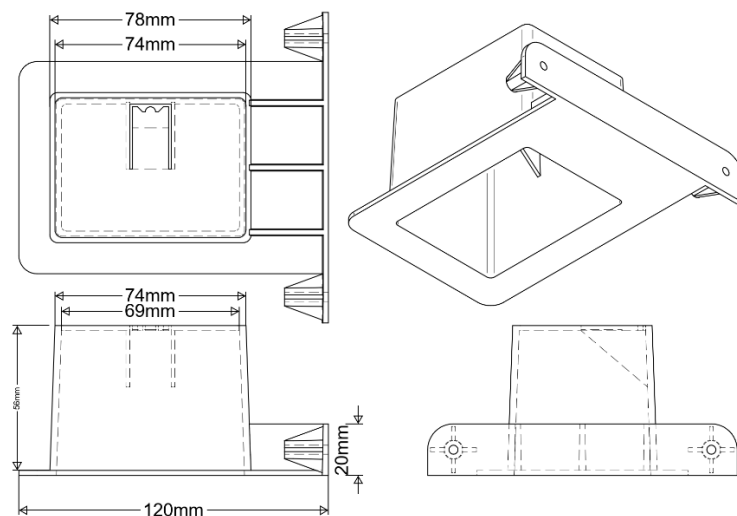

*The information in this publication is based on the present state of our knowledge but any conclusion and recommendations are made without liability on our part. Buyers should make their own assessment of our product under their own conditions and for their requirements.

Applications/Scope of use

- Suitable for new builds only as part of the building envelope system.
- For metal or timber frame construction.
- To ensure the integrity of the building envelope, the electrical box should be sealed to the air barrier system.

Installation

For up to two cables, the unit should be securely attached to the stud, with cables routed through, properly clamped and sealed to ensure a tight fit.

For more cables, the unit should be securely attached to the stud, with cables routed through and sealed without the clamp.

Maintenance

No maintenance requirements.

Warranty

Tight House Power Point Box is warranted for 10 years.

Health and Safety

Take care when working on wall assembly and follow all guidance and industry good practice guidelines.

Durability

Tight House Power Point Box can be left exposed during construction, but it must be protected from careless handling, vandalism, long-term UV radiation, and constant high temperatures. Replace any damaged product before completion. Cover the Tight House Power Point Box within 30 days.

Technical Data

The product is made up of a medium flow modified polycarbonate full compound material. It is suitable for injection moulding applications, grade exhibits V0* flammability, good toughness, impact strength and ease of processing characteristics.

Property ⁽¹⁾	Test Method	Units	Value ^{(2) (3)}
Tensile @ Yield (50mm/min)	ISO 527	MPa	70
Elongation @ Break	ISO 527	%	>80
Flexural Strength	ISO 178	MPa	105
Flexural Modulus	ISO 178	GPa	2.8
Notched Izod Impact	ISO 180/A	Kj/m ²	55
H.D.T. (1.82MPa) @ 3.2mm	ISO 75	°C	125
V0 (3.0 mm)	UL94*	10 sec	PASS
MFI (300°C/1.2kg)	ISO 1133	g/10 min	8.7
Specific Gravity	ISO 1183	g/cm ³	1.22

(1) Typical properties; not to be construed as specifications

(2) Values quoted are the result of tests on representative samples and the product supplied may not conform in all respects.

(3) Values quoted are the result of tests on Natural/Un-pigmented product. These values may vary on products that contain pigmentation or any other additive.

*The information in this publication is based on the present state of our knowledge but any conclusion and recommendations are made without liability on our part. Buyers should make their own assessment of our product under their own conditions and for their requirements.