

**GASLESS | COST-EFFECTIVE | LIGHTWEIGHT | SUPERIOR PERFORMANCE**

### 300A

60%

0.045" Wire

10ft

15ft

20ft

Other Lengths or Power Pins

Lincoln® Connector

0501.0161

0501.0156

0501.0154

Contact Sumig

Euro Connector

0501.0163

0501.0184

0501.0158

### 400A

60%

0.045" - 1/16" Wire

10ft

15ft

20ft

Other Lengths or Power Pins

Lincoln® Connector

0501.0169

0501.0083

0501.0165

Contact Sumig

Euro Connector

0501.0175

0501.0185

0501.0166

### 500A

60%

1/16" - 3/32" Wire

10ft

15ft

20ft

Other Lengths or Power Pins

Lincoln® Connector

0501.0082

0501.0179

0501.0172

Contact Sumig

Euro Connector

0501.0170

0501.0176

0501.0173

**STANDARD**  
CONSUMABLES

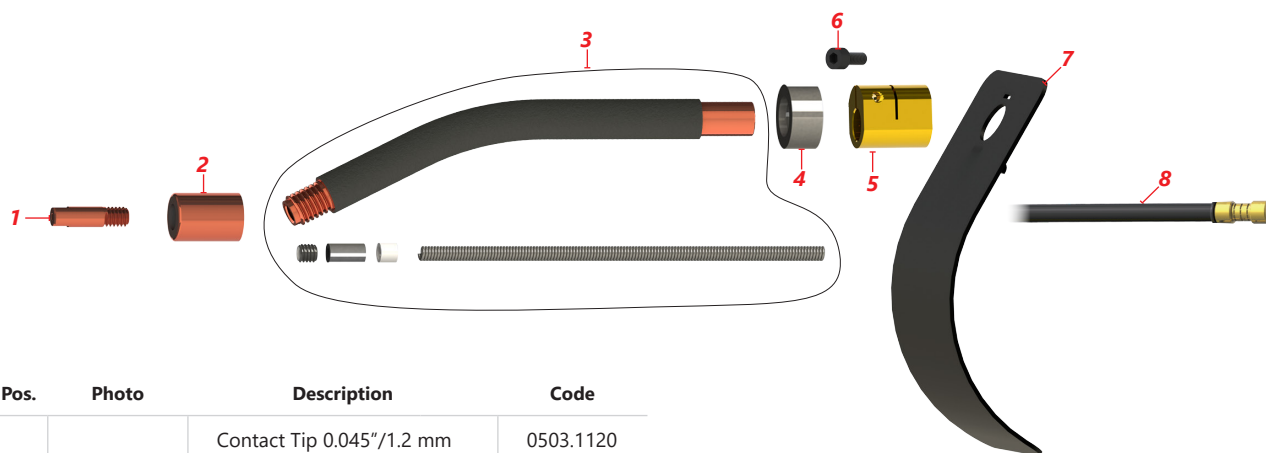

Pos.	Photo	Description	Code	
01		Contact Tip 0.045"/1.2 mm	0503.1120	
		Contact Tip 0.070"/1.8 mm	0503.1102	
		Contact Tip 1/16"/1.6 mm	0503.1101	
		Contact Tip 5/64"/2.0 mm	0503.1103	
02		Thread Protector	0503.1128	
03		Torch Body	0503.1126	
04		Insulator Ring	0502.1900	
05		Connection Block	2140.0169	
06		Screw	4002.8038	
07		Handle Protector	0502.1953	
08		Stainless Steel Liner	10Ft	0502.1813
			15Ft	0502.1815

Any informations on this brochure is subject to change without notice



**SUMIG USA CORPORATION**  
8600 Commodity Circle #159  
Orlando, FL 32819

☎ 1 800 503-9717  
 🌐 [www.sumigusa.com](http://www.sumigusa.com)  
 ✉ [sumigusa@sumig.com](mailto:sumigusa@sumig.com)